

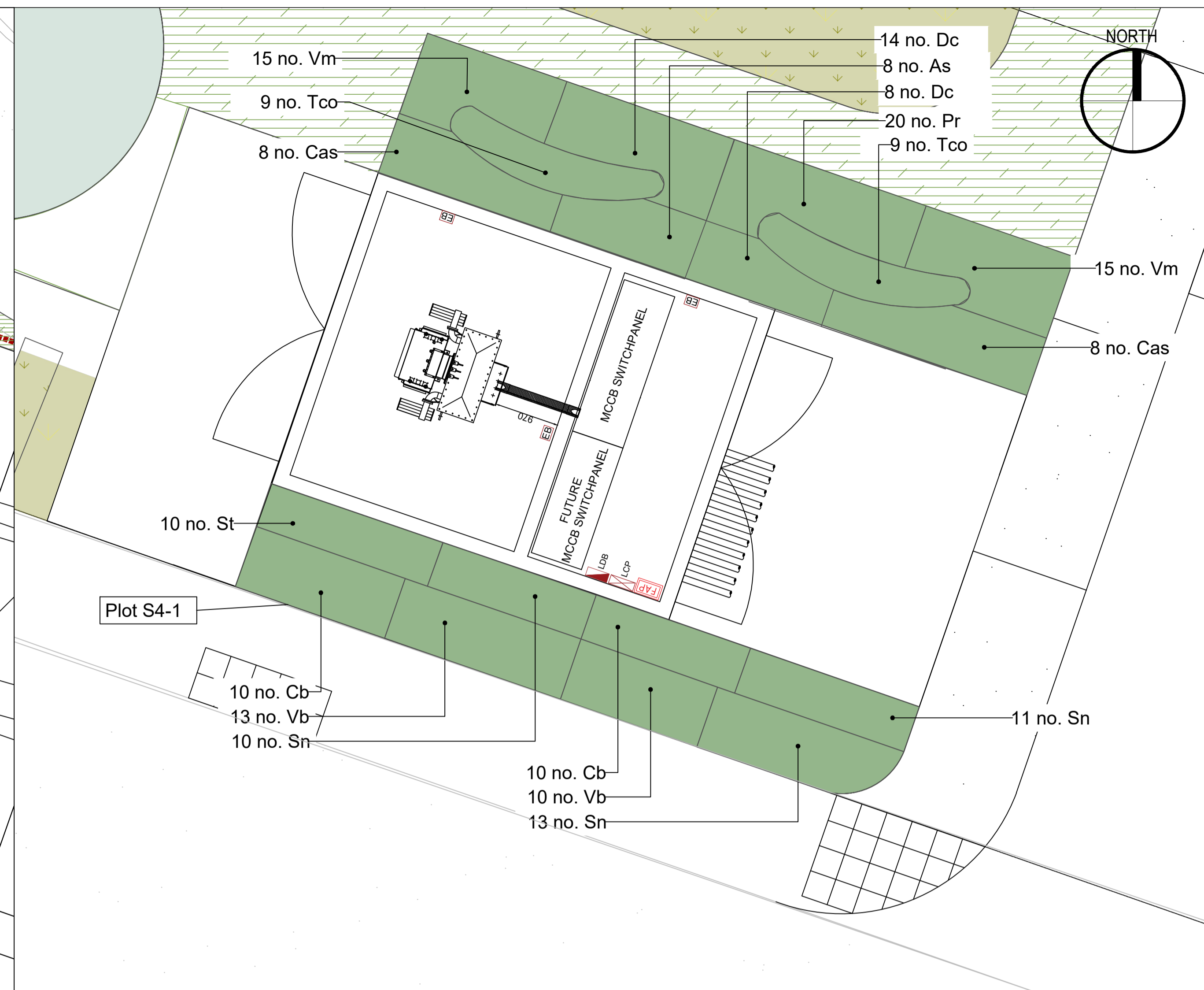

1 Landscape Planting Detail Area
D-L-1400 SCALE 1:100

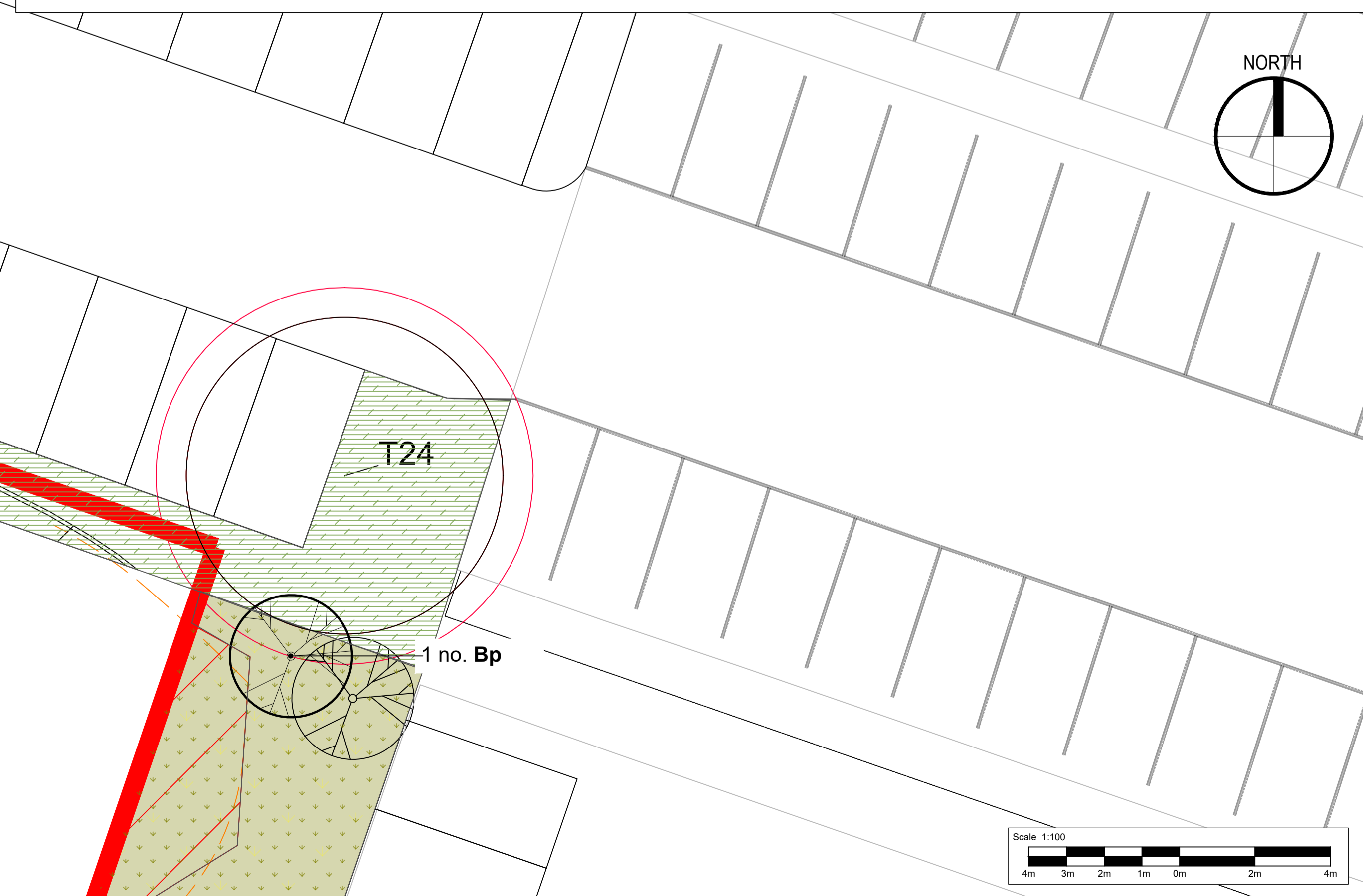

2 Landscape Planting Detail Area
D-L-1400 SCALE 1:50



Scale 1:100

- KEY**
- SOFT LANDSCAPE**
- Existing tree to be retained and protected. Root protection area identified in Purple. Refer to Arboricultural information.
 - Existing tree / vegetation to be removed
 - Planting Type S1: Proposed native shrub/scrub planting
 - Planting Type S2: Proposed species rich lawn turf
 - Planting Type S3: Proposed neutral grassland
 - Planting Type S4 / S5: Proposed wildlife friendly shrub and perennial planting
 - Planting Type RG: Proposed rain garden planting
 - Planting Type BU: Proposed bulb planting & species rich lawn turf
 - Proposed grasscrete seeded by high quality amenity grass seed
 - Proposed native hedgerow
 - Proposed Extra Heavy Standard tree planting.

- Notes:
- General:
Grasscrete to be seeded with grass seed mix as shown on 705674_2201-ATK-000-XX-D-L-1408 - Landscape Planting - Plan - Detail Area Sheet 9 of 9: Planting Schedules
1. Grasscrete hard structure and build up to engineer specification
 2. Topsoil works to be carried out in accordance with document: 705674_2201-ATK-000-XX-T-L-0404 - Stage 4 Landscape Specification

- This drawing should be read in conjunction with:
- 705674_2201-ATK-000-XX-D-L-1001 to 1009 - Landscape General Arrangement Plans
 - 705674_2201-ATK-000-XX-D-L-0410 to 0417 Landscape General Arrangement Plans and Outline Phase Plan
 - 705674_2201-ATK-000-XX-D-L-1412 - Landscape Planting General Arrangement Key Plan
 - 705674_2201-ATK-000-XX-D-L-1400 to 1408 - Landscape Planting Plan Detail Areas
 - 705674_2201-ATK-000-XX-D-L-1408 - Landscape Planting - Plan - Detail Area Sheet 9 of 9: Planting Schedules
 - 705674_2201-ATK-000-XX-D-L-1410 - Planting Tree Pit Details
 - 705674_2201-ATK-000-XX-T-L-0404 - Stage 4 Landscape Specification

© Crown copyright 2022
Do not scale from drawings. Verify all dimensions on site prior to construction. This drawing is to be read in conjunction with all relevant documents and drawings. Report all discrepancies to MoJ immediately.
No unauthorised use, disclosure, storage or copying.

SAFETY, HEALTH AND ENVIRONMENTAL INFORMATION

In addition to the hazards/risks normally associated with the types of work detailed on this drawing, note the following:

CONSTRUCTION

FOR PROJECT AND BUILDING RISKS PLEASE REFER TO RISK REGISTER

MAINTENANCE/CLEANING

FOR PROJECT AND BUILDING RISKS PLEASE REFER TO RISK REGISTER

DECOMMISSIONING/DEMOLITION

FOR PROJECT AND BUILDING RISKS PLEASE REFER TO RISK REGISTER

It is assumed that all works will be carried out by a competent contractor working, where appropriate, to an approved method statement

P02	JR	MaJ	16/05/2023	FOR PLANNING
P01	CM	MaJ	17/03/2023	STAGE 4 ISSUE
Rev	Issued by	Issued to	Date	Description

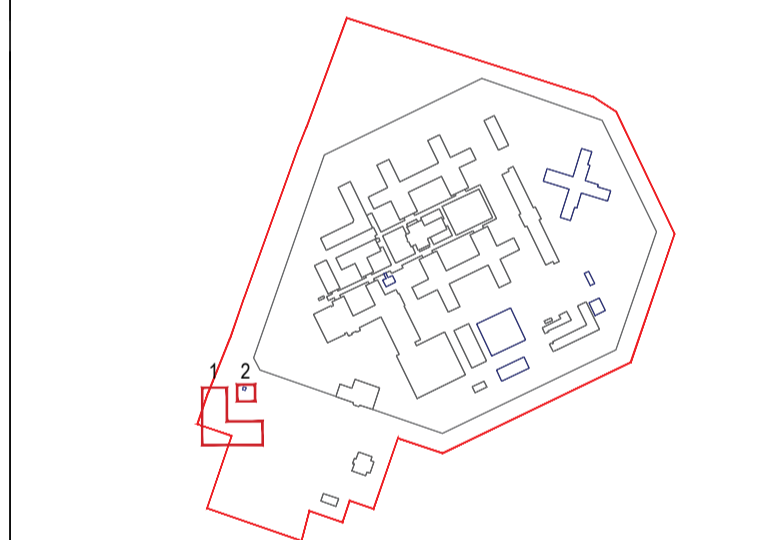

Project Status
FOR INFORMATION

Client
 Ministry of Justice
Project
HMP ELMLEY EXPANSION PROJECT

Ministry of Justice, 102 Petty France, London, SW1H 9AJ
Project Description / Site
HMP ELMLEY EXPANSION PROJECT

Project Address
ELMLEY CHURCH ROAD,
EASTCHURCH,
SHEERNESS
ME12 4DZ

Building Type
SITE WIDE

Drawing Title
**LANDSCAPE - PLANTING PLAN
DETAIL AREA SHEET 1 OF 9**

Drawn By: CM Date: 17/03/23
Checked By: NA Date: 17/03/23
Approved By: JH Date: 17/03/23

Drawing Number
705674_2201-ATK-000-XX-D-L-1400

Sheet No. 1 of 9 Scale As Shown Orig. Sheet Size @ A1 Rev. P02

Data Security Classification
OFFICIAL Suitability
S2