

KEY

FENCES

- 15m offset from perimeter / zonal fence line
- HMP Elmley existing perimeter fence line retained
- Existing internal zonal fence retained
- Proposed internal zonal fence, 5.2m high (unless specified otherwise)
- Proposed Sports Pitch fencing, 2.4m high (unless stated otherwise)

HARD LANDSCAPE

- Existing asphalt concrete roadway / vehicular hardstanding retained
- Proposed asphalt footpath / pedestrian only area + occasional vehicle overrun *
- Proposed asphalt roadway / vehicular hardstanding *
- Existing concrete roadway / vehicular hardstanding retained
- Proposed concrete roadway / vehicular hardstanding *
- Proposed PCC permeable block paving car parking space, suitable for vehicular use *
- Proposed EV charging bays (paving to match adjacent bays / with permeable block)*
- Proposed PCC block paving footpath to tie in with existing *
- Proposed Type 4 polymetric MUGA court surface. (Q26)
- Proposed Synthetic grass 3G football pitch. (Q26)
- Proposed grasscrete. See civils specification for product*, and refer to landscape spec (Q31) for topsoil and grass seeding.
- Proposed 450mm high timber knee rail
- Proposed tactile blister paving to pedestrian crossings. Colour: buff

SOFT LANDSCAPE

- Existing tree to be retained and protected. Root protection area identified in Purple. Refer to Arboricultural information.
- Existing tree / vegetation to be removed
- Proposed native shrub/scrub planting **
- Proposed species rich lawn turf **
- Proposed neutral grassland **
- Proposed wildlife friendly shrub and perennial planting **
- Proposed rain garden planting **
- Proposed bulb planting & species rich lawn turf **
- Proposed grasscrete seeded by high quality amenity grass seed **
- Proposed native hedgerow **
- Proposed Extra Heavy Standard tree planting. Refer to Soft Landscape Strategy **

© Crown copyright 2022

Do not scale from drawings. Verify all dimensions on site prior to construction. This drawing is to be read in conjunction with all relevant documents and drawings. Report all discrepancies to MoJ immediately.

No unauthorised use, disclosure, storage or copying.

SAFETY, HEALTH AND ENVIRONMENTAL INFORMATION

In addition to the hazards/risks normally associated with the types of work detailed on this drawing, note the following:

CONSTRUCTION

FOR PROJECT AND BUILDING RISKS PLEASE REFER TO RISK REGISTER

MAINTENANCE/CLEANING

FOR PROJECT AND BUILDING RISKS PLEASE REFER TO RISK REGISTER

DECOMMISSIONING/DEMOLITION

FOR PROJECT AND BUILDING RISKS PLEASE REFER TO RISK REGISTER

It is assumed that all works will be carried out by a competent contractor working, where appropriate, to an approved method statement

- Note:
- *Refer to Civils Engineer's Specification for further details in relation to hard landscape elements, including paving types and edgings, document number: 705674_2201-BHK-000-XX-T-S-0002
 - **Refer to Planting Plans drawings number 705674_2201-ATK-000-XX-D-L-1400-705674_2201-ATK-000-XX-D-L-1409
 - Fire route to be designed to accommodate a minimum of 12.5 ton load in accordance with approved 'Building Regulation Part B'. The capacity of the existing vehicle route to be checked to ensure they are suitable to support the fire tender loading
 - Drawing to be read in conjunction with Landscape Specification.
 - Refer to MoJ Design Guide 'Physical & Special Security' document number STD-Z-DG-068
 - Refer to MoJ Design Guide 'Design guide perimeter security' document number STD-Z-DG-062

Rev	Issued by	Issued to	Date	Description
P03	KJ	MoJ	17/03/2022	FOR PLANNING
P02	LM	MoJ	31/10/2022	ISSUED FOR REVIEW AND AUTHORIZATION
P01.02	LM	MoJ	10/06/2022	Draft Issue for Discussion
P01.01	LM	MoJ	20/05/2022	Draft Issue for Discussion

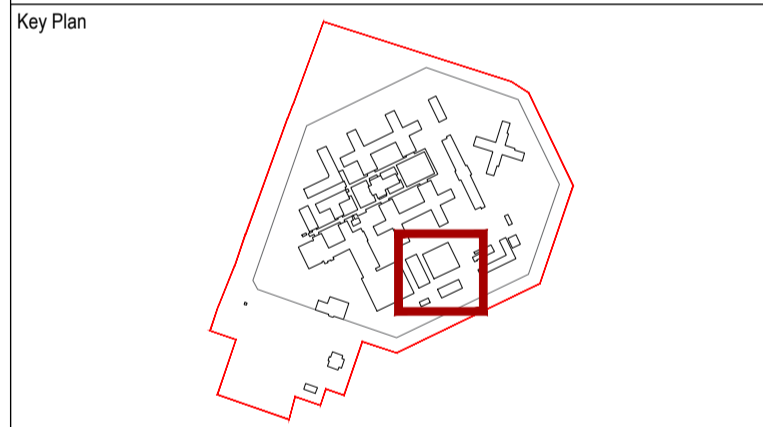

Project Status
FOR INFORMATION

Client: **Ministry of Justice**

Project: **HMP ELMLEY EXPANSION PROJECT**

Ministry of Justice, 102 Petty France, London, SW1H 9AJ

Project Description / Site
HMP ELMLEY EXPANSION PROJECT

Project Address
ELMLEY CHURCH ROAD,
EASTCHURCH,
SHEERNESS
ME12 4DZ

Building Type
SITE WIDE

Drawing Title
**GENERAL ARRANGEMENT
LANDSCAPE - WORKSHOP / ADMIN
LEVEL 00**

Drawn By: LM	Date: 20/05/22
Checked By: NA	Date: 20/05/22
Approved By: JH	Date: 20/05/22

Drawing Number
705674_2201-ATK-035-XX-D-L-1004

Sheet No.	Scale	Orig. Sheet Size	Rev.
1 of 1	1:200	@ A1	P03

Data Security Classification
OFFICIAL

Suitability
S2

