

PLEASE REFER TO ALL DORMER AND CO DRAWINGS IN CONJUNCTION WITH THE STRUCTURAL ENGINEERS CALCULATIONS FOR FURTHER DETAILS

Do not scale this drawing

The drawing is subject to copyright laws and the use of this drawing is licensed by Dormer & Co. Chartered Architects for use on this project only.

In the event of any discrepancies being found they are to be brought to the attention of Dormer & Co. Chartered Architects as soon as possible.

Contractors must check all dimensions on site.

Scale bar at 1:100

Construction design & management regulations (CDM 2015)
 It is the duty as principal contractor under the CDM 2015 regulations to be aware of the project risks as highlighted within the pre-construction health & safety file, and adhere to the agreed methodology contained within the document to minimise risk to site personnel and members of the public from a construction and maintenance view point. The principal contractor is also responsible for the compiling of the construction health and safety file in accordance with the HSE guidance. www.hse.gov.uk/principalcontractor

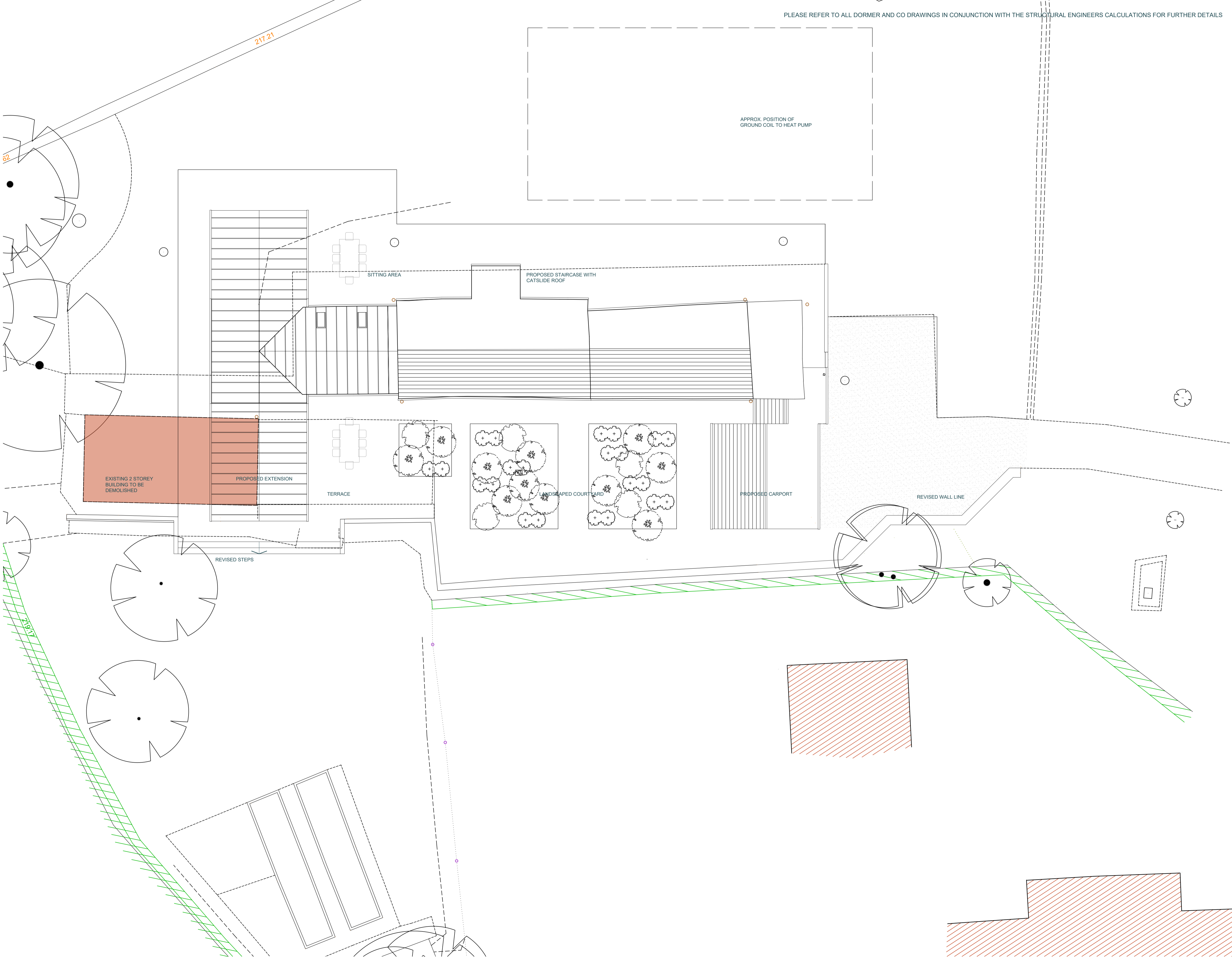

Rev	Date	Reason	NPD	KAD
A	28.05.23	GSHP Ground coil indicative position added		

DORMER & Co.

MENWITH HILL TOP BARN, MENWITH HILL, HARROGATE

PROPOSED EXTENSIONS AND ALTERATIONS

PROPOSED SITE PLAN

scale:	at:	des:	rev:	date:
1:100	A1	2259.P04	A	MAY 2023

Drawn by:	Checked by:	Status:
NPD	KAD	PLANNING

RIBA Chartered Practitioner
 Dormer & Co. Chartered Architects Ltd
 18 West Park, Harrogate, North Yorkshire HG1 1BJ
 T: 01423 851500 W: www.dormerandco.com

Site Plan
 1:100

ALL DIMENSIONS ARE ANTICIPATED AND MUST BE CONFIRMED ONSITE