

THE SCHOOL HOUSE, LUCKER VILLAGE, NORTHUMBERLAND

FLOOR PLAN LAYOUT | AS EXISTING

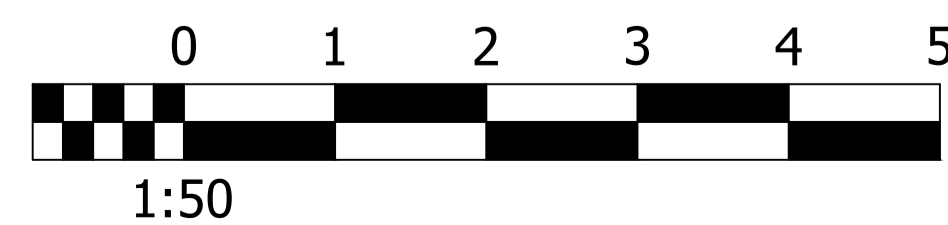
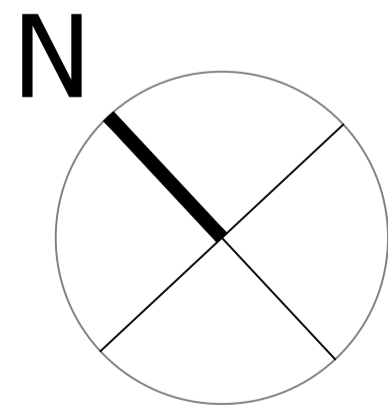
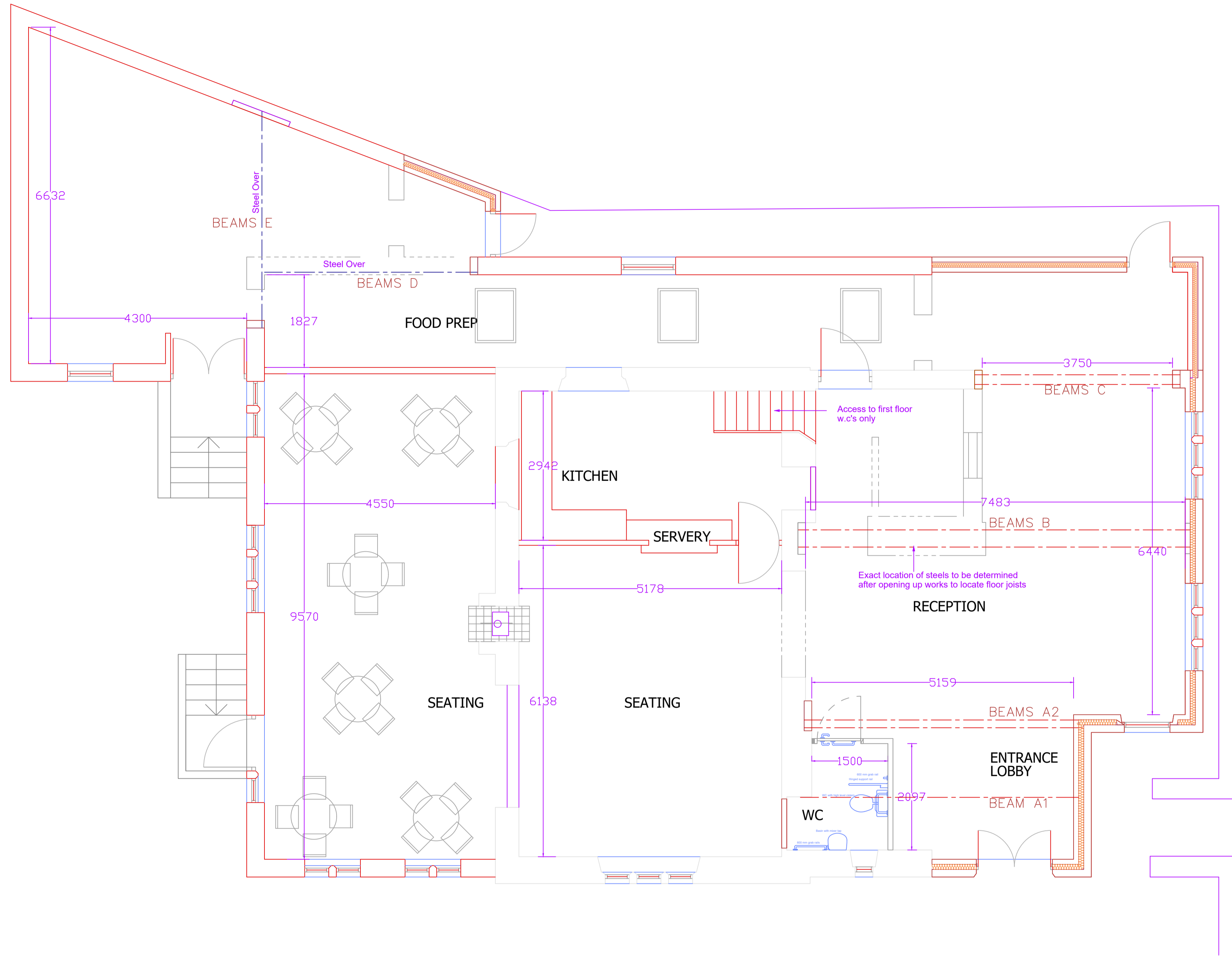

GENERAL NOTES

THIS DRAWING IS TO BE READ IN CONJUNCTION WITH ALL MICHAEL ATKINSON ARCHITECTURE + HERITAGE DRAWINGS FOR THE PROJECT.

CONTRACTORS ARE ADVISED TO CONTACT MICHAEL ATKINSON ARCHITECTURE + HERITAGE WITH ANY QUERIES REGARDING THE CONTENTS OF THE DRAWING TO PROVIDE FURTHER CLARIFICATION OF THE DESIGNS CONTAINED WITHIN.

ACCURACY OF DRAWINGS

THIS DRAWING MAY HAVE BEEN BASED ON EXISTING DRAWINGS NOT PREPARED BY MICHAEL ATKINSON ARCHITECTURE + HERITAGE WHICH MAY NOT BE CURRENT AND ACCURATE THEREFORE ALL SITE DIMENSIONS SHOULD BE VERIFIED AND CONFIRMED BEFORE ANY WORKS ARE CARRIED OUT ON SITE OR SHOP DRAWINGS PRODUCED.

'AS BUILT' DRAWINGS ARE PRODUCED IN ACCORDANCE WITH FEEDBACK FROM THE CONTRACTORS TEAM AND WHILST EVERY EFFORT IS MADE TO ENSURE ACCURACY AS SUCH THEY MAY NOT BE 100% ACCURATE TO ACTUAL CONSTRUCTION DETAILS.

DEMOLITIONS

ALL STRIPPING OUT AND DEMOLITION WORKS ARE SUBJECT TO STRUCTURAL INVESTIGATIONS.

B	30/05/23	PLANNING ISSUE
A	23/05/23	PLANNING ISSUE

Michael Atkinson
ARCHITECTURE & HERITAGE

THE APPLE INN + SCHOOL HOUSE, LUCKER VILLAGE, BELFORD, NORTHUMBERLAND, NE70 7JL
THE SCHOOL HOUSE | CONVERSION TO LEISURE APARTMENTS

FLOOR PLAN LAYOUT | AS EXISTING

MA	MA	0396	S 04	B
----	----	------	--------	---

28/03/2023	1:50 @ A1	RIBA STAGE 3 : SPATIAL COORDINATION
------------	-----------	-------------------------------------

Contractors must verify all dimensions on site before commencing any work or making shop drawings.
© 2023 | DRAWING AND DESIGN COPYRIGHT OF MICHAEL ATKINSON ARCHITECTURE + HERITAGE