

GROUND FLOOR PLAN
to mains in Lane

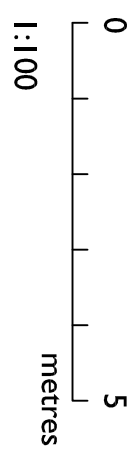

A Ref. 30.05.23 Date
Window in Bathrm changed to rooflight.
Revision

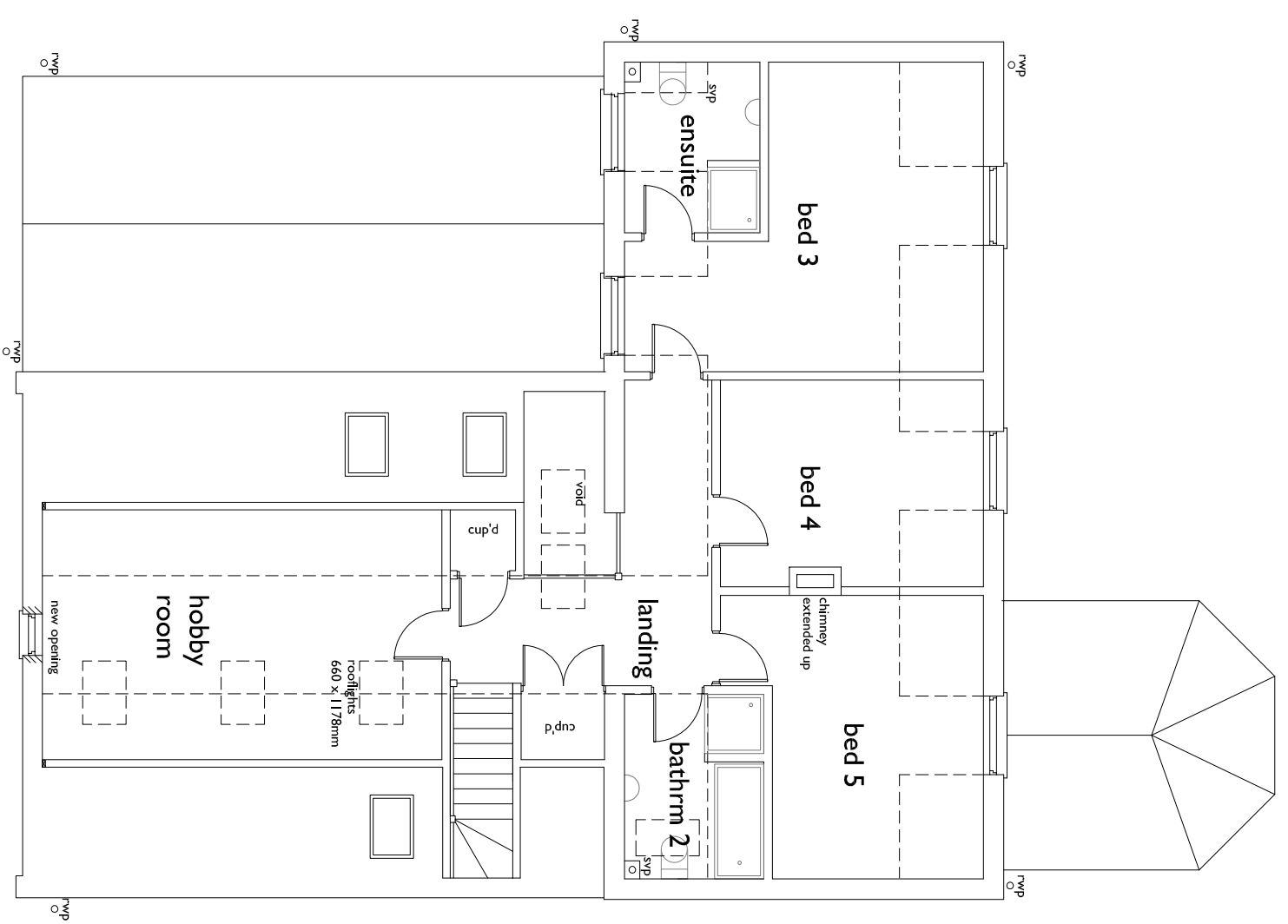

FIRST FLOOR PLAN

Do not scale from this drawing. All measurements to be checked on site. Any discrepancies, contact the issuer.

		Rose Cottage High Street Rothfield Bury St Edmunds Suffolk IP30 0QA	Lara Turner Architectural Services © tel: 01 440 737 428 e-mail: enquiries@ltaarchitectural.co.uk
DETAIL: FLOOR PLANS PROPOSED		PROJECT: EXTENSIONS & ALTERATIONS - LONGFIELD, WOOLPIT GREEN, IP30 9RQ	
Scale: 1:100@A3	Date: January 2022	JOB No. LRRF0516	DRG No. 104A