

Pitched Roof Build Up - Insulation at Rafter Level -  
 To provide U-Value of 0.15 W/m2K.  
 (Min. standard for new thermal elements BR\_Part L1B 0.15 W/m2K)  
 Redland Norfolk Pantiles - to match existing  
 25 x 38 mm treated softwood battens  
 Breather membrane  
 Rafters: 150 x 50 C24 @ 400mm C/C'S to SE's specification - with  
 100mm Celotex GA4000 rigid insulation boards between rafters  
 (or equal and approved)  
 60mm Celotex GA4000 rigid insulation boards below rafters (or equal and approved)  
 1000 gauge vapour control layer  
 2 x 12.5mm plasterboard - skimmed and decorated

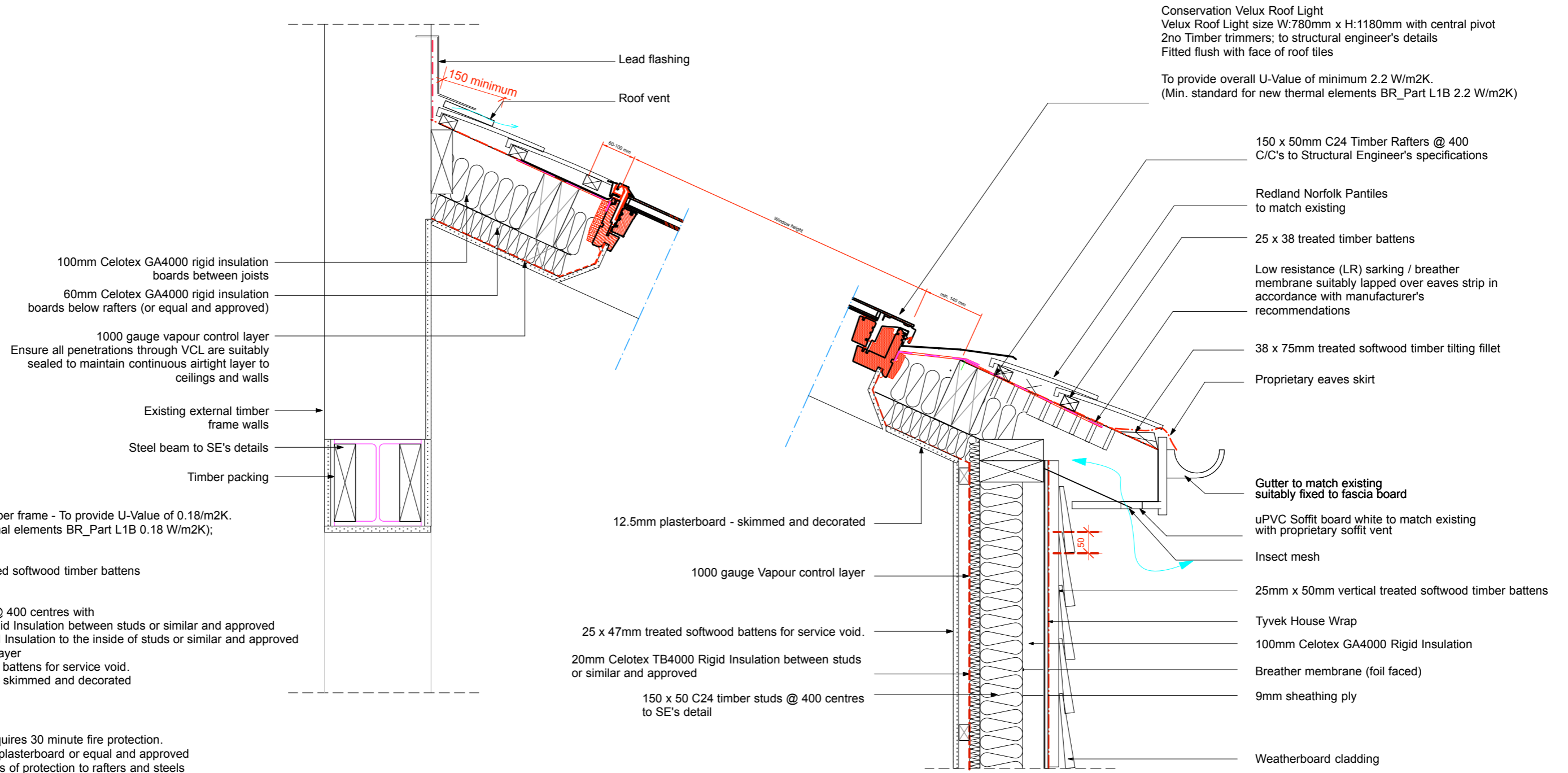

External Wall Build Up - Timber frame - To provide U-Value of 0.18/m2K.  
 (Min. standard for new thermal elements BR\_Part L1B 0.18 W/m2K);

Weatherboard Cladding-  
 25mm x 50mm vertical treated softwood timber battens  
 Tyvek House Wrap  
 9mm sheathing ply  
 150 x 50 C24 timber studs @ 400 centres with  
 100mm Celotex GA4000 Rigid Insulation between studs or similar and approved  
 20mm Celotex TB4000 Rigid Insulation to the inside of studs or similar and approved  
 1000 gauge Vapour control layer  
 25 x 47mm treated softwood battens for service void.  
 12.5mm plasterboard finish - skimmed and decorated

**FIRE RATING:**  
 All load bearing structure requires 30 minute fire protection.  
 2 x 12.5mm Gyproc Fireline plasterboard or equal and approved  
 to ceiling provides 30 minutes of protection to rafters and steels

**NOTES:**  
 Allow for moisture resistant Gyproc plasterboard to all wet areas.  
 Ensure plasterboard joints are staggered by at least 600mm  
 where 2 layers of plasterboard are used.

0 100 400mm

Äröland  
 Design

3 Church Walk  
 Sawbridgeworth  
 Herts CM21 9BJ

07884294779

Revisions:

Project: 8A Widford Road, Hunsdon, Ware SG12 8NW  
 Drawing: Proposed Roof and Rooflight Detail  
 Date: May 2023

Status: Building Control  
 Scale: 1:10@A3  
 Drawing No: 0356-1502-BC