

LOCATION PLAN 1/2500

arable farmland

agricultural access retained

existing private gardens

dean jay pearce
 architectural design & planning ltd
 2 / 3 Milestone, Hall Street, Long Melford
 Sudbury, Suffolk, CO10 9HZ
 T: 01787-378797 E: dean_pearce@live.co.uk

Project:
 Proposed residential development, change of use of land and new vehicular access (following stopping up of existing).

Site Address:
 Land between Belfry Cottage and Peartree Cottage, North of George Street, Hintlesham, IP8 3NH

Applicant:
Mr & Mrs R L Pearson

Drawing title:
PROPOSED SITE PLAN (COLOUR)

scale: 1: 200
 date: 01 / 2020
 drawn: djp
 checked:

drg no: **20/07/02 (i)** rev:

Do not scale this drawing. Use figured dimensions only. Contractor to set out all of the works prior to commencement and report any omissions / discrepancies immediately. Scales shown on this drawing are at A1 sheet size.

This drawing & information are Copyright. ©

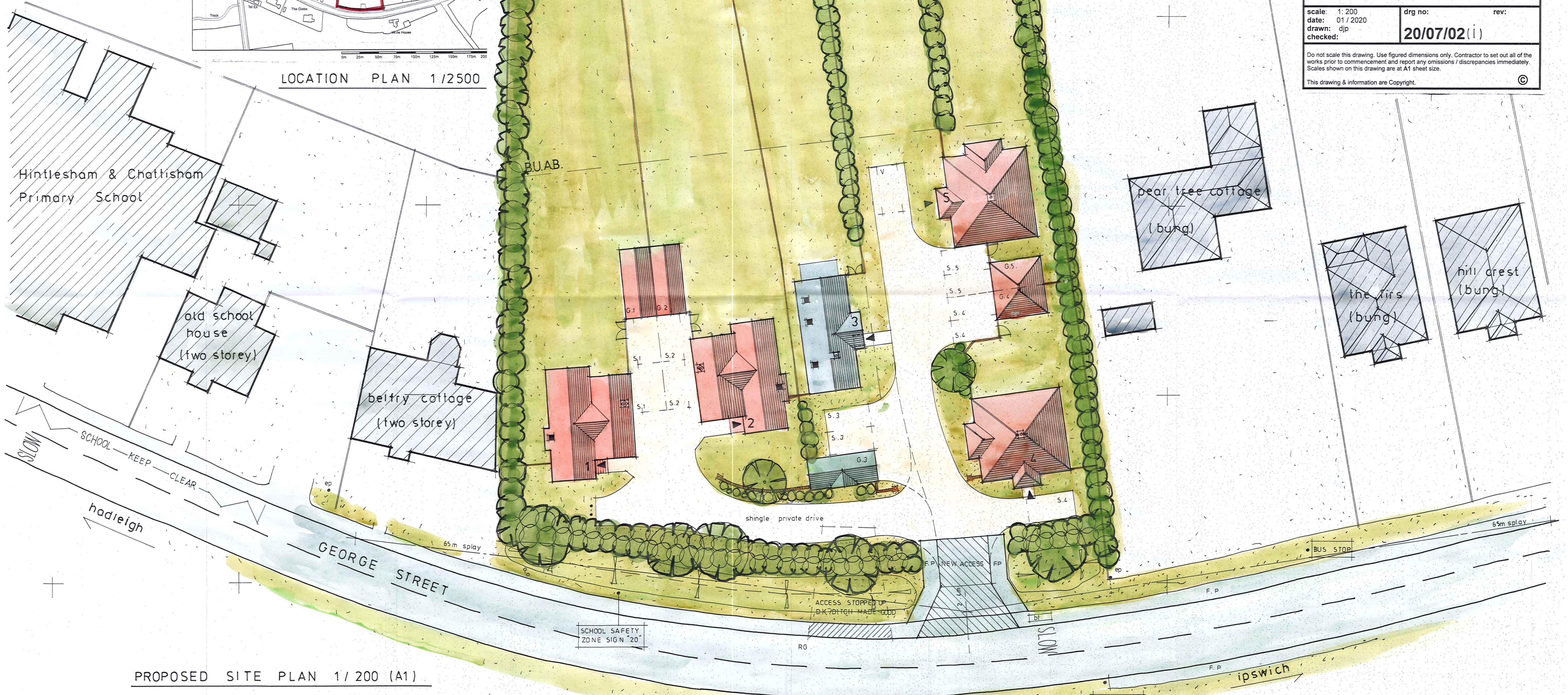

PROPOSED SITE PLAN 1/ 200 (A1)

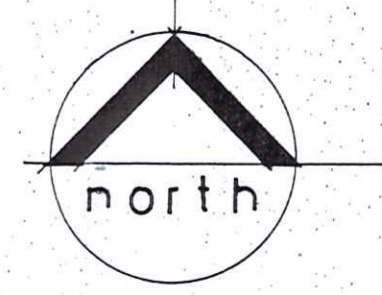
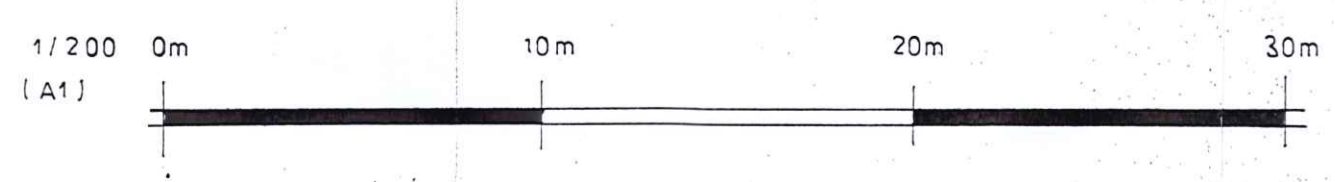

SCHEDULE OF ACCOMMODATION

PLOT	TYPE	DESCRIPTION
PLOT 1	TWO-STORY	4 BED HOUSE WITH GARAGE / PARKING
PLOT 2	TWO-STORY	4 BED HOUSE WITH GARAGE / PARKING
PLOT 3	TWO-STORY	3 BED HOUSE WITH GARAGE / PARKING
PLOT 4	SINGLE-STORY	3 BED BUNGALOW WITH GARAGE / PARKING
PLOT 5	SINGLE-STORY	3 BED BUNGALOW WITH GARAGE / PARKING

white house
2-storey