

Notes:-
 All dimensions and setting out to be verified prior to work commencing.
 All discrepancies to be notified to this office prior to work commencing.
 Do not scale off drawing - use figured dimensions only.

Rev.	Revision	Date
a	further notation added	20.4.23

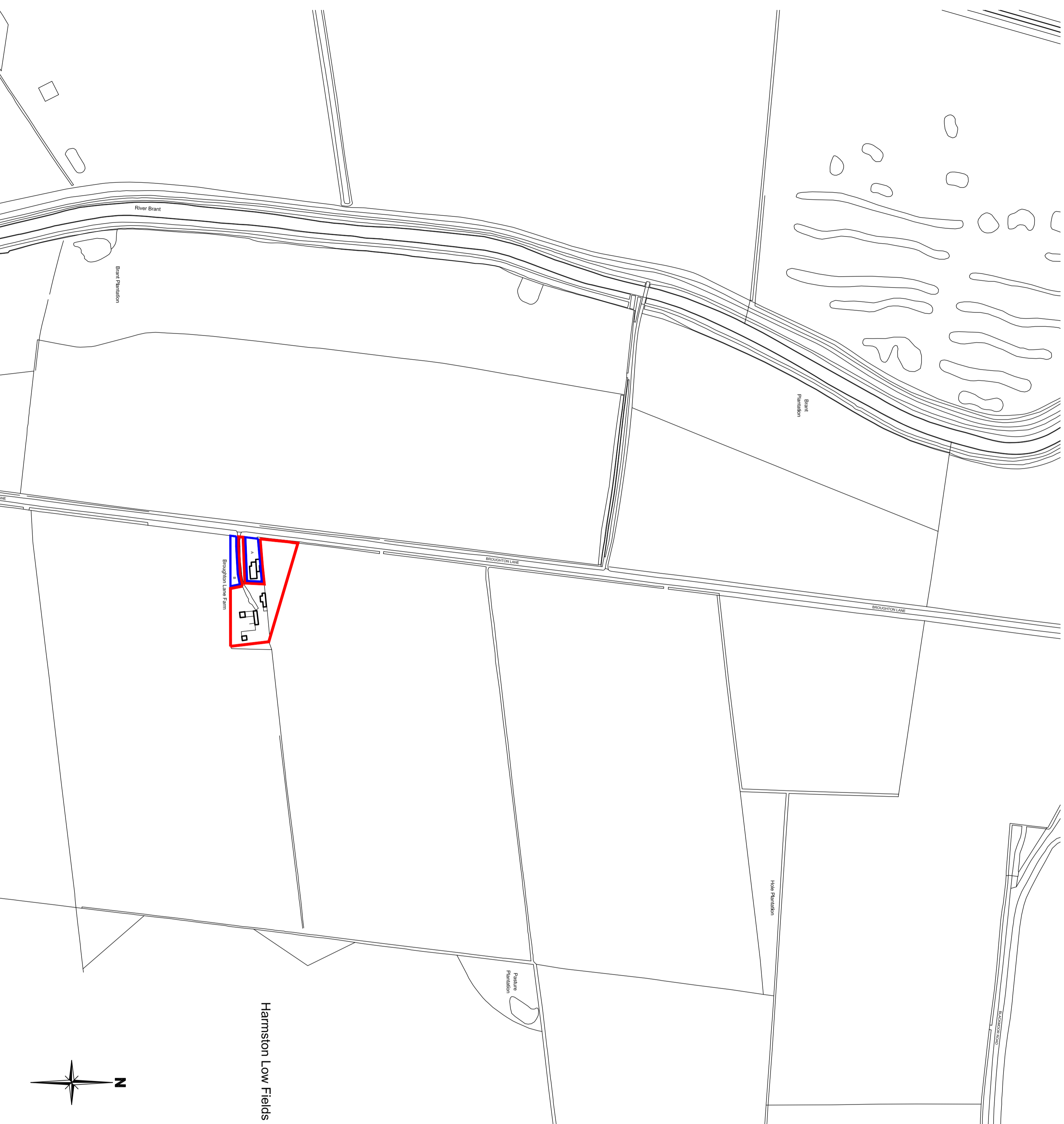

Lawful Development Certificate
drawing status

**Proposed Change of Use of
 Agricultural Land to Domestic at
 Broughton Lane Farm, Harmston
 Low Fields for Mr and Mrs T Hill**

OS Plan		drawing.
1:2500 @ A2	March 2023	date.
466 - H - 1 a		drawing no.



architecture ▪ design ▪ planning

The Studio, Woodmans Cottage, Swinderby Road,
 Norton Disney, Lincoln, LN6 9QH
 t : 01522 869469 m : 07596 155845
 e : evolutiondesign@btinternet.com w : evolutiondesign.info

Harmston Low Fields