

Notes:-
 All dimensions and setting out to be verified prior to work commencing.
 All discrepancies to be notified to this office prior to work commencing.
 Do not scale off drawing - use figured dimensions only.

Rev.	Revision	Date
.	.	.

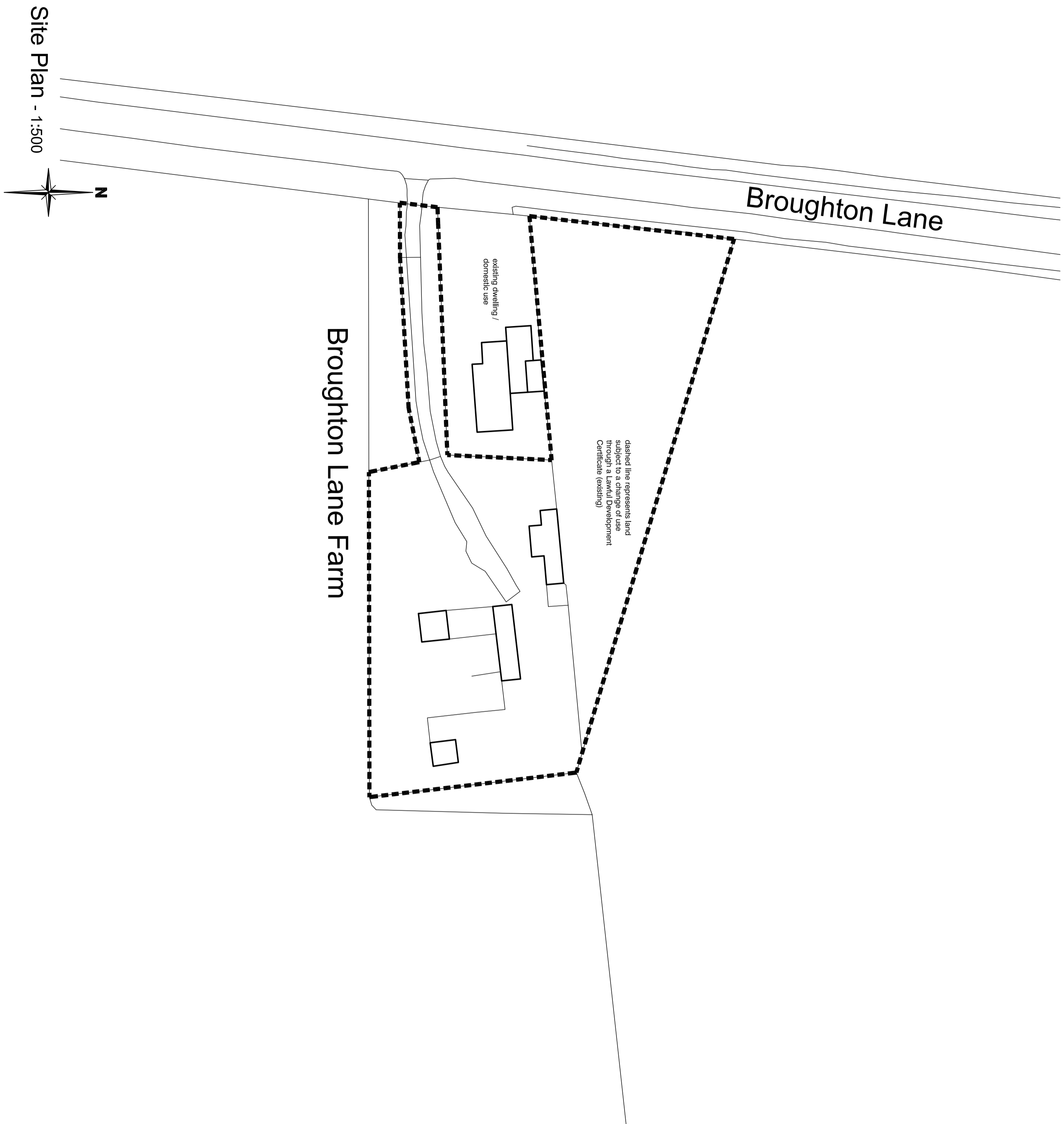

Note:- existing site plan based on OS Plan.

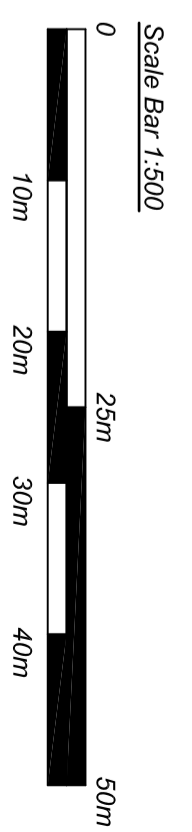

Lawful Development Certificate
drawing status

Proposed Change of Use of
 Agricultural Land to Domestic at
 Broughton Lane Farm, Harmston
 Low Fields for Mr and Mrs T Hill

Site Plan - existing		<small>drawing.</small>
1:500 @ A2	March 2023	<small>date.</small>
466 - H - 2.		<small>drawing no.</small>

Evolution design

architecture ▪ design ▪ planning

The Studio, Woodmans Cottage, Swindepby Road,
 Norton Disney, Lincoln, LN6 9QH
 t : 01522 869489 m : 07596 155845
 e : evolutiondesign@btinternet.com w : evolutiondesign.info

Site Plan - 1:500