



Aluminium Window & Door Systems

aluk.co.uk

Experts in Aluminium

ALUK



Contents

5 By experts	24 Door Systems
6 Why choose aluminium?	26 Luminia S88D Flush Entrance
8 A system for every application	28 Optio S88D Entrance
10 lined, tested and trusted	30 G15118 Commercial Entrance
12 Functionality and flexibility	32 Infinium Sliding
	34 Luminia SC154 LIR & Slide
14 Window Systems	36 Optio B5C94 LIR & Slide
14 Optio S88W Casement	38 Optio B5C94 In-line Sliding
18 Optio S88W ST Heritage	40 Luminia F82 Bi-fold
20 Optio S88W TB Before Turn	42 Optio B5F70 Bi-fold
22 Optio S88W Top Swing Reversible	44 Luminia Veranda
	46 Hardware



BECAUSE WE BELIEVE
COLLABORATION IS KING,
IT'S WHY WE'RE PROUD OF
THE PARTNERSHIPS WE'VE
BUILT WITH FABRICATORS,
INSTALLERS, AND
ARCHITECTS THROUGHOUT
THE US AND BEYOND.

By experts, for experts

It's fair to say we live and breathe aluminum at AluK, from its melting point of 660.32 °C, its vital role in the aerospace industry, to its remarkable low density, there's little we don't know about atomic number 13. More importantly, we're experts at using this versatile metal to create high performance and sustainable window and door systems that surpass the needs of fabricators and installers across the UK.

AluK's expertise in aluminum window and door systems is the result of a long history of innovation and collaboration with our customers. We're proud to be a leading manufacturer of aluminum window and door systems in the UK and beyond.

AluK's expertise in aluminum window and door systems is the result of a long history of innovation and collaboration with our customers. We're proud to be a leading manufacturer of aluminum window and door systems in the UK and beyond.

Pirrell

Russell Yates
AluK Managing Director

Why choose AluK aluminium systems?

For over 30 years, we've been at the forefront of aluminium window and door design.

But why aluminium?

It's lightweight, strong and easy to install.

It doesn't rust or rot, and it's completely recyclable.

It's a long-lasting, durable material that will last for decades.

Design

Without compromising on strength, our aluminium window and door systems are designed to offer your customers the maximum of lightness, allowing bigger glazing and providing greater light into their home.

Our integrated systems are designed for maximum profile and parts, as well as to ensure fast fabrication and a wide range of installation options.

Colour

Access a large spectrum of contemporary and classic colour choices and finishes.

We also offer a range of standard single and dual colour products from stock with our Colour offer.

For full Colour details email info@aluk.co.uk

Security

We understand the importance of security to your customers. That's why all our window and door systems are independently tested to ensure they not only meet current security regulations for new build, but that they're inherently burglar resistant too.

Most of our systems are also certified by PAS 24. Secured by Design and G-secrated accredited.

Thermal efficiency

Our window and door systems offer exceptional U-value performance for both double and triple glazing.

In fact, we were the first company to ever gain an A-rated aluminium double glazed window system in the market.

Performance

Each system includes water and acoustic barriers, and utilises the latest manufacturing technologies and techniques to provide long-term peace of mind.

They also have integrated drainage paths that allow water to pass through the system.

This, combined with the high quality air seals and barriers, ensures they can handle the ever-changing British climate with ease.

Window Energy Ratings (WERs)

Our aluminium window systems are rated for their energy efficiency using the familiar A-G scale. This means homeowners and architects can instantly see which windows to choose.

WERs also affect fabricators, because in order to supply WER

products a fabricator must join an official and recognised scheme.

This is to ensure that manufacturers can prove they have audited processes in place and that the ratings displayed are accurate. As you'd expect, we have our own group scheme at AluK.

This provides members fast-track access to all our WER data, saving them valuable time and effort.

For a more detailed look of the ratings, download our [WER guide](#) at aluk.co.uk

Service excellence

Expert service is key at AluK, so our trained architectural technicians and engineers are always on hand to offer guidance and support from design through to installation.

We also have highly experienced Project Consultants able to help with design, system selection, construction details and project specifications for your specific sector.

AluK Academy

Training is another key service we provide. From CPD and toolbox talks to hands-on guidance at our Academy Centre, we provide a wide range of training options to all our customers.

To find out more simply email training.uk@aluk.com

An AluK system for every application

If there's one thing homeowners, architects, installers and fabricators all have in common, it's the desire for choice. That's why we've created our wide range of aluminium façade systems, which meets the needs of different applications, performance and aesthetic demands.

To make life easy for homeowners, we've created three product ranges based on their individual requirements.

▶ For those looking for the finest sightlines and finest finish, there's our premium Infinium sliding door.

▶ If outstanding quality and strength at a competitive price is desired, the Jamnia range is the obvious choice.

▶ While stylish design and everyday practicality is provided by the Optix range.

From a fabricator and installer perspective, we offer systems that cover everything from heavy duty and light commercial new builds, to large-scale refurbishment projects and residential new builds.

Whatever choice you make, you can be confident that our systems offer the superior performance and quality of aluminium through and through.



Tried, tested and trusted

From trusted favourites to the latest innovations, our comprehensive range of aluminium window and door systems has been designed and developed with fabricators, installers and homeowners in mind at every stage.

Furthermore, every system delivers the aesthetic appeal and exceptional build quality demanded by the industry.

It also goes without saying they've all been tested and certified to the latest standards and accreditations.

These include PAS 24, BS4873, Secured By Design and Qualified for starters. Not to mention ISO 9001. They also hold Q-Plus Certifications for general

performance windows and advanced security windows and doors. Should we go on?

Whichever system you choose, we'll work closely with you to ensure you have all the information you require for successful fabrication and installation.

All the latest structural, thermal and wind calculations are available, as is a comprehensive suite of CAD, HSE Specifications performance and environmental data.

ALWAYS BY 10 FEB 2007





AluK window systems

For over two decades we've been designing unique aluminum window systems that exceed the performance standards expected in modern building design.

AluK operates in the highest standards in terms of quality, durability, energy efficiency, ease of installation and service, with the performance, cost, and flexibility to meet your needs.

An extensive range of components through AluK is available to allow every design, whether commercial or residential, a exceptional.

We understand your business needs, and we offer a range of aluminum window systems and accessories that meet the most stringent security standards.

They also meet the Security by Design standards issued by the UK Association of Chief Police Officers (ASIS) and are approved for the green building.

Functionality and flexibility

We offer a wide range of window frame options that cater for various applications such as infill depths or bay angles.

All our window frames are available in a range of finishes including powder coated, anodised and painted.

Our frames are available in a range of sizes and configurations to suit your project. We also offer a range of options for infill depths and bay angles.

Our frames are available in a range of finishes including powder coated, anodised and painted. We also offer a range of options for infill depths and bay angles.

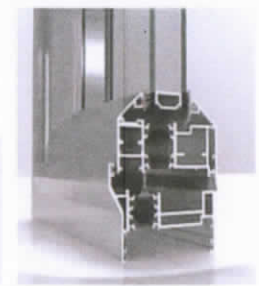
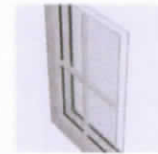

Glazing options

Every project is different, which is why our systems allow for both internal and external glazing options. We also offer glazing options to suit heritage style applications.

Aesthetics

We offer a wide range of internal and external aesthetic styles. Chamfered, Oval, Square or Flush line options can really make any project look modern or traditional. Our double breasted options allow for internal glazing without the use of dummy vents.

DESIGN FEATURES

- ▶ Iron end leg and equal leg to deep head and frame reveals
- ▶ Internal and external glazing options
- ▶ PAS 24 certified
- ▶ Integrated system for maximum profile and pitch
- ▶ Three chamber profile for maximum strength while clamping - achieves perfect corner assembly every time

Openings

All windows are available in a full range of opening options: from open in to open out, side hung, top hung, bottom hung and tilt below turn, to French casement, fixed light and multi-light.



AluK door systems

Engineered to integrate seamlessly with our window system range, our aluminium door systems remain our most popular products and provide unrivalled safety, security and installation simplicity.

Each door system has its own unique feel, offering a range of profiles, depths and glazing area options. AluK designs may offer you a first-class finish and material, but our processes are the real difference. You know our quality. It shows how to look.

In addition to meeting the needs of every application, our doors also support the latest safety, security and glazing area developments.

Our AluK aluminium door systems provide the additional feel and finish that aluminium is the only thing you should.

Optio

58BD Entrance

Available in a wide range of styles and formats, our stylish aluminium entrance door system is suitable for both light and medium-duty use.

Optio 58BD is available in a range of styles and finishes. For more information, visit our website at www.optio.com.au.



DESIGN FEATURES

- ▶ Certified under the Secured By Design scheme
- ▶ Locked to PAS 24
- ▶ Multi-point locking mechanism
- ▶ Designed to incorporate standard and security hardware using the same prep detail
- ▶ Closing feature connects lock and prevents any access to locking points

OPTIONS

- ▶ Glazing 24mm - 40mm
- ▶ 30mm or 70mm frame depth to accommodate varying types of applications
- ▶ Low threshold option for Part M - Building regulation
- ▶ Available in a range of single or dual colour and finished finishes
- ▶ Available for new build or refurbishment projects
- ▶ Available in single or double door configuration

SPECIFICATIONS

Performance & Accreditation	Single open air	Single open wall	Double open air	Double open wall
AS performance	Class 4 (1400 Pa)	Class 4 (1400 Pa)	Class 1 (200 Pa)	Class 2 (300 Pa)
Water penetration	Class 4A (1500 Pa)	Class 7A (2000 Pa)	Class 7A (2000 Pa)	Class 7A (2000 Pa)
Wind resistance	Class A3 (1500 Pa)	Class A2-A0 (2400 Pa)	Class A3-A0 (2400 Pa)	Class A3-A0 (2400 Pa)
Building regulations part L compliance	-	-	-	-
Building regulations part M compliance	-	-	-	-
Building regulations part G compliance	-	-	-	-
U-value (double glazing)	1.7 W/m ² K	1.7 W/m ² K	1.7 W/m ² K	1.7 W/m ² K
U-value (single glazing)	1.4 W/m ² K	1.4 W/m ² K	1.4 W/m ² K	1.4 W/m ² K
Max (EN 14353)	ngd	ngd	ngd	ngd
Smoke (EN 1631-2)	ngd	ngd	ngd	ngd
Security	PAS 24	PAS 24	PAS 24	PAS 24
ISO 9001 certification	Yes	Yes	Yes	Yes
Secured by Design	Yes	Yes	Yes	Yes
Durability (EN 12191) category	30,000 Cycles	30,000 Cycles	30,000 Cycles	30,000 Cycles
Minimum depth				
Units (mm)	30mm and 70mm	30mm and 70mm	Minimum 30mm	Minimum 30mm
Design features				
Thermally broken	-	-	-	-
Low E glazing	-	-	-	-
Panel fix	-	-	-	-
Flexible design - rounded aluminium	-	-	-	-
Signline (steel)	120mm	120mm	120mm	120mm
Signline (CB)	110mm	110mm	110mm	110mm
Signline (Zinc)	120mm	120mm	120mm	120mm
Signline (powder coated)	200mm	200mm	200mm	200mm
Hardware				
Multi-point locking	-	-	-	-
Panel hinges	-	-	-	-
Options				
Single colour	-	-	-	-
Dual colour	-	-	-	-
Finishes	-	-	-	-
Maximum glass and weight				
Maximum glass height	1000mm x 2140mm	1000mm x 2140mm	1000mm x 2140mm	1000mm x 2140mm
Maximum glass self weight	90 kg	90 kg	90 kg	90 kg
Maximum glass thickness	24mm - 40mm	24mm - 40mm	24mm - 40mm	24mm - 40mm

Optio 58BD is available in a range of styles and finishes. For more information, visit our website at www.optio.com.au.

END CASE SECTIONS

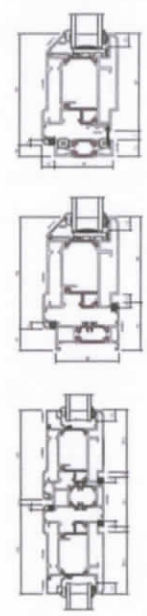

END CONFIGURATIONS

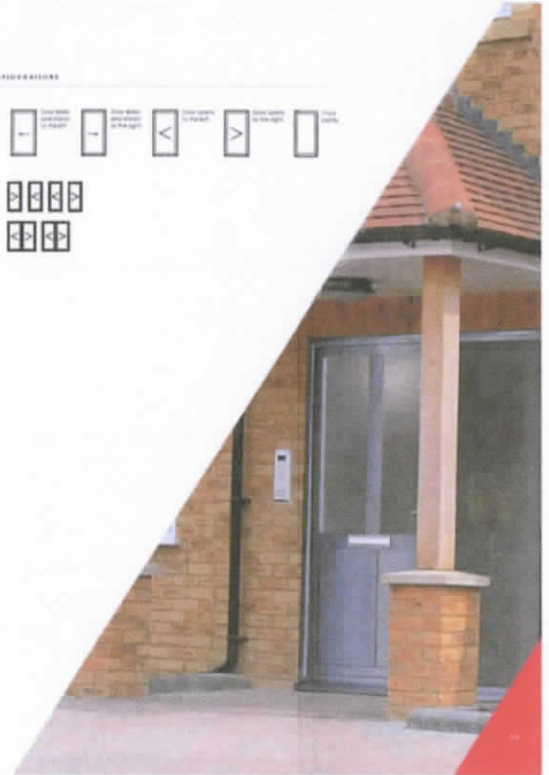
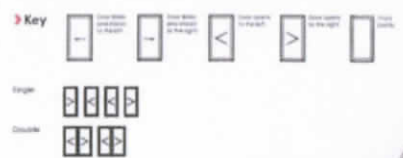

GT55 TB Commercial Entrance

The Optio GT55 thermally broken aluminium commercial door system provides the most comprehensive PAS24 security for single, double door and fixed panel.



KEY CONFIGURATIONS

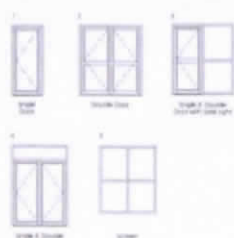

DESIGN FEATURES AND OPTIONS

- ▶ The most comprehensive PAS24 and SED certified system on the market today – panic, mechanical and electric mechanical locking
- ▶ Accepts 32mm – 31mm double or triple glazing
- ▶ Also door leaf (double) 2000mm x 2100mm
- ▶ Also panel weight 110kg
- ▶ Double acting central pivot door open in and out options

PAS 24 SECURITY RATED LOCK

Door Part Ref	Minimum Configuration	INTERNAL DOOR				EXTERNAL DOOR			
		Min (kg)	Max (kg)	Min (kg)	Max (kg)	Min (kg)	Max (kg)	Max (kg)	
KA81 - Panic V Lock	1,2,3,4,5	300	-	1300	2400	300	-	1300	2400
KA55-634 - Corima P500 Panic	1,2,3,4,5	300	-	1300	2400	300	-	1300	2400
KA44-641 - Corima P500 Panic II	1,2,3,4,5	300	-	1300	2400	300	-	1300	2400
KA55-634 - Standard 60 Panic	1,2,3	300	180*	1300	2400	300	-	1300	2400
KA57 - Corima 60 Multi-Point Lock	1,2,3,4,5	300	180*	1300	2400	300	180*	1300	2400

PERFORMANCE

Performance and certification	GT55 TB			GT55 TB			GT55 TB																																																																								
	Single	Double	External	Single	Double	External	Single	Double	External																																																																						
Air permeability (Pa/s)	Class 5 (0 Pa/s)	Class 5 (0 Pa/s)	Class 4 (100 Pa/s)	Class 5 (0 Pa/s)	Class 5 (0 Pa/s)	Class 4 (100 Pa/s)	Class 5 (0 Pa/s)	Class 5 (0 Pa/s)	Class 4 (100 Pa/s)																																																																						
Water tightness (Pa/s)	Class 1A (0 Pa/s)	Class 1A (0 Pa/s)	Class 1A (1400 Pa/s)	Class 1A (0 Pa/s)	Class 1A (0 Pa/s)	Class 1A (1400 Pa/s)	Class 1A (0 Pa/s)	Class 1A (0 Pa/s)	Class 1A (1400 Pa/s)																																																																						
Sound insulation (dB)	Q-marks	Q-marks	Q-marks	Q-marks	Q-marks	Q-marks	Q-marks	Q-marks	Q-marks																																																																						
U value (double glazing) (kg. 1.6 W/m ² K)	1.7 W/m ² K	1.62 W/m ² K	1.62 W/m ² K	1.7 W/m ² K	1.62 W/m ² K	1.62 W/m ² K	1.7 W/m ² K	1.62 W/m ² K	1.62 W/m ² K																																																																						
U value (triple glazing) (kg. 0.7 W/m ² K)	1.72 W/m ² K	1.62 W/m ² K	1.62 W/m ² K	1.72 W/m ² K	1.62 W/m ² K	1.62 W/m ² K	1.72 W/m ² K	1.62 W/m ² K	1.62 W/m ² K																																																																						
3rd party certification	Q-marks	Q-marks	Q-marks	Q-marks	Q-marks	Q-marks	Q-marks	Q-marks	Q-marks																																																																						
Security (EN 1193 category protected)	60,600	60,600	-	60,600	60,600	-	60,600	60,600	-																																																																						
System depth	110 mm	110 mm	110 mm	110 mm	110 mm	110 mm	110 mm	110 mm	110 mm																																																																						
Design features	<table border="1"> <tr><td>Thermally broken</td><td>-</td><td>-</td><td>-</td><td>-</td><td>-</td><td>-</td><td>-</td><td>-</td><td>-</td></tr> <tr><td>Low threshold</td><td>-</td><td>-</td><td>-</td><td>-</td><td>-</td><td>-</td><td>-</td><td>-</td><td>-</td></tr> <tr><td>Anti-rattle strip</td><td>-</td><td>-</td><td>-</td><td>-</td><td>-</td><td>-</td><td>-</td><td>-</td><td>-</td></tr> <tr><td>Upholstery</td><td>140 mm</td><td>170 mm</td><td>50 mm</td><td>140 mm</td><td>170 mm</td><td>50 mm</td><td>140 mm</td><td>170 mm</td><td>50 mm</td></tr> <tr><td>Feature design - single elements</td><td>-</td><td>-</td><td>-</td><td>-</td><td>-</td><td>-</td><td>-</td><td>-</td><td>-</td></tr> <tr><td>Aluminium slip bar</td><td>-</td><td>-</td><td>-</td><td>-</td><td>-</td><td>-</td><td>-</td><td>-</td><td>-</td></tr> <tr><td>Fixed door</td><td>-</td><td>-</td><td>-</td><td>-</td><td>-</td><td>-</td><td>-</td><td>-</td><td>-</td></tr> </table>									Thermally broken	-	-	-	-	-	-	-	-	-	Low threshold	-	-	-	-	-	-	-	-	-	Anti-rattle strip	-	-	-	-	-	-	-	-	-	Upholstery	140 mm	170 mm	50 mm	140 mm	170 mm	50 mm	140 mm	170 mm	50 mm	Feature design - single elements	-	-	-	-	-	-	-	-	-	Aluminium slip bar	-	-	-	-	-	-	-	-	-	Fixed door	-	-	-	-	-	-	-	-	-
Thermally broken	-	-	-	-	-	-	-	-	-																																																																						
Low threshold	-	-	-	-	-	-	-	-	-																																																																						
Anti-rattle strip	-	-	-	-	-	-	-	-	-																																																																						
Upholstery	140 mm	170 mm	50 mm	140 mm	170 mm	50 mm	140 mm	170 mm	50 mm																																																																						
Feature design - single elements	-	-	-	-	-	-	-	-	-																																																																						
Aluminium slip bar	-	-	-	-	-	-	-	-	-																																																																						
Fixed door	-	-	-	-	-	-	-	-	-																																																																						
Accessories	<table border="1"> <tr><td>Multi-point locking</td><td>-</td><td>-</td><td>-</td><td>-</td><td>-</td><td>-</td><td>-</td><td>-</td><td>-</td></tr> <tr><td>Single-point locking</td><td>-</td><td>-</td><td>-</td><td>-</td><td>-</td><td>-</td><td>-</td><td>-</td><td>-</td></tr> <tr><td>Compressed hinges</td><td>-</td><td>-</td><td>-</td><td>-</td><td>-</td><td>-</td><td>-</td><td>-</td><td>-</td></tr> <tr><td>Special hinges</td><td>-</td><td>-</td><td>-</td><td>-</td><td>-</td><td>-</td><td>-</td><td>-</td><td>-</td></tr> <tr><td>Electric mechanical locking</td><td>-</td><td>-</td><td>-</td><td>-</td><td>-</td><td>-</td><td>-</td><td>-</td><td>-</td></tr> <tr><td> Panic call devices (EN 1125)</td><td>-</td><td>-</td><td>-</td><td>-</td><td>-</td><td>-</td><td>-</td><td>-</td><td>-</td></tr> </table>									Multi-point locking	-	-	-	-	-	-	-	-	-	Single-point locking	-	-	-	-	-	-	-	-	-	Compressed hinges	-	-	-	-	-	-	-	-	-	Special hinges	-	-	-	-	-	-	-	-	-	Electric mechanical locking	-	-	-	-	-	-	-	-	-	Panic call devices (EN 1125)	-	-	-	-	-	-	-	-	-										
Multi-point locking	-	-	-	-	-	-	-	-	-																																																																						
Single-point locking	-	-	-	-	-	-	-	-	-																																																																						
Compressed hinges	-	-	-	-	-	-	-	-	-																																																																						
Special hinges	-	-	-	-	-	-	-	-	-																																																																						
Electric mechanical locking	-	-	-	-	-	-	-	-	-																																																																						
Panic call devices (EN 1125)	-	-	-	-	-	-	-	-	-																																																																						
Maximum size & weight	<table border="1"> <tr><td>Maximum door leaf size (mm)</td><td>1600 x 2100</td><td>2000 x 2100</td><td>2000 x 2100</td><td>1600 x 2100</td><td>2000 x 2100</td><td>2000 x 2100</td><td>1600 x 2100</td><td>2000 x 2100</td><td>2000 x 2100</td></tr> <tr><td>Maximum door leaf weight (kg)</td><td>110 kg</td><td>110 kg</td><td>-</td><td>80 kg</td><td>80 kg</td><td>-</td><td>80 kg</td><td>80 kg</td><td>-</td></tr> <tr><td>Maximum glazing thickness (single glazing) (mm)</td><td>600</td><td>600</td><td>4-12</td><td>4-12</td><td>4-12</td><td>4-12</td><td>4-12</td><td>4-12</td><td>4-12</td></tr> <tr><td>Maximum glazing thickness (double glazing) (mm)</td><td>24-40</td><td>24-40</td><td>24-28</td><td>24-28</td><td>24-28</td><td>24-28</td><td>24-28</td><td>24-28</td><td>24-28</td></tr> </table>									Maximum door leaf size (mm)	1600 x 2100	2000 x 2100	2000 x 2100	1600 x 2100	2000 x 2100	2000 x 2100	1600 x 2100	2000 x 2100	2000 x 2100	Maximum door leaf weight (kg)	110 kg	110 kg	-	80 kg	80 kg	-	80 kg	80 kg	-	Maximum glazing thickness (single glazing) (mm)	600	600	4-12	4-12	4-12	4-12	4-12	4-12	4-12	Maximum glazing thickness (double glazing) (mm)	24-40	24-40	24-28	24-28	24-28	24-28	24-28	24-28	24-28																														
Maximum door leaf size (mm)	1600 x 2100	2000 x 2100	2000 x 2100	1600 x 2100	2000 x 2100	2000 x 2100	1600 x 2100	2000 x 2100	2000 x 2100																																																																						
Maximum door leaf weight (kg)	110 kg	110 kg	-	80 kg	80 kg	-	80 kg	80 kg	-																																																																						
Maximum glazing thickness (single glazing) (mm)	600	600	4-12	4-12	4-12	4-12	4-12	4-12	4-12																																																																						
Maximum glazing thickness (double glazing) (mm)	24-40	24-40	24-28	24-28	24-28	24-28	24-28	24-28	24-28																																																																						
Applications	<table border="1"> <tr><td>Home office</td><td>-</td><td>-</td><td>-</td><td>-</td><td>-</td><td>-</td><td>-</td><td>-</td><td>-</td></tr> <tr><td>Exterior entrance</td><td>-</td><td>-</td><td>-</td><td>-</td><td>-</td><td>-</td><td>-</td><td>-</td><td>-</td></tr> <tr><td>Interior commercial</td><td>-</td><td>-</td><td>-</td><td>-</td><td>-</td><td>-</td><td>-</td><td>-</td><td>-</td></tr> </table>									Home office	-	-	-	-	-	-	-	-	-	Exterior entrance	-	-	-	-	-	-	-	-	-	Interior commercial	-	-	-	-	-	-	-	-	-																																								
Home office	-	-	-	-	-	-	-	-	-																																																																						
Exterior entrance	-	-	-	-	-	-	-	-	-																																																																						
Interior commercial	-	-	-	-	-	-	-	-	-																																																																						



INFINIUM Sliding

Infinium brings together indoor and outdoor living spaces in exquisite harmony.

The Infinium system offers a wide range of glazing options, including double and triple glazing, and is available in a range of colours to match your interior or exterior space.

The Infinium system is available in a range of colours to match your interior or exterior space.

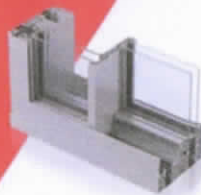

DESIGN FEATURES

- ▶ Sliding door
- ▶ Fully concealed outer-frame
- ▶ 21mm concealed interlock
- ▶ One or more opening panels with large width dimensions up to 3000mm (W) and height dimensions up to 3000mm
- ▶ Holds up to 400kg panel weight

OPTIONS

- ▶ Available in double or triple track
- ▶ Glazing options of 38mm - 52mm
- ▶ Fixing corner post option for larger opening space
- ▶ Single colour available as standard
- ▶ Available in a range of configurations
- ▶ Double or triple glazing options available on the same outer-frame

SPECIFICATIONS

Performance & certifications

Overhead (Double Glazing)	1.2 W/m²K
Overhead (Triple Glazing)	0.9 W/m²K
44 Tightness	Class 4 (A10-P4)
Water Tightness	Class 6A (A10-P6)
Wind Load	Class C2 (1500 Pa up to 160km/h)

Size limits

Max panel weight	400kg
Max panel dimension	3000mm (W) 3000mm (H)

System features

Drain colour option	-
Multi-point locking	-
Glazing options	38mm - 52mm

CAR CROSS SECTION

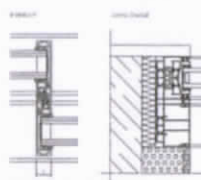

10°

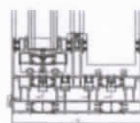

INFINIUM CONFIGURATIONS

▶ Key



The diagrams showed here illustrate some of the configurations achievable with ALUC's Infinium system.

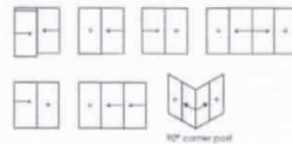

10° corner post



Optio

BSF70 Bi-fold

An intelligent combination of form and function, our highly versatile and market leading Bi-fold sliding door system gives you maximum control over the style and operation of the doors.

Multiple colours can be selected to complement the interior or exterior of your building, with the option to customise the hardware.

The system is available in a range of frame profiles, including slimline, heavy duty and thermal break, to suit your requirements.



KEY FEATURES

- ▶ Certified under the Secured By Design scheme
 - ▶ Tested to PAS 24
 - ▶ Unique, pop-out handle that allows for maximum door opening and panels to stack square
 - ▶ Four stainless steel rollers to ensure smooth and consistent operation
- ### OPTIONS
- ▶ Chamfered and square beaded options
 - ▶ Glazing 28mm - 40mm
 - ▶ Available in a range of opening configurations
 - ▶ Available with heavy duty rollers (BSF70 HD)
 - ▶ Available in a range of single or dual colour and anodised finishes
 - ▶ Low threshold (5mm step height)
 - ▶ All configurations available open in and open out
 - ▶ Chamfered and square beaded options
 - ▶ Shortfalls top and bottom of the infill for enhanced security
 - ▶ Dedicated bottom-brage guide for consistent operation and enhanced security
 - ▶ Double track thresholds allowing greater stability

SPECIFICATIONS

Performance and construction

	BSF70	BSF70 HD
U-value (double glazing)	1.4 W/m ² K	1.4 W/m ² K
U-value (triple glazing)	1.4 W/m ² K	1.4 W/m ² K
Air tightness (Pa)	Class 4 (100 Pa)	NFD
Water tightness (Pa)	Class 4A (500 Pa)	NFD
Wind load (Pa)	Class A3240 (2400 Pa)	NFD
Security	PAS 24	NFD
Self-cleaning certification	Green	NFD
Secured by design	Yes	NFD

Configurations

	Open in and open out	Open in and open out
3-0-0	✓	✓
3-0-1	✓	✓
3-0-2	✓	✓
3-0-3	✓	✓
3-0-4	✓	✓
3-0-5	✓	✓
3-0-6	✓	✓
3-0-7	✓	✓
3-0-8	✓	✓
3-0-9	✓	✓
3-0-10	✓	✓
3-0-11	✓	✓
3-0-12	✓	✓
3-0-13	✓	✓
3-0-14	✓	✓
3-0-15	✓	✓
3-0-16	✓	✓
3-0-17	✓	✓
3-0-18	✓	✓
3-0-19	✓	✓
3-0-20	✓	✓

Weight

	BSF70	BSF70 HD
Max panel weight	100 kg	150 kg
Upright (max)	110 mm	110 mm
Upright (CS)	130 mm	130 mm
Upright (corner)	110 mm	110 mm
Upright (beating tile)	140 mm	140 mm
Maximum leaf height	2400 mm	2400 mm

System features

	BSF70	BSF70 HD
Frame depth	70mm	70mm
Double roller option	✓	✓
Weatherstripping	✓	✓
Drilling options	Internal beaded	Internal beaded
Glazing thickness	24mm - 40mm	24mm - 40mm

GLAZING OPTIONS

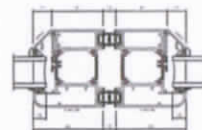
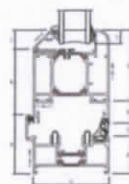

BSF70 is available with a range of glazing options including double and triple glazing, low-E glass, acoustic glass, and laminated glass. The system is also available with a range of frame finishes including anodised aluminium, powder coated aluminium, and stainless steel. The system is designed to be compatible with a range of hardware options including handles, locks, and sensors.

BSF70 CONFIGURATIONS

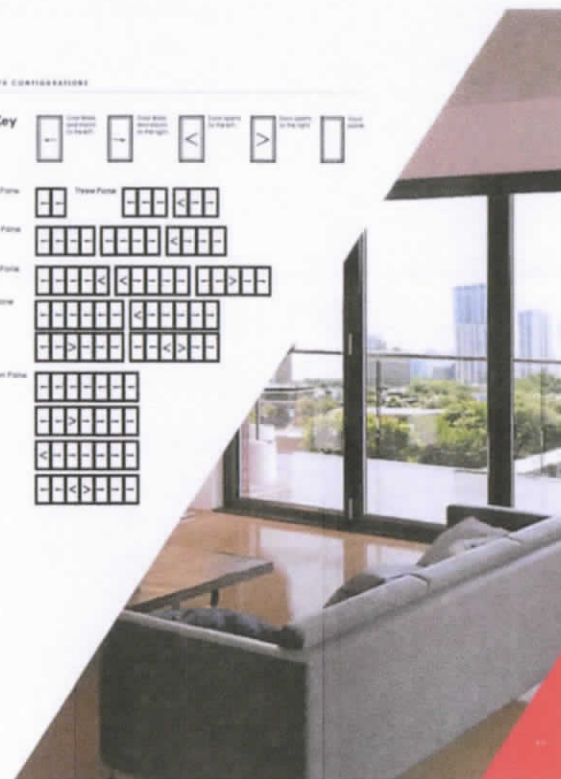

Luminia

Veranda

Our customers can now enjoy longer sunshine seasons, brighter spaces and more late night fresh air while remaining sheltered and protected at all times.

As part of the Luminia system, you can benefit from the same high-quality aluminium construction and the same level of safety and security as our other products.



PREMIUM TYPE 1

Use of A&U design: this Luminia system is inherently strong and needs little maintenance. The system also features thermal breaks, giving you the freedom to transform the veranda into an insulated living space.



MODERN TYPE 2

Our most contemporary veranda: this system boasts a slimmer aesthetic. It's a perfect example of form embracing function.



ENHANCED TYPE 4

The most robust veranda in our range: this upgraded design is ideal if you're looking for extra strength and a brighter outdoor space. Thanks to additional steel reinforcement this system can stretch an impressive 60 metres in width with the support of only two posts. *We also offer a Victorian style gutter for the type 4.



DESIGN FEATURES

- ▶ Full aluminium system
- ▶ 3 different design options
- ▶ Large open – up to 6m
- ▶ Hidden water drainage and flange
- ▶ Optional sliding doors and walls
- ▶ 5 styles colours
- ▶ Polycarbonate or glass glazing options

LUMINIA VERANDA

Specifications	Type 1	Type 2	Type 4
Thermal break	Yes	Yes	Yes
Rafter width (mm)	54	54	54
Concealed drainage	Yes	Yes	Yes
Optic EBCA integration	Yes	Yes	Yes
Luminia glass sliding door integration	Yes	Yes	Yes
Veranda post	Yes	Yes	Yes
Rooflight profile	Yes	Yes	Yes
Post depth (mm)	193	173	200
Wall plate (mm)	210	170	170
4 metres span with no central post	Yes	Yes	Yes

*Maximum length is 60 metres. **Minimum span is 2 metres.

Optio

58BW Casement

Built to the highest UK standards, this effective and high performance solution offers clean lines and advanced functionality.

For a full list of Optio window and door products, visit www.balfourbeatty.com. For more information, contact your local sales representative or visit www.balfourbeatty.com.



KEY FEATURES

- ▶ Certified under the Secured by Design scheme
- ▶ Tested to PAS 24
- ▶ Green guide rated A
- ▶ Integrated deep head profile for ease of visible ventilation
- ▶ Unique polyamide thermal break design to improve thermal performance

OPTIONS

- ▶ 58mm or 70mm frame depth to accommodate varying types of application
- ▶ Project in or project out options
- ▶ Internally or externally glazed to accommodate low and high rise projects
- ▶ Glazing System – 48mm
- ▶ Available in a range of single or dual colour and anodised finishes
- ▶ Available in the following profiles: top, Chamfered, Square and Oval
- ▶ Available in the following configurations: top hung, side hung, bottom hung, fixed light, multi-light and french casement
- ▶ Available for Lifetime Homes (LTH)
- ▶ Double beaded option allowing for internal glazing without the use of dummy vents
- ▶ Dedicated fixing steps for ease of installation
- ▶ Designed with a flange groove to accommodate standard locking hardware



▶ Top hung



▶ Side hung



▶ Bottom hung

PERFORMANCE

Performance and certification	Minimum opening
U-value (double glazing)	1.4 W/m ² K
U-value (triple glazing)	1.0 W/m ² K
Window energy rating (WER)	B+ C
Green guide rating	A rated
Acoustic performance (dB)	40 (CEN 42 53-4) 48
air tightness (Pa)	Class 4 (100 Pa)
water tightness (Pa)	Class 4A (100 Pa)
wind load (Pa)	Class E340 (240 Pa)
Security	PA4 2+
ISO 9001 certification	Secured
Secured by Design	Yes

CONFIGURATION

Configuration	Open out
Casement	Open out
Top hung	✓
Side hung	✓
Bottom hung	✓
Fixed light	✓
Multi-light	✓
French casement	✓

MAXIMUM

Top hung (max weight)	100 kg
Side hung (max weight)	25 kg
Bottom hung (max weight)	40 kg (110kg)
Fixed light (max weight)	200 kg

EXTRUSION FINISHES

Extrusion finishes	58mm and 70mm
Frame depth	58mm and 70mm
Dual colour option	✓
Multi-colour finishing	✓
Glazing options	Internal and external beaded
Glazing thickness	24mm + 48mm
Uprights (frame to vent)	70mm
Uprights (vent to handle)	48mm
Uprights (fixed light)	45mm

ANODISING

800	✓
ChromHeat	✓
Square	✓
Oval	✓

Optio is a registered trademark of Balfour Beatty Windows and Doors. All other trademarks are the property of their respective owners. © 2018 Balfour Beatty Windows and Doors. All rights reserved.

CAN CROSS SECTIONS

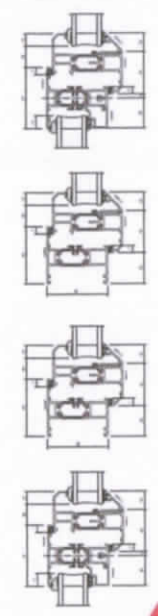

Optio

58BW ST Heritage

The look of steel, the benefits of aluminium. A win-win for designers and homeowners alike.

For more information visit www.vokroll.com/58bw-st-heritage or contact your local sales representative.

For more information visit www.vokroll.com/58bw-st-heritage or contact your local sales representative.



DESIGN FEATURES

- ▶ Certified under the Secured by Design scheme
- ▶ Tested to PAS 24
- ▶ Green guide rated A
- ▶ Integrated deep fixed profiles for ease of trickle ventilation
- ▶ Unique polyamide thermal break design to improve thermal performance
- ▶ Slim sightlines to match existing steel windows
- ▶ Internally beaded for ease of glazing on highrise projects

FEATURES

- ▶ 28mm or 32mm frame depth to accommodate varying types of applications
- ▶ Internally or externally glazed
- ▶ Glazing 28mm – 32mm
- ▶ Available for Lifetime Homes (LTH)
- ▶ Available in a range of single or dual colour and anodised finishes
- ▶ Available in the following aesthetics: Beveled Edge, Square and Putty Line
- ▶ Available in the following configurations: top hung, side hung, bottom hung, fixed light, multi-light and French casement
- ▶ Double headed option allows for internal glazing without the use of slurry vents
- ▶ Accommodates standard hardware



▶ Square



▶ Putty Line



▶ Beveled Edge

PERFORMANCE

Performance with accreditation	Minimum requirement
U-value (double glazing)	1.4 U-value
U-value (triple glazing)	1.2 U-value
Window energy rating (WER)	A - B
Green guide rating	A rated
Airtightness (Pa)	≤ 0.015 @ 10Pa @ 10Pa
Acoustic performance (Pa)	Class 4 (20Pa Pa)
Water tightness (Pa)	Class PA 100 (Pa)
Wind load (Pa)	Class C140 (2400 Pa)
Security	PAS 24
3rd party certification	GreenSpec
Secured by Design	Yes

CONFIGURATION

Configuration	Open out
Top hung	✓
Side hung	✓
Bottom hung	✓
Fixed light	✓
Multi-light	✓
French casement	✓

MAX WEIGHT

Top hung (max weight)	30 kg
Side hung (max weight)	24 kg
Bottom hung (max weight)	40 kg (2 hinges)
Fixed light (max weight)	500 kg

SYSTEM OPTIONS

Frame depth	28mm and 32mm
Dual colour option	✓
Multi-point locking	✓
Glazing options	Internal and external
Glazing thickness	28mm - 32mm
Sightline (Frame to vent)	48mm
Sightline (vent to slurry)	81mm
Sightline (Fixed light)	48mm

AVAILABILITY

Putty Line	✓
Beveled Edge	✓
Square	✓

For more information visit www.vokroll.com/58bw-st-heritage or contact your local sales representative.

GLAZING OPTIONS

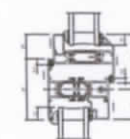
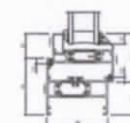
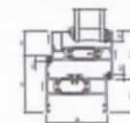
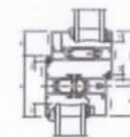

Optio

58BW Top Swing Reversible

Easy to clean and effortless to operate, our ever-popular top swing reversible windows increase thermal performance, improve safety and exceed modern building design performance standards.

Available in a range of finishes, including our popular white, grey and black. Also available in a range of colours to match your building's exterior. For more information, visit www.victoriamulti.co.uk



KEY FEATURES

- ▶ Certified under the Secured by Design scheme
- ▶ Tested to PAS 24
- ▶ Green guide rated A
- ▶ Integrated deep head profile for ease of mobile ventilation
- ▶ Unique polyamide thermal break design to improve thermal performance
- ▶ A clean, flat appearance to give a true contemporary aesthetic
- ▶ Design allows the windows to be pivoted without intruding the internal building line

OPTIONS

- ▶ Glazing 24mm – 28mm
- ▶ Available in a range of single or dual colour and anodised finishes
- ▶ Available in the following aesthetic finishes: Contemporary and Channeled
- ▶ Available in the following configurations: top swing, side swing, fixed light and multi-light
- ▶ Dedicated fixing steps for ease of installation
- ▶ Full range of customisable hardware available

SPECIFICATIONS

Performance & accreditation	Default setting
U-value (double glazing)	1.7 (w/m ² ·K)
Green guide rating	A rated
A1 lightweight (Pa)	Class A1 (100 Pa)
Water tightness (Pa)	Class A1 (100 Pa)
Wind load (Pa)	Class A1 (100 Pa)
Security	PAS 24
Self-purge certification	Green
Secured by design	Yes

Configuration	Open out
Opening	Open out
Top swing	-
Side swing	-
Fixed light	-
Multi-light	-

Size limits	
Top swing (max weight)	40 kg
Side swing (max weight)	44 kg
Fixed light (max weight)	280 kg

System details	
Frame depth	58mm
Draft excluder option	-
Self-cleaning coating	-
Glazing options	Standard
Glazing thickness	24mm – 28mm
Lightline (frame to head)	102mm
Lightline (frame to sill/side)	142mm

Materials	
Frame	-
Contemporary	-
Square	-

GLAZING SECTIONS

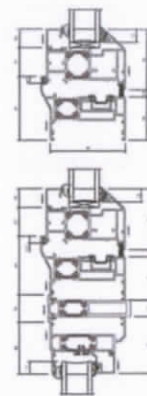

© 2018 Victoria Multi-paned Windows Ltd. All rights reserved. This document is the property of Victoria Multi-paned Windows Ltd. and is not to be distributed, copied, or reproduced in any form without the prior written consent of Victoria Multi-paned Windows Ltd. For more information, visit www.victoriamulti.co.uk

Luminia

F82 Bi-fold

A contemporary, stylish bi-folding door with 98% better sightlines and interlock of 122mm that provide larger glazing panels without compromising on performance.

For more information, visit our website www.balfordbeal.com or contact your local representative. For more information, visit our website www.balfordbeal.com or contact your local representative.



DESIGN FEATURES

- ▶ Redesigned full pop-out handle
- ▶ Unique traffic door
- ▶ HD composite rollers or standard
- ▶ 4 stainless steel rollers
- ▶ Both frame and sill glazing of 11mm
- ▶ All configurations available open in and open out

OPTIONS

- ▶ Chamfered and square bevel options
- ▶ Glazing 18mm-54mm
- ▶ Available in a range of opening configurations
- ▶ Available in a range of single or dual colour and anodised finishes
- ▶ All configurations available open in and open out
- ▶ Chamfered and square bevel options

SPECIFICATIONS

Performance and availability

	F82	F82 HD
U-value (double glazing)	1.4 W/m ² K	1.3 W/m ² K
U-value (triple glazing)	1.0 W/m ² K	1.1 W/m ² K
Air tightness (F1)	NFD (testing June 2017)	NFD (testing June 2017)
Water tightness (F2)	NFD (testing June 2017)	NFD (testing June 2017)
Wind load (F3)	NFD (testing June 2017)	NFD (testing June 2017)
Security	NFD (testing June 2017)	NFD (testing June 2017)
ISO 9001 certification	NFD (testing June 2017)	NFD (testing June 2017)
Secured by design	NFD (testing June 2017)	NFD (testing June 2017)

Configurations

Opening	Open in and open out	Open in and open out
2-0-0	✓	✓
3-0-0	✓	✓
3-0-1	✓	✓
4-0-0	✓	✓
4-0-1	✓	✓
4-0-2	✓	✓
4-0-3	✓	✓
4-0-4	✓	✓
4-0-5	✓	✓
4-0-6	✓	✓
4-0-7	✓	✓
4-0-8	✓	✓
4-0-9	✓	✓
4-0-1	✓	✓

Design features

	F82	F82 HD
Max unit weight	130 kg	130 kg
Upright (max)	87 mm	87 mm
Upright (min)	87 mm	87 mm
Upright (max)	87 mm	87 mm
Upright (max)	122 mm	122 mm
Maximum leaf height	2400 mm	2400 mm

System features

	F82	F82 HD
Frame depth	80 mm	80 mm
Dark colour option	✓	✓
Multi-point locking	✓	✓
Glazing options	Internal bevel	Internal bevel
Glazing thickness	18 mm-24 mm	18 mm-24 mm

LOW CROSS SECTIONS

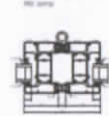
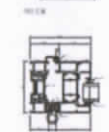
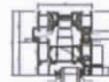

F82 CONFIGURATIONS

Key

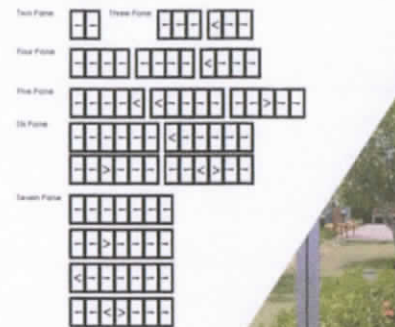

For more information, visit our website www.balfordbeal.com or contact your local representative. For more information, visit our website www.balfordbeal.com or contact your local representative.

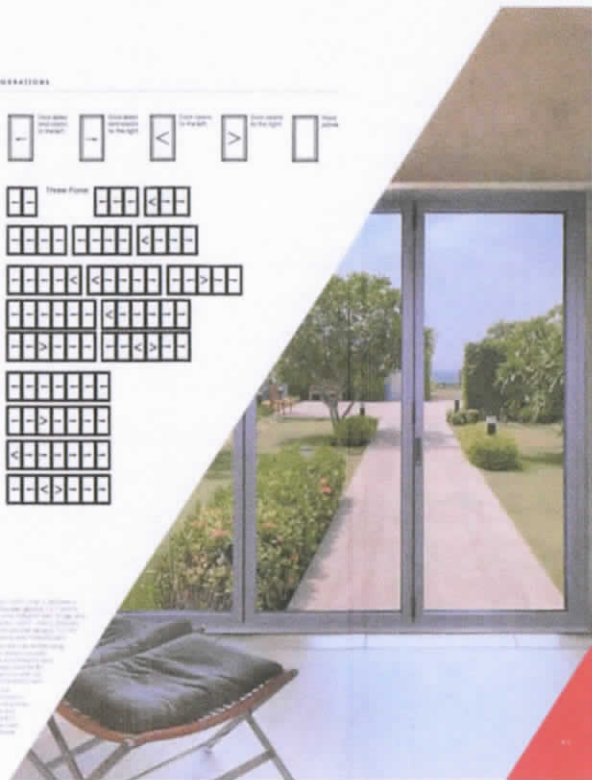

T: 01291 639 739
E: info@aluk.co.uk

Registered Office:
Aluk (GB) Ltd
Newhouse Farm Ind Est
Chepstow
NP16 6UD

Registered Number:
02881320

aluk.co.uk

Experts in Aluminium

ALUK