

Pos. F82 bi-fold, Quantity: 1
 Job: Dean Pearce - LPA heritage
 System: AluK GB F82 Rebated Frame Open Out Square (Push In Gasket) HI
 Exterior View

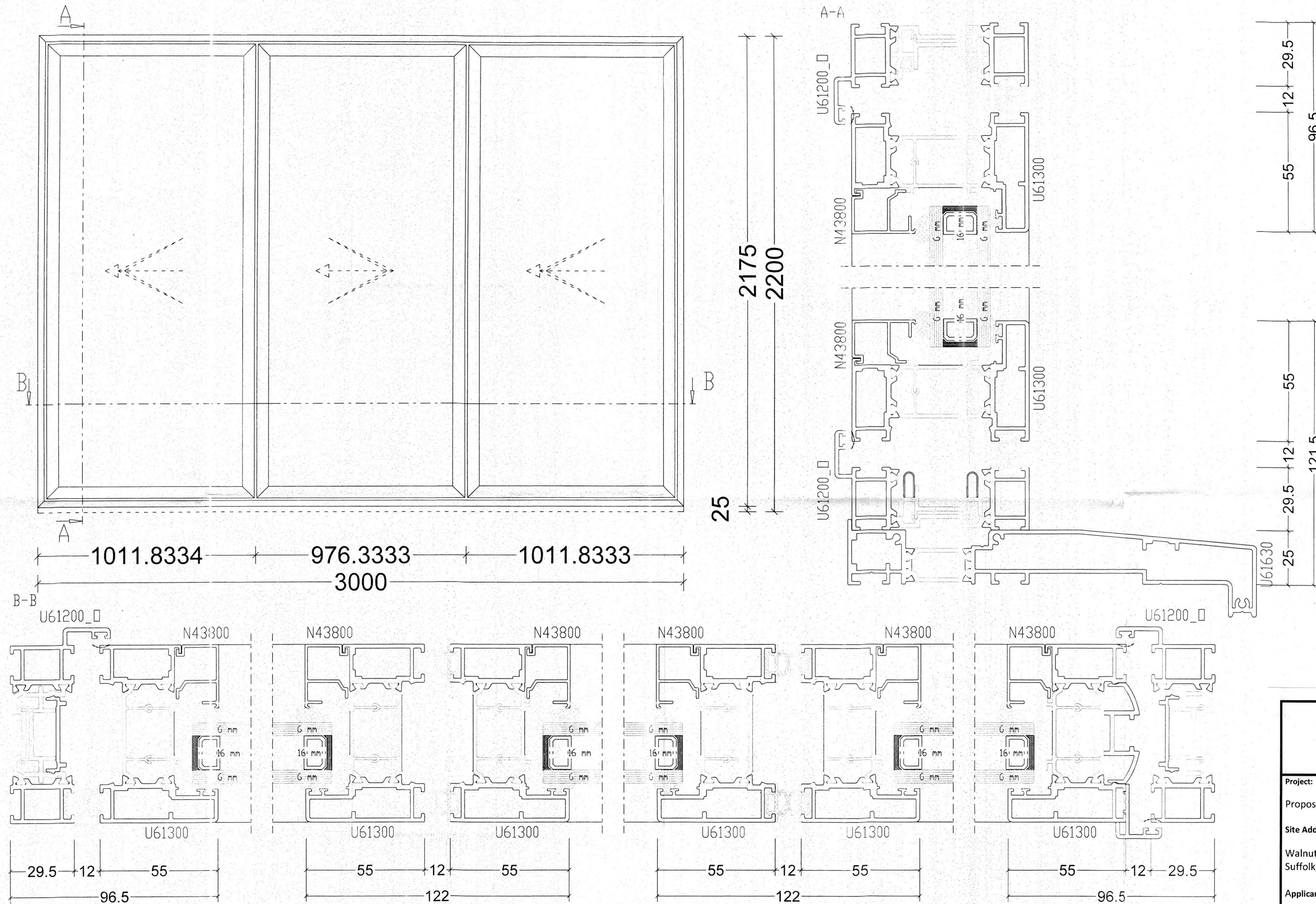

<p>dean jay pearce architectural design & planning ltd 2 / 3 Milestone, Hall Street, Long Melford Sudbury, Suffolk, CO10 9HZ T: 01787-378797 E: dean.pearce@live.co.uk</p>	
<p>Project: Proposed single-storey extension and alterations</p>	
<p>Site Address: Walnut Tree Cottage, Sherbourne Street, Edwardstone, Suffolk, CO10 5PD</p>	
<p>Applicant: Mr S Douglas</p>	
<p>Drawing title: ADDITIONAL FENESTRATION DETAILS- DOORS 2 & 3 - RAL 7016/ P.C. ALUMINIUM</p>	
<p>scales: 1: 1 date: 04 / 2020 drawn: checked:</p>	<p>drg no: 19/011/07 rev:</p>
<p><small>Do not scale this drawing. Use figured dimensions only. Contractor to set out all of the works prior to commencement and report any omissions / discrepancies immediately. Scales shown on this drawing are at A1 sheet size.</small></p>	
<p><small>This drawing & information are Copyright.</small></p>	