

EXISTING internal elevation

- red feltors with s/s mesh and render over
- oak 260x230 chamfered timber floor beam
- modern architrave and internal door

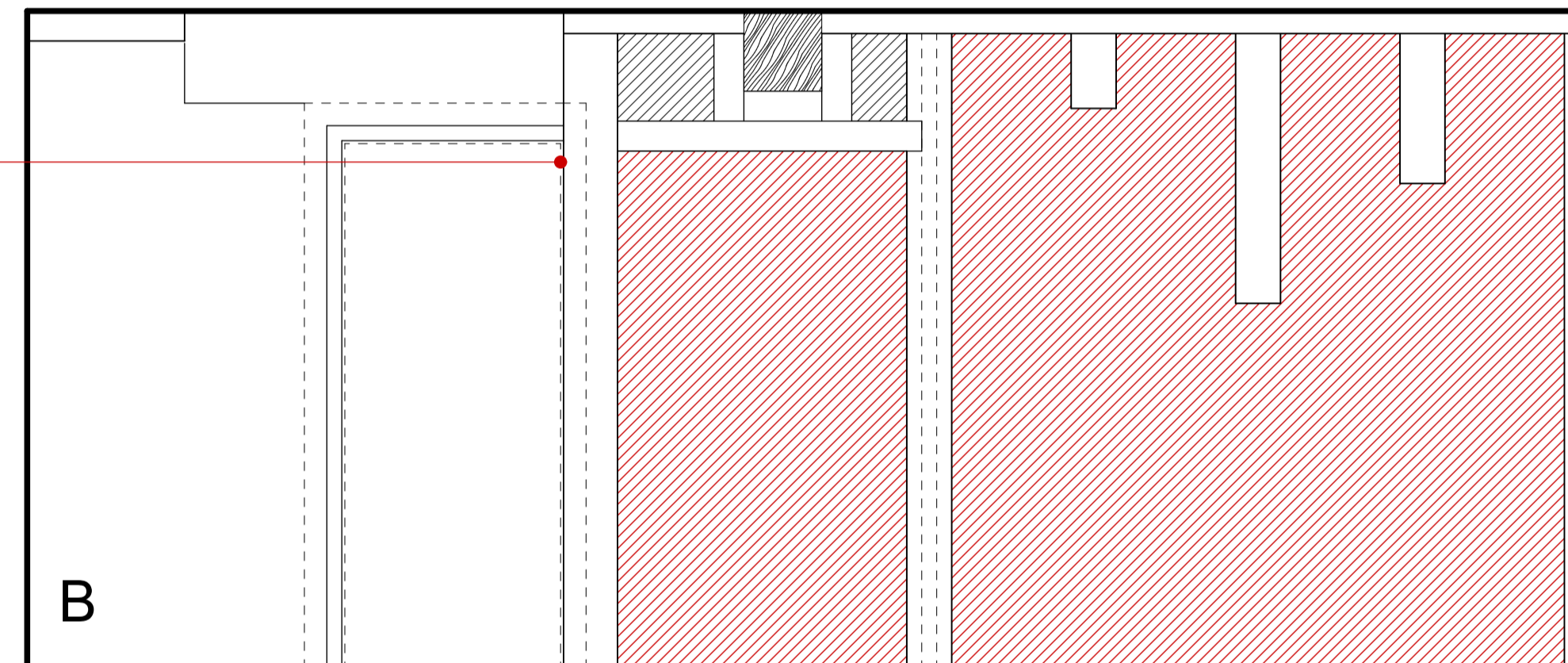
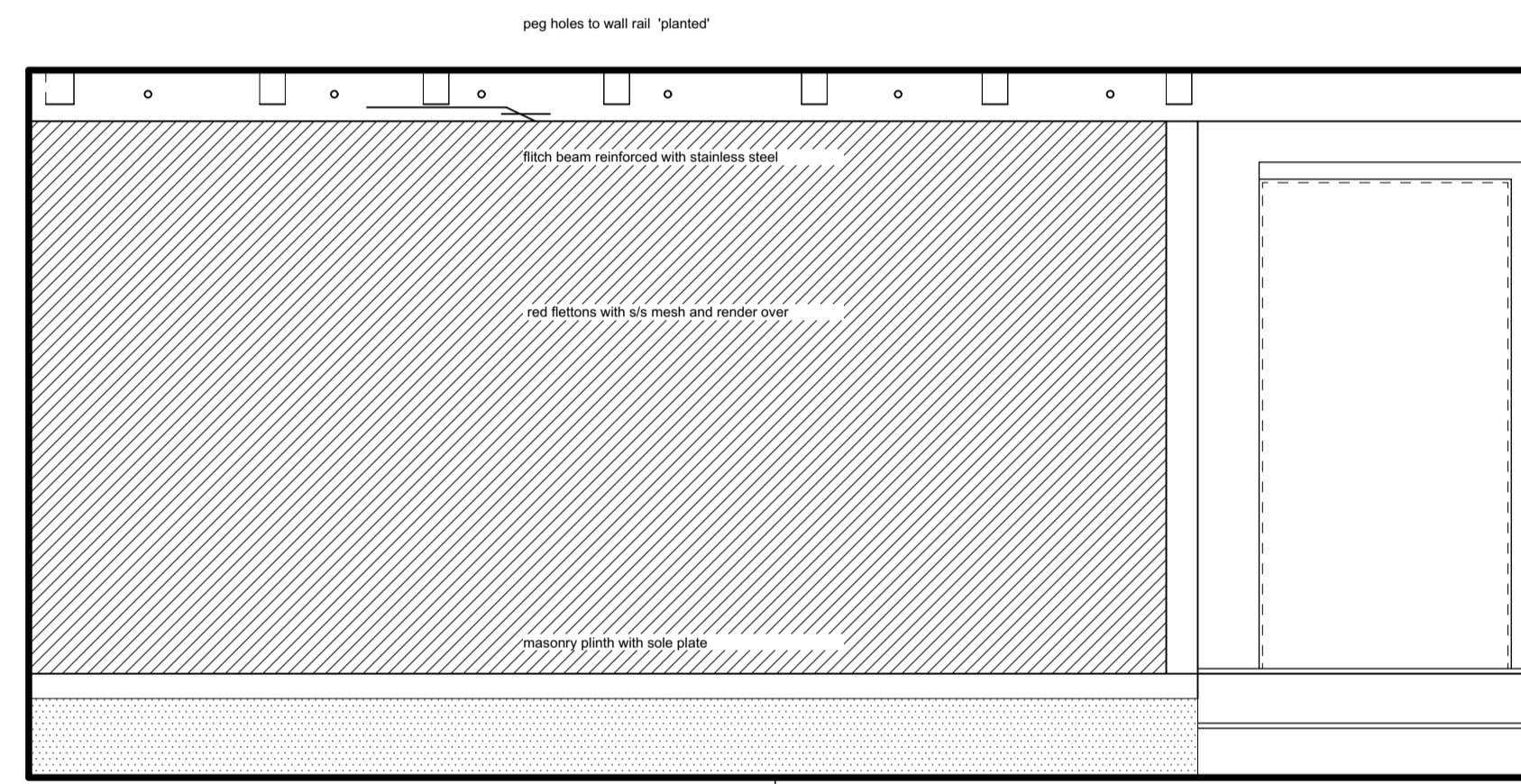

EXISTING internal elevation - fabric to be removed

- to be removed
- oak 260x230 chamfered timber floor beam
- modern architrave and internal door

It is proposed that the timber frame is repaired and reinstated with the following method statement for the works proposed:

- Insert temporary support needles to carry the existing wall and to support the existing floor beams.
- Remove the existing brickwork wall structure to kitchen floor level (side B).
- Insert timber plate along length of wall
- Insert new vertical studs @ some 400mm centres along the length of the removed walling including vert support studs under the existing beam bearings.
- Insert half height timber noggings between each vertical stud.

A

EXISTING internal elevation

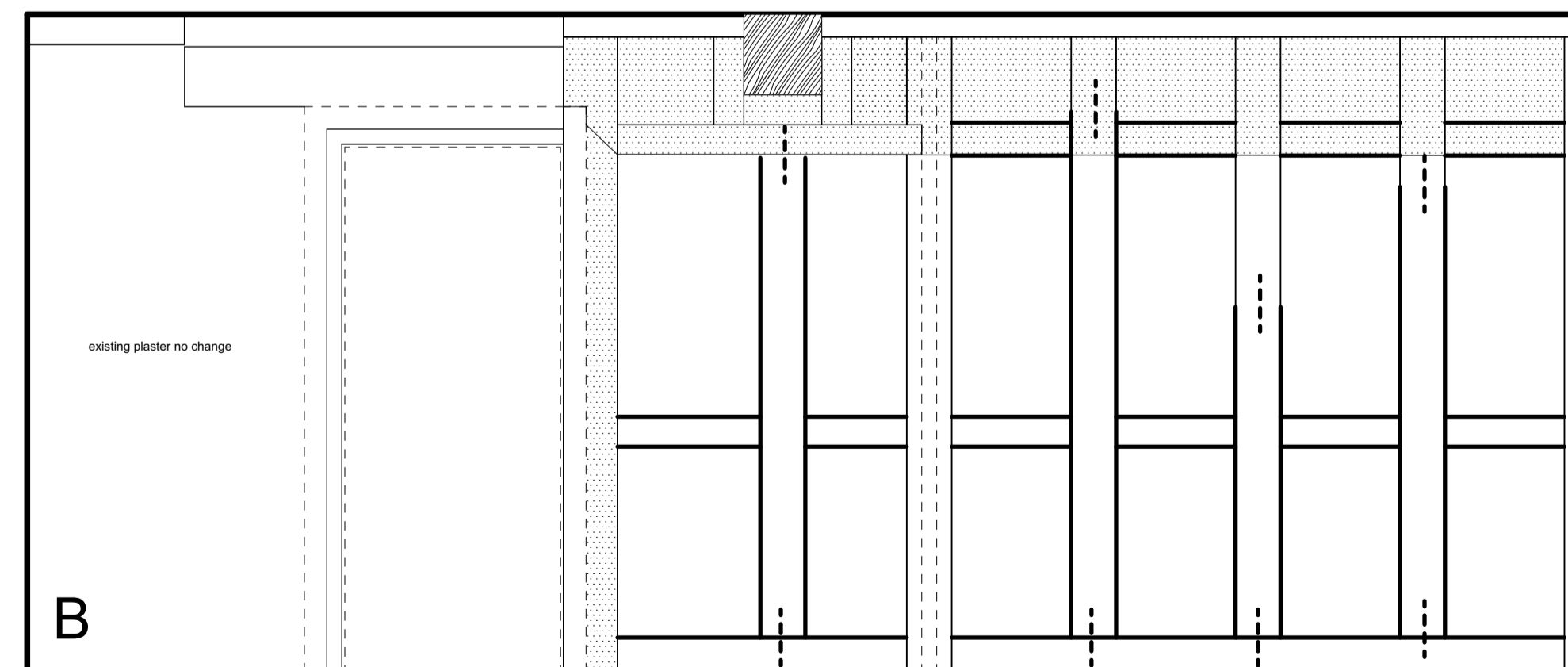
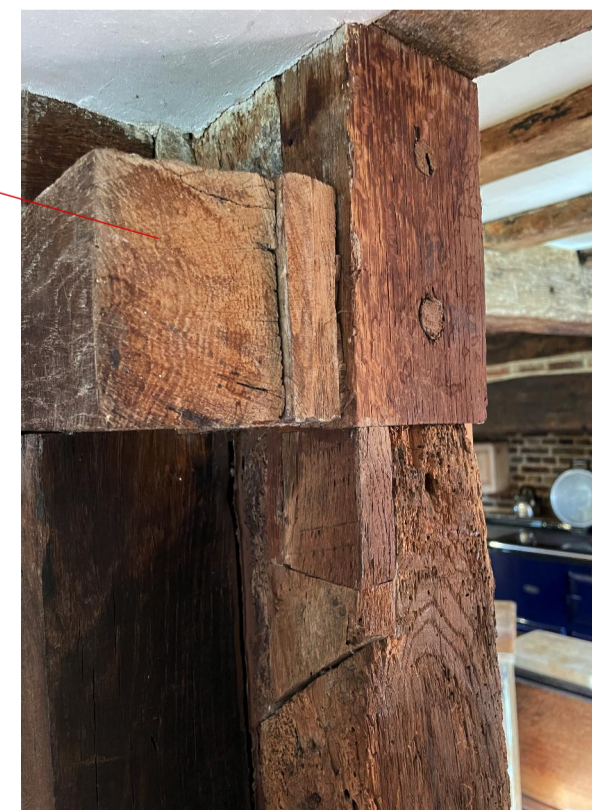
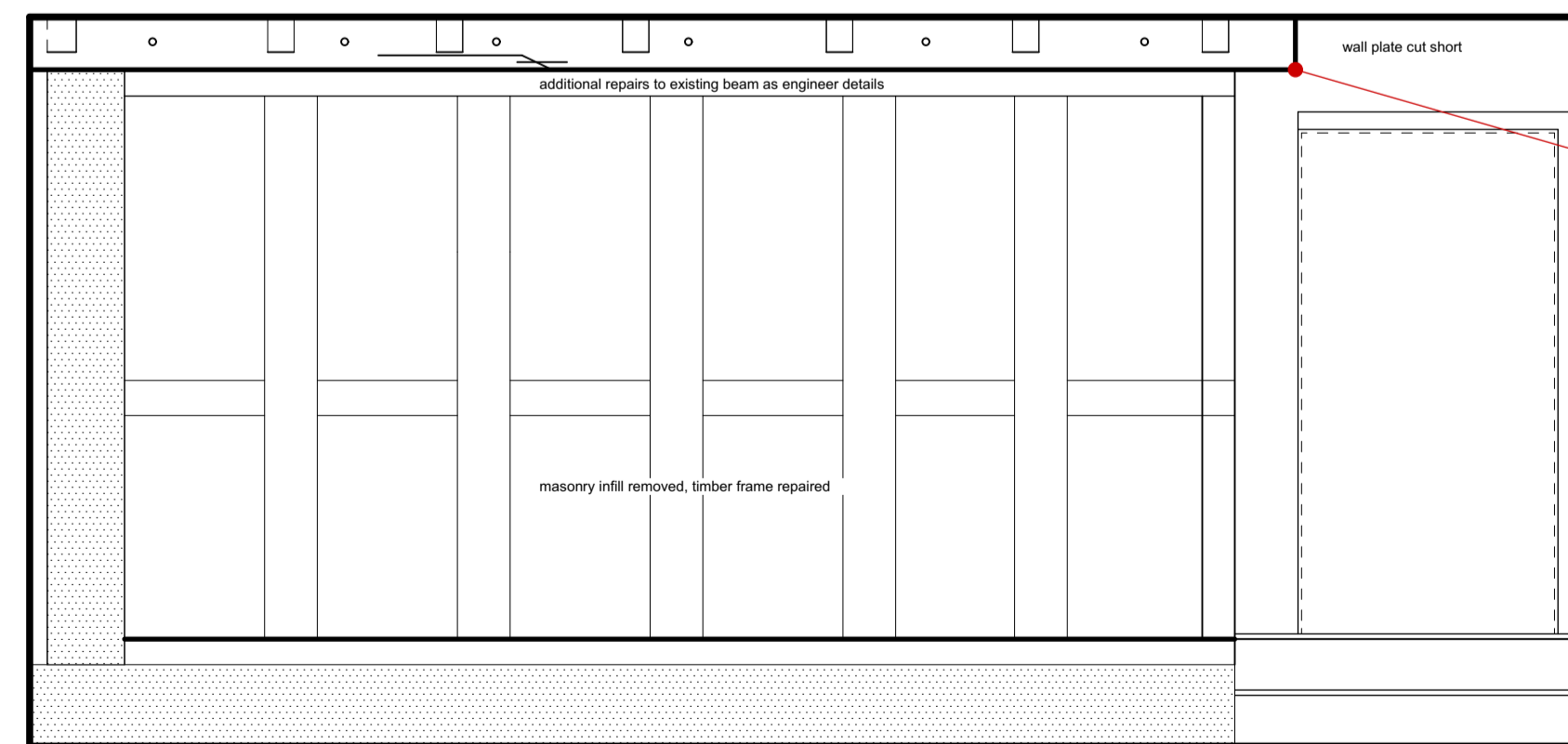

PROPOSED internal elevation - fabric to be repaired / reinstated

- lime plaster - to match existing
- oak 260x230 chamfered timber floor beam
- modern architrave and internal door

A

PROPOSED internal elevation

notes

revisions

project
Barfords
Donkey Lane, IP29 4QU
drawing
Schedule of Repair

scale
1:20@A1
date
23.04.23
number/revision
2360_04 drawn
sjs