

STATUTORY DECLARATION

I, Torquil Silvanus Matthew Septimus Riley-Smith of Knights Farm Barn, Colne Engine, Halstead in the County of Essex MAKE this solemn Declaration conscientiously believing the same to be true and by virtue of the provisions of the Statutory Declarations Act 1835.

1. I am very familiar with Waldergrave Farm, Hartest and the building shown hatched black on the attached plan.
2. I am a friend of the owners and have visited on many occasions.
3. I can confirm that the owners, William Michell Luttmann-Johnson and Lucilla Jane Luttmann-Johnson converted the building into living accommodation for their parents in November 2002. It has been used by David and Vanessa Adams as their sole and permanent dwelling since August 2003.

I understand that a person who intentionally makes a false statement in a statutory declaration is guilty of an offence under section 11 of the Statutory Declarations Act 1959, and I believe that the statements in this declaration are true in every particular.

DECLARED

At *Sudbury*.

In the County of Suffolk

This *31st* day of *March* 2023.

Before me,

S 

SMUR
Solicitor

WILLIAMS & STATHWATE
Solicitors
27 PRIARS STREET
SUDBURY, SUFFOLK CO10 2AD

From: **william luttman-johnson** wiluttmanjohnson@gmail.com
Subject: Fwd: Statuary Declarations
Date: 27 March 2023 15:57
To: **william michell luttman-johnson** wiluttmanjohnson@gmail.com

WL

Begin forwarded message:

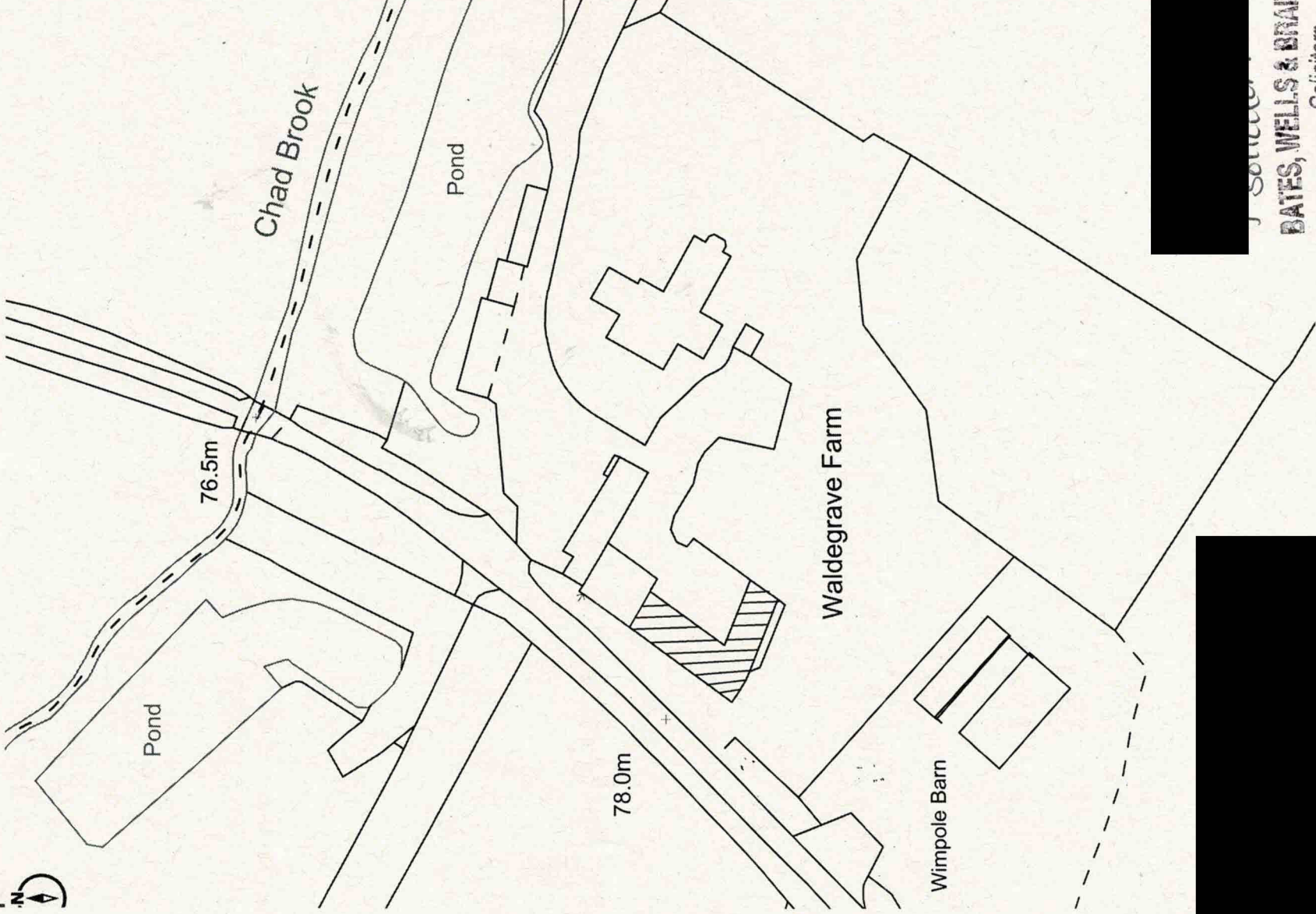

[Redacted]

[Redacted]

DATES, WELLS & BRATHWAITE

Solicitors

27 FRIARS STREET
SUDBURY, SUFFOLK CO10 2AD
31/03/2023