

J.P. CHICK & PARTNERS LTD
 IA23 / 047 - SMO IA
 G/F FLOOR STRUCTURAL G.A.
 DES: GUR LTD



REVA - STRUCTURAL MEMBERS
 SHOWN FOR PRICING
 PURPOSES ONLY.

EXISTING RAFTERS
 TBC ON SITE.
 IF REQ, PROVIDE 50x150
 C24 @ 400mm CS.

FLOOR AREAS
 (gross internal)
 Sales Area 198 sq m
 2,131 sq ft

- Key:
- B₁ - 254 x 254 x 89 UC (Grs355)
 - B₂ - 2No 203 x 203 x 60 UC (Grs355)
 - B₃ - 2No 203 x 203 x 52 UC (Grs355)
 - C₂ - 2No 200 x 90 x 30 PFC (Grs355)
 - C₃ - 2No 200 x 90 x 30 PFC (Grs355)
 - C₄ - 152 x 152 x 37 UC (Grs355)
 OR
 168.3 x 6.3 CHS (Grs355)
 - R_{B1} - 254 x 146 x 43 UB (Grs355)
 - PS₁ - 440 LONG x 100mm WIDE
 x 215mm DEEP CLASS B
 ENGINEERING BRICK
 PADSTONE.
 - L₁ - 2No BHD100 CATNIC
 HEAVY DUTY BOX LINES.

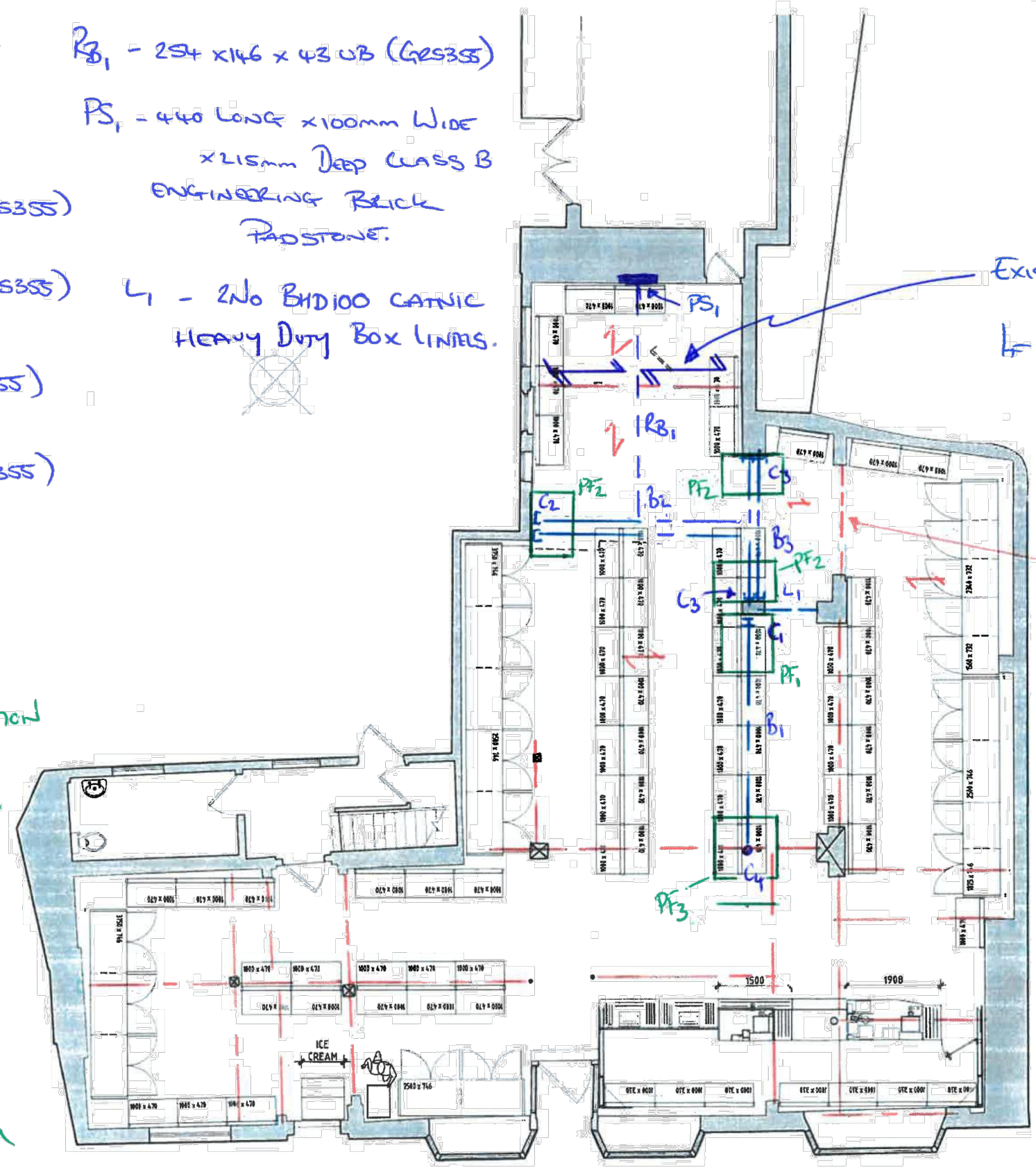

- PF₁ - 1m x 1m GEN 3 PAD FOUNDATION
 - PF₂ - 0.8m WID x 1.2m LONG GEN 3
 PAD FOUNDATION
 - PF₃ - 1.2m x 1.2m GEN 3
 PAD FOUNDATION.
- PAD FOUNDATIONS TO BE
 MIN 1m DEEP. OVERALL
 DEPTH TBC BY BUILDING
 CONTROL.

