

KEY	
	INDICATES DIRECTION OF FLOOR SPAN OVER
	INDICATES DIRECTION OF ROOF MEMBERS OVER
	JOINT "A" INDICATES LOCATION OF MOVEMENT JOINT IN MASONRY
	INDICATES LINE OF STRUCTURE OVER
	INDICATES LINE OF DEMOLISHED WALL
	INDICATES LINE OF NON LOAD BEARING PARTITION
	INDICATES 4.2 N/mm ² M.D. (iii) BLOCKWORK
	INDICATES 7.3 N/mm ² M.D. (iii) BLOCKWORK

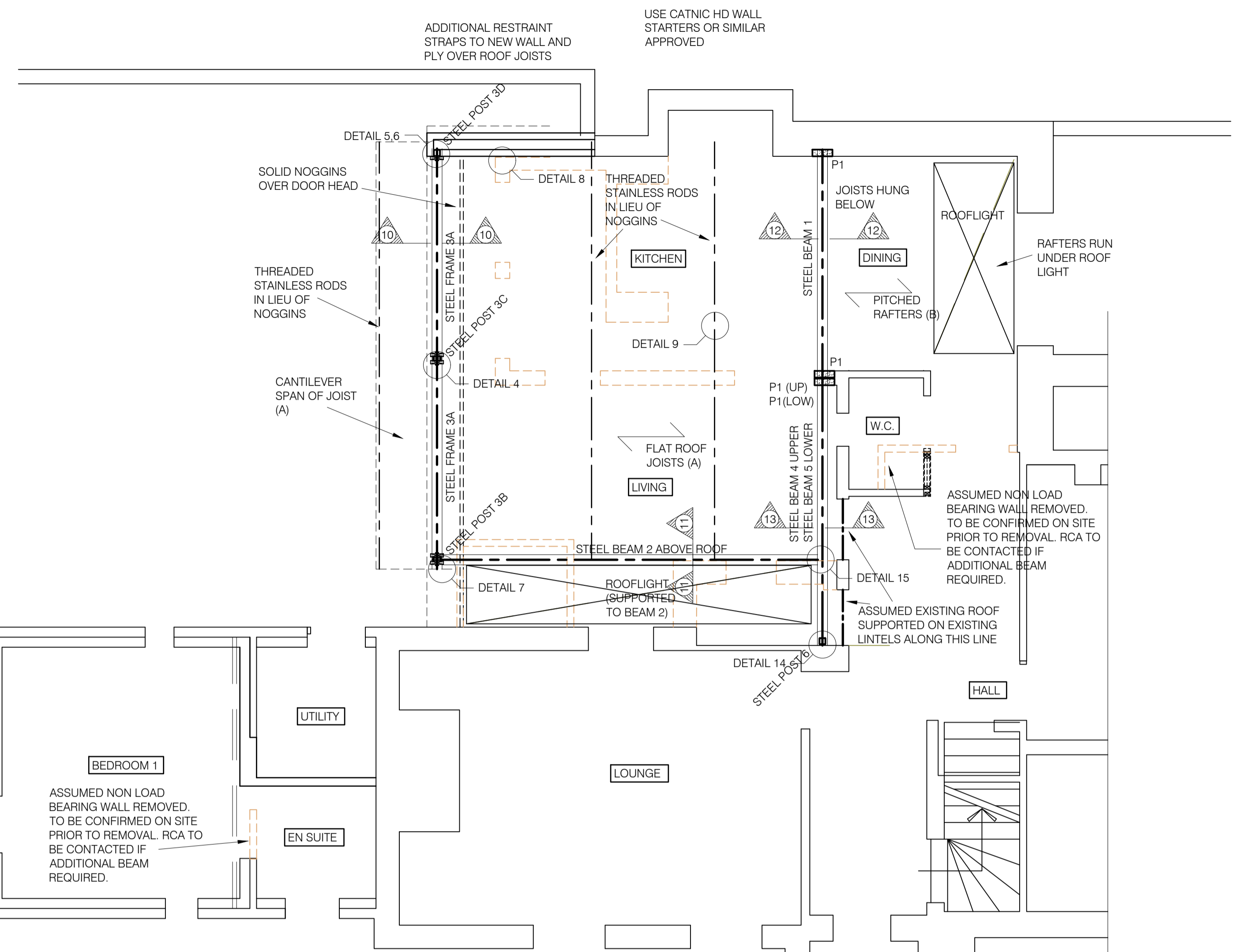

GROUND FLOOR G.A.
(SHOWING STRUCTURE OVER)
SCALE 1:50

PADSTONE SCHEDULE	
Ref.	Padstone Size
P1	300mm x WALL WIDTH x 150mm DEEP.
P2	440mm x WALL WIDTH x 215mm DEEP.
P3	300mm x 300mm x 100mm x 150mm DEEP.

STEELWORK SCHEDULE					
REF. No.	SECTION	* ACTUAL SIZE		WEIGHT (Kg/m)	GRADE
		DEPTH	WIDTH		
1	152 x 152 UC 30	158	153	30.0	S355
2	152 x 152 UC 30	158	153	30.0	S355
3A	152 x 152 UC 30	158	153	30.0	S355
3B	120 x 80 x 8.0 RHS	120	80	-	S355
3C	120 x 80 x 8.0 RHS	120	80	-	S355
3D	100x100x8.0 SHS	100	100	22.6	S355
4	152 x 152 UC 30	158	153	30.0	S355
5	152 x 89 UB 16	152	89	16.0	S355
6	100x100x4.0 SHS	100	100	11.9	S355
-					
-					

* TO NEAREST mm.

TIMBER SCHEDULE		
REF. No.	SIZE	GRADE
A	250 x 72 @ 400mm CENTRES	C24
B	250 x 72 @ 400mm CENTRES	C24

NOTES

- THIS DRAWING IS TO BE READ IN CONJUNCTION WITH ALL OTHER RELEVANT DRAWINGS, DETAILS, SCHEDULES AND SPECIFICATIONS. R.C.A. TO BE NOTIFIED IF ANYTHING ON SITE IS DIFFERENT TO THIS DRAWING. DO NOT SCALE FROM THIS DRAWING. ALL DIMENSIONS TO BE CHECKED ON SITE PRIOR TO COMMENCEMENT OF WORKS. ALL TEMPORARY WORKS TO CONTRACTORS DETAILS AND DESIGN. WHERE EXISTING WALLS ARE SHOWN AS LOAD BEARING FOR SUPPORT IT IS THE CONTRACTORS RESPONSIBILITY TO CHECK THESE WALLS ARE LOAD BEARING ON SITE PRIOR TO WORKS STARTING.
- MASONRY**
 - BLOCKWORK DETAILS (UNLESS NOTED OTHERWISE) :-
 - BELOW DPC BLOCKWORK TO BE IN MORTAR DESIGNATION (i) IN ACCORDANCE WITH BS EN 1996, CEMENT : SAND 3:1.
 - ABOVE DPC BLOCKWORK TO BE IN MORTAR DESIGNATION (iii) IN ACCORDANCE WITH BS EN 1996, CEMENT : SAND WITH PLASTICIZER 1 : 5 TO 6. ALL MASONRY TO BE INSTALLED IN ACCORDANCE WITH BS EN 1996.
 - BLOCKWORK HAS BEEN DESIGNED TO HAVE A MAXIMUM DENSITY OF 1400kg/M³. RCA TO ADVISE IF DENSE BLOCKS ARE REQUIRED.
 - INNER SKIN TO EXTERNAL WALLS TO BE 100mm UNLESS NOTED OTHERWISE.
 - MOVEMENT JOINTS IN MASONRY REQUIRED ABOVE D.P.C. LEVEL TO BS EN 1995. ANY JOINTS SHOWN ON PLAN ARE INDICATIVE ONLY. LOCATIONS TO BE AGREED - USE MINIMUM 12m c/c IN BRICKWORK (6m FROM CORNERS) AND 6m c/c IN BLOCKWORK (3m FROM CORNERS).
 - WALL TIES TO BE INSTALLED AND SPECIFIED TO DD140 AND NHBC STANDARDS. WHERE TIES REQUIRED FOR 125mm CAVITY. USE ANCON ST1 TIES OR SIMILAR APPROVED.
 - NO INDIVIDUAL BLOCK TO WEIGH MORE THAN 20Kg FOR HEALTH & SAFETY PURPOSES. RCA TO BE CONSULTED SHOULD HEAVIER BLOCKS BE REQUIRED.
 - LINTELS INSTALLED IN ACCORDANCE WITH BS5977. ALL LINTELS TO BEAR 150mm WHERE POSSIBLE. "CG70/100" REFERS TO CATNIC LINTEL REFERENCE. LINTELS SHOWN ARE A GUIDE ONLY AND SHOULD BE CONFIRMED BY LINTEL MANUFACTURER PRIOR TO INSTALLATION. SPECIFIED LINTELS TO BE CHECKED FOR CAVITY SIZE BY CONTRACTOR OR CLIENT PRIOR TO ORDERING.
- STEELWORK**

ALL STEELWORK TO BE GRADE S 355 JR (WHERE INTERNAL) AND S 355 JO (WHERE EXTERNAL) IN ACCORDANCE WITH BS EN 10025. ALL HOLLOW SECTIONS TO BE HOT ROLLED GRADE S355 "CELSIUS" UNLESS NOTED OTHERWISE. ALL STEELWORK TO BE INSTALLED IN ACCORDANCE WITH BS EN 1993. ECCENTRICALLY LOADED BEAMS TO HAVE ENDS FULLY BUILT IN PRIOR TO FLOOR/WALL LOADING FROM ABOVE. TEMPORARY PROPPING MAY BE REQUIRED WHERE ECCENTRIC LOADS OCCUR. IF IN ANY DOUBT PLEASE CONTACT RCA. STEELWORK ABOVE GROUND TO BE FINISHED TO GIVE CORRECT FIRE RATING TO CURRENT BUILDING REGULATIONS. ALL EXTERNAL EXPOSED STEELWORK TO BE GALVANISED. GENERALLY STEELWORK TO BE FINISHED WITH ZINC PHOSPHATE PRIMER. ALL BOLTS TO BE GRADE 8.8 UNLESS STATED OTHERWISE. ALL CONNECTIONS TO BE INSTALLED IN ACCORDANCE WITH BS EN 1993. ALL STEEL BEAMS TO SIT ON 450 x WALL THICKNESS x 215 DEEP CONCRETE PADSTONES UNLESS NOTED OTHERWISE. PADSTONES TO BE MINIMUM 21.0N/mm² CONCRETE. BEAMS TO BEAR 150mm WHERE POSSIBLE. WHERE HOLDING DOWN BOLTS MAY BE REQUIRED. RCA TO ADVISE. LONGER BEAMS MAY REQUIRE SPLICING TO ENABLE SAFE HANDLING - RCA TO BE CONTACTED SHOULD SPLICE CONNECTION BE REQUIRED. SITE MEASUREMENTS TO BE TAKEN BY CONTRACTOR PRIOR TO ORDERING OF STEEL.
- TIMBER**

ALL TIMBER TO BE INSTALLED IN ACCORDANCE WITH BS EN 1995 AND NHBC STANDARDS. LATERAL RESTRAINT STRAPS REQUIRED TO WALLS PARALLEL TO JOISTS AND TIMBER ROOF SPANS. STRAPS TO BE AT MAXIMUM 1.2m C/C APART AND FIXED TO MINIMUM OF 3 No. JOISTS. ALL STRAPS INSTALLED TO BS EN 1995. SOLID BLOCKING TO BE USED WHERE JOISTS ARE NOTCHED INTO STEEL BEAMS. ALL JOISTS TO BE DOUBLED UNDER PARTITIONS U.N.O. HERRINGBONE STRUTTING/SOLID BLOCKING REQUIRED PERPENDICULAR TO JOIST SPANS AS FOLLOWS:-

Up to 2.5m Span	None Required
2.5m - 4.5m Span	1 row required mid span
Over 4.5m Span	2 rows required equally spaced

CDM REGULATIONS 2017.
MEMBER SIZES AND DIMENSIONS HAVE BEEN DESIGNED IN ORDER TO SATISFY THE DESIGN REQUIREMENTS OF THE PROJECT. CONTRACTOR SHOULD BE AWARE OF RISKS ASSOCIATED WITH HANDLING AND INSTALLATION OF STRUCTURE WHICH CANNOT BE REMOVED AT THE DESIGN STAGE. CONTRACTOR MUST BE SUITABLY EXPERIENCED IN ALL ASPECTS OF HANDLING AND LIFTING. ALL TEMPORARY WORKS MUST COMPLY WITH CURRENT LEGISLATION. REFERENCE MUST ALWAYS BE MADE TO THE SEPARATE RCA RISK ASSESSMENT DOCUMENT.

CLOUDED ITEMS WITH TAG INDICATES LATEST REVISIONS TO DRAWING. PLEASE NOTE THAT ADDITIONAL CHANGES MAY BE NOTED IN THE REVISION BOX BELOW.

Rev.	Date	By	Description	App.
-				

Project
**Labour in Vain
Church End
Albury
SG11 2JG**

Title
**Ground Floor
General Arrangement**

Scale	1:50 @ A1	Drawn By	MPL
Date	April 2023	Approved	MPL

 RCA STRUCTURES <small>STRUCTURAL ENGINEERING AND DESIGN</small>	2nd Fl. Unit 1, Birchanger Industrial Estate, Stansted Road, Bishops Cleeve, CM23 2TH. Tel. 01279 506721 Fax. 01279 506724 E-mail: mail@rcastructures.co.uk Internet: www.rcastructures.co.uk
 The Institution of Structural Engineers	