

- GENERAL NOTES**
1. Do Not Scale
 2. The contractor is to check and verify all buildings and site dimensions and levels, including sewer invert levels, before works start on site. The contractor is to comply in all aspects with the current building legislation, British Standards, building regulations etc.
 3. Positions of existing services/statutory undertakers apparatus adjacent to or crossing proposed excavations are to be checked by the contractor prior to starting work.
 4. This drawing is to be read in conjunction with and checked against all other drawings, Engineering Details, Specification and any structural, geotechnical or other specialist document provided.
 5. Any anomaly or contradiction between any of the above is to be reported to Edenstone.
 6. This drawing is schematic for clarity only, positions of pipe runs and manholes may vary on site due to site conditions.
 7. The use of this drawing does not absolve the client of their responsibilities under the Health and Safety: The Construction Design and Management Regulations 2015. The Principle Designer is required to contact PHG Consulting prior to permitting this drawing to be used in connection with any construction works.
 8. This drawing is based on the latest Architects design layout received.
 9. All works shown have been designed in accordance with Building Regs Part M.
 10. All underbuild, and retaining wall heights shown are the anticipated maximum finished height required.
 11. All step shown are to have a maximum 150mm rising and minimum 280mm going dimensions up to a maximum of 12 steps per flight.
 12. All levels immediately adjacent to the rear access are assumed to be 150mm below finished floor level.

- ROAD AND SEWER ADOPTION NOTES**
1. All works for adoption under a Section 38 agreement shall be carried out to the approval of North Somerset Council.
 2. All works for adoption under a Section 104 agreement shall be carried out to the National Water Council 'Design and Construction' Guidance for foul and surface water sewers offered for adoption under the Code for adoption agreements for water and sewerage companies operating wholly or mainly in England ("the Code") (DCG) and Wessex Water's requirements.

- DRAINAGE LEGEND**
- Existing Foul Drains retained
 - Proposed Foul Drainage (Adoptable) - with Invert Adoption extents to be confirmed by Wessex Water
 - Proposed Storm Drainage (Adoptable) - with Invert Adoption extents to be confirmed by Wessex Water
 - Proposed Wessex Water Easement (3m Either side of sewer)
 - Private foul drain (1000 unless show otherwise)
 - Private foul inspection chamber <3m deep with restricted access depths >1.2m (4500 & 700mm deep unless noted)
 - Private foul access chamber depth to invert 700mm (2250)
 - Private storm drain (1000 unless show otherwise)
 - Private surface water inspection chamber <3m deep with restricted access depths over 1.2m.
 - Rodding eye (450mm deep unless noted otherwise)
 - Channel drain (ACO or similar)
 - Proposed Hydrobrake Chamber
 - Proposed catchpit chamber
 - Cellular Attenuation Tank
 - Orifice Control /Filter Chamber
 - Vortex Separator Chamber
 - Exceedance Flow Direction

REV.	DATE	DETAILS	AMENDMENTS	BY	CHK.
C	31.05.23		Vortex chamber relocated to make it more accessible. Altered following Client review - F13's Changed from 6.8.0 to 6.8.15 to 30.34 & 30.40. Retention altered to suit. GA Updated. Levels updated. gradients added to rear gardens. S185 realigned to avoid RPP. pipe details added. Minor rev to basin extent.	DRW	SJD
B	11.04.23		Basin levels updated. Outfall level raised to avoid clash with road street.	DRW	SJD
A	24.03.23		Surfacing updated.	DRW	SJD

CLIENT:

EDENSTONE HOMES

CONSULTING ENGINEERS

PHG CONSULTING LTD
107 COWBRIDGE ROAD EAST
CAMBRIDGE CB1 1 9AG
T: +44(0)20 3026 2671
E: enquiries@phg-consulting.com
W: www.phg-consulting.com

@PHG_consulting
www.edenstone.com/company/phg-consulting-engineers

PROJECT: Bleadon Quarry, Bridge Road, Bleadon

DRAWING TITLE: Engineering Layout 1:250 Sheet 1

DRAWN	CHK.	STATUS	SCALE AT A1:
DRW	SJD	CONSTRUCTION	1:250
DATE	JOB NO.	DWG. NO.	REV.
09.02.23	2311	100	C

- ENGINEERING LEGEND**
- 10.500 Finished Floor Level
 - Underbuild
 - Retaining Wall
 - Timber Retaining Wall (max. 595mm)
 - Steps (R=rise G=going)
 - TS - Threshold Step
 - Level Proposed
 - Banking 1:2 Max
 - Tactile crossing point
 - Vehicular crossover
 - Awareness strip - Refer to details
 - Rise to Raised table - Refer to S278 Drawings

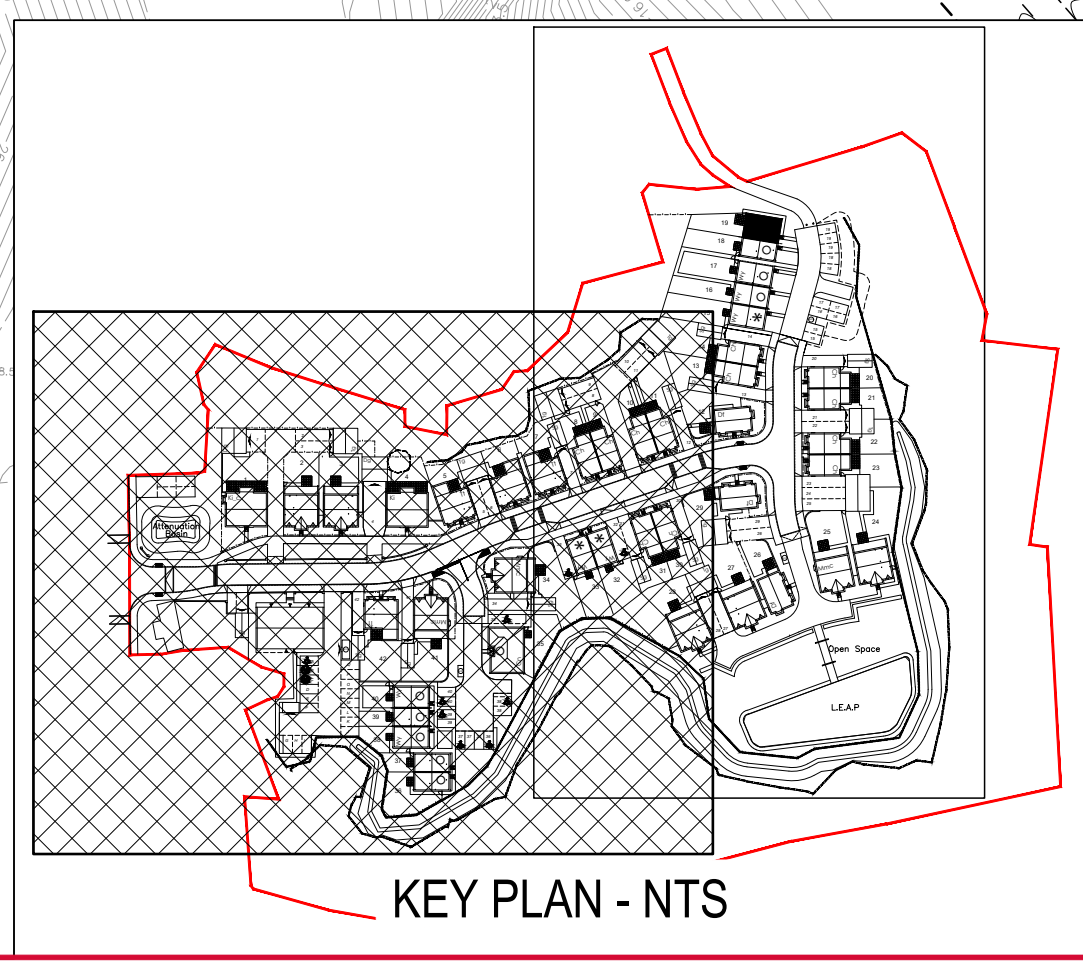
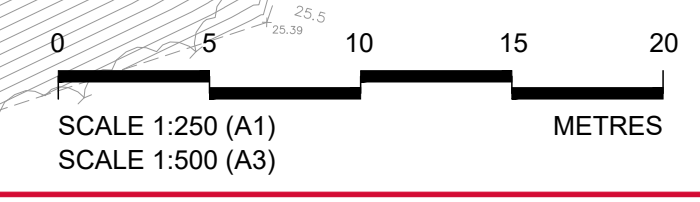

2311_100-01-Engineering Layout 1:250 - Sheet 1 (pg)