

BLOCK PLAN - 1:500

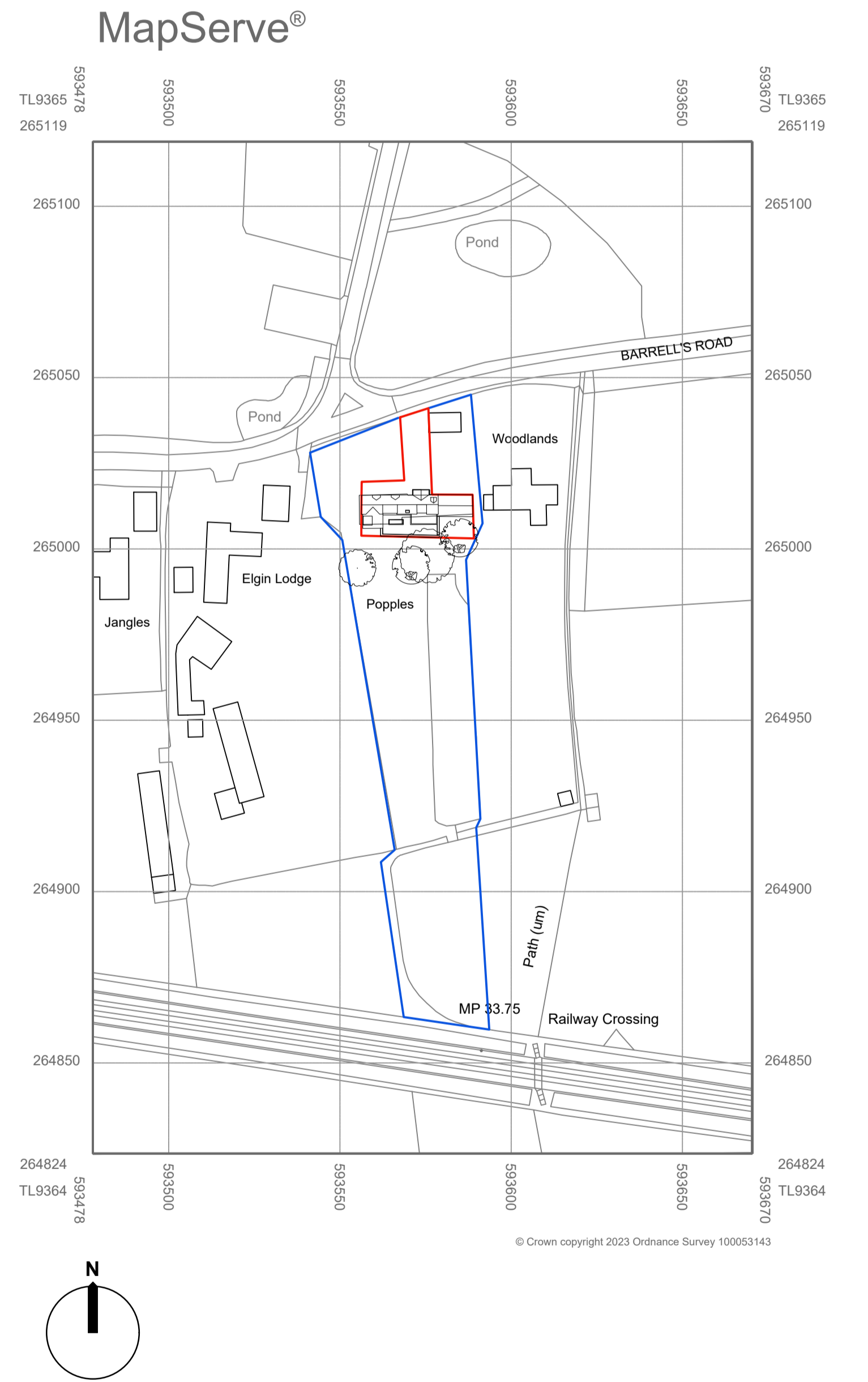

LOCATION PLAN - 1:1250

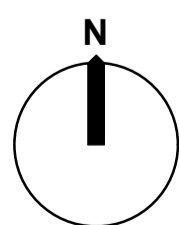

REV	DATE	CHK	AMENDMENTS
01	30.05.23	SAJ	DRAFT FOR COMMENT / APPROVAL
02	09.06.23	SAJ	SUBMITTED FOR PLANNING APPLICATION

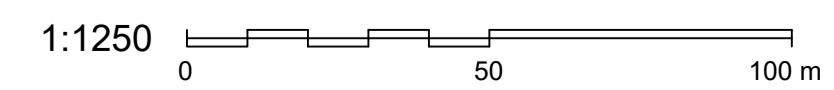
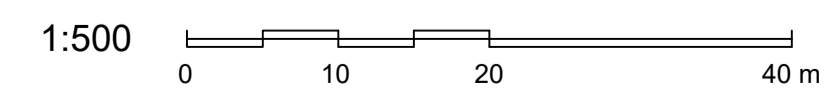

ALL DIMENSIONS TO BE CONFIRMED ON SITE BY THE CONTRACTOR PRIOR TO CONSTRUCTION

H:\FFA 2022\Popples\Drawings\20230623 FFA Project Drawings.dwg\9901 050 Location Plan and Block Plan\ISO full bleed A1 (894.00 x 841.00 MM)\Stuart.Jones\6/23/2023 1:52 PM

CLIENT			
MR & MRS HARRIS			
JOB			
REAR EXTENSION TO POPPLES, THURSTON			
DRAWING			
SITE LOCATION PLAN AND BLOCK PLAN			
PLANNING			
SCALE	1:100	PAPER	A1
DATE	JUNE 2023		
JOB	DWG	REV	
PP01		050	02

© COPYRIGHT FABRIC FIRST ARCHITECTS LTD