

ground floor plan

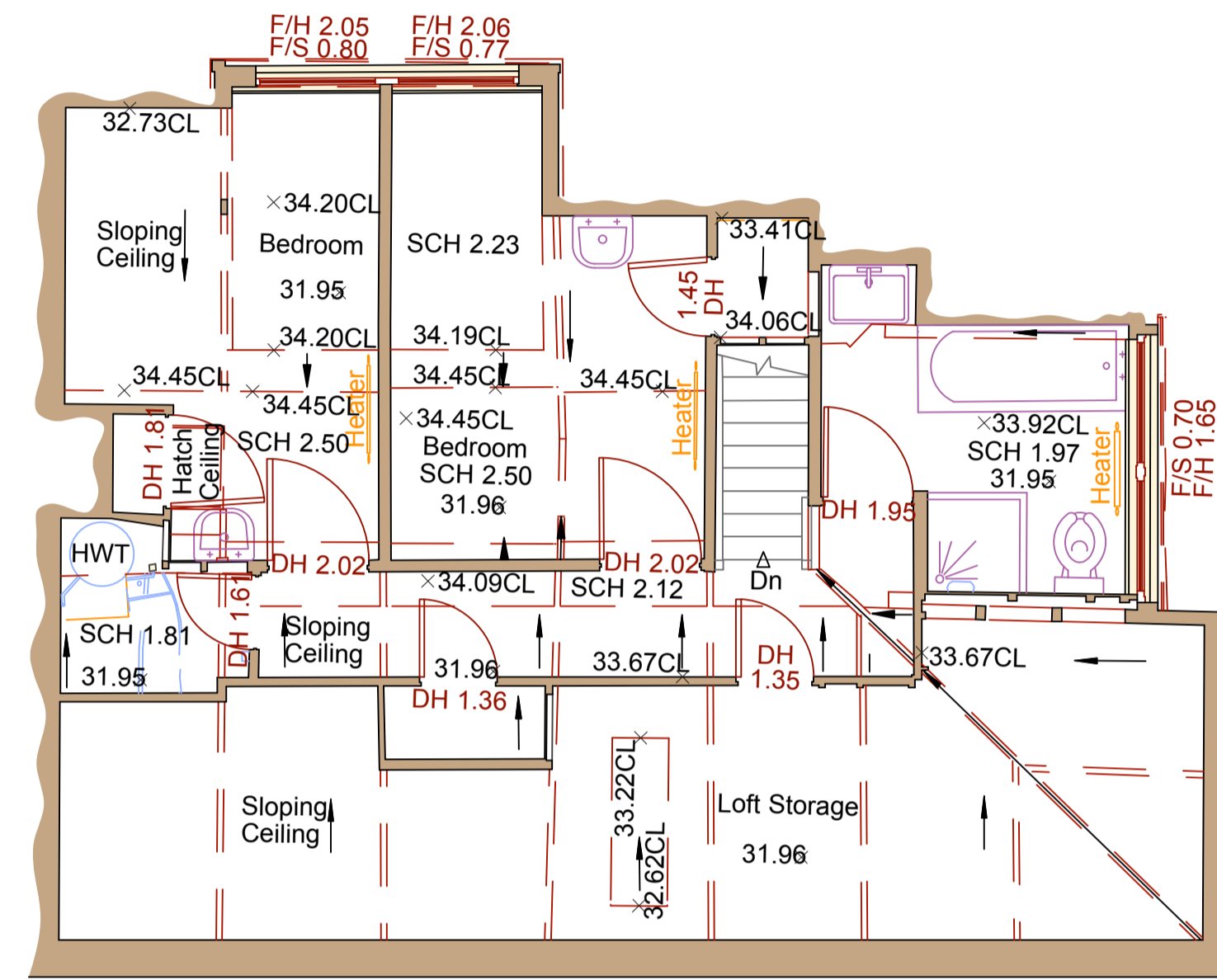

first floor plan

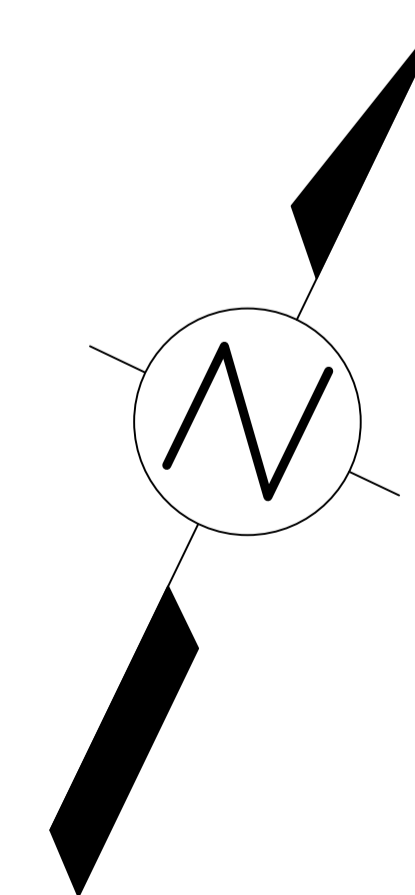
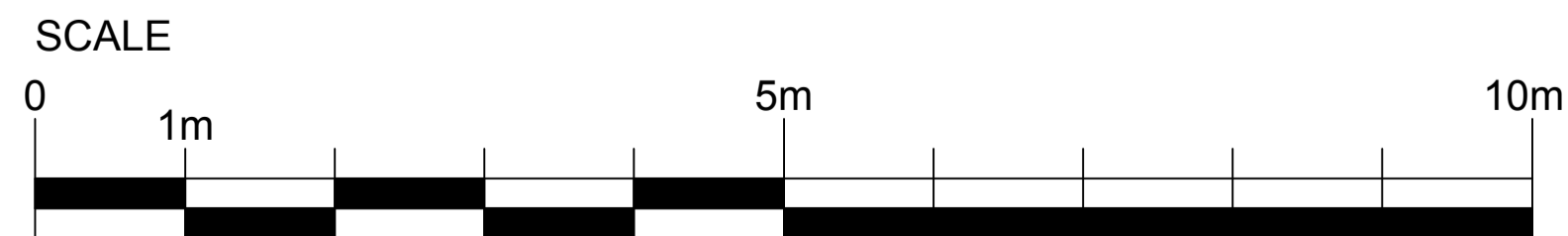

Revisions

This drawing is copyright. Contractors must check all dimensions on site prior to commencing work or ordering materials. Only figured dimensions are to be worked from. Discrepancies to be reported immediately to purl-design. This drawing is not for construction purposes unless stated

Purl Design Architecture LTD is a limited company registered in England and Wales with number 09182260. Registered office: The Mill, Prideaux Road, St. Blazey, Cornwall PL24 2SR

REDEVELOPMENT OF EXISTING DWELLING, POLMEOR, POLZEATH		
FOR GARY AND PENNY ANGWIN		
EXISTING FLOOR PLANS		
Scale	Drawn by	Date
1:50@A1	P.HUME	04.2023
Drawing no.	Rev. no.	Purpose
PD719/02		not for construction
 <b>PURL DESIGN</b> ARCHITECTURE LTD Tregarthen House, Nanstallon, Cornwall, PL30 5LB Tel no. 01726 812212 www.purl-design.com		