

3 Blue Hill Cottages, Watton-At-Stone

Drawing title: Existing Roof

Scale: 1:50 @ A1

Date: September 2020

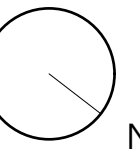

General Notes

All dimensions to be verified on site
 To be read in conjunction with all relevant documents
 In the event of discrepancy notify the Architect immediately
 This document is copyright of The Rural Craft Co.

Issue Status

SK Information F Feasibility D Design
 P Permissions S Scheme T Tender
 C Construction E Existing Condition

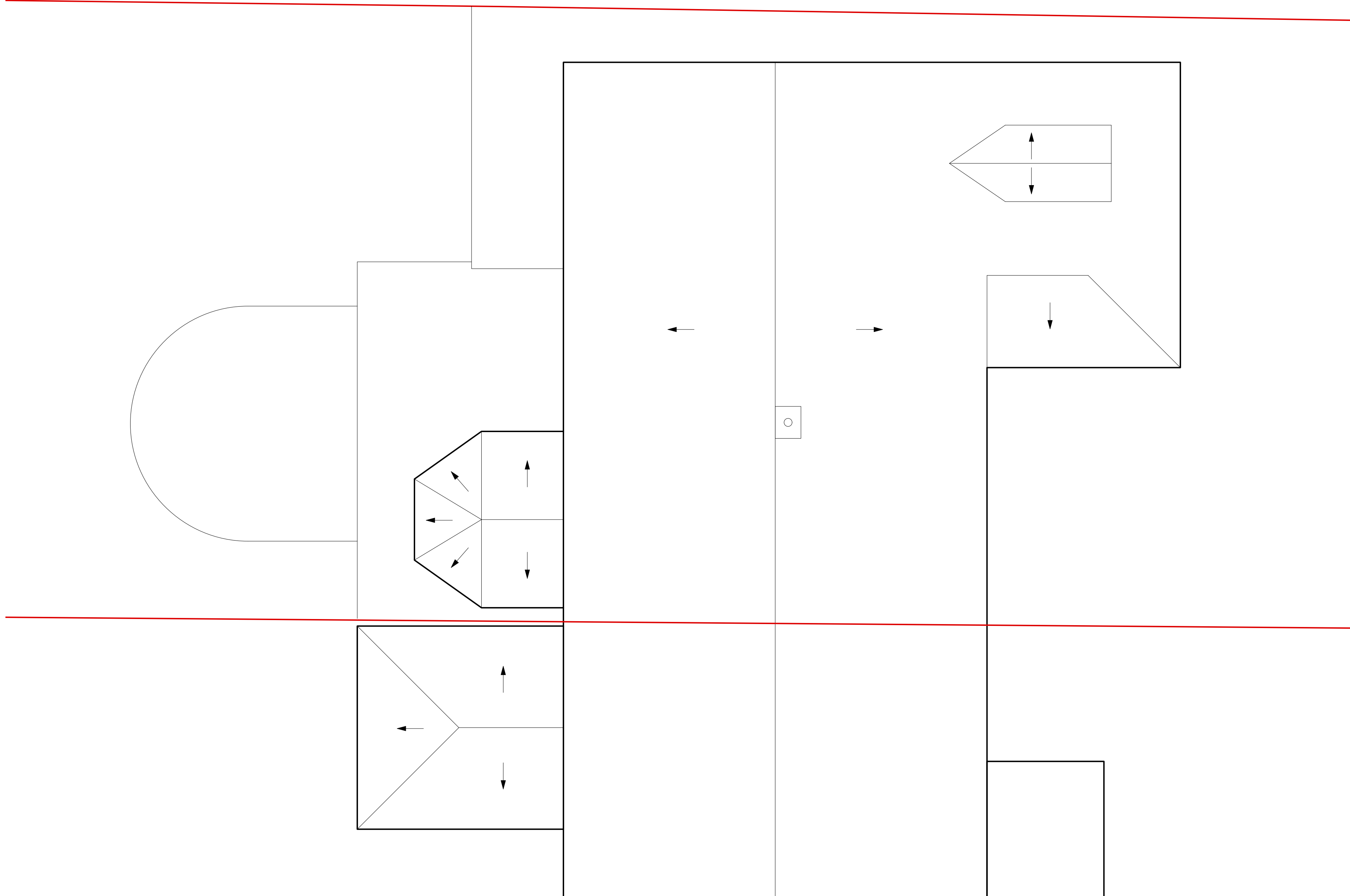

(P1): Planning Issue (19.07.23/SE)

Revision: Information (date/drawn by)

0519 - 003 (P1)

**THE RURAL
 CRAFT
 Co.**

Cambridgeshire & Hertfordshire based Architects

www.theruralcraftco.com