

© This drawing and design are copyright.  
 Do not scale from this drawing. Use only figured dimensions. If in doubt, ask.  
 All dimensions are to be checked on site.  
 Any discrepancies should be reported immediately to the Architect.

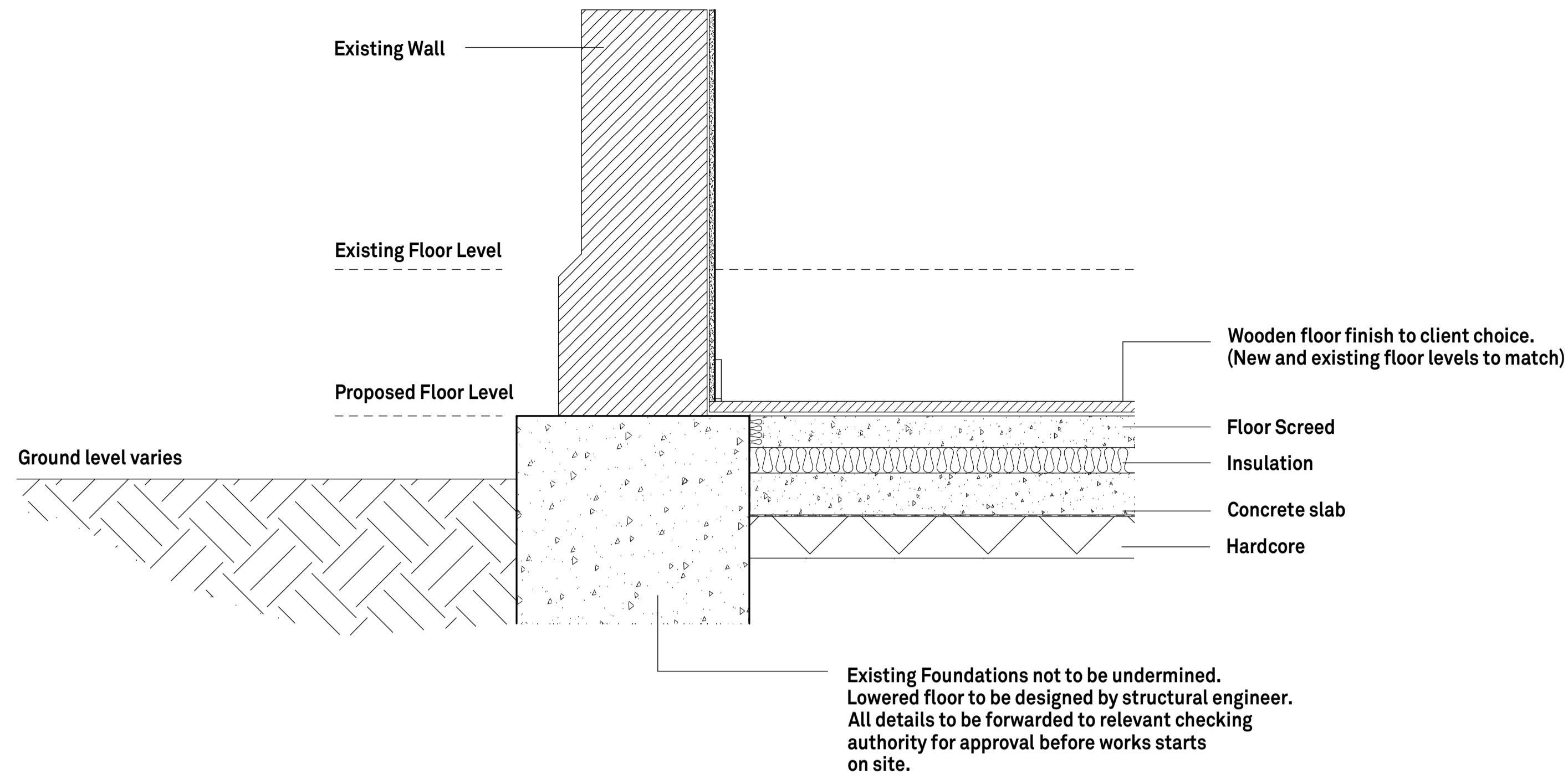

**Typical Ground Floor Slab Lowered Floor Detail**  
1:10

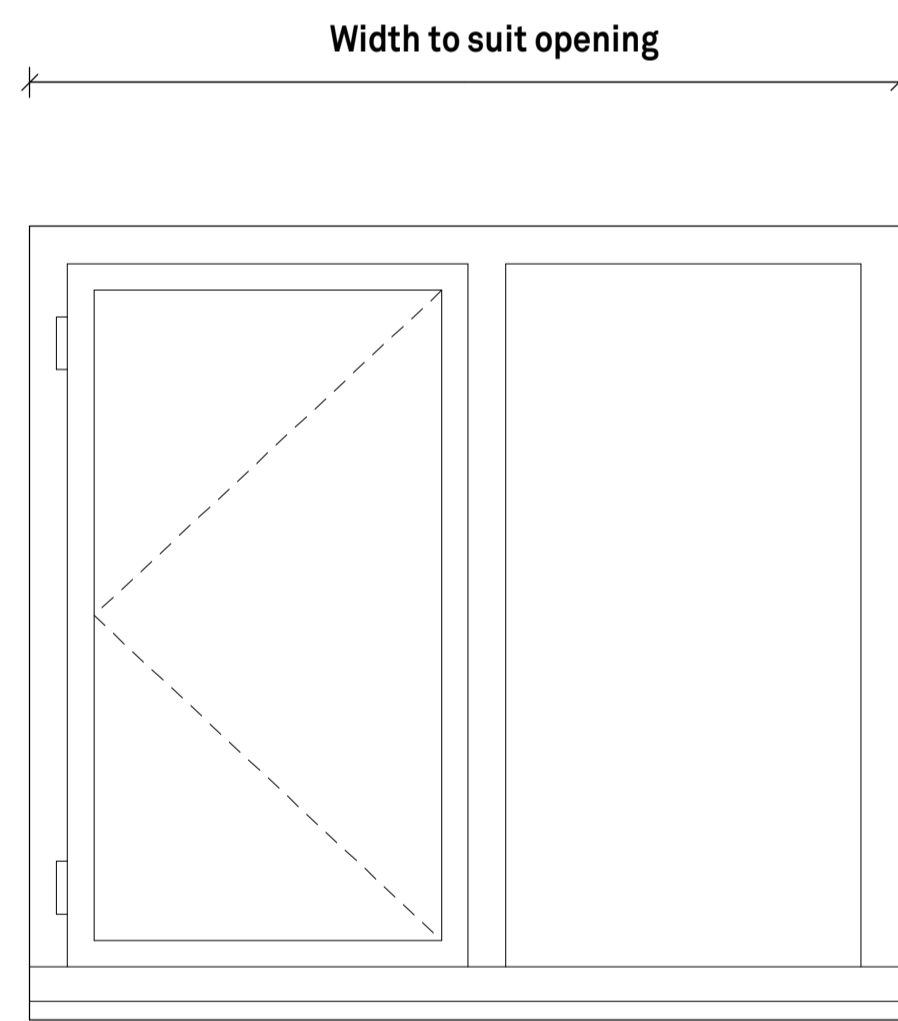

**Typical Timber Window Elevation**  
1:10

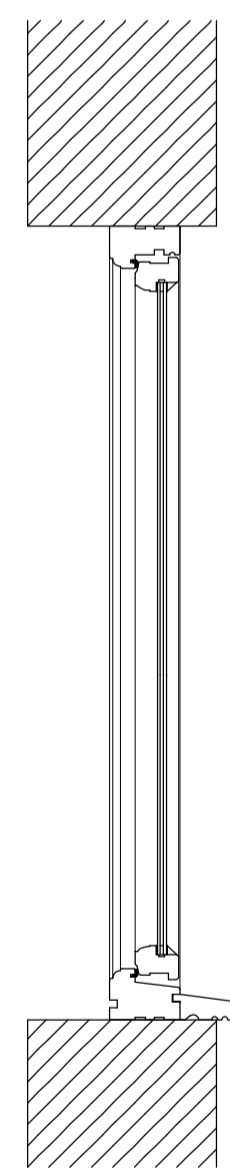

**Typical Timber Window Section**  
1:10

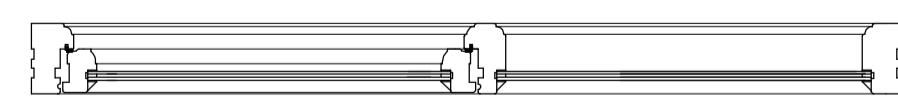

**Typical Timber Window Plan**  
1:10



**Wooden floor Sample Reclaimed Boards**



**Typical Aluminium double door Plan**  
1:10

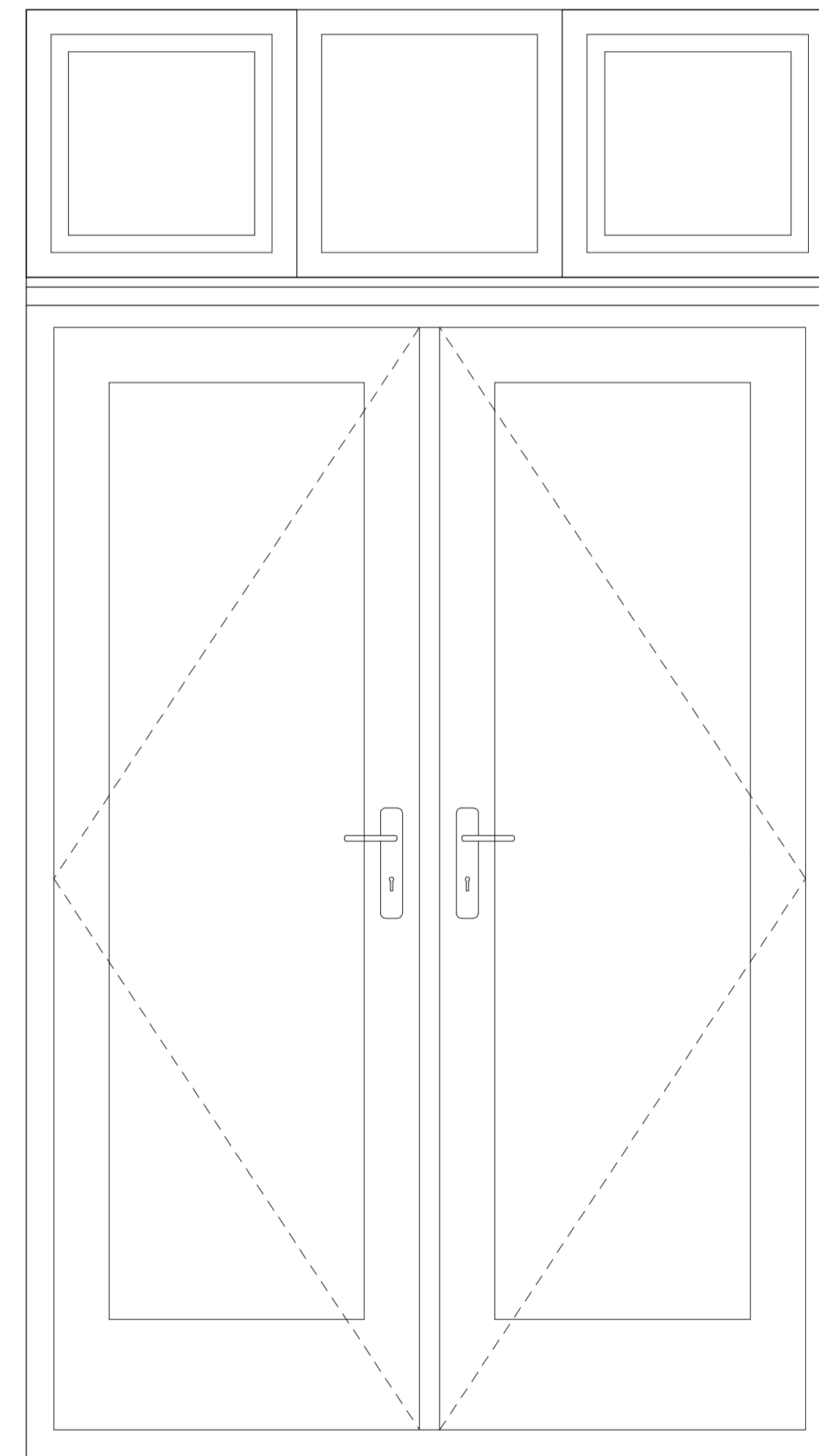

**Typical Aluminium double door Elevation**  
1:10

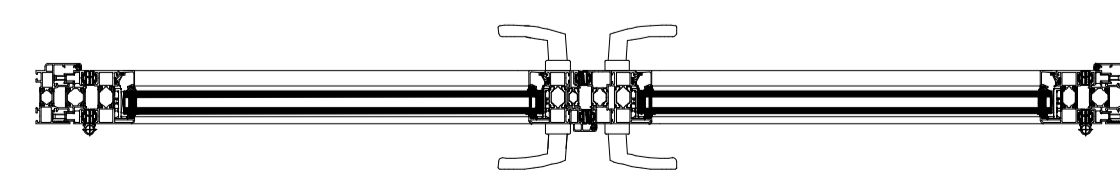

**Typical Aluminium double door Plan**  
1:10

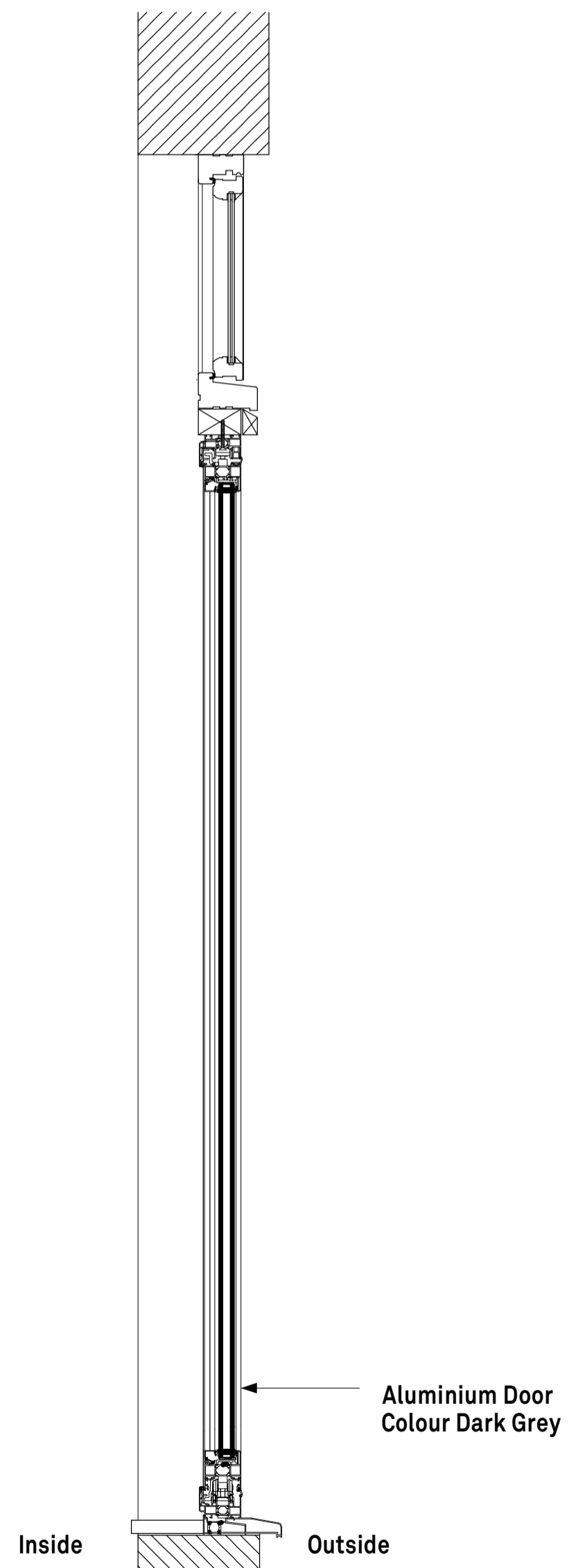

**Typical Aluminium double door Section**  
1:10

DATE	REV	DESCRIPTION	DRAWN
<b>PatrickAllen&amp;Associates Architects</b>			
architects@patrickallen.org.uk		2 Grange Business Centre	
www.patrickallen.org.uk		Tommy Flowers Drive	
+44 (0)1473 820660		Grange Farm	
		Kesgrave, Ipswich	
		Suffolk, IP8 2BY	
Project			
<b>Proposed alterations at:- Lodge Barn South, Forest Road, Onehouse, Stowmarket, IP14 3HH</b>			
Client			
<b>Mr &amp; Mrs Brown</b>			
Drawing Title			
<b>Details Sheet 1</b>			
Drawing Status			
<b>Planning</b>			
Scale	Paper Size	Date	Drawn
1:10	A1	May 23	--
Drawing Number			
<b>3892-85B</b>			
© 2023 Patrick Allen & Associates Limited   Registered No: 4694261			