

general notes © This drawing and all information it contains is copyright of Twenty-Nine Architecture and must not be copied or reproduced in whole or in part or used without express approval of the authors.

The drawing is to be read in conjunction with all other relevant drawings and specifications.

All dimensions to be checked on site prior to commencement of works and any discrepancies to be checked immediately.

Do not scale from this drawing.

Unless otherwise stated, all dimensions are in mm.

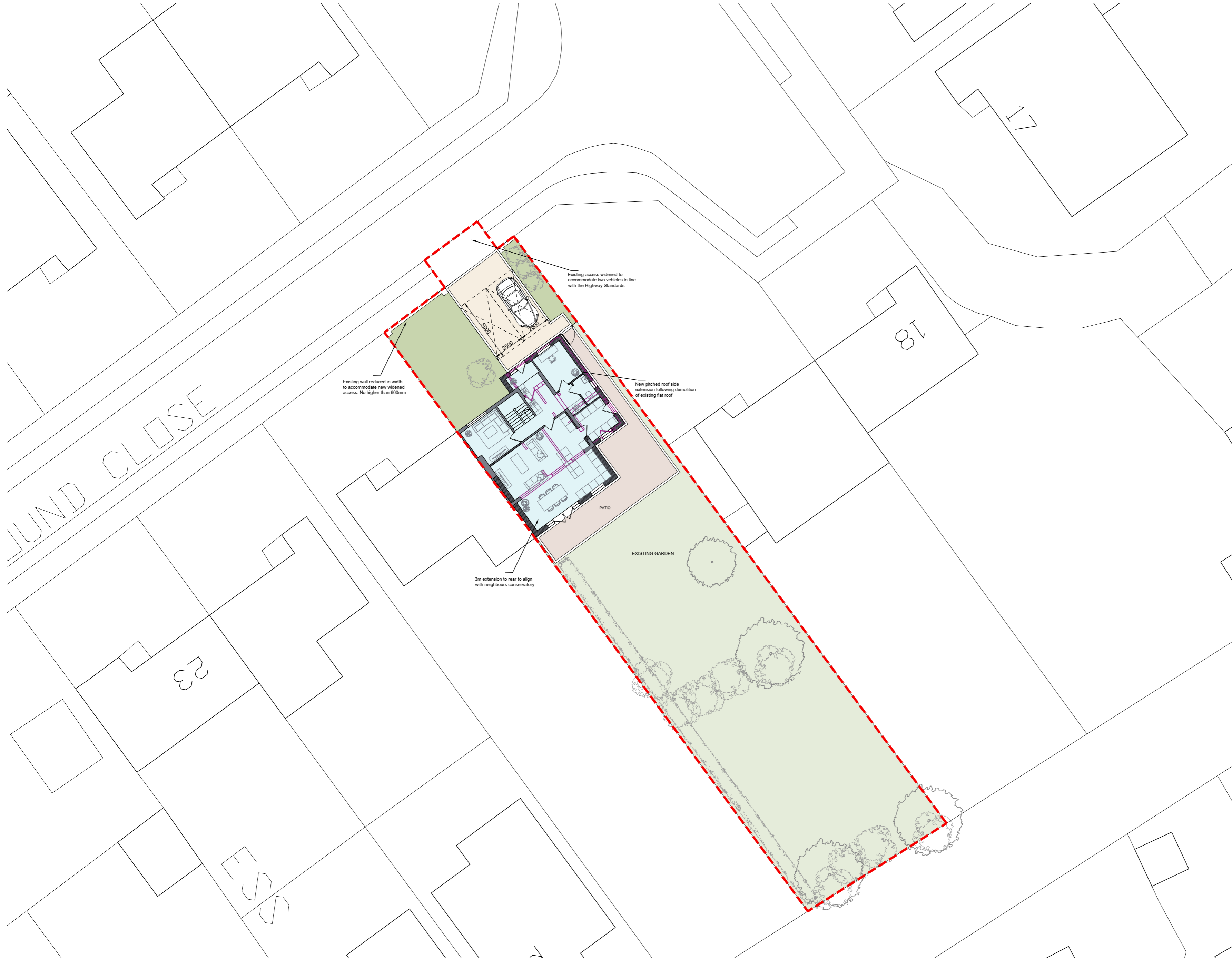

- LEGEND**
- - - - SITE BOUNDARY
  - PROPOSED NEW TREES/ PLANTING
  - EXISTING TO BE REMOVED
  - SOFT LANDSCAPING
  - FLAG PAVING TO PATIOS AND PATHS
  - EXISTING PEA SHINGLE EXISTING TO PARKING BAYS RETAINED

rev **P2** date **July '23** drawn **DSR**

client **Tony DeSimone**

project **20 Pound Close, Bottisham, Cambridgeshire**

drawing title **Proposed Site Plan**

drawing no **PL(21)01** checked **DSR**  
 scale **1:200** original **A2**  
 status **PLANNING**

address **25 Cromwell Road  
 Cambridge  
 Cambridgeshire  
 CB1 3EB**

telephone **+44 (0)1223 212253**  
 email **info@29architecture.co.uk**  
 website **www.29architecture.co.uk**

