



Lyndon Brett Partnership

Chartered Surveyors

County Court Chambers, Queen Street,  
Bridgwater, Somerset, TA6 3DA

Tel: 01278 450 350  
Fax: 01278 428 375  
E-mail: info@lbp-rics.co.uk  
Website: www.lbp-rics.co.uk

**Client:** Mr. John Bult  
**Address:** Collum Farm, Collum Lane,  
Kewstoke, Somerset, BS22 9YX  
**Location:** Collum Farm, Collum Lane,  
Kewstoke, Somerset, BS22 9YX  
**Purpose:** Proposed Floor Plan Detailed  
Drawings  
**Dwg. No.:** C3/230720  
**Date:** July 2023  
**Scale:** 1:100 (A0) (unless stated)

**Areas (GIA):** Ground Floor: 5,768.436645 m<sup>2</sup>  
**Total:** 5,768.436645 m<sup>2</sup>

**Areas (GEA):**

**General Notes:**

This drawing is for Client and Local Authority  
Approval only (as applicable).

Figured dimensions to be taken in preference  
to scaled dimensions. All measurements are  
to be checked on-site for validation &  
authenticity.

No amendments or copies are to be produced  
without prior consent from the Design Team  
at Lyndon Brett Partnership.

All works are for and included within the  
boundaries of:

No external alterations are to be made unless  
detailed on the attached plans provided.

© Copyright Reserved



**Drawing Notes:**

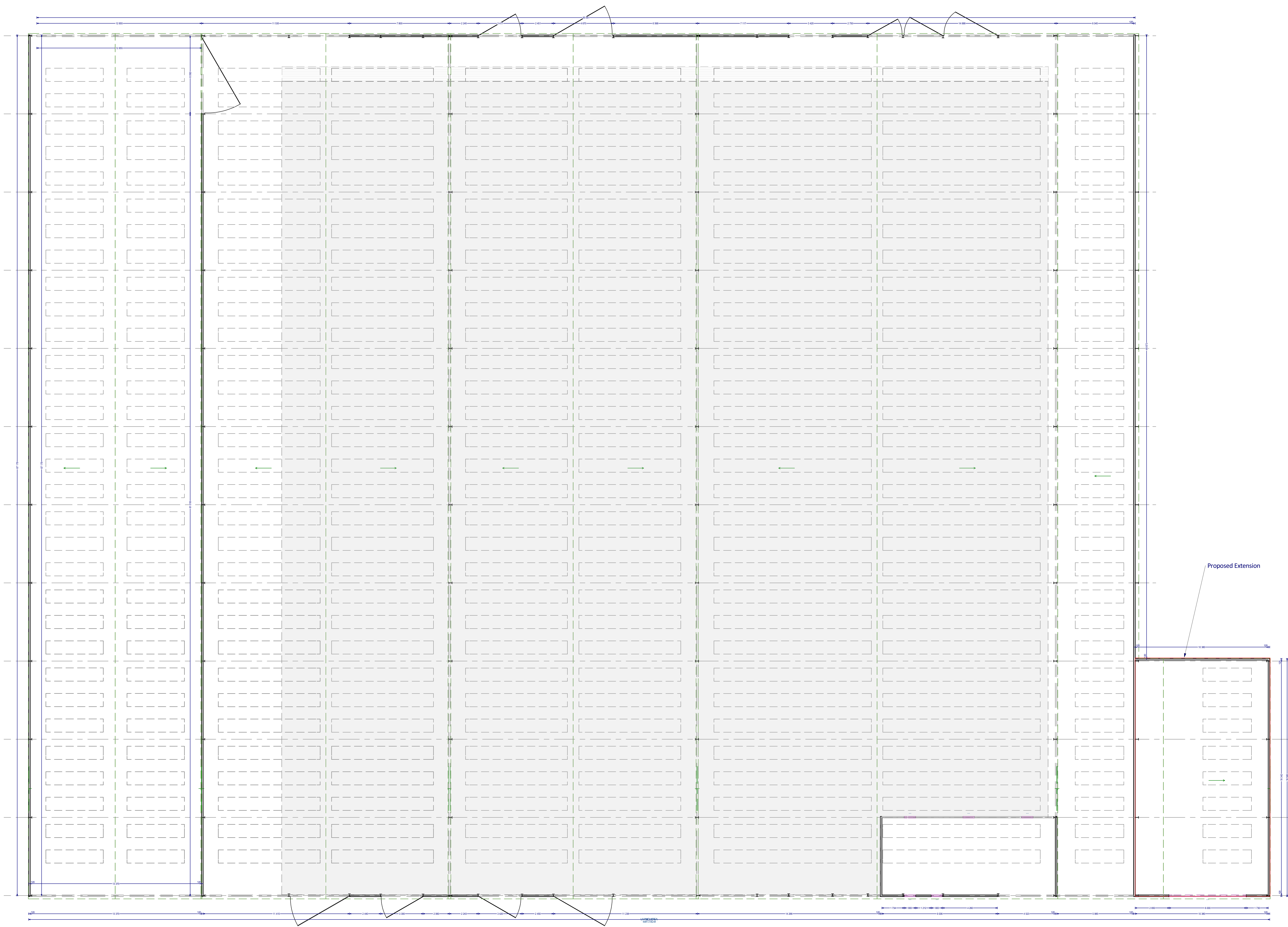

Proposed Ground Floor Plan

