

Do not scale this drawing for other than Planning purposes

Note: Proposals based on preliminary survey. It is recommended that a full measured survey is carried out prior to detail design.

**NOT for CONSTRUCTION**

© Biddulph Architects Ltd

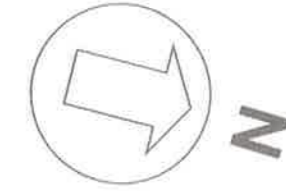

1:100 @ A3  
0 5m  
Existing ground floor

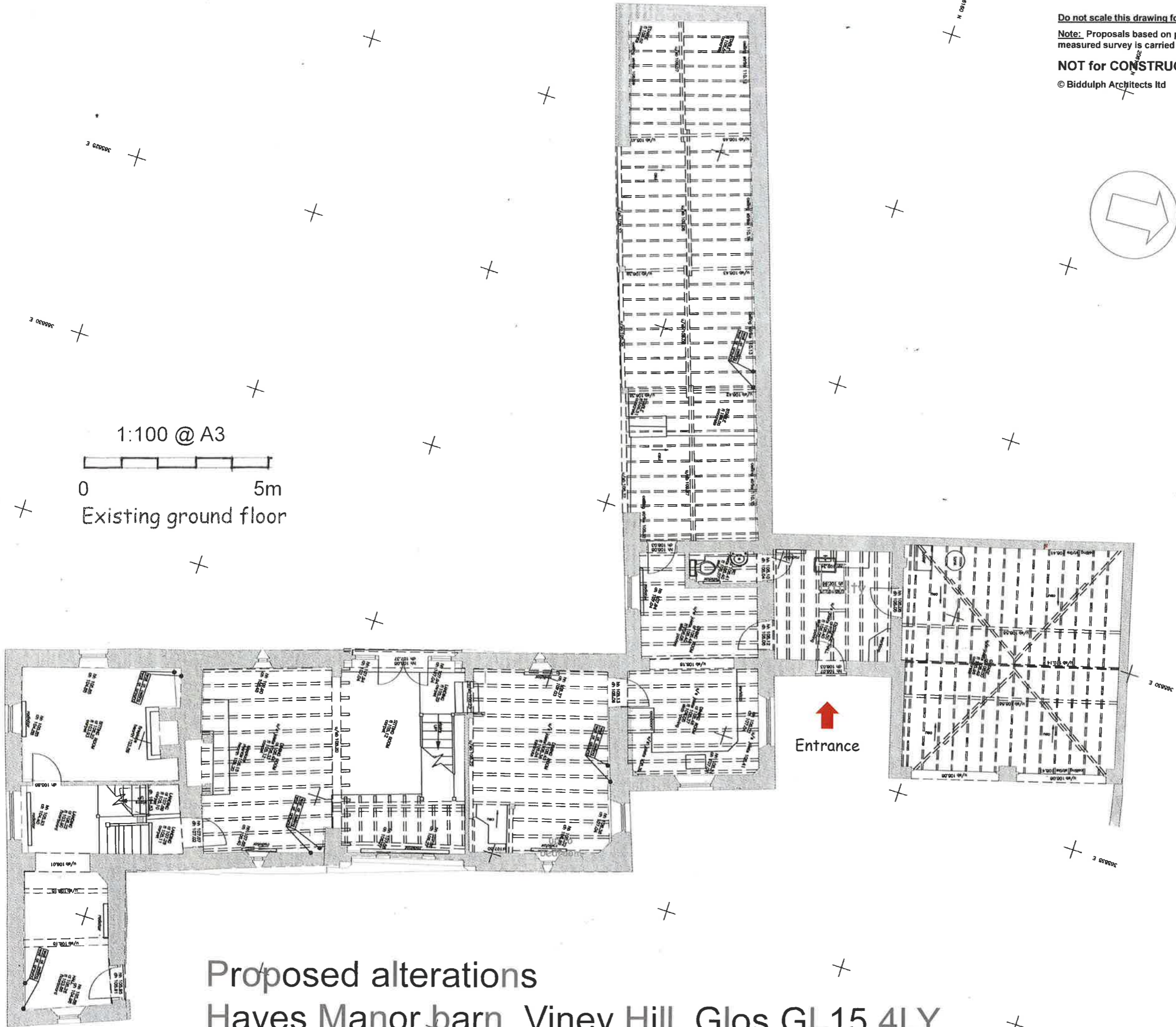

# Proposed alterations Hayes Manor barn, Viney Hill, Glos GL15 4LY

Dwg. No.  
HM/PL/04

