

Do not scale this drawing for other than Planning purposes

Note: Proposals based on preliminary survey. It is recommended that a full measured survey is carried out prior to detail design.

NOT for CONSTRUCTION

© Biddulph Architects Ltd

Line of proposed bottom-hung sliding doors and glazing inboard of existing timber posts.

Frame of sliding door/glazing to align behind existing timber posts

Existing timber posts

Proposed bat roost. Refer to MPEEcology report dated June 2023 for details

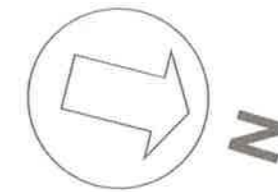

1:100 @ A3



0 5m

Proposed ground floor

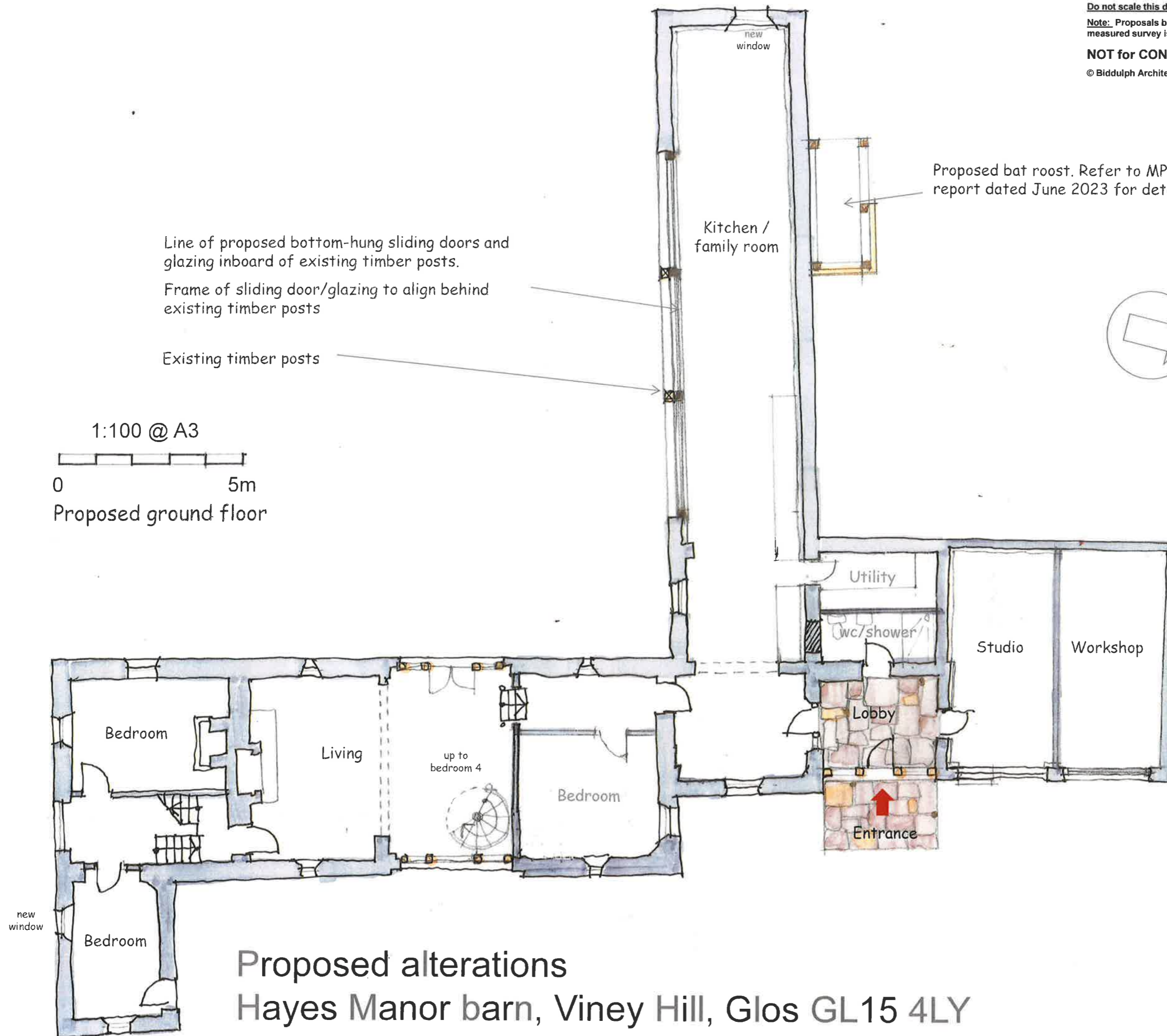

Proposed alterations Hayes Manor barn, Viney Hill, Glos GL15 4LY

Dwg. No.
HM/PL/11

