

Proposal Notes

- 1. Sedum / green roof
- 2. Sloping zinc roof
- 3. Reinstated original slate hipped roof
- 4. Reinstated original brick chimneys
- 5. Brick chimney
- 6. PV (solar array) panels
- 7. Gutter

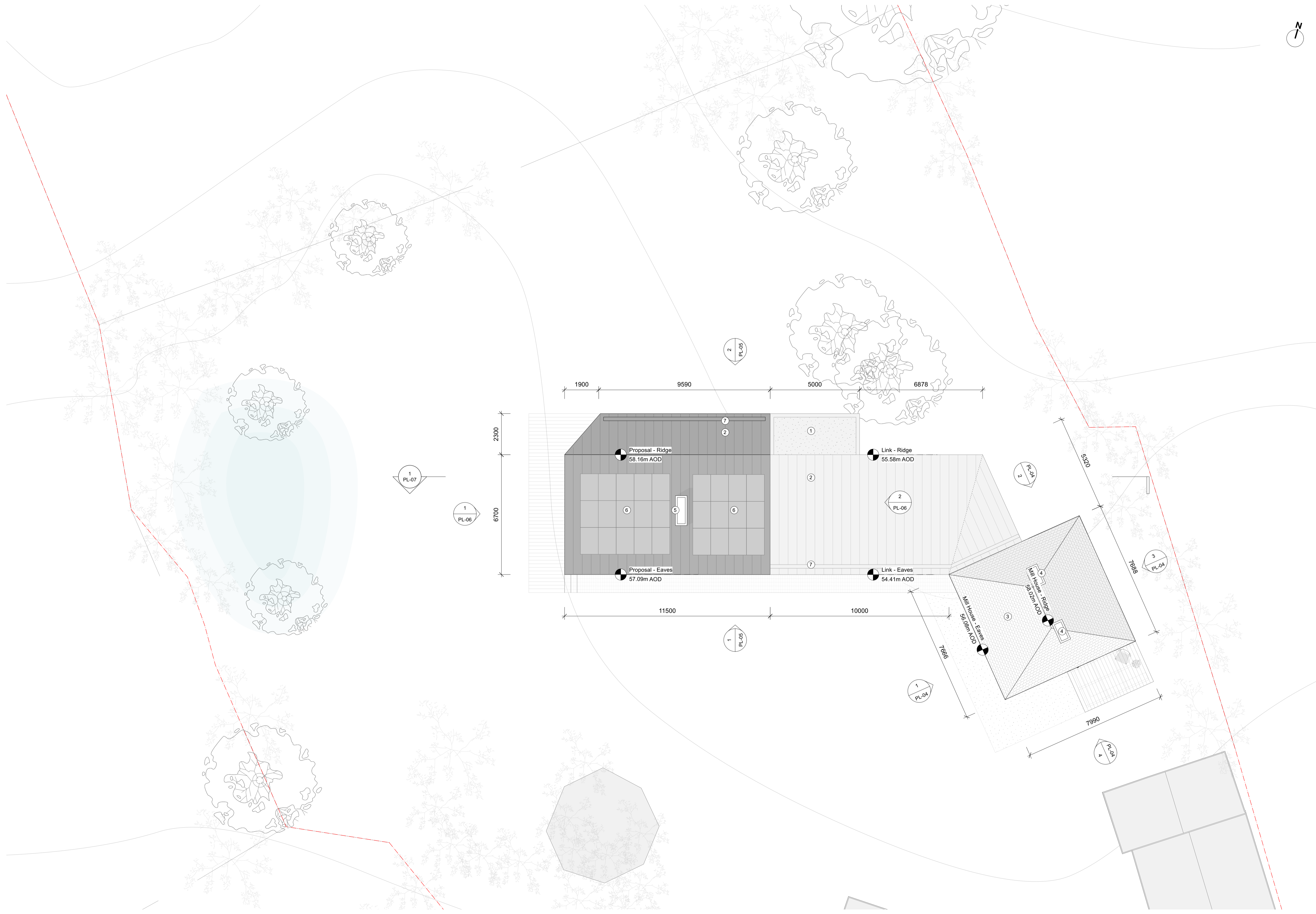

1 Roof Plan as Proposed  
 PL-03 Scale: 1:100



Notes

Use figured dimensions only. Do not scale from this drawing. Issued for purpose indicated only. All dimensions to be checked on site. Architect to be notified of any discrepancies before construction commences. Structural and services information is indicative only - refer to consultants' drawings and specification for details and setting out. All work and materials to be in accordance with current applicable statutory legislation and to comply with all relevant codes of practice and British and European standards. Information contained within this drawing is the sole copyright of IF\_DO (IF Design Office Ltd) and not to be reproduced without expressed wishes.

Revisions

27/07/23 Issue for Planning

Consultants

Key Plan

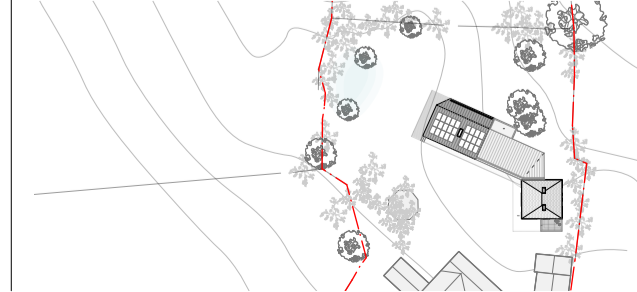

Client

David Nicholson & Ruth Hawkins

Project

Mill House

Drawing Title

Roof Plan as Proposed

Drawing Status	Drawn	Checked	Revision
PL	JW	AS	-

Project No.	Date	Scale @ A1	Scale @ A3
2206	25/07/23	1:100	1:200

Drawing Number  
2206-PL-03

# IF\_DO

J311, The Biscuit Factory, Drummond Road, London, SE16 4DU  
 +44 (0)203 645 6789  
 info@ifdo.co  
 www.ifdo.co