

Existing Site Plan

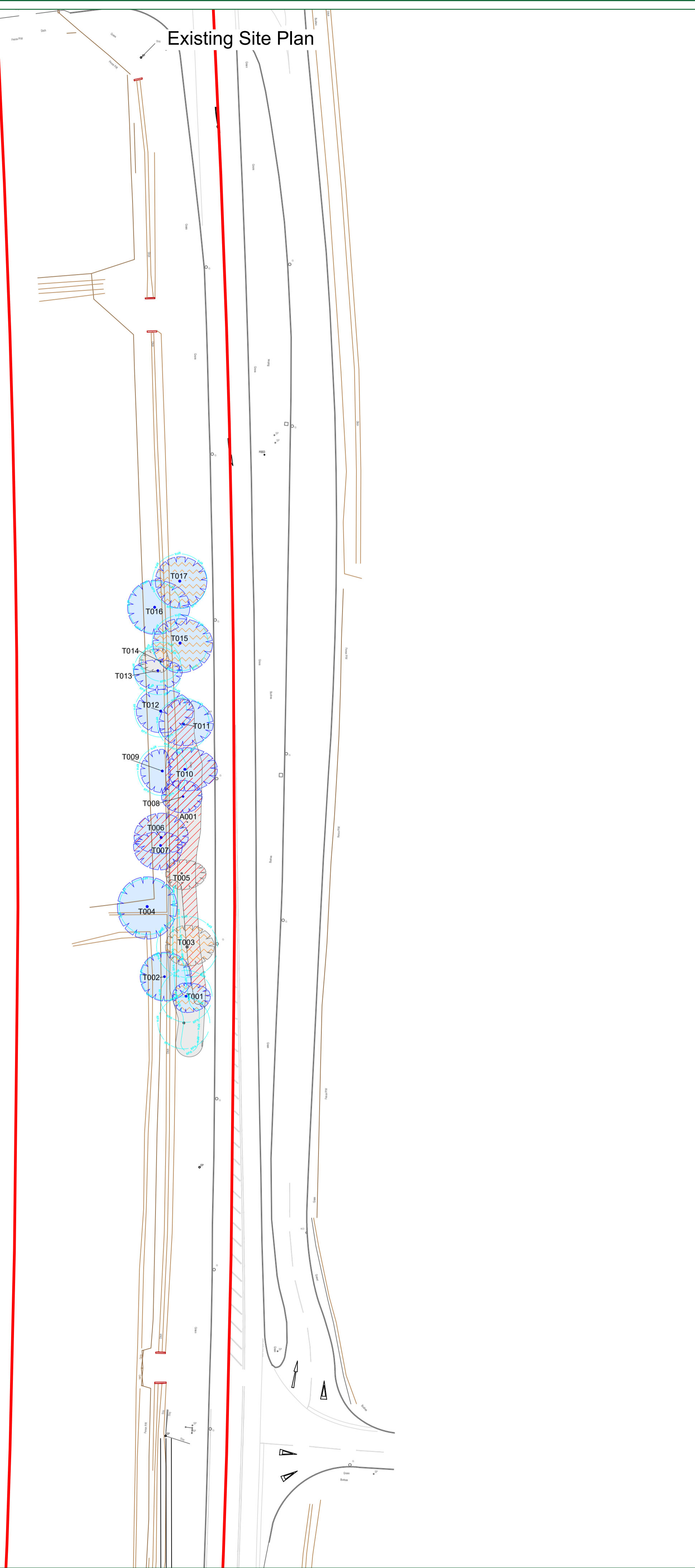

Proposed Site Plan

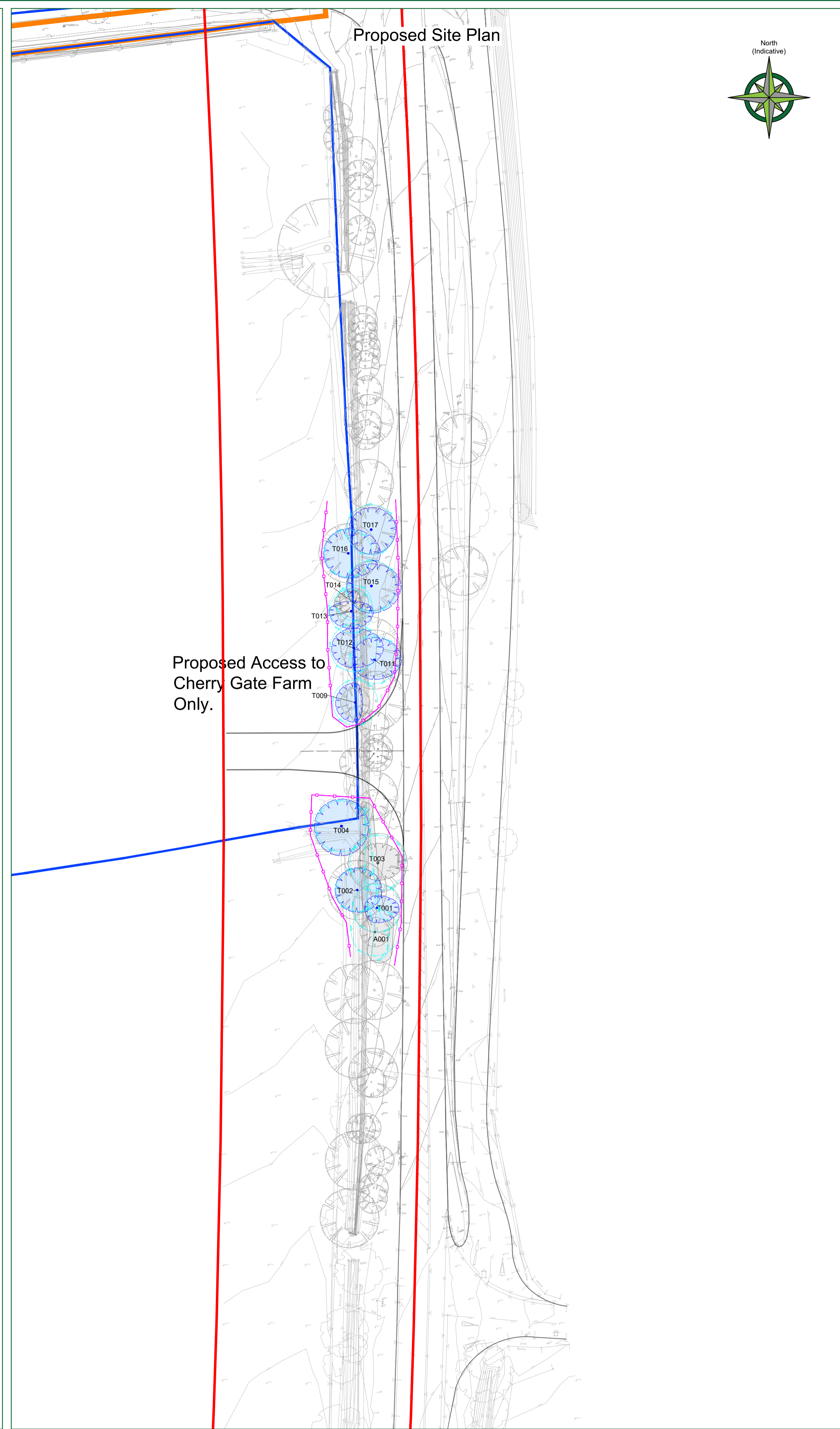

Proposed Access to
Cherry Gate Farm
Only.

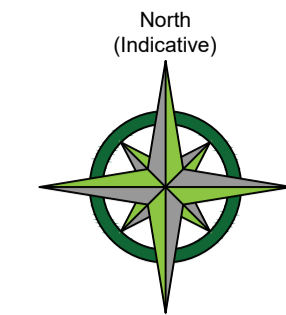

CATEGORY AND DEFINITION

Trees unsuitable for retention	
Category U	Those in such condition that they cannot realistically be retained as living trees in the current land use for longer than 10 years
Trees to be considered for retention	
Category A	Trees of high quality with an estimated remaining life expectancy of at least 40 years
Category B	Trees of moderate quality with an estimated remaining life expectancy of at least 20 years
Category C	Trees of low quality with an estimated remaining life expectancy of at least 10 years, or young trees with a stem diameter below 150mm

NOTE:

Hayden's Arboricultural Consultants were provided with a Topographical Survey but these do not always show the positions of all the trees/features on site. The locations of any additional features have been fixed using GPS. As such the position of the trees/landscape features should not be taken as exact but gives a fair distribution of their locations on site.

LEGEND

	Existing Tree/Feature BS 5837:2012 Category B
	Existing Tree/Feature to be crown lifted to allow for development
	Existing Tree/Feature to be removed to allow for development BS 5837:2012 Category B
	Existing Tree/Feature BS 5837:2012 Category C
	Existing Tree/Feature to be crown lifted to allow for development
	Existing Tree/Feature to be removed to allow for development BS 5837:2012 Category C
	Line of Root Protection Area (RPA) - calculated following guidelines set in BS 5837:2012
	Line of proposed temporary protective barrier

Rev: 02/06/23 Hvb Based on BBSurveys topo drg no. 2219-3804 Rev A & GHBullarad & Associates LLP drg no. 292/2022/010_P1

The position, condition, and dimensions of the trees are based on a site survey undertaken on 12/05/23

"The original of this drawing was produced in colour - a monochrome copy should not be relied upon"

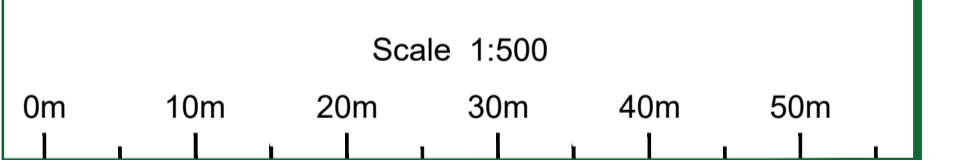

© HAYDEN'S 2023
5 Moseleys Farm Business Centre
Fornham All Saints,
Bury St Edmunds
Suffolk IP28 6JY
Head Office: 01284 765391
Southern Office: 01722 657423
www.treesurveys.co.uk Email: info@treesurveys.co.uk

Client: John Denny Associates Ltd. Drawing Title: Prelim AIA

Site: New Access of A140, White Oak Farm, Brockford Green, Suffolk, IP14 5NJ

Date: 02/06/23 Drawn By: Hvb Cad File Ref: CllPro\10287-D-AIA

Scale: 1:500 (A1) Checked By: SHO Drawing No: 10287-D-AIA Rev: -