

ACCOMMODATION SCHEDULE	GROSS EXTERNAL AREA (m <sup>2</sup> )
Existing bungalow	188.49m <sup>2</sup>
Existing garage and adj. workshop	45.14m <sup>2</sup>
Sub total	233.63m <sup>2</sup>
Proposed new bungalow	149.29m <sup>2</sup>
Proposed new garage workshop	57.94m <sup>2</sup>
Sub total	207.23m <sup>2</sup>
Site Area = 1517.88m <sup>2</sup> (0.375Acres)(0.15Ha)	

AS CONSENTED UNDER REF. 21/01982/FUL

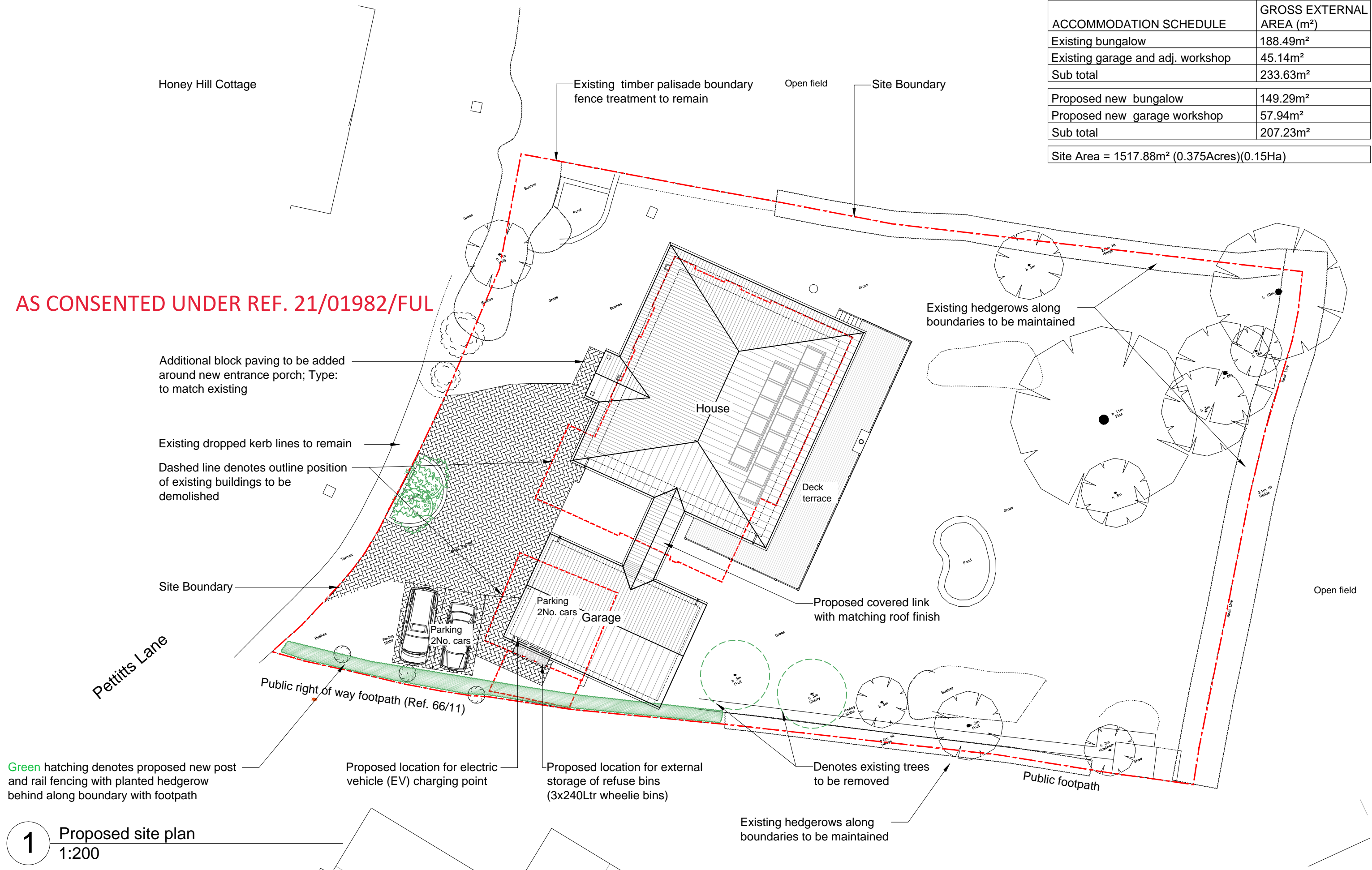

Green hatching denotes proposed new post and rail fencing with planted hedgerow behind along boundary with footpath

1 Proposed site plan  
1:200

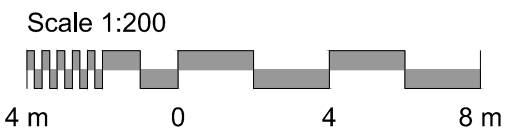

No. 44 Pettitts Lane

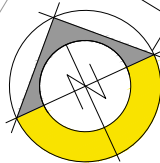

REV.	DATE	NOTES	BY	CHECKED
-	-	First Issue	-	-
A	03-04-20	Footpath added around Garage; boundary treatment notes added	JW	AB
B	05-06-20	Drawing title amended	JW	AB
C	12-04-21	Location and size of proposed garage / Workshop amended	JW	AB
D	21-04-21	Extent of block paving reduced.	JW	AB

PROJECT	46 Pettitts Lane Dry Drayton CB23 8BT
CLIENT	Mr David Alexander
DWG INFORMATION	X:\Jobs\2402\46 Pettitts Lane, Dry Drayton\A.0 Drawings\Drawing Sheets\2402 010 Proposed site (Block) plan.dwg

DRAWING TITLE		
Proposed site (Block) plan		
JOB NO.	DWG. NO.	STATUS
E 2402	010	Planning
SCALE	DWG. SIZE	REV.
1: 200	A3	D

**ecodesign** consultants  
Architects & Environmental Consultants

3 Parklands, Great Linford  
Milton Keynes, MK14 5DZ  
T: 01908 886854  
E: studio@ecodesignconsultants.co.uk  
W: www.ecodesignconsultants.co.uk

Do not scale from this drawing. All dimensions to be checked on site, before work commences. Any discrepancies must be reported to the architect / contract administrator. COPYRIGHT © This drawing is copyright and issued to you in confidence. It must not be copied, used or disclosed, in whole or in part, to third parties. It remains the property of eco design consultants. Read in conjunction with all relevant structural, mechanical and electrical engineers and landscaping.