

**PROPOSED WINDOW**

TWO-LIGHT CASEMENT @1:10

- Style to match existing windows.
- Exterior Finish - To match existing window frame colour.
- Interior Finish – Gloss White.

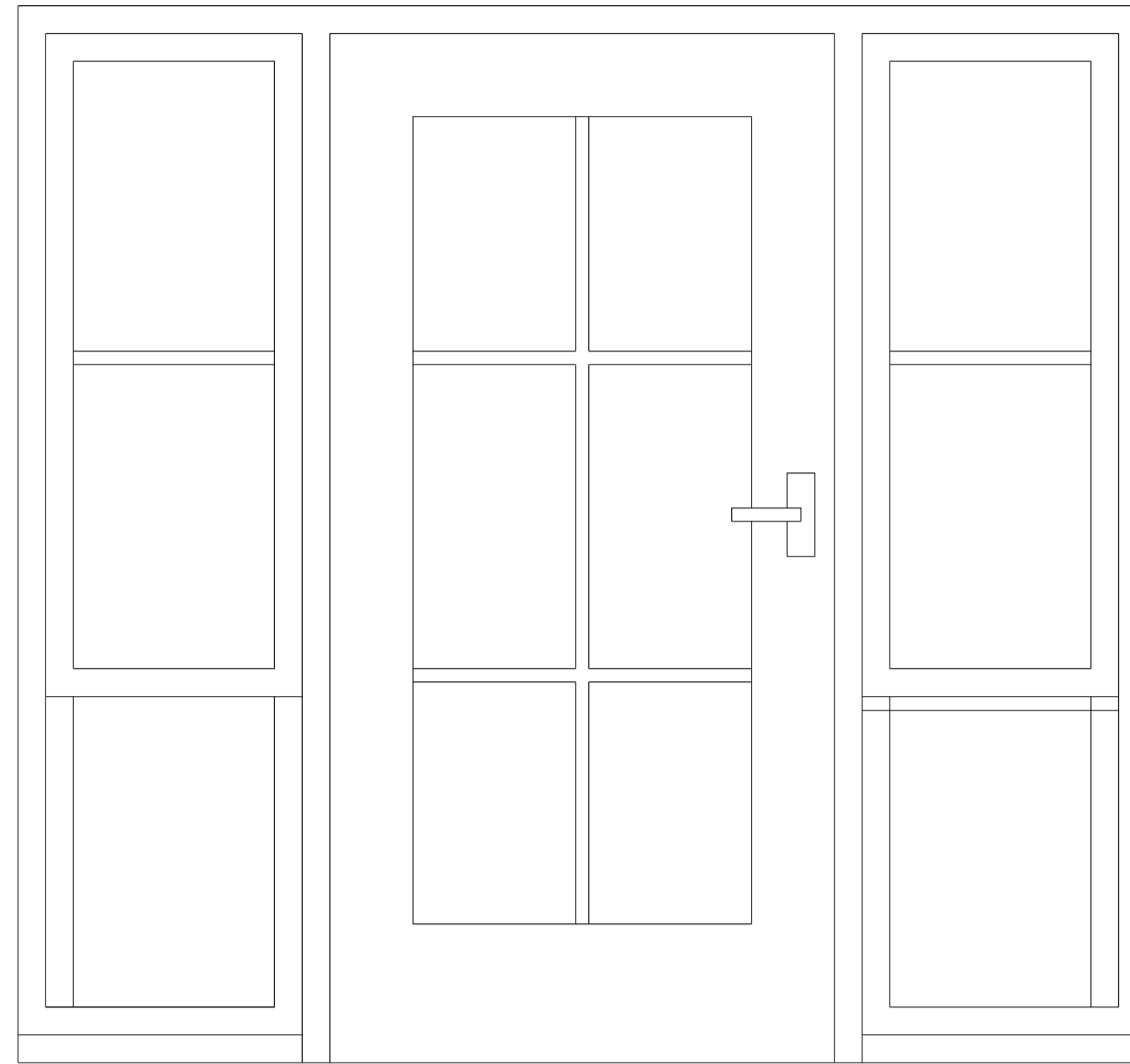

**PROPOSED DOOR**

SINGLE DOOR WITH 2 NO. OPENING SIDELIGHTS @ 1:10

- Style to match proposed window.
- Exterior Finish - To match existing door frame colour.
- Interior Finish – Gloss White.

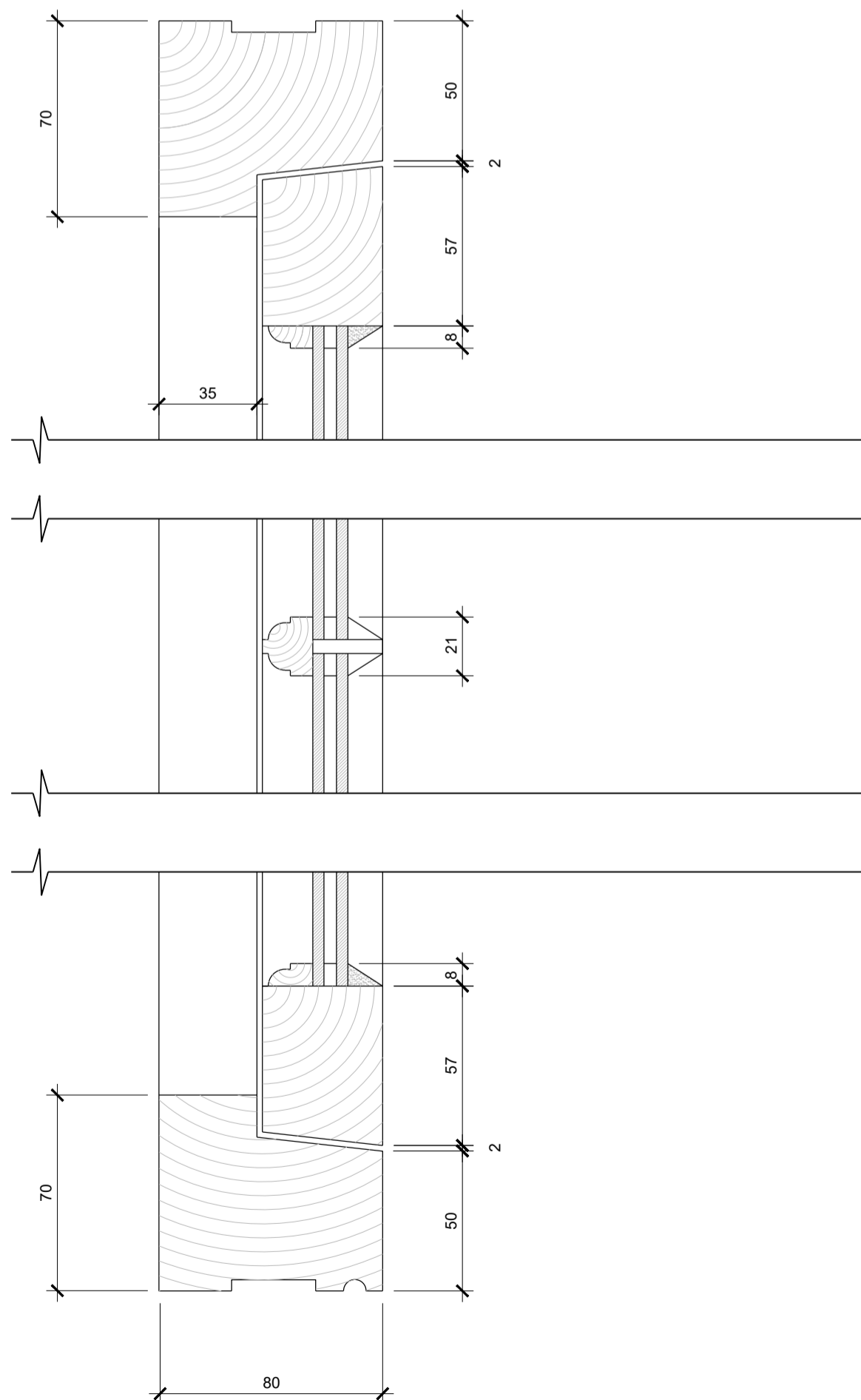

**CASEMENT DETAIL**

SECTION @ 1:2

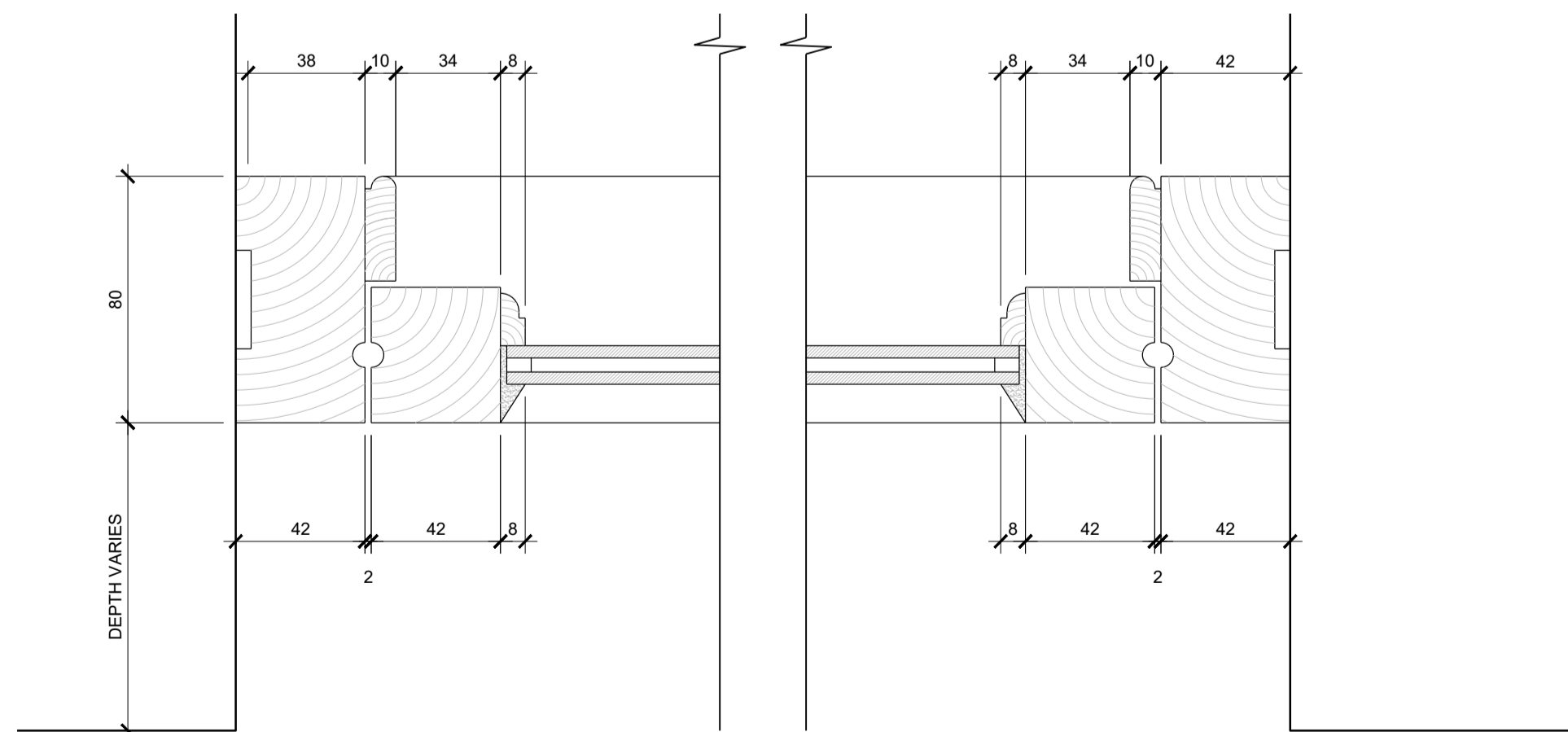

**CASEMENT DETAIL**

PLAN @ 1:2

**Notes:**  
 This drawing is to be read in conjunction with all other relevant architectural drawings.  
 Drawing not to be scaled, use figured dimensions only. All dimensions to be checked on site by the contractor prior to the commencement of any work or specialist production drawing. Any discrepancies to be notified to Hay Associates and further instructions obtained before work is commenced.  
 Copyright © Hay Associates Limited

A	Planning Issue	24.07.2023
Rev.	Note:	Date:
Hay Associates Limited 4100 Park Approach Thorpe Park Leeds LS15 8GB		
0113 880 5500 info@thehayassociates.co.uk www.thehayassociates.co.uk		
<b>Client</b>	Mr. A. Ward	
<b>Project</b>	"MIDWAY", LANCOTT LANE, BRIGHTHAMPTON	
<b>Title</b>	PROPOSED - Window and Door Details	
<b>Scale</b>	As stated @ A1	Date: June 2023
<b>Drawn by</b>	MH	<b>Checked by</b> MH
<b>Project No.</b>	E124	<b>Drawing No.</b> PA02
	<b>Revision</b> A	<b>Status</b> Planning