

- Notes**
1. This document and its design content is copyright © by SDA.
 2. This document and its design is the property of SDA and is not to be used, copied, communicated or disclosed, in whole or in part, except in accordance with a contract, license or agreement in writing with SDA.
 3. The document shall be read in conjunction with all other associated project information including models, specifications, schedules, risk assessments, related consultant & client documents.
 4. All dimensions are in millimeters unless noted otherwise.
 5. All dimensions to be checked on site.
 6. SDA prefer to document dimensions, even though a scale bar may be present, please call us to establish correct dimensions if they are not shown.
 7. Immediately report any discrepancies, errors or omissions to SDA. If in doubt, please contact SDA.

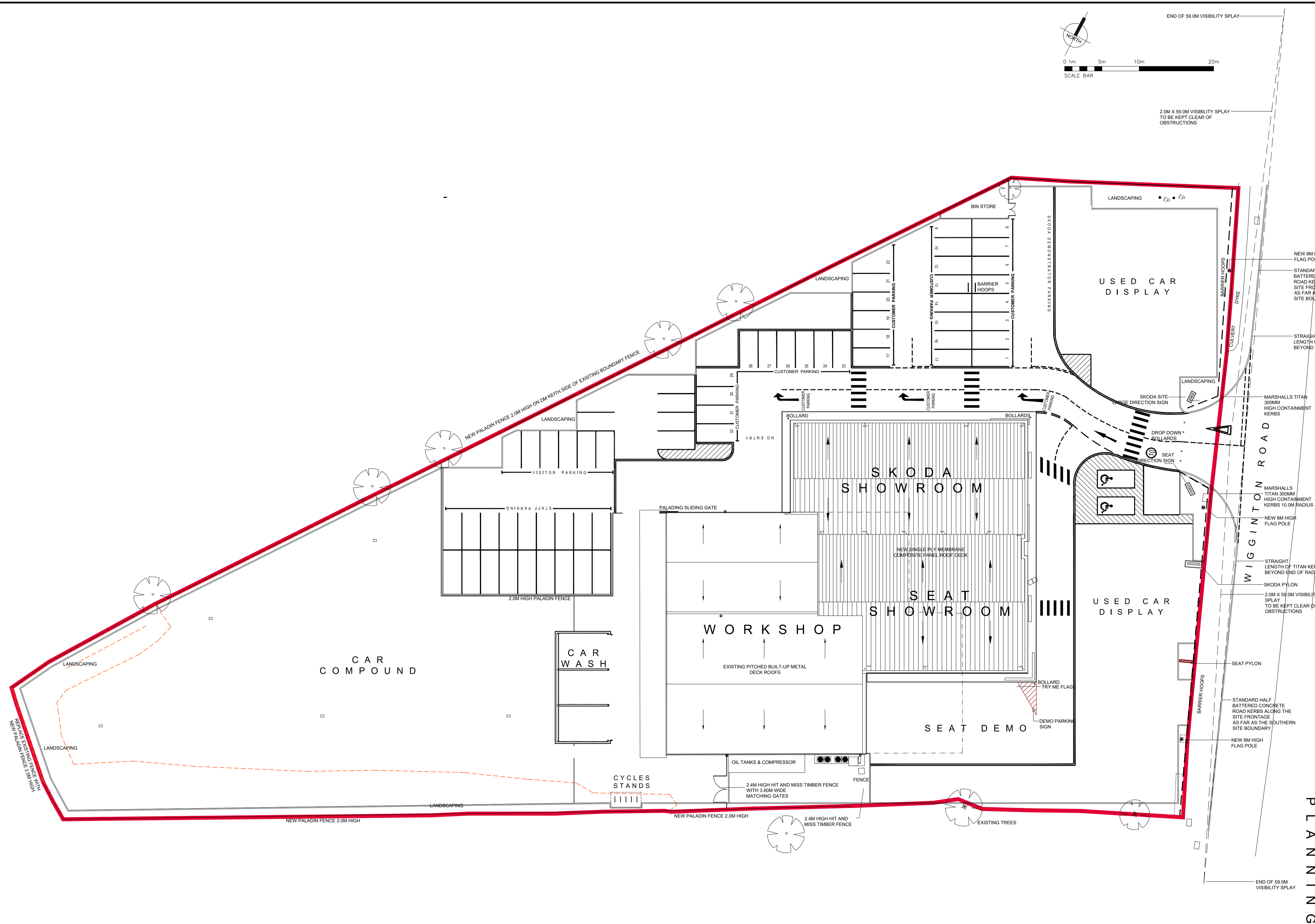

- NEW 8M HIGH FLAG POLE
- STANDARD HALF BATTERED CONCRETE ROAD KERBS ALONG THE SITE FRONTAGE AS FAR AS THE NORTHERN SITE BOUNDARY
- STRAIGHT LENGTH OF TITAN KERB BEYOND END OF RADIUS
- MARSHALLS TITAN 300MM HIGH CONTAINMENT KERBS
- MARSHALLS TITAN 300MM HIGH CONTAINMENT KERBS 10.0M RADIUS
- NEW 8M HIGH FLAG POLE
- STRAIGHT LENGTH OF TITAN KERB BEYOND END OF RADIUS
- SKODA PYLON
- 2.0M X 59.0M VISIBILITY SPLAY TO BE KEPT CLEAR OF OBSTRUCTIONS
- SEAT PYLON
- STANDARD HALF BATTERED CONCRETE ROAD KERBS ALONG THE SITE FRONTAGE AS FAR AS THE SOUTHERN SITE BOUNDARY
- NEW 8M HIGH FLAG POLE
- END OF 59.0M VISIBILITY SPLAY

C01	10/07/23	FOR PLANNING	LB	IH
P01	07/07/23	FIRST ISSUE	LB	IH

REV.	DATE	DESCRIPTION	DRN.	CHKD.
------	------	-------------	------	-------

CLIENT
DM KEITH

PROJECT
PROPOSED BYD SHOWROOM AND VALET BUILDING WIGGINGTON ROAD, YORK YO32 2RJ

TITLE
EXISTING SITE PLAN

SUITABILITY CODE A3	PURPOSE OF ISSUE APPROVED FOR STAGE 3
DWG No. Ref: A1N0016 - SDA - 00 - XX - DR - A - 00100	Rev: C01
SCALE 1:250@A1	DATE JULY 2023
DRAWN LB	CHECKED IH

SDA ARCHITECTS

THE BASILICA PENTHOUSE
LEEDS LS1 6LS
T: +44 (0)113 288 1000
mail@sdaarchitects.co.uk

2 KING CHARLES STREET
LEEDS LS1 6LS
mail@sdaarchitects.co.uk

BSI REGISTERED FS 56715

P L A N N I N G