

Lighting Calculations

PROJECT : Eddington
DATE : 23/11/22
REF : 4303_09_010

Eddington – Lighting Calculations

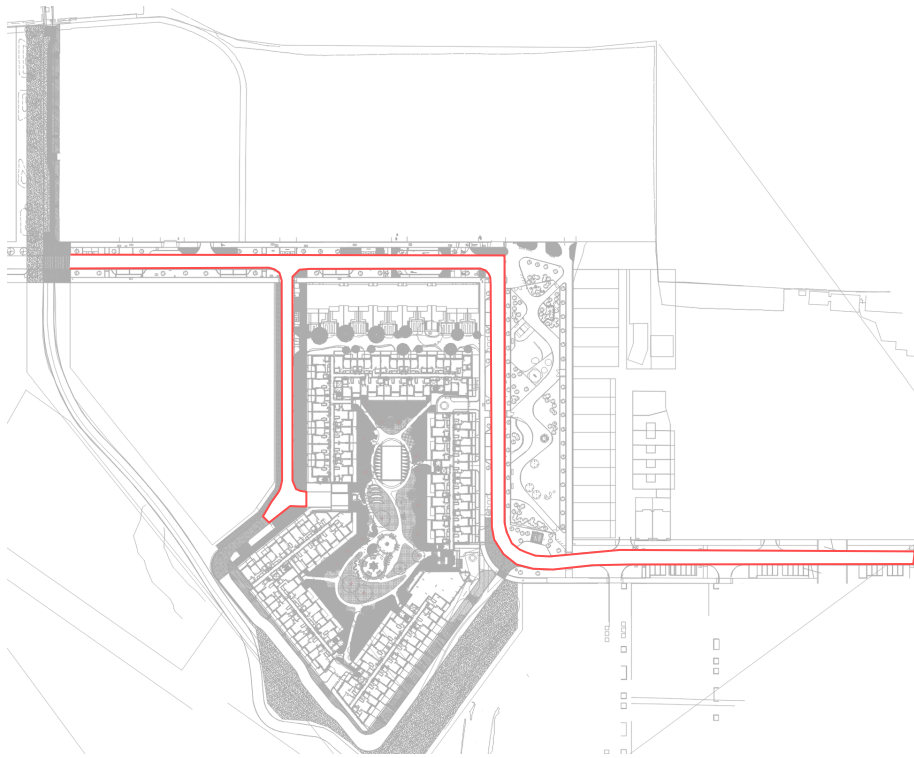

Description of area: *Main Road*

Lighting Requirements: Lighting Class C3 – 15lux, Uniformity of 0.44

Relevant Lighting Codes and Guidelines:

- CIBSE LG6
- BS5489 - BSEN13201-02 (2020)
- ILE Guidance for the Reduction of Light Pollution (2015)
- ILE The Outdoor Lighting Guide (2005)
- ILP Guidance, Bats and Artificial Lighting in the UK (2019)
- CIBSE Fact File 7: Environmental Considerations for Exterior Lighting (2003)
- SLL LG6 :The Exterior Environment (1992)
- CIE136: Guide to the lighting of Urban Areas (2000)

Calculation Output Information:

Light level at floor level:	18	(lux average)
Min / Max:	0.41	(lux)
Uniformity:	0.63	(Uo)
Maintenance Factor:	0.8	

floor level is 0.100m above the finish floor unless otherwise stated.

Calculations Prepared by: L. Dowding

Approved By: C.Sutherland

Date: 23/11/22

Eddington – Lighting Calculations

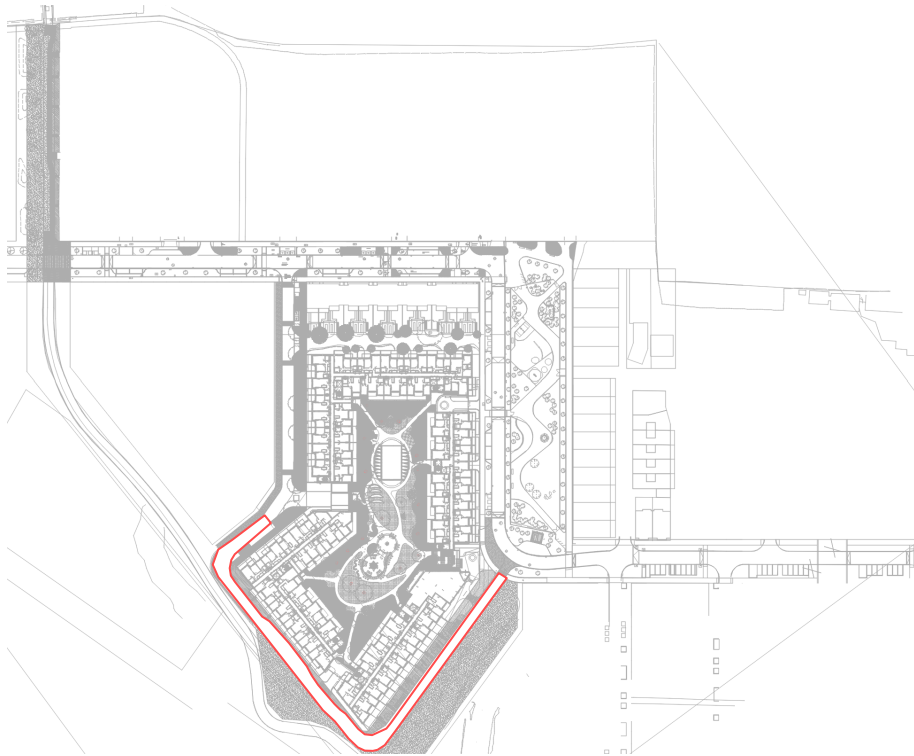

Description of area: *Refuse Road*

Lighting Requirements: Lighting Class C4 – 10lux, Uniformity of 0.44

Relevant Lighting Codes and Guidelines:

CIBSE LG6

BS5489 - BSEN13201 (2020)

ILE Guidance for the Reduction of Light Pollution (2015)

ILE The Outdoor Lighting Guide (2005)

ILP Guidance, Bats and Artificial Lighting in the UK (2019)

CIBSE Fact File 7: Environmental Considerations for Exterior Lighting (2003)

SLL LG6 :The Exterior Environment (1992)

CIE136: Guide to the lighting of Urban Areas (2000)

Calculation Output Information:

Light level at floor level:	13	(lux average)
Min / Max:	0.35	(lux)
Uniformity:	0.61	(Uo)
Maintenance Factor:	0.8	

floor level is 0.100m above the finish floor unless otherwise stated.

Calculations Prepared by: L. Dowding

Approved By: C.Sutherland

Date: 23/11/22

Eddington – Lighting Calculations

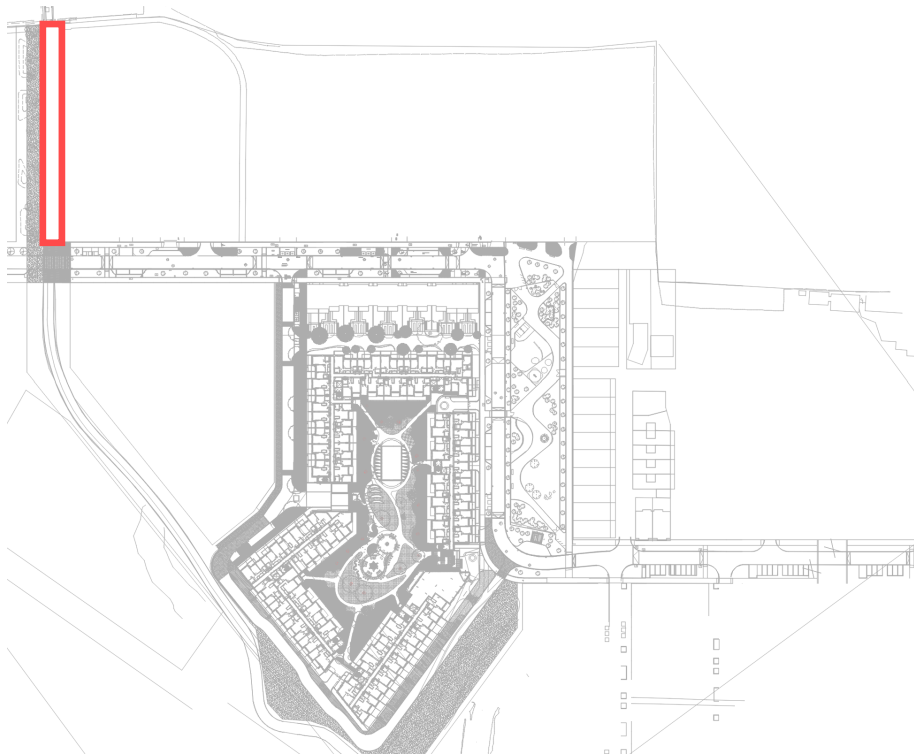

Description of area: *Cycle Road*

Lighting Requirements: Lighting Class P2 - 10lux at floor level

Relevant Lighting Codes and Guidelines:

CIBSE LG6

BS5489 - BSEN13201 (2020)

ILE Guidance for the Reduction of Light Pollution (2015)

ILE The Outdoor Lighting Guide (2005)

ILP Guidance, Bats and Artificial Lighting in the UK (2019)

CIBSE Fact File 7: Environmental Considerations for Exterior Lighting (2003)

SLL LG6 :The Exterior Environment (1992)

CIE136: Guide to the lighting of Urban Areas (2000)

Calculation Output Information:

Light level at floor level:	13.1	(lux average)
Min / Max:	0.48	(lux)
Uniformity:	0.62	(Uo)
Maintenance Factor:	0.8	

floor level is 0.100m above the finish floor unless otherwise stated.

Calculations Prepared by: L. Dowding

Approved By: C.Sutherland

Date: 23/11/22