

0 10 20 30 40 50 M

SCALE 1:500 @ A3

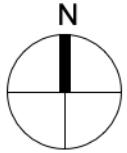

General notes:

1. Contractor to check all dimensions on site prior to production of any shop drawings, fabrication and commencement on site.
2. Drawings to be read in conjunction with full set of drawings, schedules, specifications and information from Structural Engineer and other Consultants.
3. All work to comply with current Building Regulations and all relevant regulations.
4. Contractor to refer all discrepancies to Architect.
5. Tender documentation for costing purposes only. Unless marked 'For Construction' drawings should not be used for construction.
6. All building materials and products to be installed to manufacturer's recommendations.

Proposed bin collection point as per existing consent ref: 20/01210/OUT with stone walling to match existing and 1.2m high timber gate.

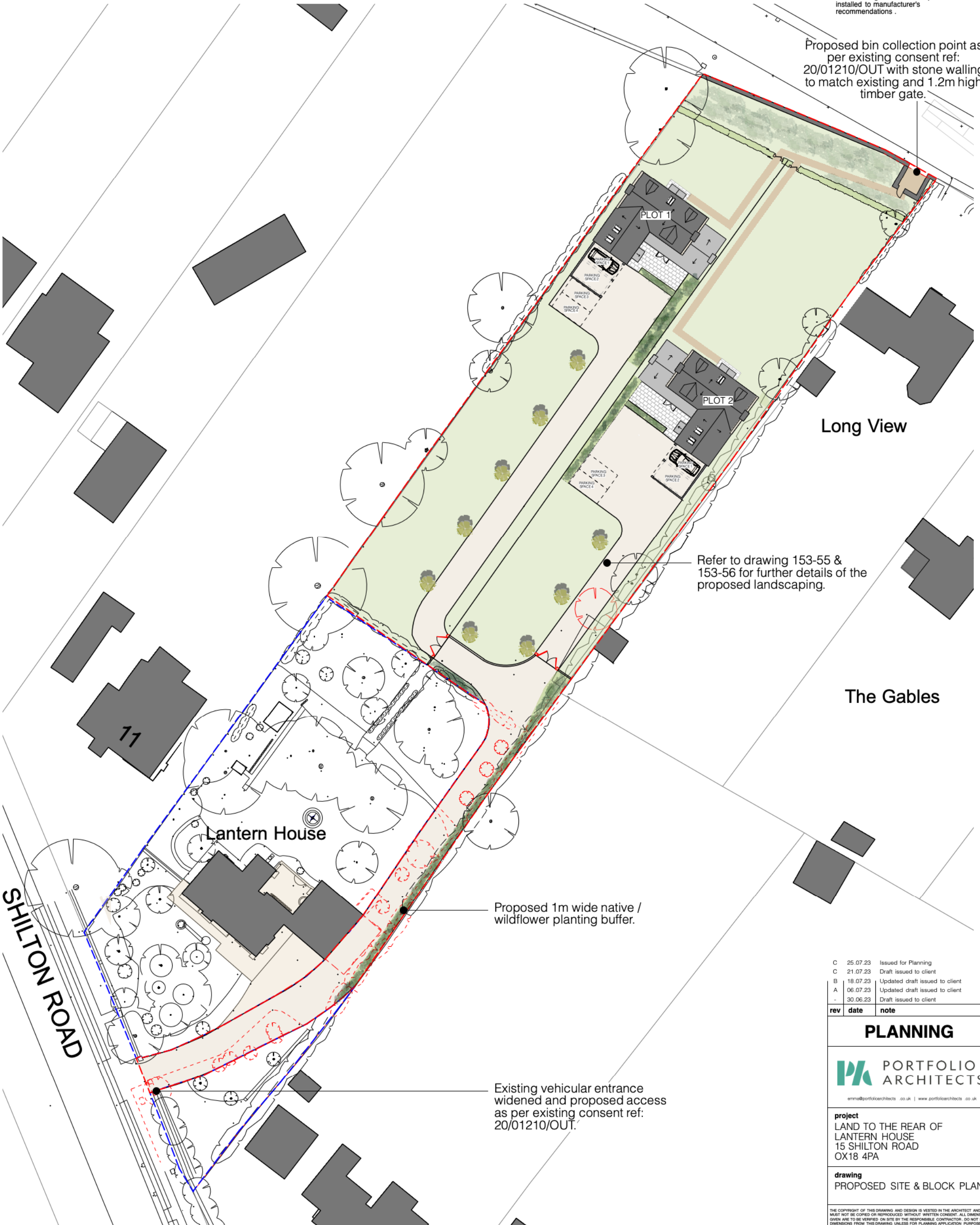

Long View

Refer to drawing 153-55 & 153-56 for further details of the proposed landscaping.

The Gables

Lantern House

11

SHILTON ROAD

Proposed 1m wide native / wildflower planting buffer.

Existing vehicular entrance widened and proposed access as per existing consent ref: 20/01210/OUT.

C	25.07.23	Issued for Planning
C	21.07.23	Draft issued to client
B	18.07.23	Updated draft issued to client
A	06.07.23	Updated draft issued to client
-	30.06.23	Draft issued to client
rev	date	note

PLANNING



project  
LAND TO THE REAR OF  
LANTERN HOUSE  
15 SHILTON ROAD  
OX18 4PA

drawing  
PROPOSED SITE & BLOCK PLAN

THE COPYRIGHT OF THIS DRAWING AND DESIGN IS VESTED IN THE ARCHITECT AND MUST NOT BE COPIED OR REPRODUCED WITHOUT WRITTEN CONSENT. ALL DIMENSIONS GIVEN ARE TO BE VERIFIED ON SITE BY THE RESPONSIBLE CONTRACTOR. DO NOT SCALE DIMENSIONS FROM THIS DRAWING UNLESS FOR PLANNING APPLICATION PURPOSES.

scale 1:500@A3 dwg no 153-50 rev C