

# PROPOSED EXTERNAL SURFACE DETAILS

- General notes:
1. Contractor to check all dimensions on site prior to production of any shop drawings, fabrication and commencement on site.
  2. Drawings to be read in conjunction with full set of drawings, schedules, specifications and information from Structural Engineer and other Consultants.
  3. All work to comply with current Building Regulations and all relevant regulations.
  4. Contractor to refer all discrepancies to Architect.
  5. Tender documentation for costing purposes only. Unless marked 'For Construction' drawings should not be used for construction.
  6. All building materials and products to be installed to manufacturer's recommendations.



**Local Cotswold Stone**



**Natural timber featheredge horizontal cladding or similar**



**High Quality Heritage Reproduction Stone Conservation Slate**

1 External Elevations  
Local Stone

2 Timber Cladding

3 Roof



**High quality painted timber sash windows with sash horns.**  
Slimline / conservation double glazing



**VELUX conservation style rooflight (recessed)**  
Double glazed

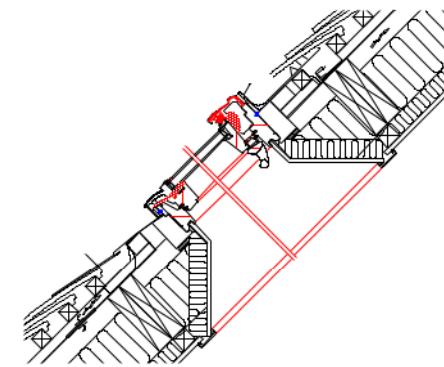

4 Proposed Windows

5 Proposed Rooflights  
1:20 @ A3



**Alutec Traditional Half Round Heritage Black aluminium rainwater goods or similar**

6 Rainwater Goods

rev	date	note
A	25.07.23	Issued for Planning
-	24.07.23	Draft issued to client

## PLANNING



**project**  
LAND TO THE REAR OF  
LANTERN HOUSE  
15 SHILTON ROAD  
OX18 4PA

**drawing**  
PROPOSED MATERIALS 1 OF 2

THE COPYRIGHT OF THIS DRAWING AND DESIGN IS VESTED IN THE ARCHITECT AND MUST NOT BE COPIED OR REPRODUCED WITHOUT WRITTEN CONSENT. ALL DIMENSIONS GIVEN ARE TO BE VERIFIED ON SITE BY THE RESPONSIBLE CONTRACTOR. DO NOT SCALE DIMENSIONS FROM THIS DRAWING UNLESS FOR PLANNING APPLICATION PURPOSES.

scale	dwg no	rev
NTS@A3	153-57	A