

Proposed landscaping plan continues on drawing 153-55.

0 1 2 3 4 5 6 7 8 9 10 M

SCALE 1:200 @ A3

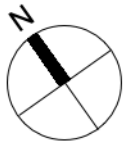

Existing hedgerow retained.

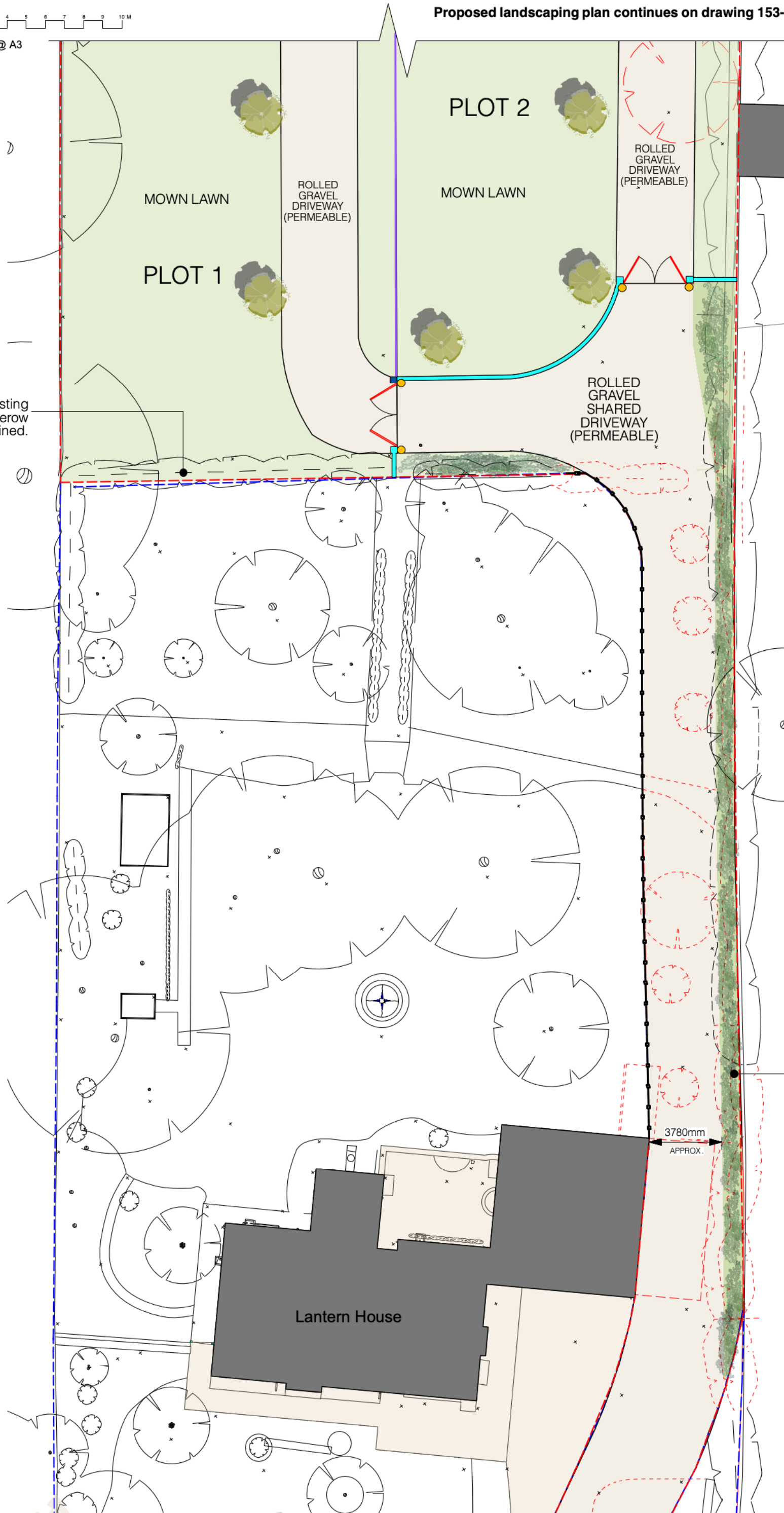

- General notes:
1. Contractor to check all dimensions on site prior to production of any shop drawings, fabrication and commencement on site.
  2. Drawings to be read in conjunction with full set of drawings, schedules, specifications and information from Structural Engineer and other Consultants.
  3. All work to comply with current Building Regulations and all relevant regulations.
  4. Contractor to refer all discrepancies to Architect.
  5. Tender documentation for costing purposes only. Unless marked 'For Construction' drawings should not be used for construction.
  6. All building materials and products to be installed to manufacturer's recommendations.

Proposed Key:

- 1.8m painted timber close boarded fence
- New Hedgerow
- New tree
- Shrubs
- External lighting locations (1.6m high wall mounted IP rated wall lights)
- Proposed log pile location as per Ecology by Design Ltd proposals.
- Proposed bird box location as per Ecology by Design Ltd proposals.
- Proposed bat box location as per Ecology by Design Ltd proposals.
- Proposed invertebrate hotel location as per Ecology by Design Ltd proposals.
- Proposed 1.6m high local stone walling.
- Proposed 1.2m high metal estate fencing.

Proposed 1m wide native / wildflower planting buffer.

3780mm APPROX.

A	25.07.23	Issued for Planning
-	21.07.23	Draft issued to client
rev	date	note

**PLANNING**



project  
LAND TO THE REAR OF  
LANTERN HOUSE  
15 SHILTON ROAD  
OX18 4PA

drawing  
PROPOSED LANDSCAPING,  
LIGHTING & BIODIVERSITY PLAN

THE COPYRIGHT OF THIS DRAWING AND DESIGN IS VESTED IN THE ARCHITECT AND MUST NOT BE COPIED OR REPRODUCED WITHOUT WRITTEN CONSENT. ALL DIMENSIONS GIVEN ARE TO BE VERIFIED ON SITE BY THE RESPONSIBLE CONTRACTOR. DO NOT SCALE DIMENSIONS FROM THIS DRAWING UNLESS FOR PLANNING APPLICATION PURPOSES.

scale 1:200@A3      dwg no 153-56      rev A