

GENERAL NOTES

All dimensions in millimetres unless noted otherwise.
Do not scale from drawings for construction purposes.

All dimensions to be checked on site. All details and dimensions relating the sub-contractors or suppliers work must be checked and agreed between the subcontractors or supplier and the general contractor.

This drawing is to be read in conjunction with all other contract documents, contractor specifications & Schedule of Works prepared by JS Planning Studio.

Works to comply with current Codes of Practice, Eurocode, British Standards and Building Regulations.

Preliminary Issue - Not for construction

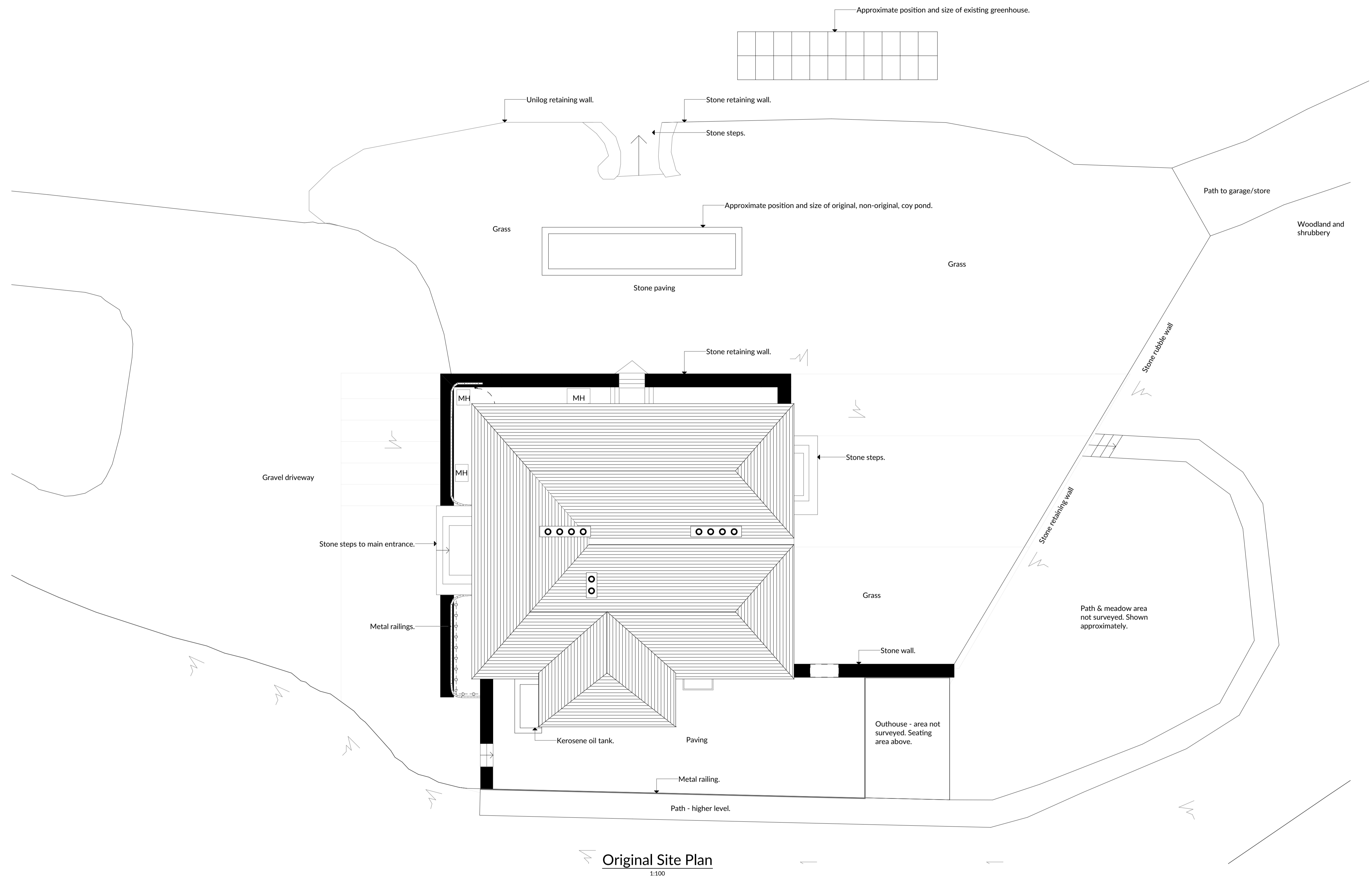

Original Site Plan
1:100

Designers Risk Assessment:

- Installation of heavy beams - Mechanical aids should be employed if required when installing beams.
- Temporary Support - The contractor is to provide all necessary temporary propping to safely undertake the work and maintain structural stability, including sides of excavations for sub structure and retaining elements.
- Confirmation of Structural Layout - The assumptions made within the calculations and drawing should be confirmed on site, prior to commencement of works. Any differences should be discussed with Structural Engineer, in order to check calculations.
- Working at height - Suitable scaffold to be provided in order to carry out works safely.
- Asbestos - Any suspected Asbestos containing materials should be tested and removed by specialist contractors in accordance with HSE guidance.

PLANNING

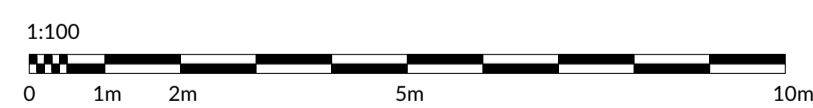

Revision:	Date:	Initials:	Description:
PR2	28/05/2022	JAT	ISSUE FOR COMMENT
PL1	01/06/2022	JSK	ISSUED FOR PLANNING



M Perry Associates Ltd
Parade House, The Parade
Liskeard, Cornwall PL14 6AF
Telephone: 01579 345777
mail@mperryassociates.com
www.mperryassociates.com

MR G SCOTT
PENALLY HOUSE, BOSCASTLE
ORIGINAL SITE PLAN

Scale(s):	Date:	Drawn by:	Checked:
1:100@A1	MAY'22	JAT	MWP
Project No:	Drawing No:	Revision:	
21460	002	PL1	