

location plan 1:1250

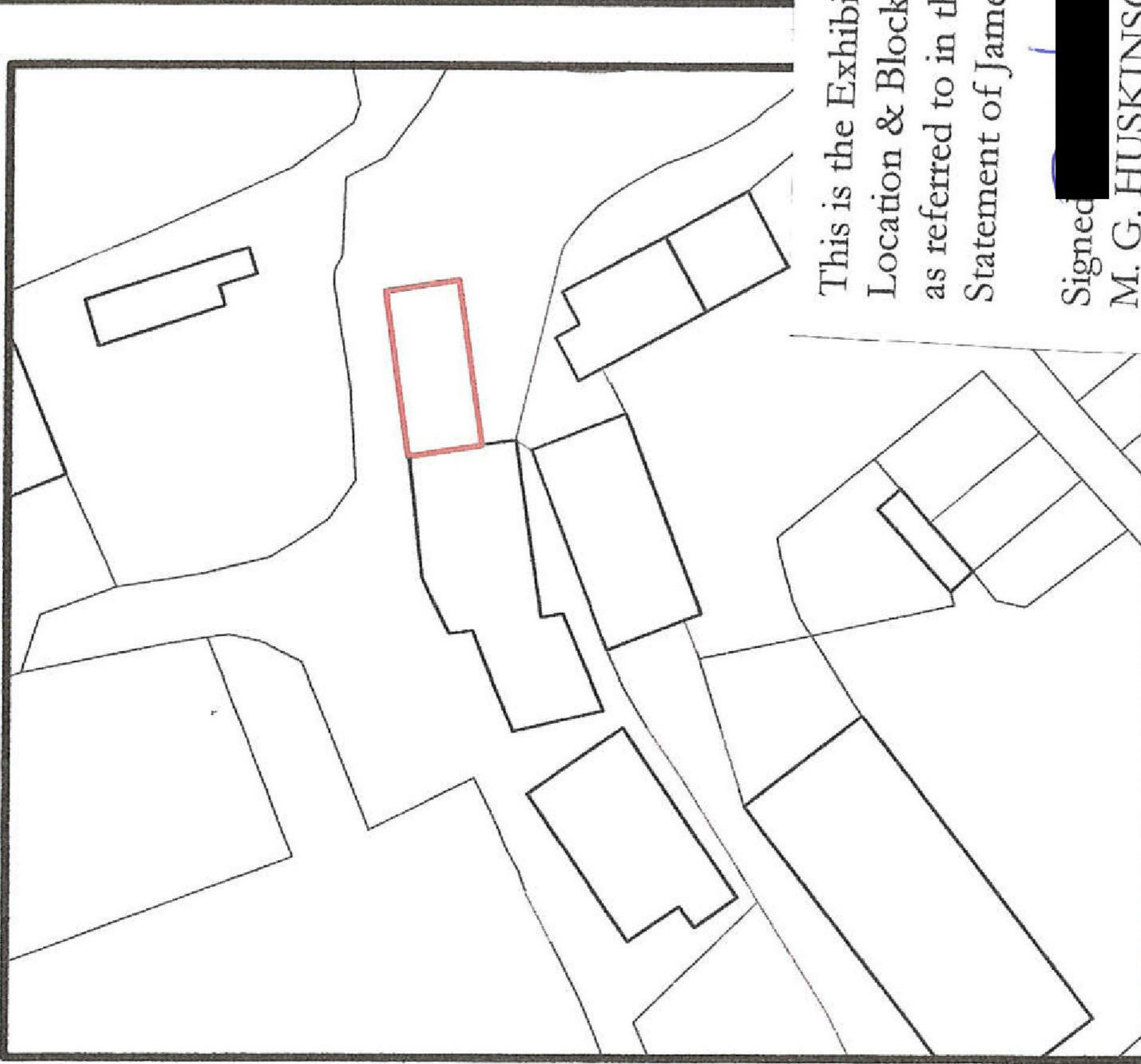

block plan 1:500

This is the Exhibit marked:  
Location & Block Plan  
as referred to in the Witness  
Statement of James Cox

Signed

M. G. HUSKINSON

Commissioner of Oaths

20 January 2021

104.21

Project: Survey of partially completed barn conversion at Goodway Farm, Radford Road, Alvechurch B48 7DY		Drawn by: <b>S. Mumford.</b>	Drg Title: <b>OS Mapping Data</b>	Stewart Mumford <b>Architectural Consulting Ltd.</b> 29, Whitcombs Orchard, Cleobury Mortimer Kidderminster DY14 8RN T. 01299271068 M.07977921039 E. stewart.mumford@btinternet.com	
Client: <b>Mr. R. Haydon</b>		Revision Description:		Date: <b>Sept 2020</b>	Rev.:
		Scale: <b>NTS</b>	Drg. Nr.: <b>02/2020/02c</b>		