

© COPYRIGHT
 The copyright in this drawing is vested in oculis architects and no licence or assignment of any kind has been, or is, granted to any third party whether by provision of copies or originals of the drawings or otherwise unless otherwise agreed in writing.

FOR ELECTRONIC DATA ISSUE
 Electronic data / drawings are issued as "read only" and should not be interrogated for measurement. All dimensions and levels should be read, only from those values stated in text, on the drawing.

AREA MEASUREMENT
 The areas are approximate and can only be verified by a detailed dimensional survey of the completed building. Any decisions to be made on the basis of these provisions, whether as to project viability, pre-letting, lease agreements or the like, should include due allowance for the increases and decreases inherent in the design development and building processes. Figures relate to the built areas of the building at the current stage of the design and using the Gross External Area (GEA) / Gross Internal Area (GIA) / Net Internal Area (NIA) method of measurement from the Code of Measuring Practice, 6th Edition (RCS Code of Practice). All areas are subject to Town Planning and Conservation Area Consent, and detailed Rights to Light analysis.

SCALE BAR:

1:50	0.5	2.0
1:100	1.0	5.0
1:200	2.0	10.0

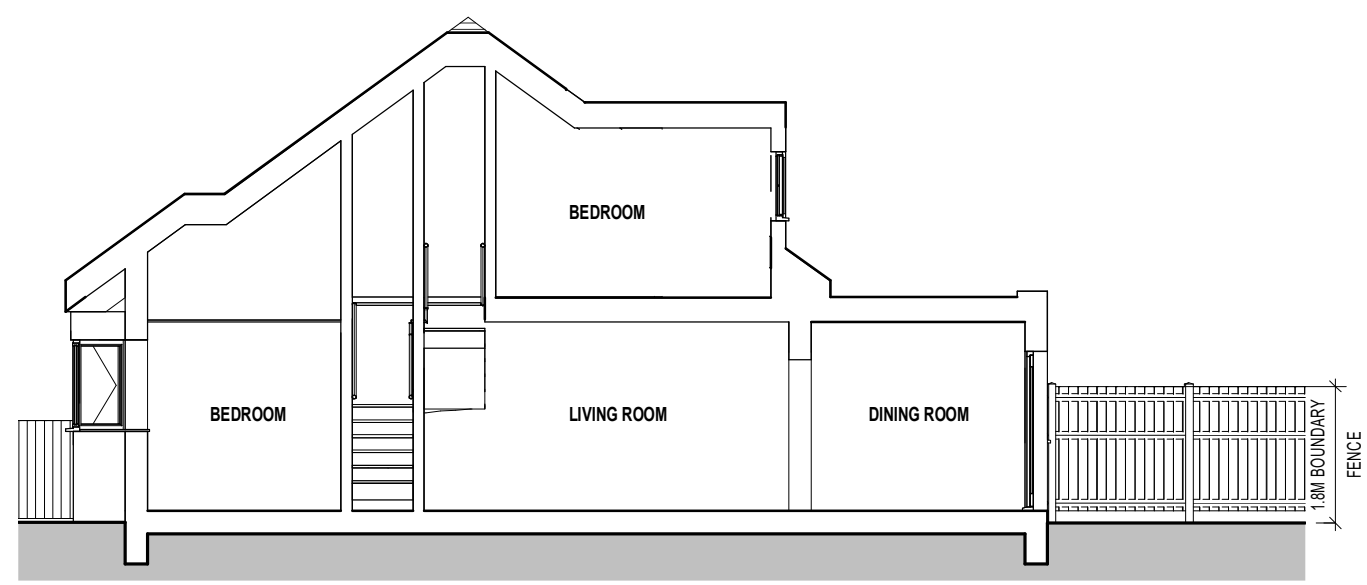

1 EXISTING LONG SECTION
 1 : 100

REV	DATE	AMENDMENT
TITLE		
184 THORNDON AVE BRENTWOOD, CM13 3TP		
oculus architects Ltd 441 West Green Road London N15 3PL www.oarch.co.uk		
DRAWING TITLE		
EXISTING SECTION		
SCALE	1 : 100@ A3	DRAWN BY MN
DATE	2023.05.31	CHECKED BY PA
JOB No.	1158	EC300-300 REV.
STAGE	DRAFT	