

- Notes**
1. Do not scale from this drawing. If in doubt ask.
 2. Contractor to check all dimensions on site prior to the commencement of works and report any discrepancies to the Architect immediately.
 3. To be read in conjunction with all other drawings, bills and specification documents.
 4. Cross refer to structural engineers design for all structural information.

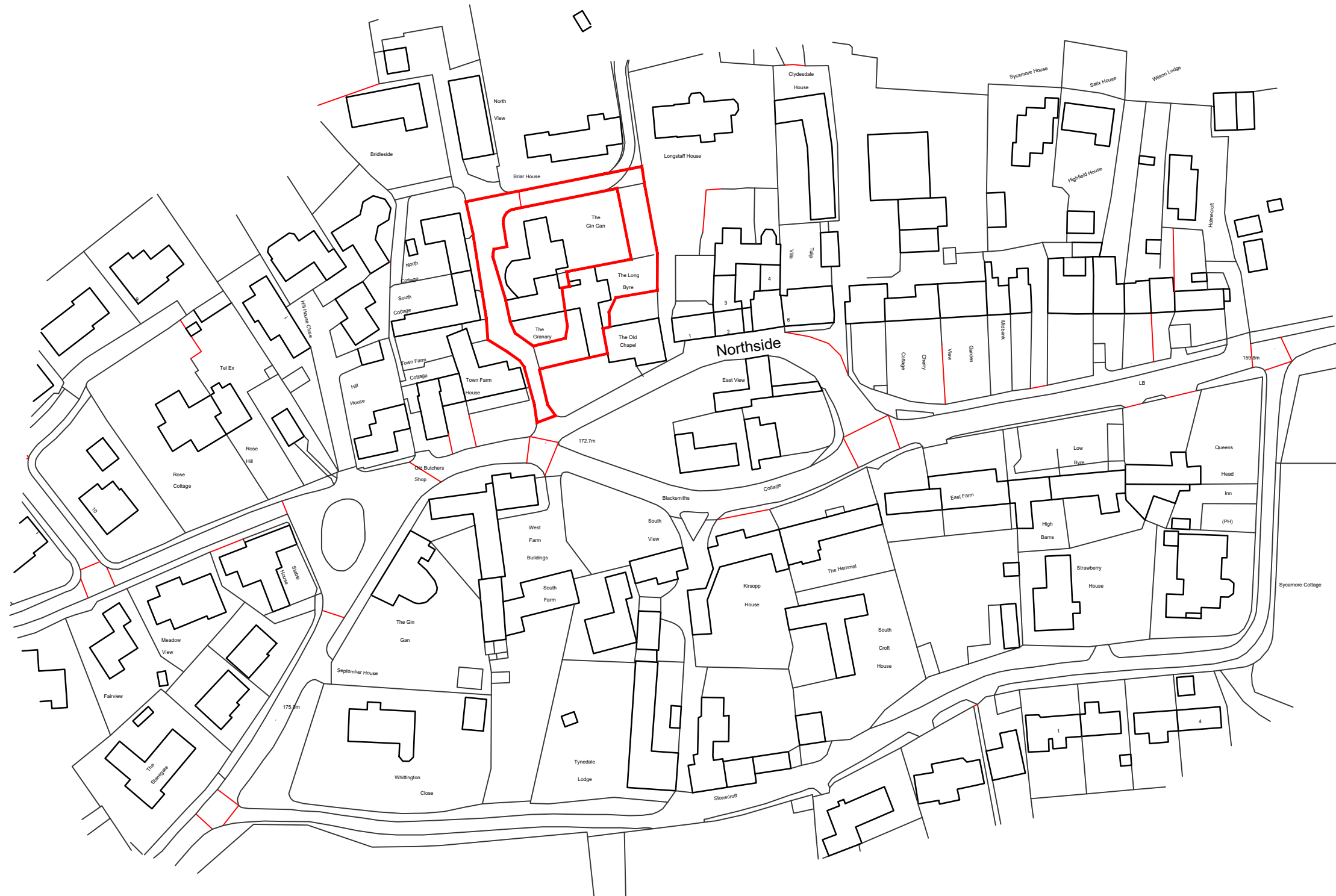

Rev	Date	Description	Rev by	Chkd
A	22.06.23	Layout updated following planning comments	AS	

Status **PLANNING**

idp PARTNERSHIP
G R O U P

IDP-Scotland - 95 South Woodside Rd - Glasgow - G20 6NT
0141 3425400

IDP-England - Beaufront Park - Hexham - Northumberland - NE46 4TU
0191 4063100

email: info@idpartnershipgroup.com

Job / Client
Proposed axillary building to serve the principle dwelling of Long Byres for Ms Vicky Moffitt

Drawing Title
Great Whittington

Proj. Architect	ND	Drawn by	AS	Checked by
Scale @A3	1:1250	Job Number	1424	Drawing Number
Date	21.03.2023.			L 000 A

Location Plan scale 1:1250 @ A3

