

**Planning**

This drawing has been prepared for workstages up to planning application purposes only and is not intended "for construction". The 'scale bar' should only be used to check the drawing has been reproduced to the correct size. No responsibility can be accepted for errors made by others in "scaling" from this drawing.

Tyack Architects Ltd own copyright of the original design work in the drawings, documents and digital files which cannot be copied, loaned or disclosed without written agreement. Please refer to our Standard Terms of Business.

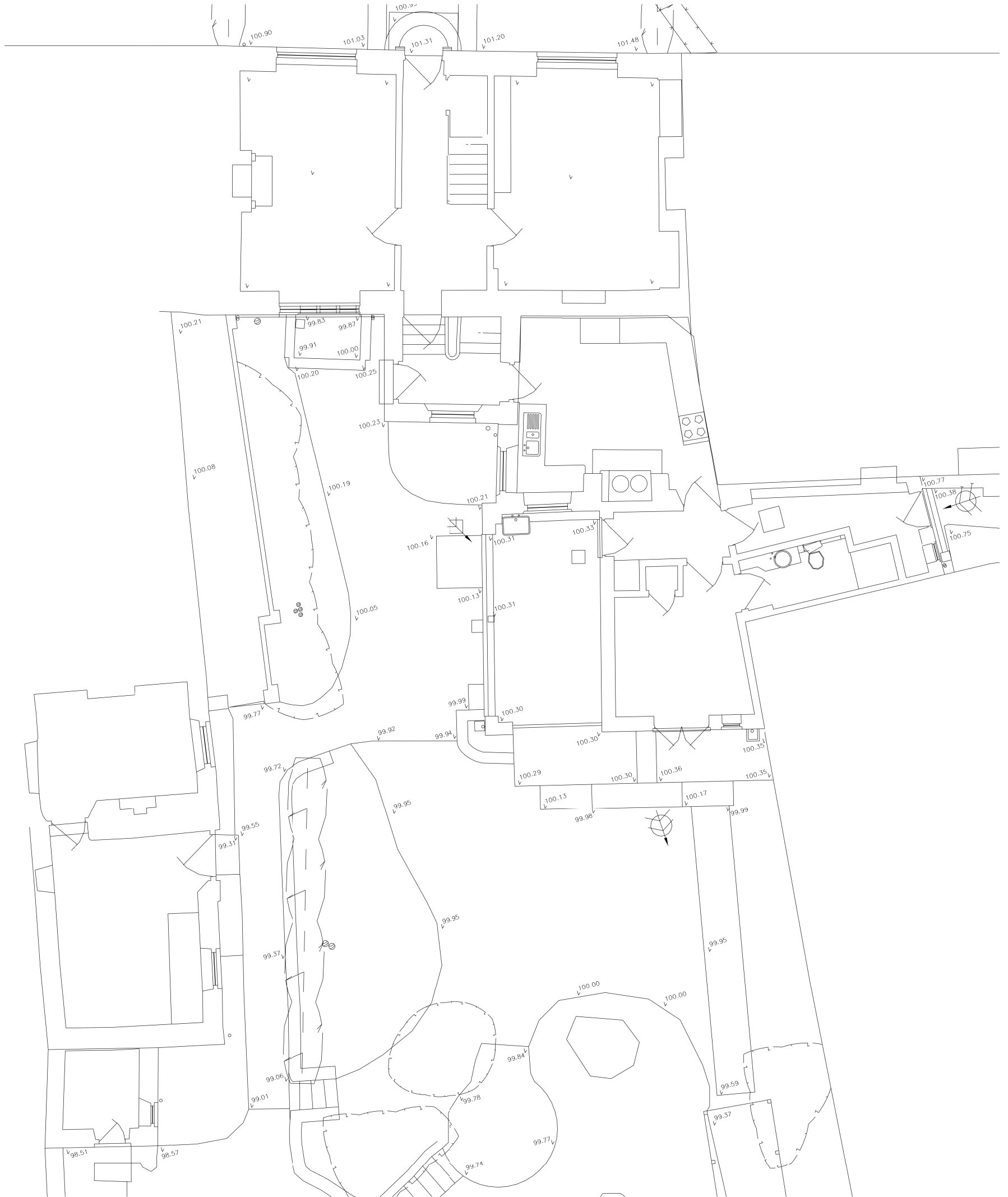

Scale 1:100 5m



Tyack Architects Ltd  
The Mann Institute  
Oxford Street  
Moreton-in-Marsh  
Gloucestershire  
GL56 0LA

t: 01608 650 490  
f: 01608 651 863  
e: mail@tyackarchitects.com  
w: tyackarchitects.com

**Planning**  
**Existing Plan - Ground**  
36 New Street, Chipping Norton  
David Holdsworth

Scale: 1 : 100@A3 Date: July 2023  
Drawn/Checked: RO/ET Drg No: 3127-003

Rev: