

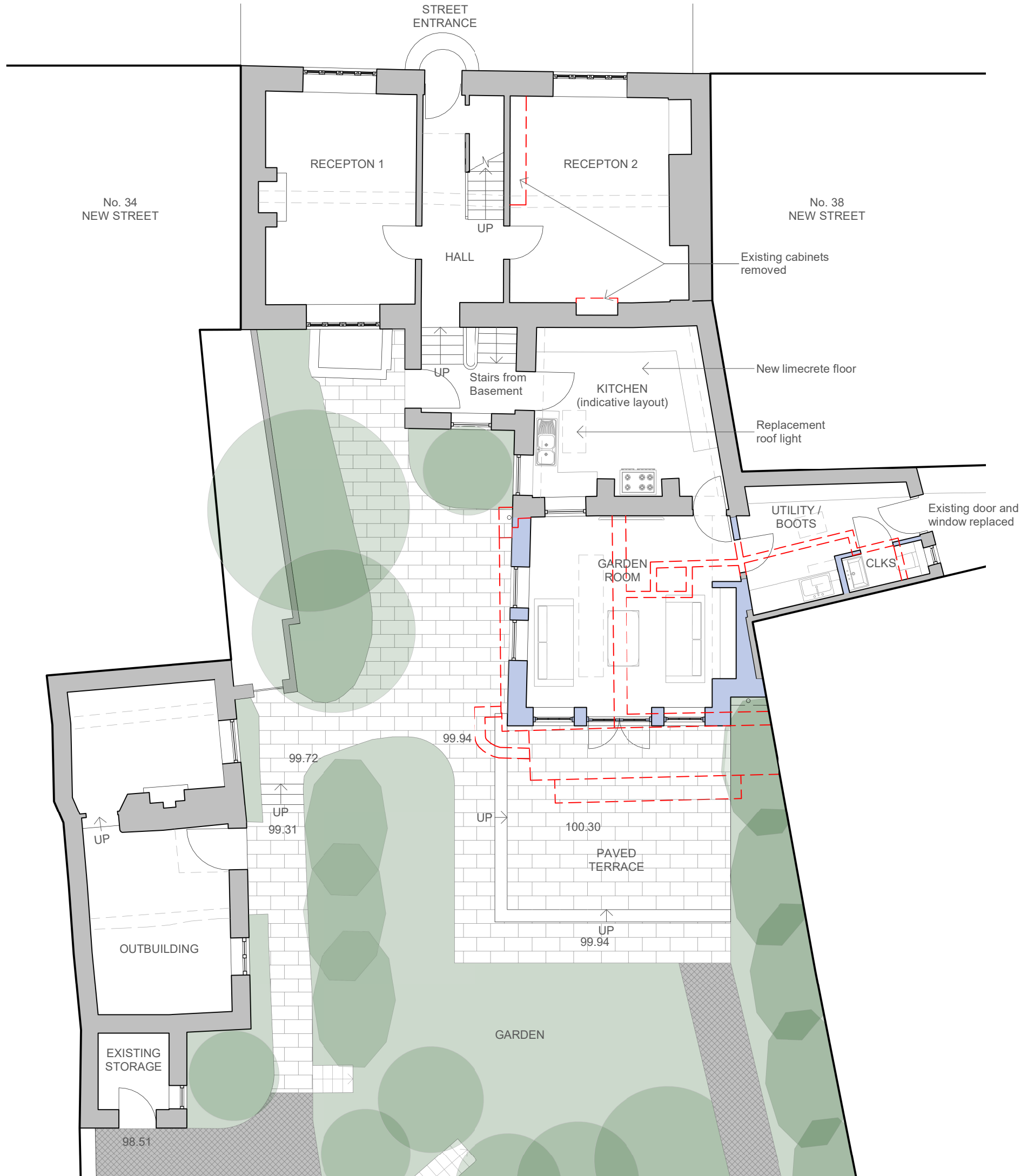

Planning

This drawing has been prepared for workstages up to planning application purposes only and is not intended "for construction". The 'scale bar' should only be used to check the drawing has been reproduced to the correct size. No responsibility can be accepted for errors made by others in "scaling" from this drawing.

Tyack Architects Ltd own copyright of the original design work in the drawings, documents and digital files which cannot be copied, loaned or disclosed without written agreement. Please refer to our Standard Terms of Business.



 Existing structure removed

 Yorkstone paving

 Gravel path

Scale 1:100  5m



Tyack Architects Ltd
The Mann Institute
Oxford Street
Moreton-in-Marsh
Gloucestershire
GL56 0LA

t: 01608 650 490
f: 01608 651 863
e: mail@tyackarchitects.com
w: tyackarchitects.com

Planning
Proposed Plan - Ground
36 New Street, Chipping Norton
David Holdsworth

Scale: 1 : 100@A3 Date: July 2023
Drawn/Checked: RO/ET Drg No: 3127-006

Rev: