

- 01 - Existing structure to barn to be retained.
- 02 - New polished concrete ground bearing floor with levels to match existing threshold.*
- 03 - New Timber Pod.
- 04 - New shallow steps/ramp with limestone tile finish to improve accessibility between existing cottage level and Threshing Barn. To be constructed in concrete.
- 05 - Existing thatch retained. New breathable plaster finish and paint to underside.*
- 06 - Internal faces of existing stone/cob external walls to be repaired as required and finished with a breathable insulating plaster and a breathable paint finish.

* Refer to dwg PL012 for details of new build-ups

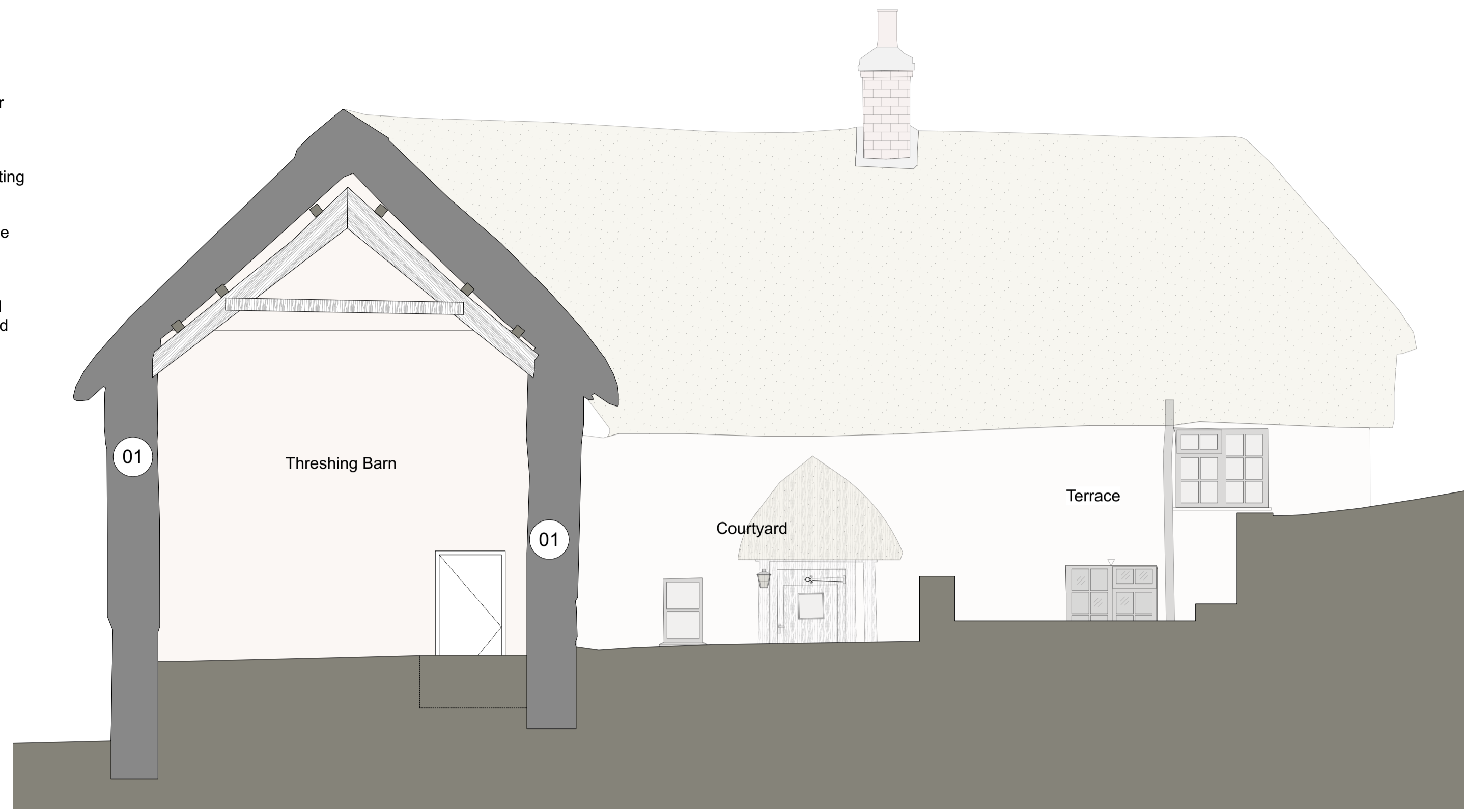

01. Existing Section CC

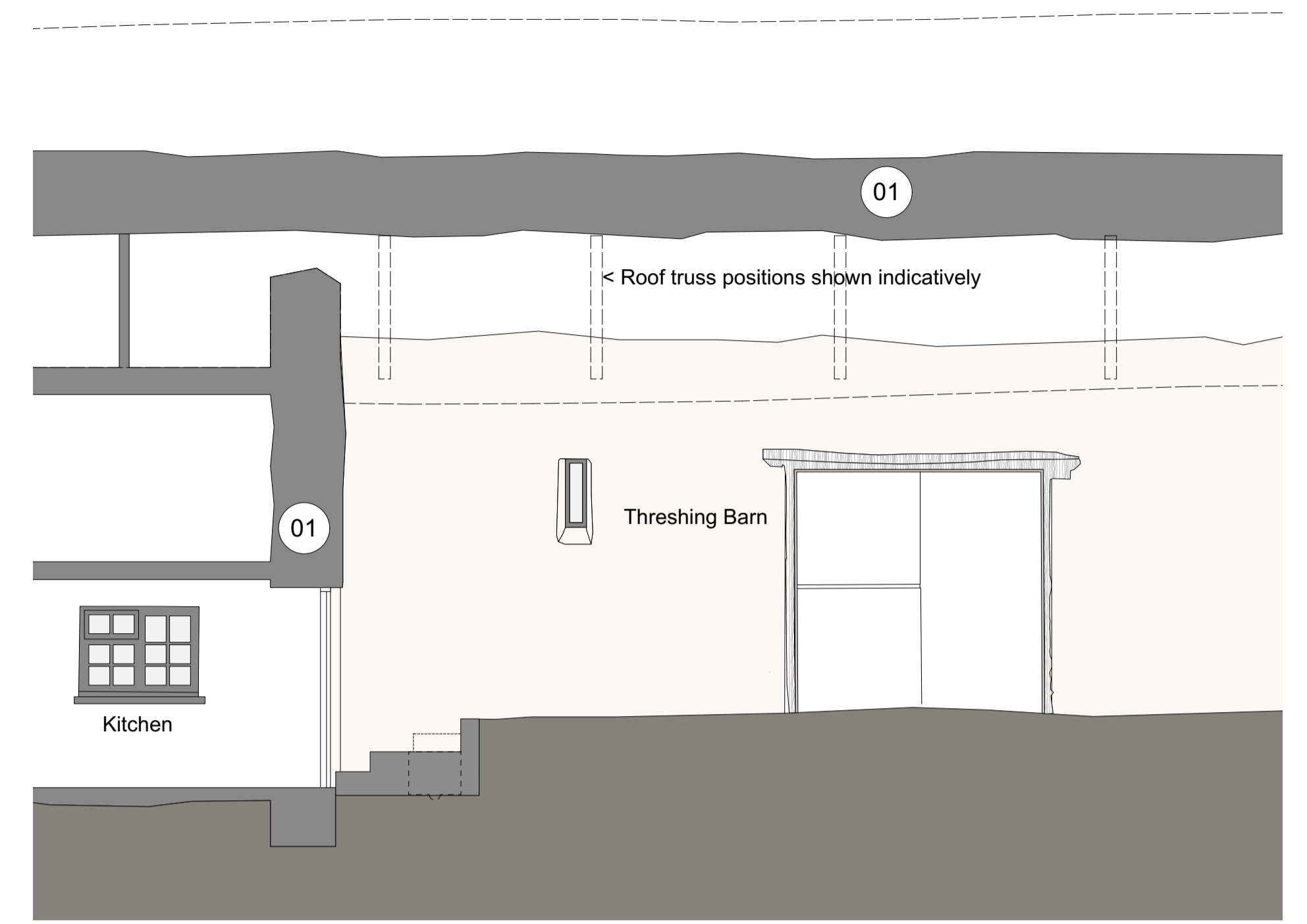

03. Existing Section DD

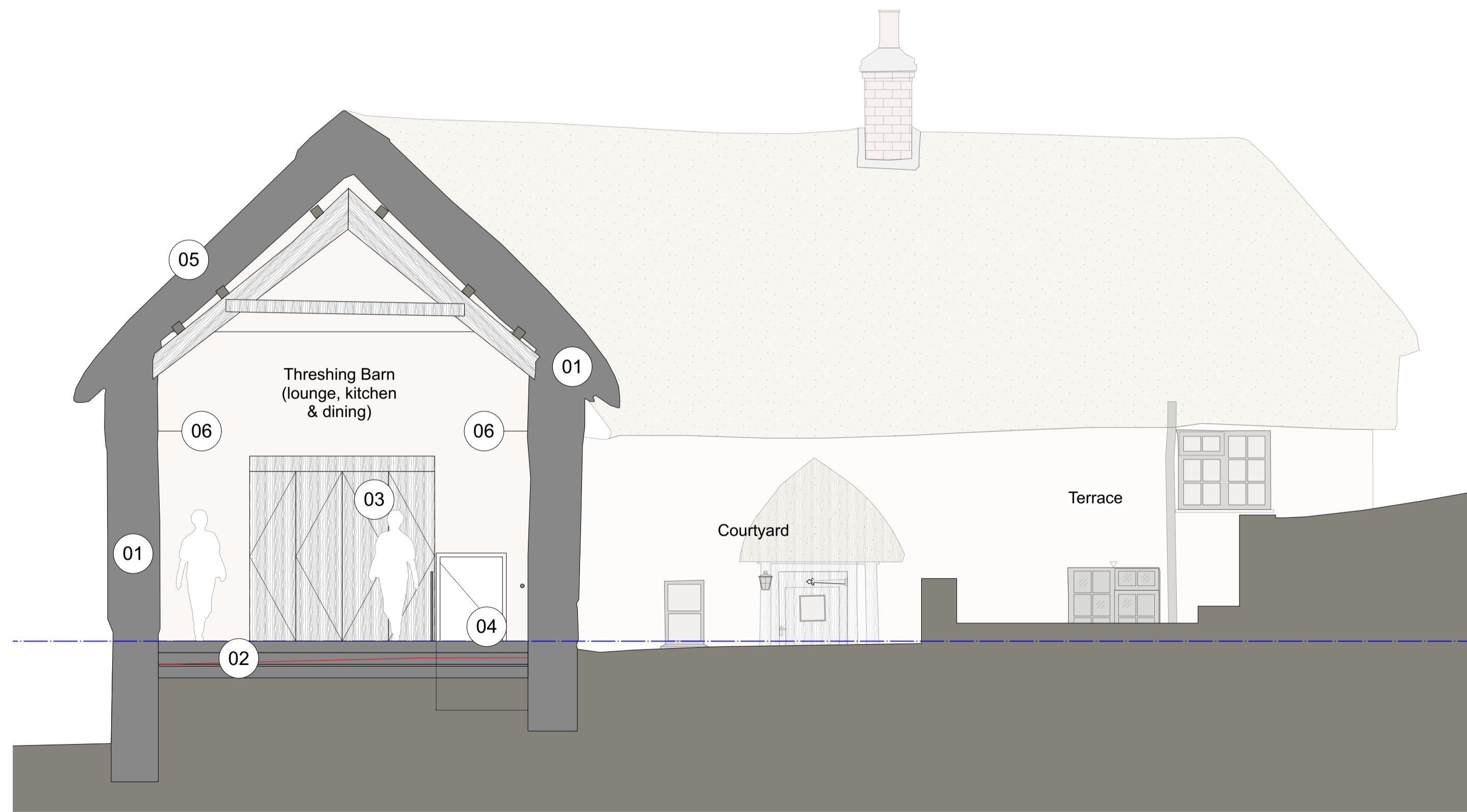

02. Proposed Section CC

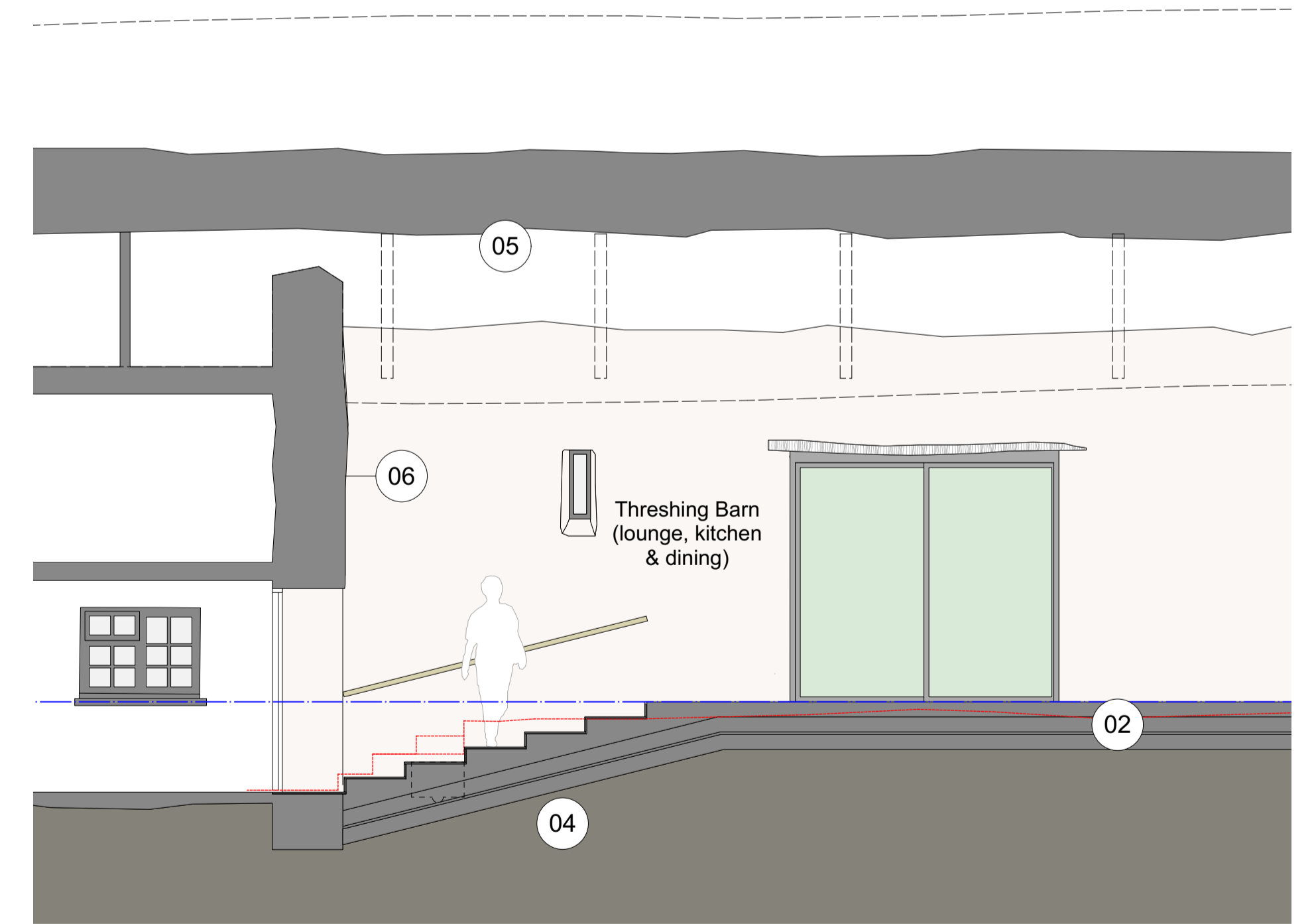

04. Proposed Section DD

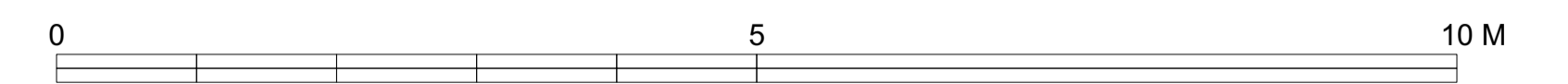

General Notes

...

Only figured dimensions are to be taken from this drawing. The contractor / installer must verify all dimensions on site before commencing any work or additional drawings. The contractor / installer must report any discrepancies to the Architect / Contract Administrator before commencing any further work. All drawings are to be read in conjunction with other Architects drawings and specifications for this project, and any S/Eng's drawings or specifications. All works are to be carried out in accordance and comply with the CDM Regulations 2015 and contractors health & safety method statement. All works to be constructed / installed in accordance with relevant UK Approved Building Regulations documents and British Standards. All materials, products, fixtures and fittings to be installed in accordance with manufacturers specifications and guidance. New British Design is the trading name of New British Design Ltd. Hare House, Sandford, Exeter, EX17 4ED.