





© Crown Copyright. All Rights Reserved. License Number 100022432.

## Sensitive Land Uses

### General

-  Specified Site
-  Specified Buffer(s)
-  Bearing Reference Point
-  Slice
-  Map ID

### Sensitive Land Uses

-  Ancient Woodland
-  Area of Adopted Green Belt
-  Area of Unadopted Green Belt
-  Area of Outstanding Natural Beauty
-  Environmentally Sensitive Area
-  Forest Park
-  Local Nature Reserve
-  Marine Nature Reserve
-  National Nature Reserve
-  National Park
-  Nitrate Sensitive Area
-  Nitrate Vulnerable Zone
-  Ramsar Site
-  Site of Special Scientific Interest
-  Special Area of Conservation
-  Special Protection Area
-  World Heritage Sites

### Site Sensitivity Context Map - Slice D

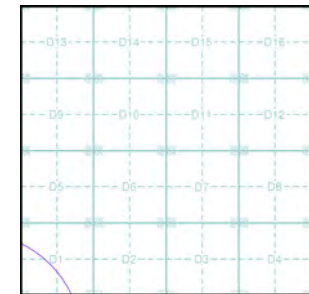

### Order Details

Order Number: 304894834\_1\_1  
 Customer Ref: STU5875  
 National Grid Reference: 570560, 266980  
 Slice: D  
 Site Area (Ha): 51.85  
 Search Buffer (m): 1000

### Site Details

Lanwades Hall, Newmarket, CB8 7UA

570000 570500 571000 571500 572000 572500 573000 573500

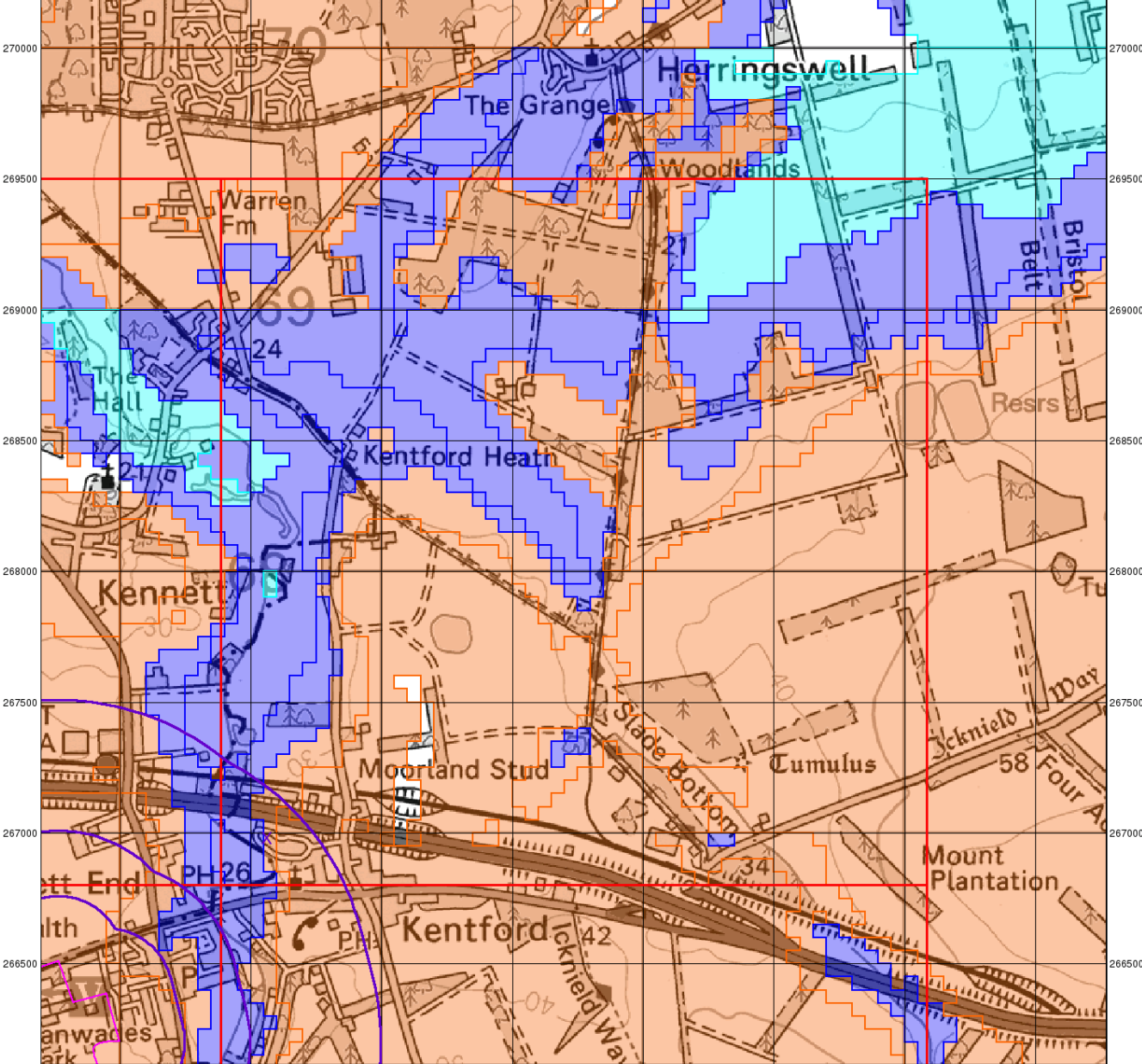

© Crown Copyright. All Rights Reserved. License Number 100022432

# soiltechnics

environmental • geotechnical • building fabric

## BGS Flood GFS Data

### General

- Specified Site
- Specified Buffer(s)
- Bearing Reference Point
- Slice

### Agency and Hydrological (Flood)

- Limited Potential for Groundwater Flooding to Occur
- Potential for Groundwater Flooding of Property Situated Below Ground Level
- Potential for Groundwater Flooding to Occur at Surface

## Site Sensitivity Context Map - Slice D

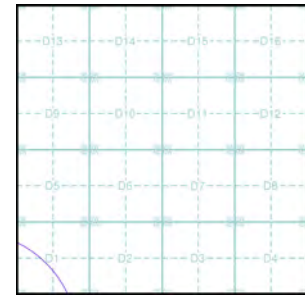

## Order Details

Order Number: 304894834\_1\_1  
 Customer Ref: STU5875  
 National Grid Reference: 570560, 266980  
 Slice: D  
 Site Area (Ha): 51.85  
 Search Buffer (m): 1000

## Site Details



Lanwades Hall, Newmarket, CB8 7UA



Tel: 0844 844 9952  
 Fax: 0844 844 9951  
 Web: www.envirocheck.co.uk







## Geology 1:50,000 Maps Legends

### Artificial Ground and Landslip

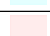
Map Colour	Lex Code	Rock Name	Rock Type	Min and Max Age
	WGR	Worked Ground (Undivided)	Void	Not Supplied - Holocene
	MGR	Made Ground (Undivided)	Artificial Deposit	Not Supplied - Holocene

Map Colour	Lex Code	Rock Name	Rock Type	Min and Max Age
	HNCK	Holywell Nodular Chalk Formation and New Pit Chalk Formation (Undifferentiated)	Chalk	Not Supplied - Cenomanian

### Superficial Geology

Map Colour	Lex Code	Rock Name	Rock Type	Min and Max Age
	ALV	Alluvium	Clay, Silt, Sand and Gravel	Not Supplied - Holocene
	LOFT	Lowestoft Formation	Clay and Silt	Not Supplied - Anglian
	LOFT	Lowestoft Formation	Diamicton	Not Supplied - Anglian
	CXSG	Croxton Sand and Gravel Member	Sand and Gravel	Not Supplied - Anglian
	HEAD	Head	Clay, Silt, Sand and Gravel	Not Supplied - Quaternary
	RTD2	River Terrace Deposits, 2	Sand and Gravel	Not Supplied - Quaternary
	RTD4	River Terrace Deposits, 4	Sand and Gravel	Not Supplied - Quaternary
	RTD3	River Terrace Deposits, 3	Sand and Gravel	Not Supplied - Quaternary
	T2T3	River Terrace Deposits, 2 to 3	Sand and Gravel	Not Supplied - Quaternary
	RTDU	River Terrace Deposits (Undifferentiated)	Sand and Gravel	Not Supplied - Quaternary
	RTD1	River Terrace Deposits, 1	Sand and Gravel	Not Supplied - Quaternary
	PEAT	Peat	Peat	Not Supplied - Quaternary

### Bedrock and Faults

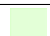
Map Colour	Lex Code	Rock Name	Rock Type	Min and Max Age
	CKR	Chalk Rock Member	Chalk	Not Supplied - Turonian
	LCCK	Lewes Nodular Chalk Formation, Seaford Chalk Formation, Newhaven Chalk Formation and Culver Chalk Formation (Undifferentiated)	Chalk	Not Supplied - Turonian

**soiltechnics**  
environmental • geotechnical • building fabric

### Geology 1:50,000 Maps

This report contains geological map extracts taken from the BGS Digital Geological map of Great Britain at 1:50,000 scale and is designed for users carrying out preliminary site assessments who require geological maps for the area around the site. This mapping may be more up to date than previously published paper maps.

The various geological layers - artificial and landslip deposits, superficial geology and solid (bedrock) geology are displayed in separate maps, but superimposed on the final 'Combined Surface Geology' map. All map legends feature on this page. Not all layers have complete nationwide coverage, so availability of data for relevant map sheets is indicated below.

### Geology 1:50,000 Maps Coverage

Map ID: 1  
Map Sheet No: 189  
Map Name: Bury St Edmund  
Map Date: 1982  
Bedrock Geology: Available  
Superficial Geology: Available  
Artificial Geology: Available  
Faults: Not Supplied  
Landslip: Not Available  
Rock Segments: Not Supplied

### Geology 1:50,000 Maps - Slice D

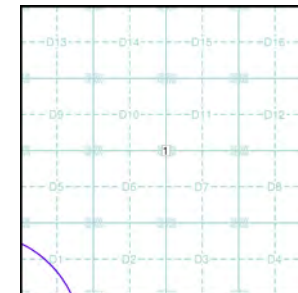

### Order Details:

Order Number: 304894834\_1\_1  
Customer Reference: STU5875  
National Grid Reference: 570560, 266980  
Slice: D  
Site Area (Ha): 51.85  
Search Buffer (m): 1000

### Site Details:

Lanwades Hall, Newmarket, CB8 7UA

**Landmark**  
INFORMATION GROUP

Tel: 0844 844 9952  
Fax: 0844 844 9951  
Web: www.envirocheck.co.uk

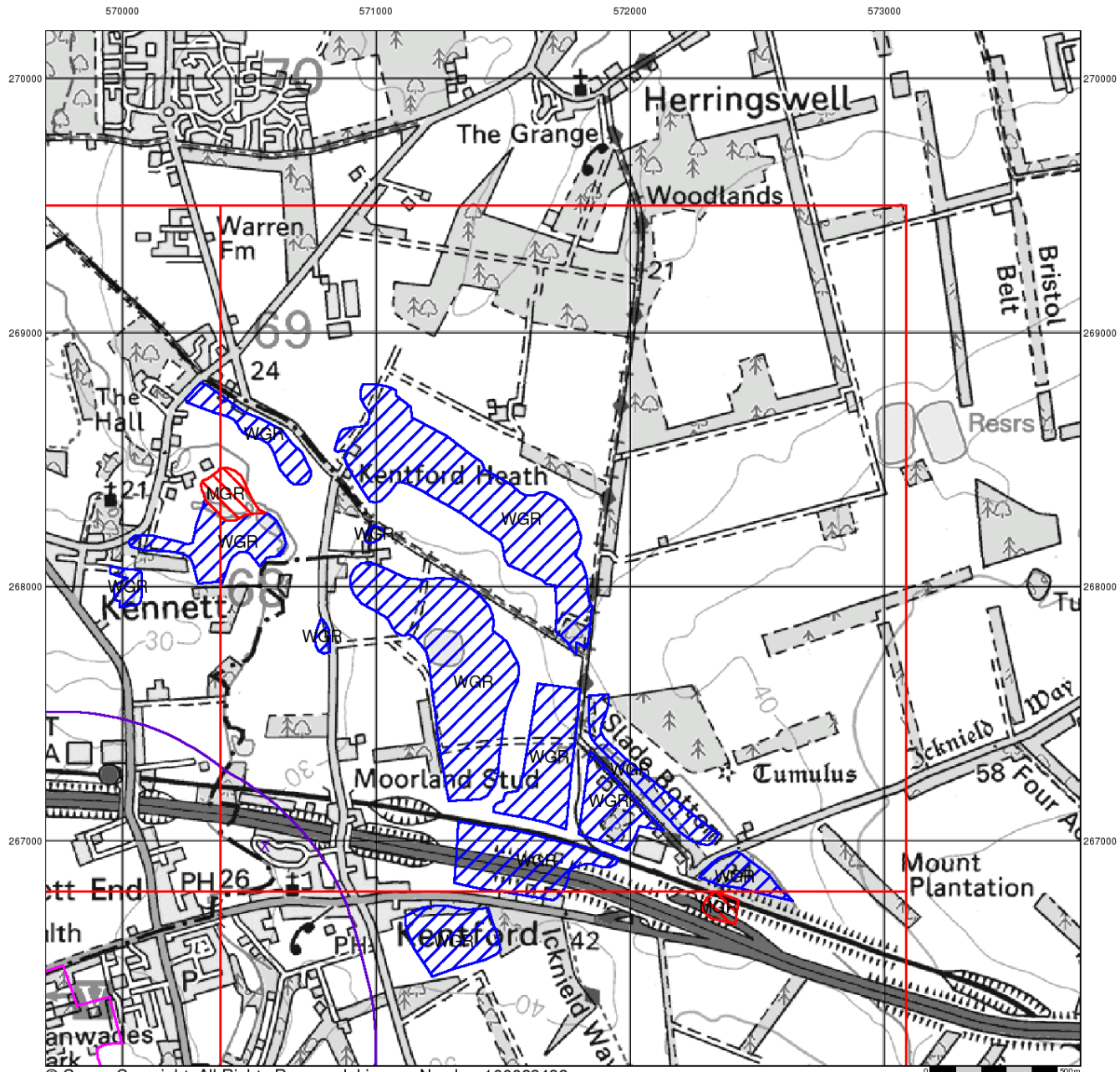

© Crown Copyright. All Rights Reserved. License Number 100022432.

# soiltechnics

environmental • geotechnical • building fabric

## Artificial Ground and Landslip

Artificial ground is a term used by BGS for those areas where the ground surface has been significantly modified by human activity. Information about previously developed ground is especially important, as it is often associated with potentially contaminated material, unpredictable engineering conditions and unstable ground.

Artificial ground includes:

- Made ground - man-made deposits such as embankments and spoil heaps on the natural ground surface.
- Worked ground - areas where the ground has been cut away such as quarries and road cuttings.
- Infilled ground - areas where the ground has been cut away then wholly or partially backfilled.
- Landscaped ground - areas where the surface has been reshaped.
- Disturbed ground - areas of ill-defined shallow or near surface mineral workings where it is impracticable to map made and worked ground separately.

Mass movement (landslip) deposits on BGS geological maps are primarily superficial deposits that have moved down slope under gravity to form landslips. These affect bedrock, other superficial deposits and artificial ground. The dataset also includes foundered strata, where the ground has collapsed due to subsidence.

## Artificial Ground and Landslip Map - Slice D

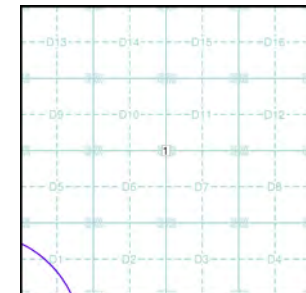

### Order Details:

Order Number: 304894834\_1\_1  
 Customer Reference: STU5875  
 National Grid Reference: 570560, 266980  
 Slice: D  
 Site Area (Ha): 51.85  
 Search Buffer (m): 1000

### Site Details:

Lanwades Hall, Newmarket, CB8 7UA

**Landmark**  
 INFORMATION GROUP

Tel: 0844 844 9952  
 Fax: 0844 844 9951  
 Web: www.envirocheck.co.uk

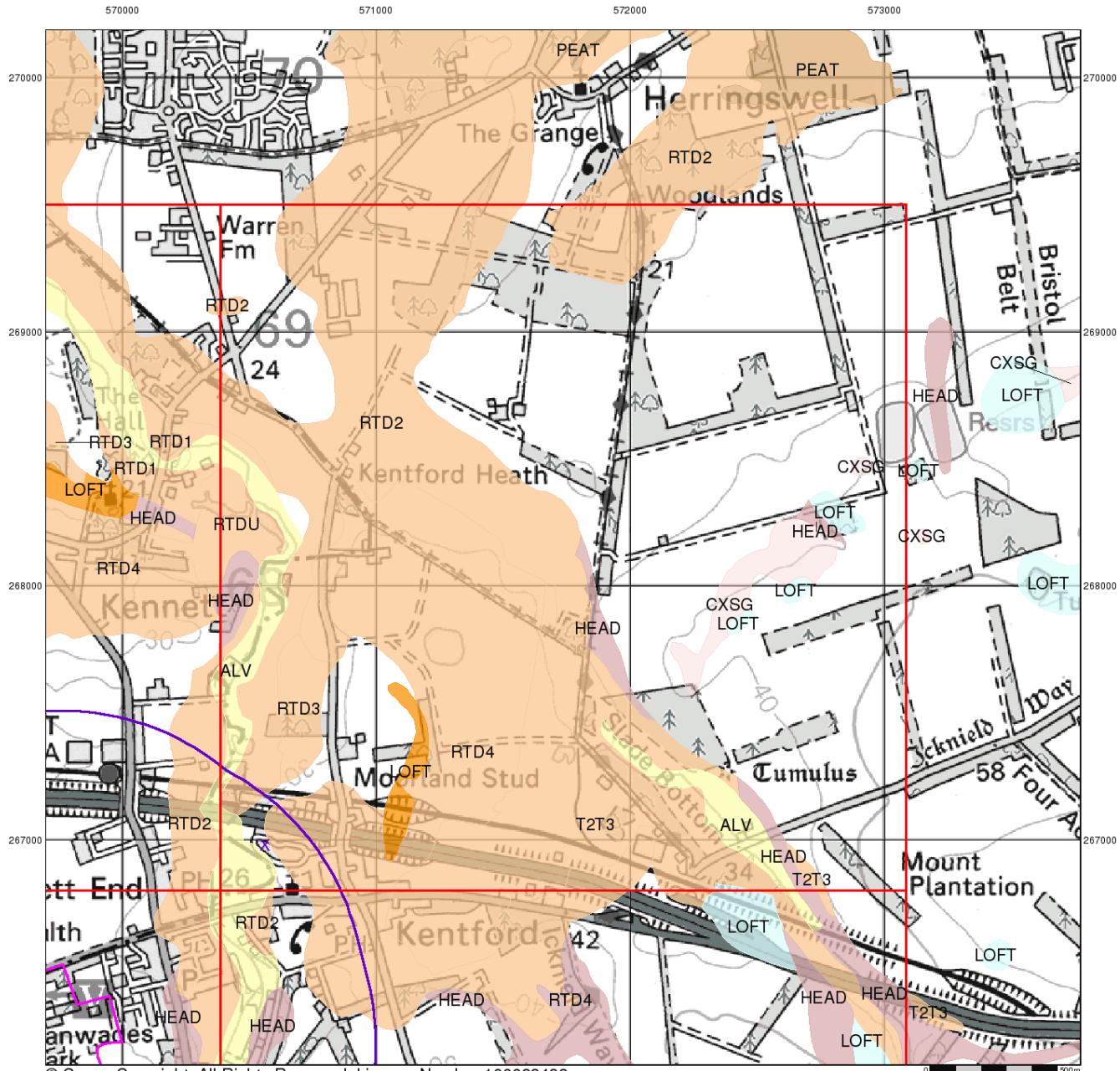

© Crown Copyright. All Rights Reserved. License Number 100022432.

# soiltechnics

environmental • geotechnical • building fabric

## Superficial Geology

Superficial Deposits are the youngest geological deposits formed during the most recent period of geological time, the Quaternary, which extends back about 1.8 million years from the present.

They rest on older deposits or rocks referred to as Bedrock. This dataset contains Superficial deposits that are of natural origin and 'in place'. Other superficial strata may be held in the Mass Movement dataset where they have been moved, or in the Artificial Ground dataset where they are of man-made origin.

Most of these Superficial deposits are unconsolidated sediments such as gravel, sand, silt and clay, and onshore they form relatively thin, often discontinuous patches or larger spreads.

## Superficial Geology Map - Slice D

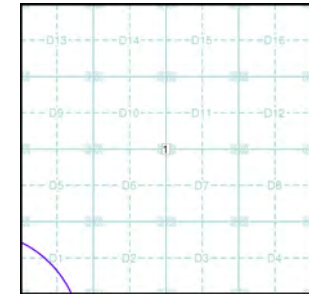

### Order Details:

Order Number: 304894834\_1\_1  
 Customer Reference: STU5875  
 National Grid Reference: 570560, 266980  
 Slice: D  
 Site Area (Ha): 51.85  
 Search Buffer (m): 1000

### Site Details:

Lanwades Hall, Newmarket, CB8 7UA



Tel: 0844 844 9952  
 Fax: 0844 844 9951  
 Web: www.envirocheck.co.uk

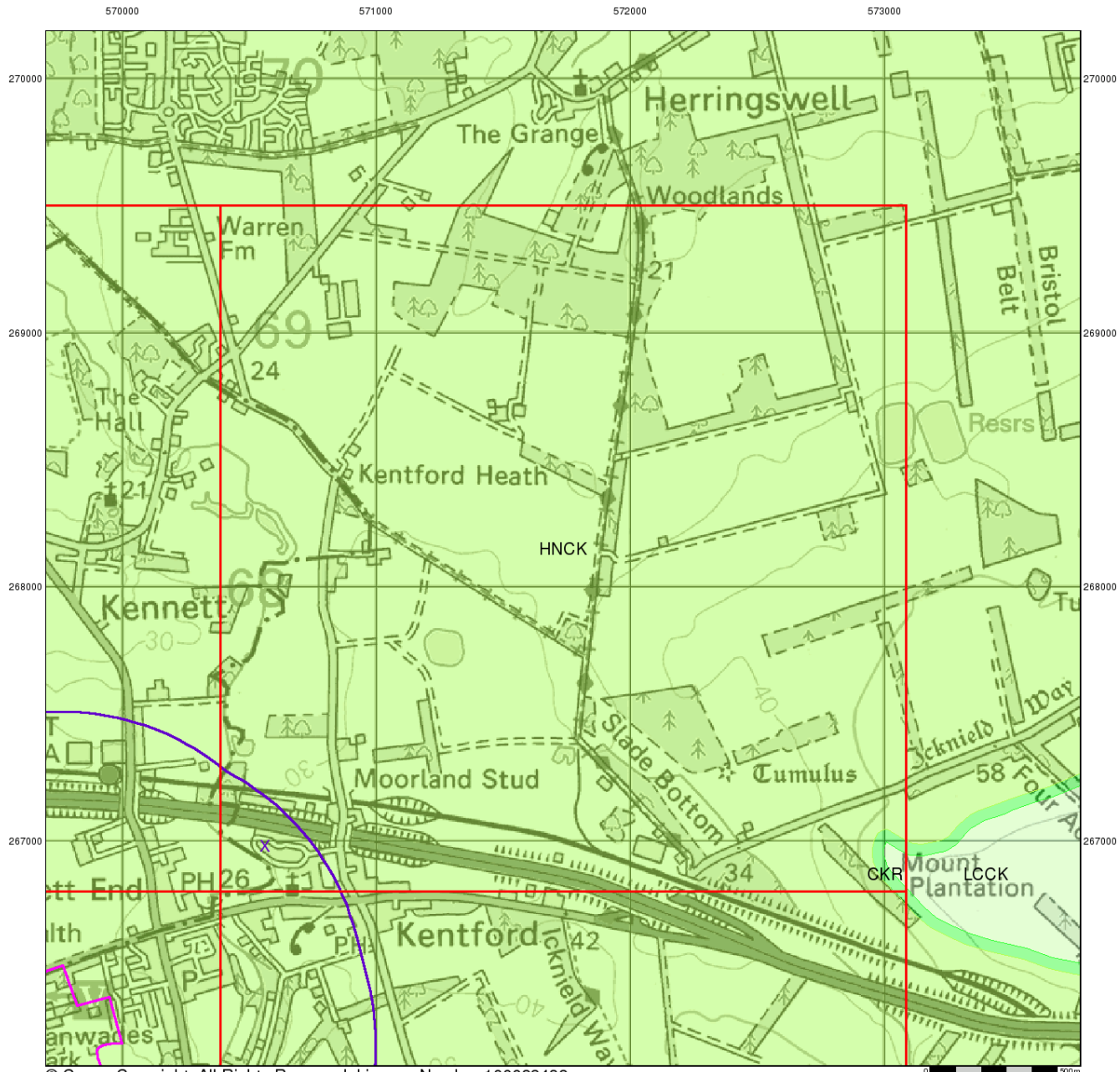

© Crown Copyright. All Rights Reserved. License Number 100022432.

# soiltechnics

environmental • geotechnical • building fabric

## Bedrock and Faults

Bedrock geology is a term used for the main mass of rocks forming the Earth and are present everywhere, whether exposed at the surface in outcrops or concealed beneath superficial deposits or water.

The bedrock has formed over vast lengths of geological time ranging from ancient and highly altered rocks of the Proterozoic, some 2500 million years ago, or older, up to the relatively young Pliocene, 1.8 million years ago.

The bedrock geology includes many lithologies, often classified into three types based on origin: igneous, metamorphic and sedimentary.

The BGS Faults and Rock Segments dataset includes geological faults (e.g. normal, thrust), and thin beds mapped as lines (e.g. coal seam, gypsum bed). Some of these are linked to other particular 1:50,000 Geology datasets, for example, coal seams are part of the bedrock sequence, most faults and mineral veins primarily affect the bedrock but cut across the strata and post date its deposition.

## Bedrock and Faults Map - Slice D

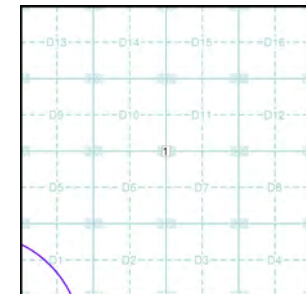

### Order Details:

Order Number: 304894834\_1\_1  
 Customer Reference: STU5875  
 National Grid Reference: 570560, 266980  
 Slice: D  
 Site Area (Ha): 51.85  
 Search Buffer (m): 1000

### Site Details:

Lanwades Hall, Newmarket, CB8 7UA



Tel: 0844 844 9952  
 Fax: 0844 844 9951  
 Web: www.envirocheck.co.uk

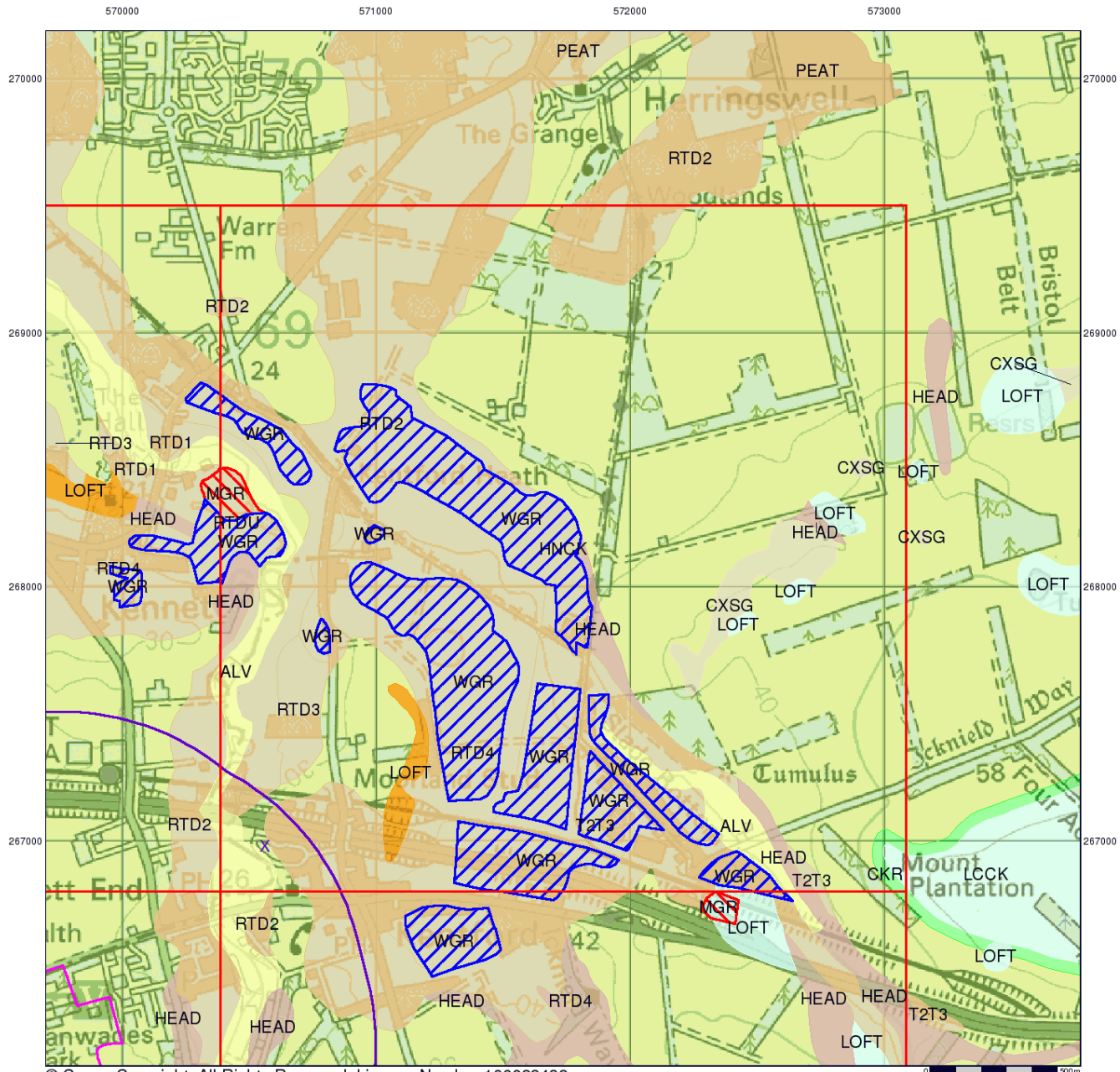

© Crown Copyright. All Rights Reserved. License Number 100022432.

# soiltechnics

environmental • geotechnical • building fabric

## Combined Surface Geology

The Combined Surface Geology map combines all the previous maps into one combined geological overview of your site.

Please consult the legends to the previous maps to interpret the Combined "Surface Geology" map.

## Additional Information

More information on 1:50,000 Geological mapping and explanations of rock classifications can be found on the BGS website. Using the LEX Codes in this report, further descriptions of rock types can be obtained by interrogating the 'BGS Lexicon of Named Rock Units'. This database can be accessed by following the 'Information and Data' link on the BGS website.

## Contact

British Geological Survey  
 Kingsley Dunham Centre  
 Keyworth  
 Nottingham  
 NG12 5GG  
 Telephone: 0115 936 3143  
 Fax: 0115 936 3276  
 email: enquiries@bgs.ac.uk  
 website: www.bgs.ac.uk

## Combined Geology Map - Slice D

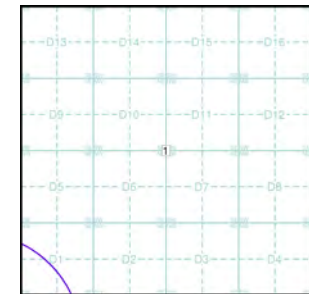

## Order Details:

Order Number: 304894834\_1\_1  
 Customer Reference: STU5875  
 National Grid Reference: 570560, 266980  
 Slice: D  
 Site Area (Ha): 51.85  
 Search Buffer (m): 1000

## Site Details:

Lanwades Hall, Newmarket, CB8 7UA



Tel: 0844 844 9952  
 Fax: 0844 844 9951  
 Web: www.envirocheck.co.uk

# Historical Mapping Legends

## Ordnance Survey County Series 1:10,560

- Gravel Pit
- Sand Pit
- Other Pits
- Quarry
- Shingle
- Orchard
- Osiers
- Reeds
- Marsh
- Mixed Wood
- Deciduous
- Brushwood
- Fir
- Furze
- Rough Pasture
- Arrow denotes flow of water
- Trigonometrical Station
- Site of Antiquities
- Bench Mark
- Pump, Guide Post, Signal Post
- Well, Spring, Boundary Post
- 285** Surface Level
- Sketched Contour
- Instrumental Contour
- Main Roads
- Minor Roads
- Sunken Road
- Raised Road
- Road over Railway
- Railway over River
- Railway over Road
- Level Crossing
- Road over River or Canal
- Road over Stream
- Road over Stream
- County Boundary (Geographical)
- County & Civil Parish Boundary
- Administrative County & Civil Parish Boundary
- Co. Boro. Bdy. County Borough Boundary (England)
- Co. Burgh Bdy. County Burgh Boundary (Scotland)
- R.D. Bdy. Rural District Boundary
- Civil Parish Boundary

## Ordnance Survey Plan 1:10,000

- Chalk Pit, Clay Pit or Quarry
- Gravel Pit
- Sand Pit
- Disused Pit or Quarry
- Refuse or Slag Heap
- Lake, Loch or Pond
- Dunes
- Boulders
- Coniferous Trees
- Non-Coniferous Trees
- Orchard
- Scrub
- Coppice
- Bracken
- Heath
- Rough Grassland
- Marsh
- Reeds
- Saltings
- Building
- Glasshouse
- Sloping Masonry
- Pylon
- Electricity Transmission Line
- Pole
- Cutting
- Embankment
- Standard Gauge Multiple Track
- Standard Gauge Single Track
- Siding, Tramway or Mineral Line
- Narrow Gauge
- Geographical County
- Administrative County, County Borough or County of City
- Municipal Borough, Urban or Rural District, Burgh or District Council
- Borough, Burgh or County Constituency
- Civil Parish
- BP, BS Boundary Post or Stone
- Ch Church
- CH Club House
- F E Sta Fire Engine Station
- FB Foot Bridge
- Fn Fountain
- GP Guide Post
- MP Mile Post
- MS Mile Stone
- Pol Sta Police Station
- PO Post Office
- PC Public Convenience
- PH Public House
- SB Signal Box
- Spr Spring
- TCB Telephone Call Box
- TCP Telephone Call Post
- W Well

## 1:10,000 Raster Mapping

- Gravel Pit
- Rock
- Boulders
- Shingle
- Sand
- Slopes
- General detail
- Overhead detail
- Multi-track railway
- County boundary (England only)
- District, Unitary, Metropolitan, London Borough boundary
- Area of wooded vegetation
- Non-coniferous trees (scattered)
- Coniferous trees (scattered)
- Orchard
- Rough Grassland
- Scrub
- Water feature
- MHW(S) Mean high water (springs)
- BM 123.45 m Bench mark (where shown)
- Point feature (e.g. Guide Post or Mile Stone)
- Site of (antiquity)
- General Building
- Refuse tip or slag heap
- Rock (scattered)
- Boulders (scattered)
- Mud
- Sand Pit
- Top of cliff
- Underground detail
- Narrow gauge railway
- Single track railway
- Civil, parish or community boundary
- Constituency boundary
- Non-coniferous trees
- Coniferous trees
- Positioned tree
- Coppice or Osiers
- Heath
- Marsh, Salt Marsh or Reeds
- Flow arrows
- MLW(S) Mean low water (springs)
- Triangulation station
- Electricity transmission line (with poles)
- Pylon, flare stack or lighting tower
- Glasshouse
- Important Building

### Historical Mapping & Photography included:

Mapping Type	Scale	Date	Pg
Suffolk	1:10,560	1884	2
Cambridgeshire & Isle Of Ely	1:10,560	1903	3
Cambridgeshire & Isle Of Ely	1:10,560	1952	4
Ordnance Survey Plan	1:10,000	1958	5
Ordnance Survey Plan	1:10,000	1983	6
10K Raster Mapping	1:10,000	2000	7
10K Raster Mapping	1:10,000	2006	8
VectorMap Local	1:10,000	2022	9

### Historical Map - Slice D

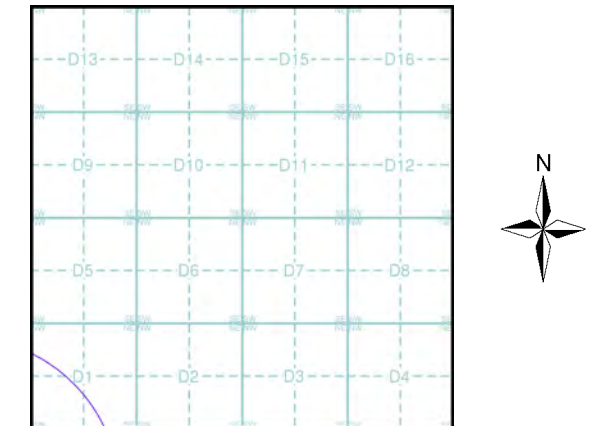

### Order Details

Order Number: 304894834\_1\_1  
 Customer Ref: STU5875  
 National Grid Reference: 570560, 266980  
 Slice: D  
 Site Area (Ha): 51.85  
 Search Buffer (m): 1000

### Site Details

Lanwades Hall, Newmarket, CB8 7UA



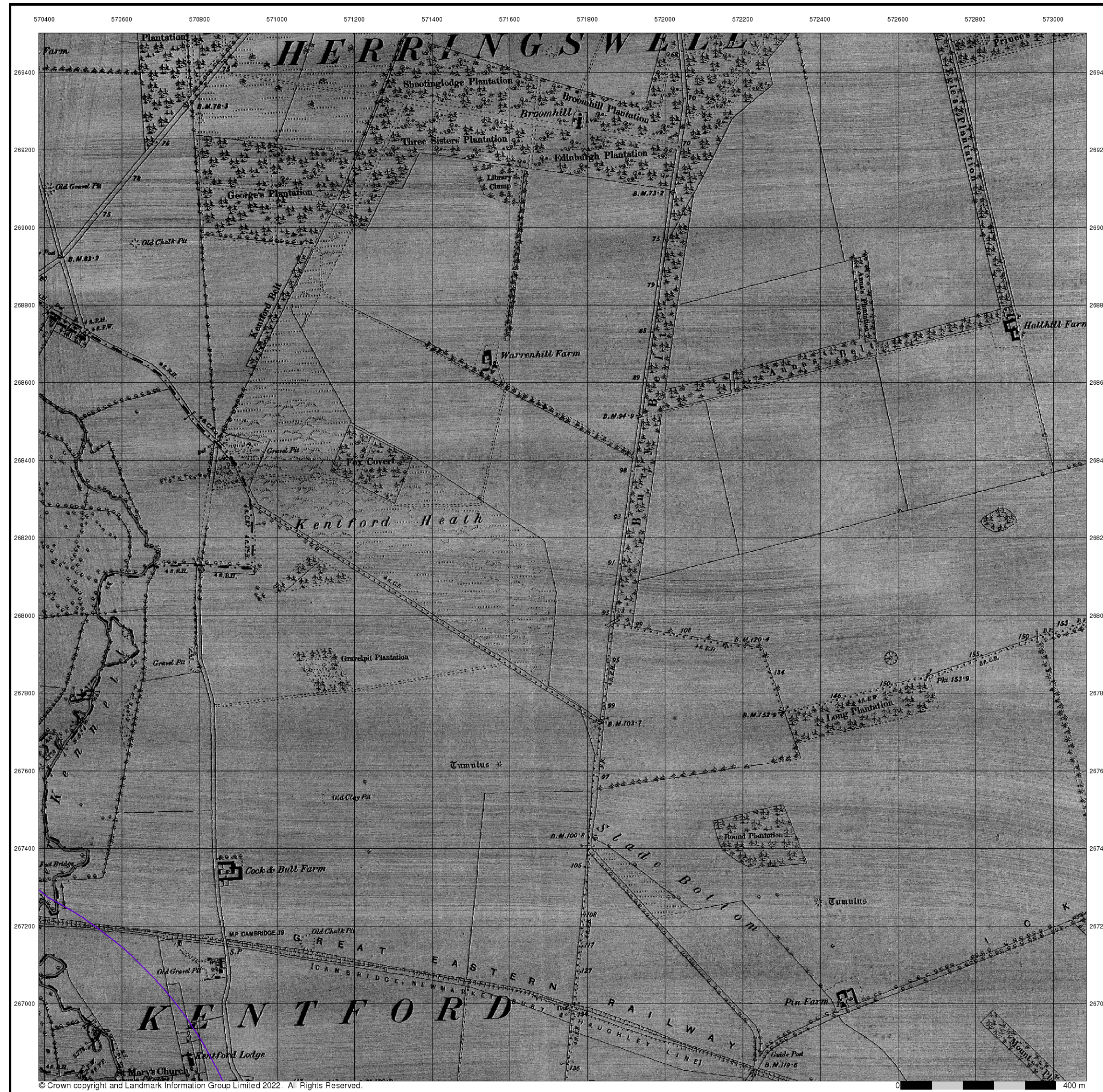

**Suffolk**  
**Published 1884**  
**Source map scale - 1:10,560**

The historical maps shown were reproduced from maps predominantly held at the scale adopted for England, Wales and Scotland in the 1840's. In 1854 the 1:2,500 scale was adopted for mapping urban areas; these maps were used to update the 1:10,560 maps. The published date given therefore is often some years later than the surveyed date. Before 1938, all OS maps were based on the Cassini Projection, with independent surveys of a single county or group of counties, giving rise to significant inaccuracies in outlying areas. In the late 1940's, a Provisional Edition was produced, which updated the 1:10,560 mapping from a number of sources. The maps appear unfinished - with all military camps and other strategic sites removed. These maps were initially overprinted with the National Grid. In 1970, the first 1:10,000 maps were produced using the Transverse Mercator Projection. The revision process continued until recently, with new editions appearing every 10 years or so for urban areas.

**Map Name(s) and Date(s)**

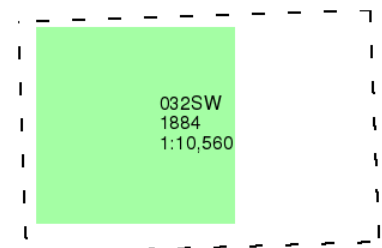

**Historical Map - Slice D**

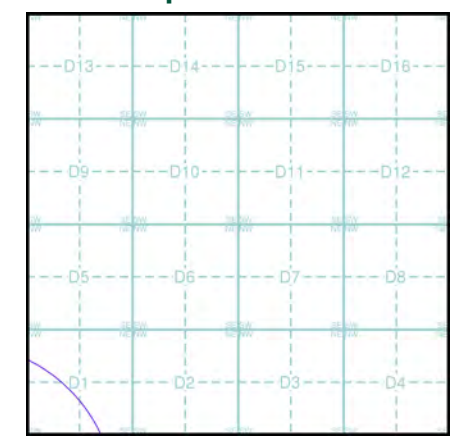

**Order Details**  
 Order Number: 304894834\_1\_1  
 Customer Ref: STU5875  
 National Grid Reference: 570560, 266980  
 Slice: D  
 Site Area (Ha): 51.85  
 Search Buffer (m): 1000

**Site Details**  
 Lanwades Hall, Newmarket, CB8 7UA

© Crown copyright and Landmark Information Group Limited 2022. All Rights Reserved.

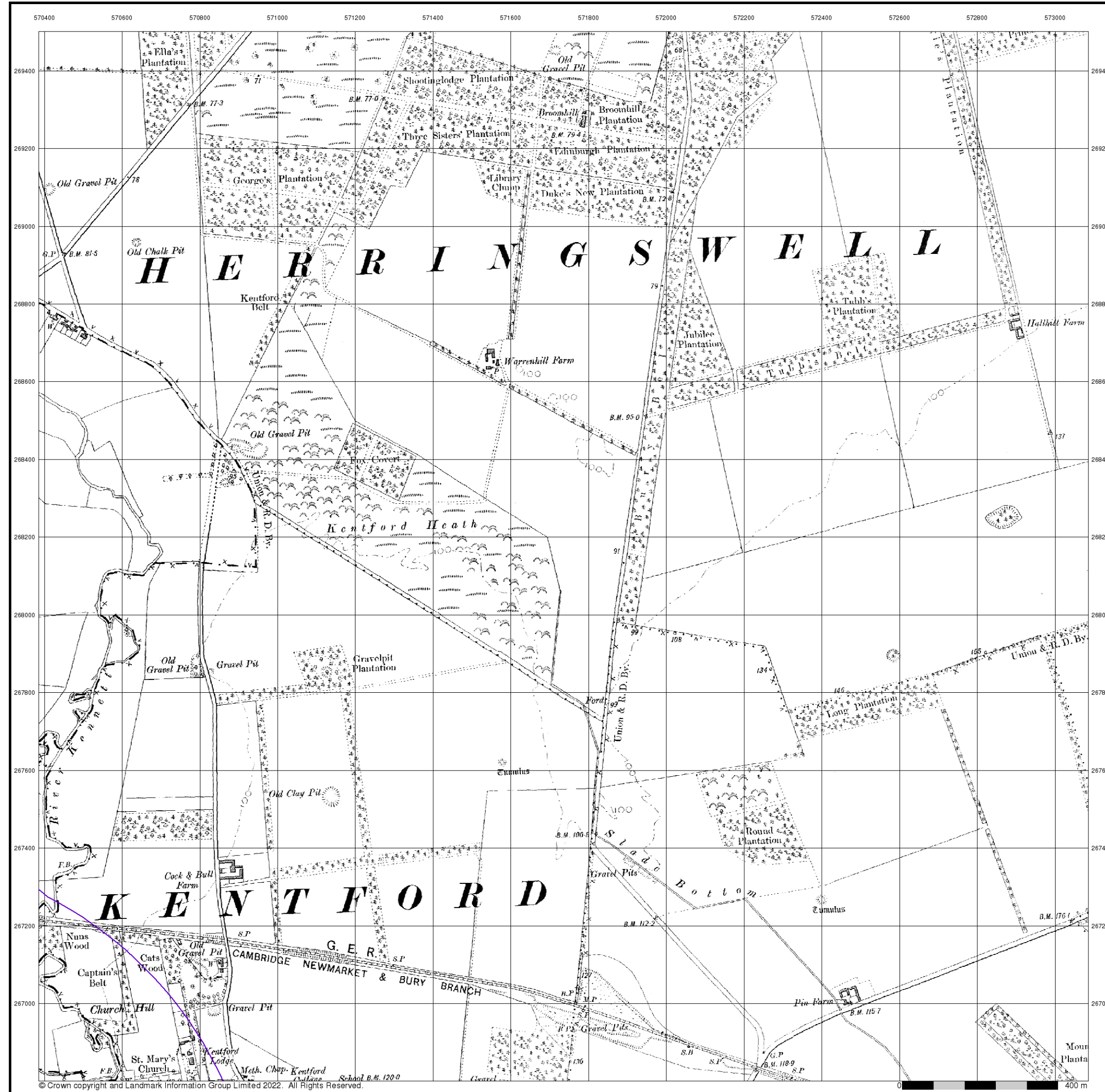

**Cambridgeshire & Isle Of Ely**

**Published 1903**

**Source map scale - 1:10,560**

The historical maps shown were reproduced from maps predominantly held at the scale adopted for England, Wales and Scotland in the 1840's. In 1854 the 1:2,500 scale was adopted for mapping urban areas; these maps were used to update the 1:10,560 maps. The published date given therefore is often some years later than the surveyed date. Before 1938, all OS maps were based on the Cassini Projection, with independent surveys of a single county or group of counties, giving rise to significant inaccuracies in outlying areas. In the late 1940's, a Provisional Edition was produced, which updated the 1:10,560 mapping from a number of sources. The maps appear unfinished - with all military camps and other strategic sites removed. These maps were initially overprinted with the National Grid. In 1970, the first 1:10,000 maps were produced using the Transverse Mercator Projection. The revision process continued until recently, with new editions appearing every 10 years or so for urban areas.

**Map Name(s) and Date(s)**

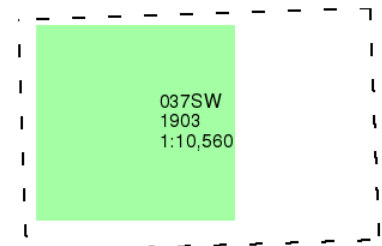

**Historical Map - Slice D**

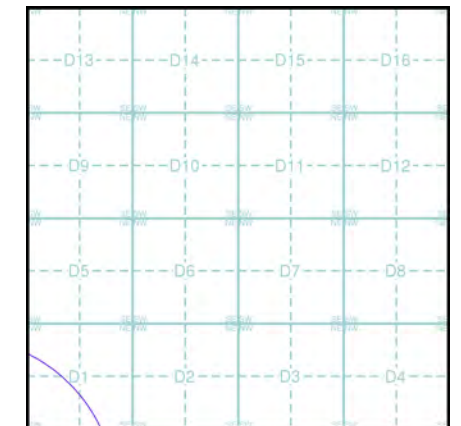

**Order Details**

Order Number: 304894834\_1\_1  
Customer Ref: STU5875  
National Grid Reference: 570560, 266980  
Slice: D  
Site Area (Ha): 51.85  
Search Buffer (m): 1000

**Site Details**

Lanwades Hall, Newmarket, CB8 7UA



**Cambridgeshire & Isle Of Ely**  
**Published 1952**  
**Source map scale - 1:10,560**

The historical maps shown were reproduced from maps predominantly held at the scale adopted for England, Wales and Scotland in the 1840's. In 1854 the 1:2,500 scale was adopted for mapping urban areas; these maps were used to update the 1:10,560 maps. The published date given therefore is often some years later than the surveyed date. Before 1938, all OS maps were based on the Cassini Projection, with independent surveys of a single county or group of counties, giving rise to significant inaccuracies in outlying areas. In the late 1940's, a Provisional Edition was produced, which updated the 1:10,560 mapping from a number of sources. The maps appear unfinished - with all military camps and other strategic sites removed. These maps were initially overprinted with the National Grid. In 1970, the first 1:10,000 maps were produced using the Transverse Mercator Projection. The revision process continued until recently, with new editions appearing every 10 years or so for urban areas.

**Map Name(s) and Date(s)**

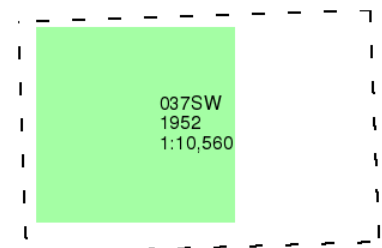

**Historical Map - Slice D**

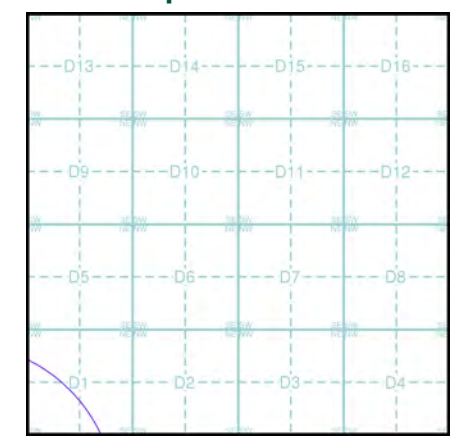

**Order Details**

Order Number: 304894834\_1\_1  
 Customer Ref: STU5875  
 National Grid Reference: 570560, 266980  
 Slice: D  
 Site Area (Ha): 51.85  
 Search Buffer (m): 1000

**Site Details**

Lanwades Hall, Newmarket, CB8 7UA



**Ordnance Survey Plan**  
**Published 1958**  
**Source map scale - 1:10,000**

The historical maps shown were reproduced from maps predominantly held at the scale adopted for England, Wales and Scotland in the 1840's. In 1854 the 1:2,500 scale was adopted for mapping urban areas; these maps were used to update the 1:10,560 maps. The published date given therefore is often some years later than the surveyed date. Before 1938, all OS maps were based on the Cassini Projection, with independent surveys of a single county or group of counties, giving rise to significant inaccuracies in outlying areas. In the late 1940's, a Provisional Edition was produced, which updated the 1:10,560 mapping from a number of sources. The maps appear unfinished - with all military camps and other strategic sites removed. These maps were initially overprinted with the National Grid. In 1970, the first 1:10,000 maps were produced using the Transverse Mercator Projection. The revision process continued until recently, with new editions appearing every 10 years or so for urban areas.

**Map Name(s) and Date(s)**

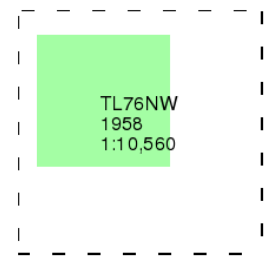

**Historical Map - Slice D**

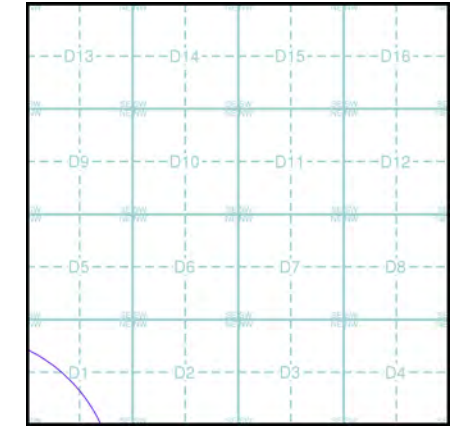

**Order Details**

Order Number: 304894834\_1\_1  
 Customer Ref: STU5875  
 National Grid Reference: 570560, 266980  
 Slice: D  
 Site Area (Ha): 51.85  
 Search Buffer (m): 1000

**Site Details**

Lanwades Hall, Newmarket, CB8 7UA

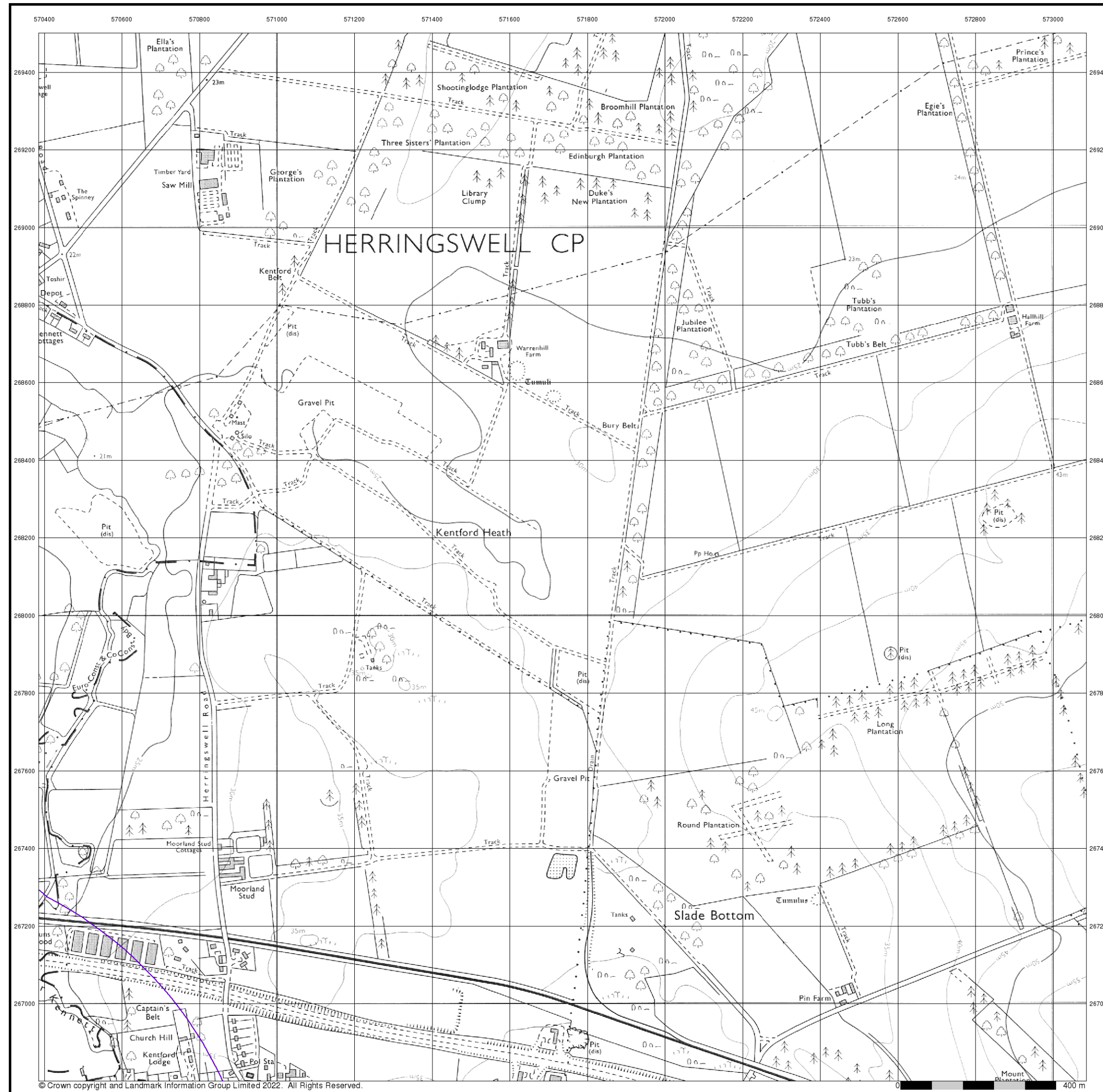

**Ordnance Survey Plan**  
**Published 1983**  
**Source map scale - 1:10,000**

The historical maps shown were reproduced from maps predominantly held at the scale adopted for England, Wales and Scotland in the 1840's. In 1854 the 1:2,500 scale was adopted for mapping urban areas; these maps were used to update the 1:10,560 maps. The published date given therefore is often some years later than the surveyed date. Before 1938, all OS maps were based on the Cassini Projection, with independent surveys of a single county or group of counties, giving rise to significant inaccuracies in outlying areas. In the late 1940's, a Provisional Edition was produced, which updated the 1:10,560 mapping from a number of sources. The maps appear unfinished - with all military camps and other strategic sites removed. These maps were initially overprinted with the National Grid. In 1970, the first 1:10,000 maps were produced using the Transverse Mercator Projection. The revision process continued until recently, with new editions appearing every 10 years or so for urban areas.

**Map Name(s) and Date(s)**

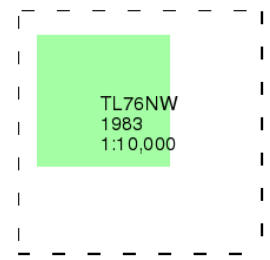

**Historical Map - Slice D**

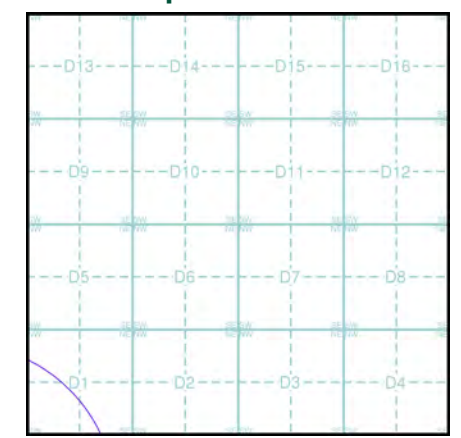

**Order Details**  
 Order Number: 304894834\_1\_1  
 Customer Ref: STU5875  
 National Grid Reference: 570560, 266980  
 Slice: D  
 Site Area (Ha): 51.85  
 Search Buffer (m): 1000

**Site Details**  
 Lanwades Hall, Newmarket, CB8 7UA

© Crown copyright and Landmark Information Group Limited 2022. All Rights Reserved.

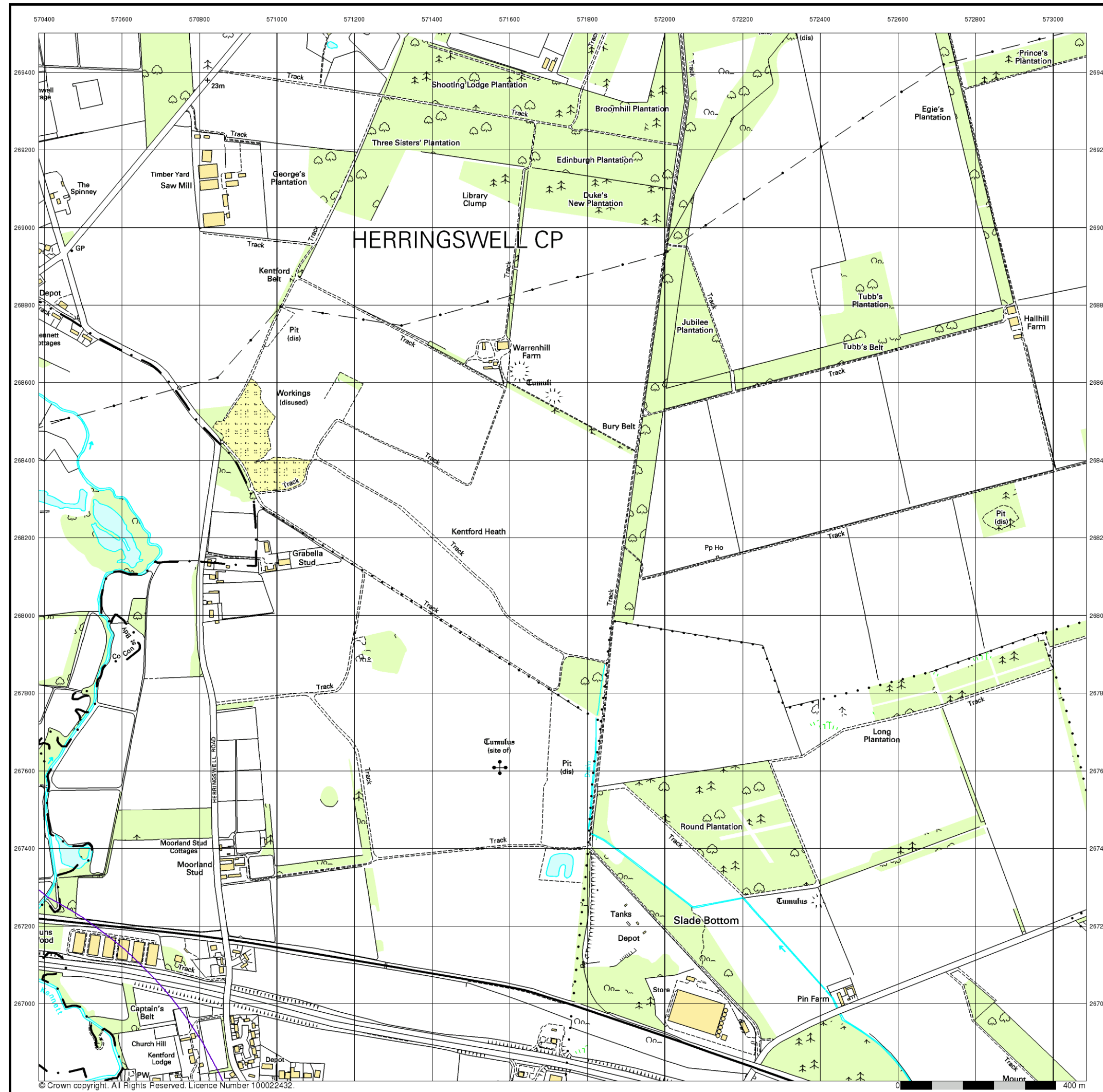

**10k Raster Mapping**  
**Published 2000**  
**Source map scale - 1:10,000**

The historical maps shown were produced from the Ordnance Survey's 1:10,000 colour raster mapping. These maps are derived from Landplan which replaced the old 1:10,000 maps originally published in 1970. The data is highly detailed showing buildings, fences and field boundaries as well as all roads, tracks and paths. Road names are also included together with the relevant road number and classification. Boundary information depiction includes county, unitary authority, district, civil parish and constituency.

**Map Name(s) and Date(s)**

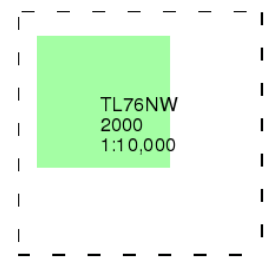

**Historical Map - Slice D**

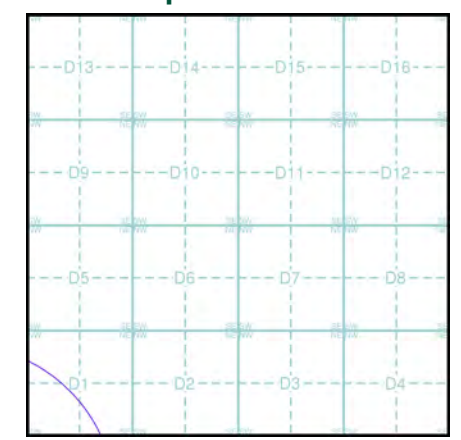

**Order Details**

Order Number: 304894834\_1\_1  
 Customer Ref: STU5875  
 National Grid Reference: 570560, 266980  
 Slice: D  
 Site Area (Ha): 51.85  
 Search Buffer (m): 1000

**Site Details**

Lanwades Hall, Newmarket, CB8 7UA

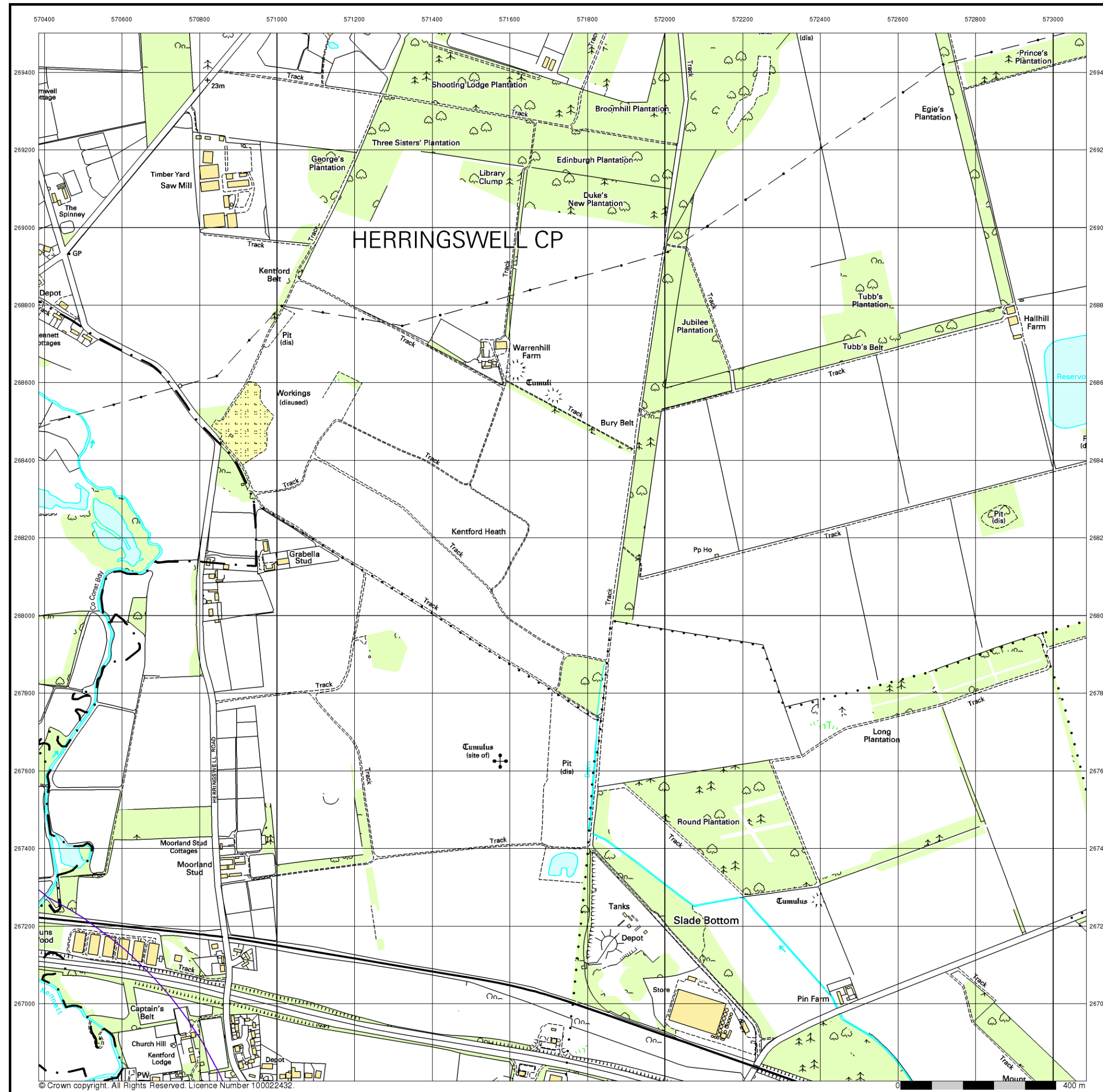

**10k Raster Mapping**  
**Published 2006**  
**Source map scale - 1:10,000**

The historical maps shown were produced from the Ordnance Survey's 1:10,000 colour raster mapping. These maps are derived from Landplan which replaced the old 1:10,000 maps originally published in 1970. The data is highly detailed showing buildings, fences and field boundaries as well as all roads, tracks and paths. Road names are also included together with the relevant road number and classification. Boundary information depiction includes county, unitary authority, district, civil parish and constituency.

**Map Name(s) and Date(s)**

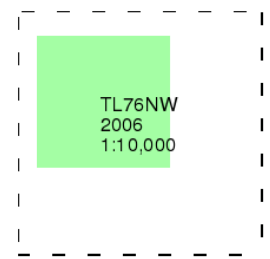

**Historical Map - Slice D**

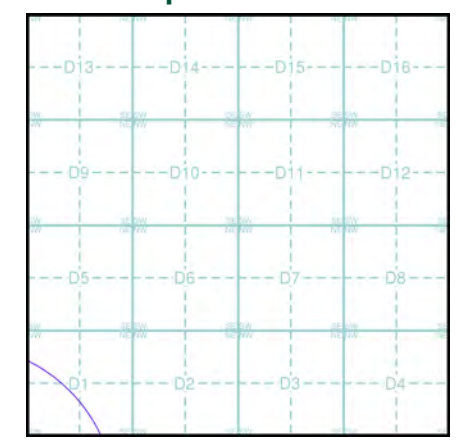

**Order Details**  
 Order Number: 304894834\_1\_1  
 Customer Ref: STU5875  
 National Grid Reference: 570560, 266980  
 Slice: D  
 Site Area (Ha): 51.85  
 Search Buffer (m): 1000

**Site Details**  
 Lanwades Hall, Newmarket, CB8 7UA

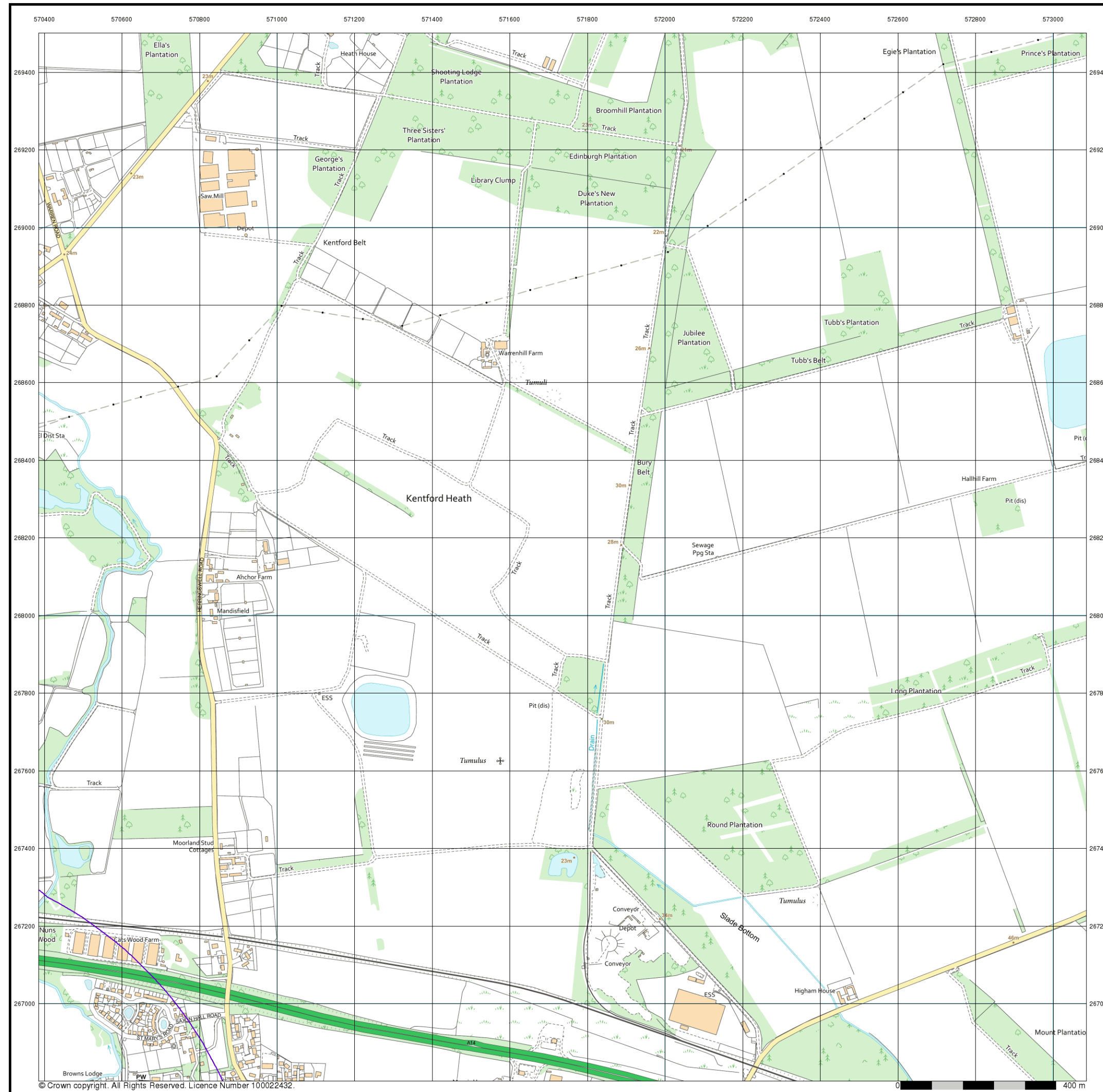

© Crown copyright. All Rights Reserved. Licence Number 100022432.

## VectorMap Local

Published 2022

Source map scale - 1:10,000

VectorMap Local (Raster) is Ordnance Survey's highest detailed 'backdrop' mapping product. These maps are produced from OS's VectorMap Local, a simple vector dataset at a nominal scale of 1:10,000, covering the whole of Great Britain, that has been designed for creating graphical mapping. OS VectorMap Local is derived from large-scale information surveyed at 1:1250 scale (covering major towns and cities), 1:2500 scale (smaller towns, villages and developed rural areas), and 1:10 000 scale (mountain, moorland and river estuary areas).

### Map Name(s) and Date(s)

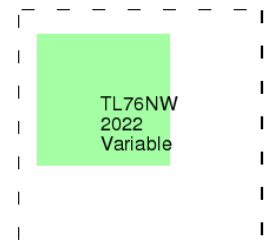

### Historical Map - Slice D

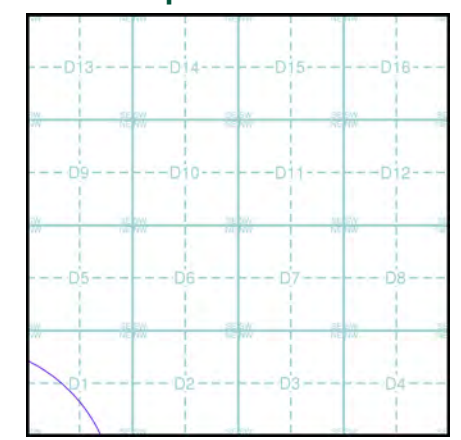

### Order Details

Order Number: 304894834\_1\_1  
 Customer Ref: STU5875  
 National Grid Reference: 570560, 266980  
 Slice: D  
 Site Area (Ha): 51.85  
 Search Buffer (m): 1000

### Site Details

Lanwades Hall, Newmarket, CB8 7UA



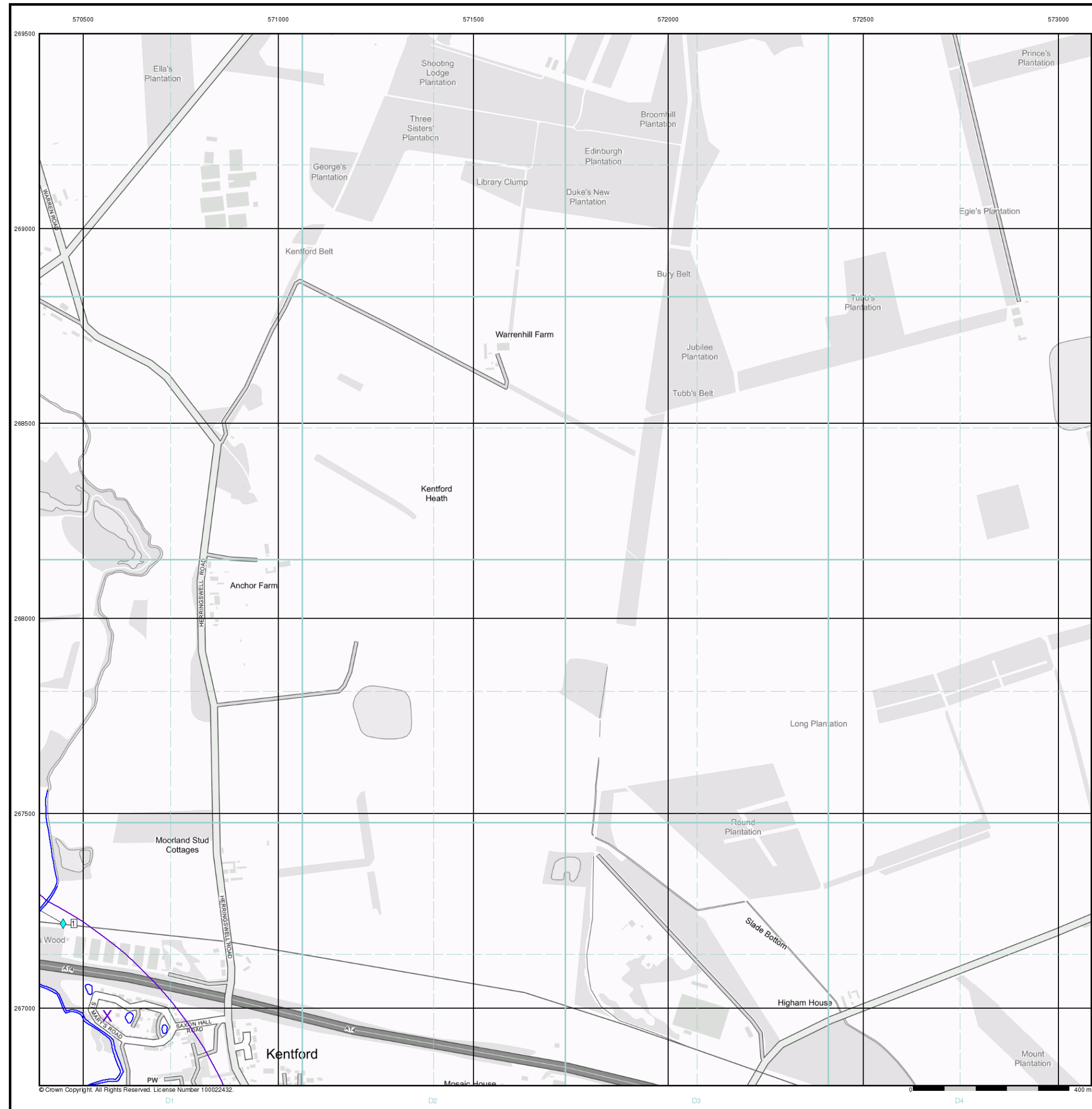

- General**
- Specified Site
  - Specified Buffer(s)
  - Bearing Reference Point
  - Map ID
  - Several of Type at Location
- Agency and Hydrological**
- Contaminated Land Register Entry or Notice (Location)
  - Contaminated Land Register Entry or Notice (Location)
  - Discharge Consent
  - Enforcement or Prohibition Notice
  - Integrated Pollution Control
  - Integrated Pollution Prevention Control
  - Local Authority Integrated Pollution Prevention and Control
  - Local Authority Pollution Prevention and Control Enforcement
  - Local Authority Pollution Prevention and Control Enforcement
  - Pollution Incident to Controlled Waters
  - Prosecution Relating to Authorised Processes
  - Prosecution Relating to Controlled Waters
  - Registered Radioactive Substance
  - River Network or Water Feature
  - River Quality Sampling Point
  - Substantiated Pollution Incident Register
  - Water Abstraction
  - Water Industry Act Referral
- Hazardous Substances**
- COMAH Site
  - Explosive Site
  - NIHHS Site
  - Planning Hazardous Substance Consent
  - Planning Hazardous Substance Enforcement
- Geological**
- BGS Recorded Mineral Site
- Waste**
- BGS Recorded Landfill Site (Location)
  - BGS Recorded Landfill Site
  - EA Historic Landfill (Buffered Point)
  - EA Historic Landfill (Polygon)
  - Integrated Pollution Control Registered Waste Site
  - Licensed Waste Management Facility (Landfill Boundary)
  - Licensed Waste Management Facility (Location)
  - Local Authority Recorded Landfill Site (Location)
  - Local Authority Recorded Landfill Site
  - Potentially Infilled Land (Non-water)
  - Potentially Infilled Land (Non-water)
  - Potentially Infilled Land (Non-water)
  - Potentially Infilled Land (Water)
  - Potentially Infilled Land (Water)
  - Potentially Infilled Land (Water)
  - Registered Landfill Site
  - Registered Landfill Site (Location)
  - Registered Landfill Site (Point Buffered to 100m)
  - Registered Landfill Site (Point Buffered to 250m)
  - Registered Waste Transfer Site (Location)
  - Registered Waste Transfer Site
  - Registered Waste Treatment or Disposal Site (Location)
  - Registered Waste Treatment or Disposal Site

### Site Sensitivity Map - Slice D

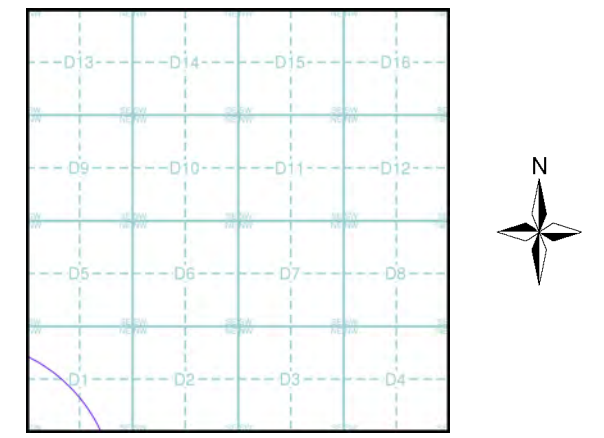

**Order Details**

Order Number: 304894834\_1\_1  
 Customer Ref: STU5875  
 National Grid Reference: 570560, 266980  
 Slice: D  
 Site Area (Ha): 51.85  
 Search Buffer (m): 1000

**Site Details**  
 Lanwades Hall, Newmarket, CB8 7UA

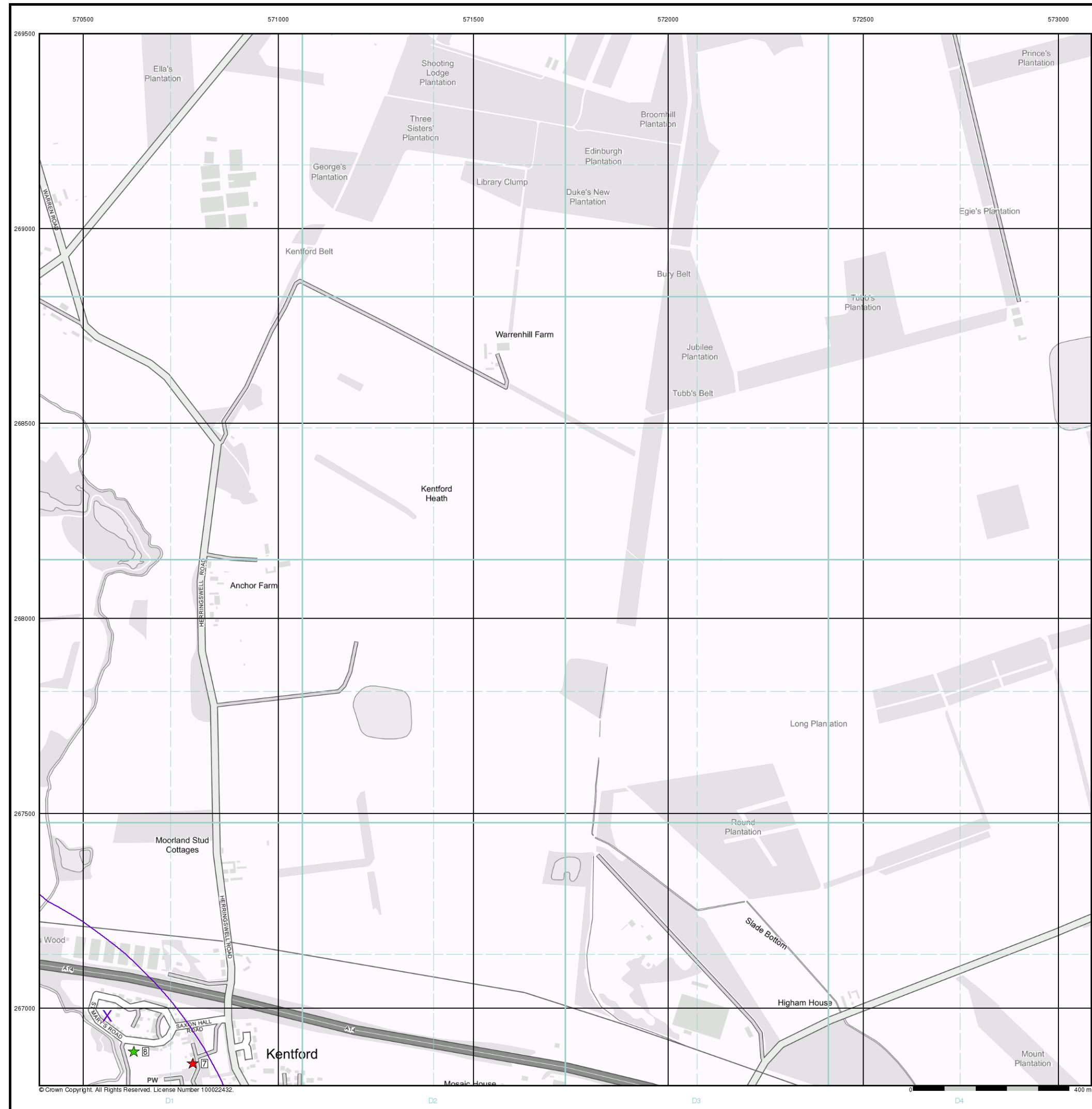

## Industrial Land Use Map

- General**
- Specified Site
  - Specified Buffer(s)
  - Bearing Reference Point
  - Slice
  - Map ID
- Industrial Land Use**
- Contemporary Trade Directory Entry
  - Fuel Station Entry
  - Gas Pipeline
  - Points of Interest - Commercial Services
  - Points of Interest - Education and Health
  - Points of Interest - Manufacturing and Production
  - Points of Interest - Public Infrastructure
  - Points of Interest - Recreational and Environmental
  - Underground Electrical Cables

## Industrial Land Use Map - Slice D

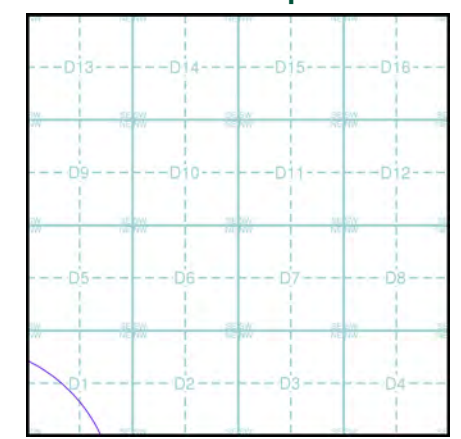



## Order Details

Order Number: 304894834\_1\_1  
 Customer Ref: STU5875  
 National Grid Reference: 570560, 266980  
 Slice: D  
 Site Area (Ha): 51.85  
 Search Buffer (m): 1000



## Site Details

Lanwades Hall, Newmarket, CB8 7UA

### General

-  Specified Site
-  Specified Buffer(s)
-  Bearing Reference Point

### Agency and Hydrological (Flood)

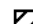
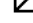
-  Extreme Flooding from Rivers or Sea without Defences (Zone 2)
-  Flooding from Rivers or Sea without Defences (Zone 3)
-  Area Benefiting from Flood Defence
-  Flood Water Storage Areas
-  Flood Defence

### Flood Map - Slice D

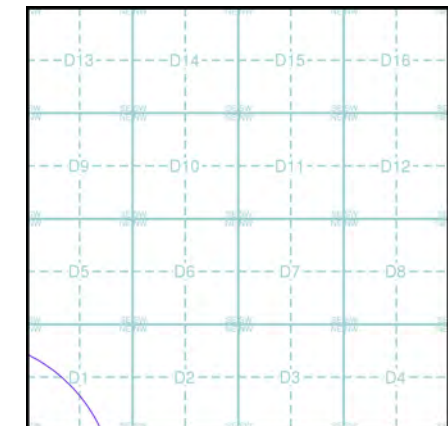

### Order Details

Order Number: 304894834\_1\_1  
 Customer Ref: STU5875  
 National Grid Reference: 570560, 266980  
 Slice: D  
 Site Area (Ha): 51.85  
 Search Buffer (m): 1000



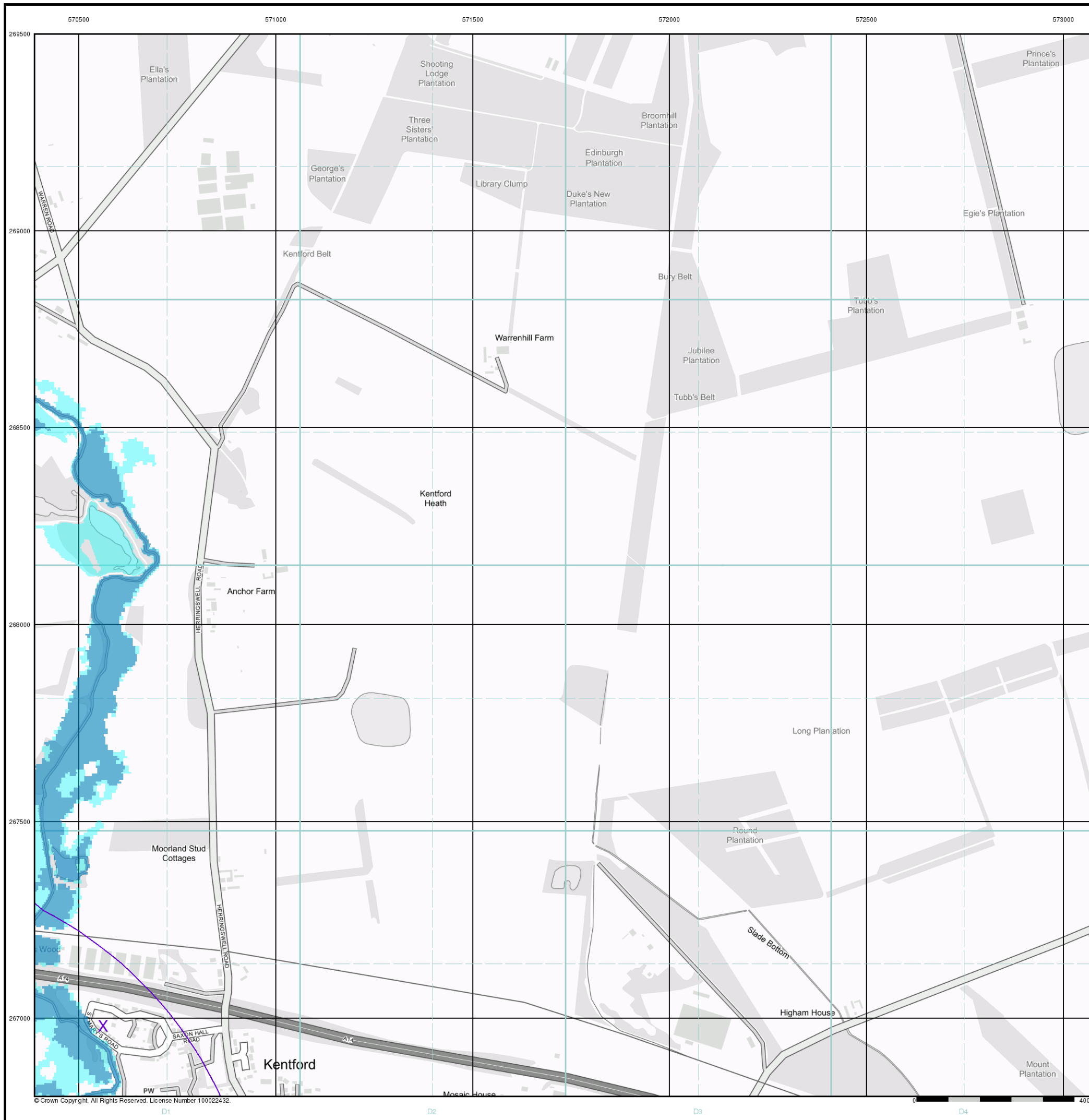

### Site Details

Lanwades Hall, Newmarket, CB8 7UA







© Crown Copyright. All Rights Reserved. License Number 100022432.

### General

-  Specified Site
-  Specified Buffer(s)
-  Bearing Reference Point
-  Map ID
-  Several of Type at Location

### Agency and Hydrological (Boreholes)

-  BGS Borehole Depth 0 - 10m
-  BGS Borehole Depth 10 - 30m
-  BGS Borehole Depth 30m +
-  Confidential
-  Other

For Borehole information please refer to the Borehole .csv file which accompanied this slice.

A copy of the BGS Borehole Ordering Form is available to download from the Support section of [www.envirocheck.co.uk](http://www.envirocheck.co.uk).

### Borehole Map - Slice D

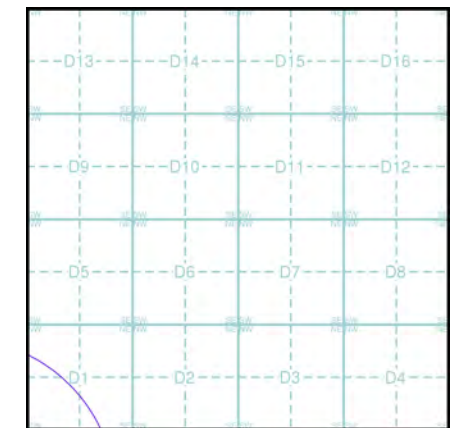

### Order Details

Order Number: 304894834\_1\_1  
 Customer Ref: STU5875  
 National Grid Reference: 570560, 266980  
 Slice: D  
 Site Area (Ha): 51.85  
 Search Buffer (m): 1000

### Site Details

Lanwades Hall, Newmarket, CB8 7UA



### General

- Specified Site
- Specified Buffer(s)
- Bearing Reference Point

### OS Water Network Data

- |  |              |  |                         |
|--|--------------|--|-------------------------|
|  | Canal        |  | Drain                   |
|  | Reservoir    |  | Other                   |
|  | Foreshore    |  | Lake                    |
|  | Marsh        |  | Transfer                |
|  | Tidal River  |  | Lock Or Flight Of Locks |
|  | Inland River |  | Sea                     |

### Contours (height in meters)

- Standard Contour 105 100 95
- Master Contour
- Spot Height 167.3
- Mean Low Water
- Mean High Water

### OS Water Network Map - Slice D

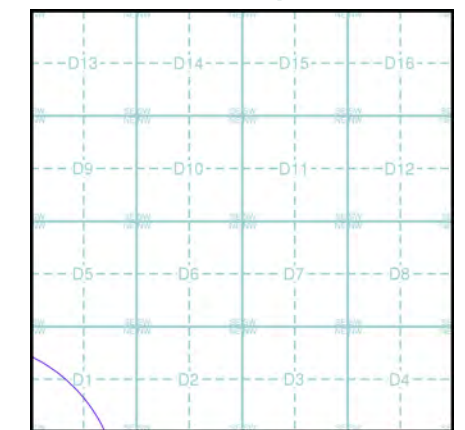

### Order Details

Order Number: 304894834\_1\_1  
 Customer Ref: STU5875  
 National Grid Reference: 570560, 266980  
 Slice: D  
 Site Area (Ha): 51.85  
 Search Buffer (m): 1000

### Site Details

Lanwades Hall, Newmarket, CB8 7UA



© Crown Copyright. All Rights Reserved. License Number 100022432.

### General

- Specified Site
- Specified Buffer(s)
- Bearing Reference Point

### Risk of Flooding from Surface Water

- High - 30 Year Return
- Medium - 100 Year Return
- Low - 1000 Year Return

### Suitability

See the suitability map below

- National to county
- County to town
- Town to street
- Street to parcels of land
- Property

### EANRW Suitability Map - Slice D

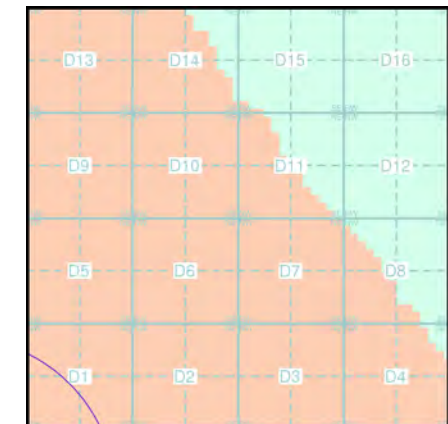

### Order Details

Order Number: 304894834\_1\_1  
 Customer Ref: STU5875  
 National Grid Reference: 570560, 266980  
 Slice: D  
 Site Area (Ha): 51.85  
 Search Buffer (m): 1000

### Site Details

Lanwades Hall, Newmarket, CB8 7UA

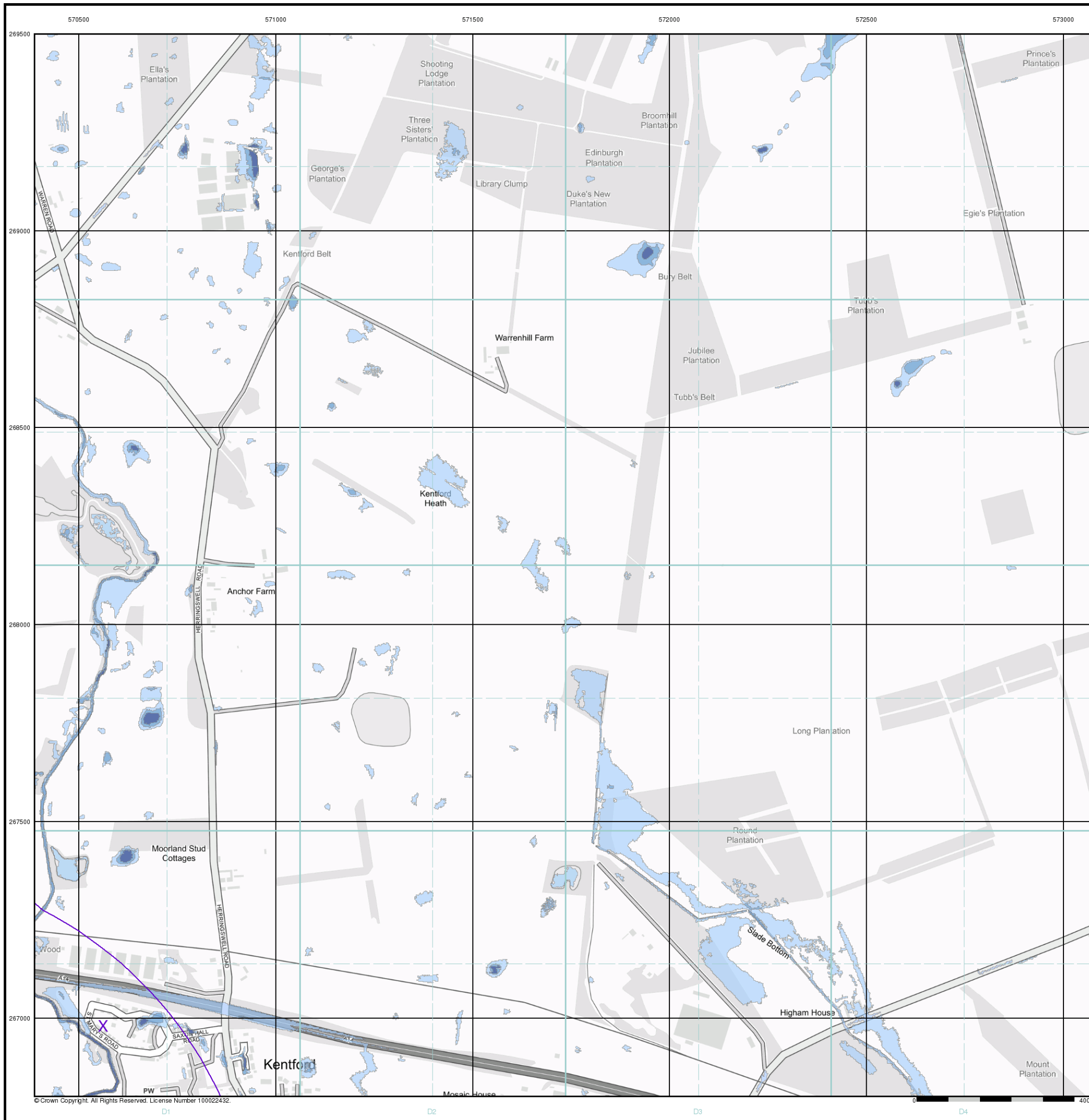

© Crown Copyright. All Rights Reserved. License Number 100022432.