



Nick Culhane
Highway Consultant

Idlewild
Fairclose Drive
Winchester
Hampshire SO22 6QW



Proposed Change of Use of Part of Existing Stables to Allow Public Events such as Weddings and Parties
Shedfield Nursery and Equestrian Centre, Botley Road, Shedfield, SO32 2HN

Introduction

This Highway Technical Note has been produced in support of a planning application submission to Winchester City Council for the change of use of part of an existing indoor riding school to allow events such as weddings to be undertaken. The location of the site is shown below.



The site is located on the south-western side of Botley Road which is classified as the A334 and is at this point is subject to a 40-mph speed limit. The road runs south-east to west where it links the B2177 at Shedfield with Botley to the west. In the vicinity of the site the road has a width of circa 6.8m and benefits from a pedestrian footway on the northern side.

The application site is currently served by a private road and a priority junction access to the north-west which runs along the northerly boundary of paddocks in the ownership of the Applicant.

The site has a considerable Planning History although in this case the most pertinent was a consent granted under the reference 15/01841/FUL for the demolition of existing stabling and extension to the existing building over a menage. This included a bar and kitchen area together with associated toilets. This is demonstrated below.

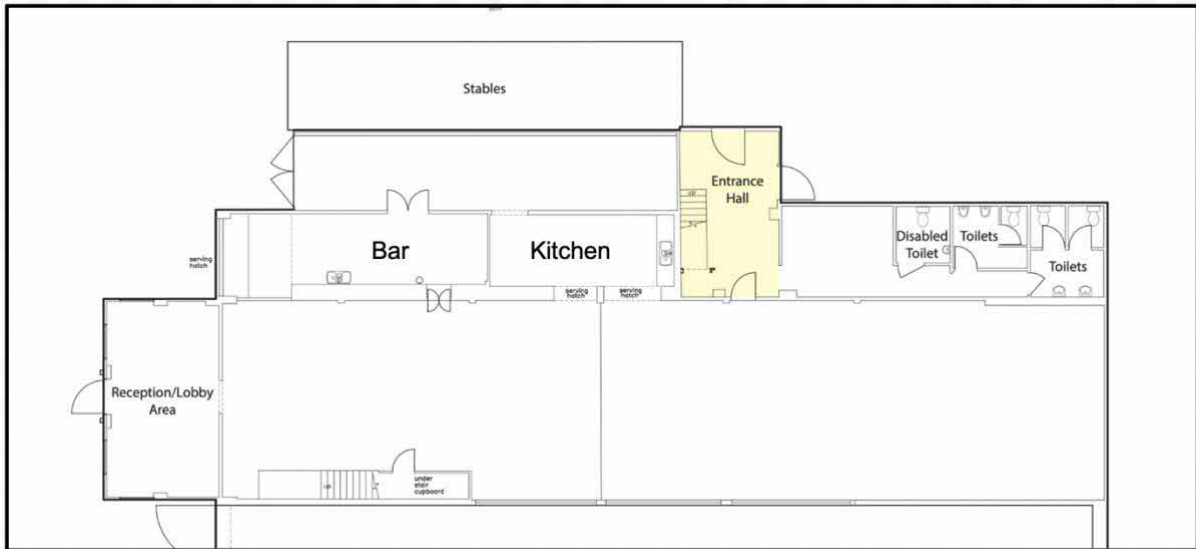

The bar and kitchen area are currently used to provide refreshments for the various users of the Riding School where seating is available which overlooks the indoor ménage.

Proposed Development

This application seeks a change of use of part of the building, namely the bar, kitchen area and seating area, to a facility where the public can attend functions such as weddings, funerals or parties. This Technical Note therefore addresses the highway implications and concludes that the development would not result in any material highway implications.

Pre-Application Submission

A pre-application submission was made to Hampshire County Council as Local Highway Authority who considered the principle of the proposals to be acceptable from a highway point of view.

Accident History

In order to determine the accident history on the surrounding highway network, Hampshire Constabulary have provided the latest details for accidents resulting in injury for a 5-year period from 01/06/2017 until 31/05/2022 and in this instance, the focus has been placed on the A334 and its junction with B2177. A summary of the accidents is given within the table below, whilst the data is included as [Appendix 1](#) to this Note.

Date	Location	Description	Casualties
03/08/17	Church Lane junction with A334	Veh 2 travelling SW on Church Lane tries to overtake Veh 1 waiting to turn into A334 and collides	1 slight
14/08/17	A334 junction with The Oaks	Veh 2 travelling NW on A334 stops due to another Veh turning right into The Oaks and Veh 1 fails to stop causing a rear end shunt	1 serious

07/06/18	A334 junction with Sandy Lane	Veh 2 travelling NW on A334 slows to turn right into Sandy Lane and Veh 1 fails to slow in time causing a rear end shunt	2 slight
15/07/18	A334 junction with Church Road	Veh 2 travelling SW on Church Rd turns right onto A334 into path of Veh 1 travelling on A334 causing a collision	1 slight
21/02/19	A334 outside The Oaks	Cyclist travelling SE on A334 falls from bike	1 serious
03/04/2019	A334 outside The Oaks	Veh 1 travelling NW on A334 fails to react to Veh2 stopping and collides with the rear	1 slight
11/05/19	A334 at junction with A334	Veh 1 travelling SE on A334 collides with central island bollard and flips onto its roof	1 slight
25/11/19	A334 junction with A334	Veh 2 travelling SE on A334 fails to stop at junction and collides with car 2 withing to turn right into A334	1 slight
08/12/19	A334 junction with A334	Veh 1 travelling on B2177 turns left into A334 but clips kerb and overturns	1 slight
22/01/20	A334 junction with A334	Veh 1 travelling SE on A334 turns right onto A334 but misjudges the junction and overturns into a ditch	1 slight
17/02/20	B2177 junction with A334	Veh 1 travelling S on B2177 fails to brake and collides with rear of Veh 2 waiting to turn right	1 slight
03/01/21	A334 outside 1 Aylings	Veh 1 travelling NW on A334 comes to an abrupt stop due to animal in the road. Veh 2 also stops but Veh 3 collides with Veh 2	1 slight
22/03/21	A334 junction with B2177	Veh 1 travelling SE fails to give way and collides with Veh 2 travelling on B2177	2 slight
05/04/21	A334 junction with Equestrian Centre	Veh 1 travelling NW along A334 collides with Veh 2 travelling NW and slowing to turn into Shedfield Equestrian centre	1 slight
02/08/21	A334 junction with B2177	Veh 1 travelling on A334 fails to give way at junction and collides with Veh 2 travelling on B2177	2 slight
15/09/21	A334 junction with B2177	Veh 1 travelling SE on A334 fails to give way and collides with Veh 2 travelling on B2177	1 serious
03/03/22	A334 junction with A334	Veh 1 travelling SE on A334 turn right but stops due to road works. Veh 2 then collides with rear of Veh 1	1 slight
10/03/22	A334 junction with B2177	Veh 1 travelling NW on A334 loses control and collides with central bollard	1 serious
29/03/22	A334 junction with B2177	Veh 1 travelling Se on A334 fails to give way at junction and collides with Veh 2 travelling on B2177	1 slight

Whilst there appear to be a number of accidents on the A334 and at its junction with the A334 / B2177, all appear to involve driver error rather than any deficiencies with the highway network. Some involve just a single vehicle, whilst just 1 incident has occurred at the access of the application site with Botley Road. This though was a rear end shunt where the preceding driver failed to brake in time to avoid a vehicle turning right into the site.

It can therefore be concluded that there is not an overarching set of circumstances that make the A334 or its junction with the B2177 unsafe, and it is unlikely that this situation would be exacerbated by the proposed development.

Site Access

The site benefits from two access points, one to the southeast and one to the north west. The former is the main access which serves the Equestrian Centre, and various shops and other enterprises, whilst the north-western access serves the application site together with AA Edwards Wholesale Fruit and Vegetables. The access takes the form of a simple priority junction which is shown below.



The A334 at this point is subject to a 40mph speed limit therefore based on the advice contained within the Hampshire County Council document Technical Guidance 3, visibility splays of 2.4m by 120.0m would be required in both the north-westerly and south-easterly directions.

Drawing numbered NJC-001 is included as [Appendix 2](#) to this Note which shows the existing access together with the required visibility splays. In addition, drawing numbered NJC-002 is included as [Appendix 3](#) to this Note which shows a cross section of the access and visibility. This demonstrates the ability of the access to provide a suitable vision splay from a driver's eye height of 1.05m to 2.0m above carriageway level at the access, to an object height of between 600mm and 1.05m at the ends of both Y distances. These splays are available either within land under the control of the applicant, or within the extent of the public highway.

Traffic Impact

It is anticipated that site would accommodate between 150 – 200 guests as a maximum, although most events are likely to be less well attended. Proposals for wedding and party establishments have previously been considered by the Local Highway Authority (LHA) with a particular site being located at Nursling Street, Nursling submitted to Test Valley Borough Council under reference 20/00358/FULLS.

At that time, the LHA accepted that an average occupation of a car would be three guests, although they also recognised that up to 20% could use a taxi service. The maximum number of cars in this case would therefore be 47, based on 160 guests (200 – 20% using taxis) at an occupation rate of 3 per car ($160 \div 3 = 47$).

Weddings will be the most regular celebrations and it is likely that fewer guests would be attending the Wedding Breakfast with further guests likely to attend the evening celebration. Weddings would take place across the whole day, whilst other celebrations such as birthday parties would be restricted to afternoons or evenings.

In order to identify the likely impact that such an event would have, a 7-day traffic volume survey was undertaken on the A334 in the vicinity of the site access. Assuming that guests would arrive from 2:00pm onwards and would leave around midnight, the existing average traffic flows can be shown below.

A334 Botley Road Shedfield Traffic Volumes			
Hour Ending	Southbound	Northbound	Combined Flow
14:00	281 vehicles	289 vehicles	570 vehicles
24:00	28 vehicles	30 vehicles	58 vehicles

The addition of around 47 vehicles through the existing access junction and on the highway network as a result of the development is not considered to be significant considering the existing flows on the A334.

There will also be some increase in staff vehicular traffic, but as the bar and café are operating at present, the increase in staff numbers is likely to be minimal. The Traffic Survey data is included as [Appendix 4](#) to this Note.

Car Parking

The car park will accommodate a maximum of some 64 vehicles, although these will only be required on the day of a function. The site has a large open area to the east of the building where it is proposed car parking can be accommodated. Spaces will be formally laid out, and a Marshall will be employed on the day of a function to ensure that parking is undertaken in a safe and orderly manner. The site is located in such a position that will ensure that all parking will be accommodated within the site and no overspill parking will occur on the surrounding highway network. This is shown on drawing V2 included as [Appendix 5](#) to this Note.

The car park will be served from the existing north-westerly access and drawing numbered NJC-003 is included as [Appendix 6](#) to this Note which shows the ability of two large cars to pass one another at the junction with A334.

At the pre-application stage, the LHA did raise some concerns about the ability for two cars to pass one another within the internal access road. This has therefore been addressed with the introduction of two passing bays within the site, to accommodate any passing needs of traffic.

All servicing associated with the various functions will take place outside of the times when guests will be present.

Summary and Conclusion

This Highway Technical Note has been produced in support of a planning application for the change of use of part of an existing indoor riding school to allow events such as weddings to be undertaken.

The site is to be served by an existing access onto the A334 where visibility is in accordance with the posted speed limit and in accordance with the LHA's document Technical Guidance 3.

If permitted, the proposals will generate around 50 additional traffic movements at the start and at the end of each event, all of which will take place outside of recognised peak traffic periods.

Adequate car parking will be provided within the site which will be directed by an appointed Marshall on the days of a specific function.

The use of the site for events such as weddings and parties will not result in any detriment to the safe operation of the public highway and is deemed to be acceptable from a highway point of view.

Nick Culhane July 2023

Appendix 1

Accident Data

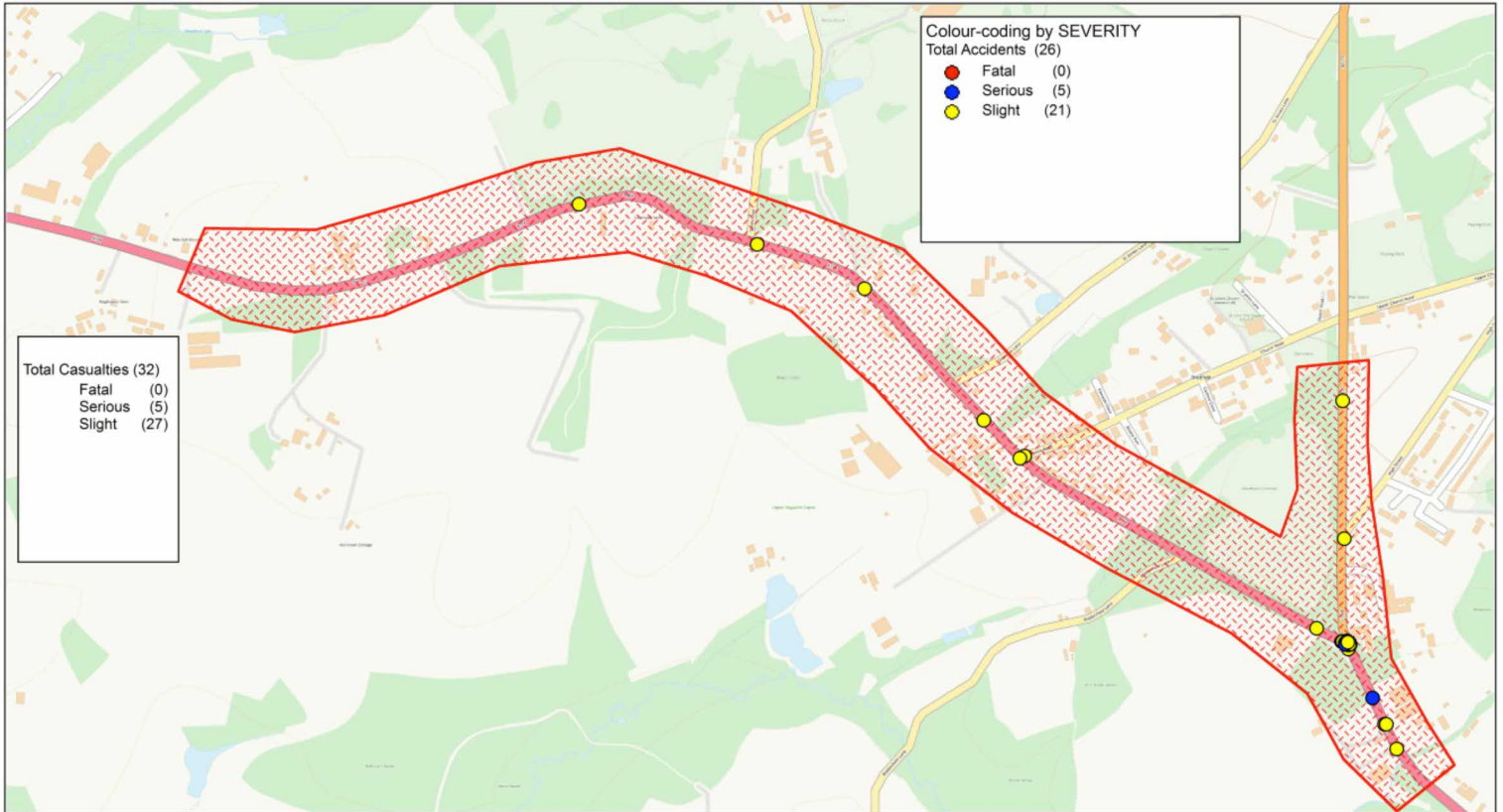

Selected map area

© Crown copyright. All rights reserved
 Hampshire Police
 Licence No. 01021C 2022

Scale	1 : 9220
DATE	07/12/2022
DRAWING No.	
DRAWN BY	

Appendix 5

Swept Path Tracking

Accidents between dates 01/06/2017 and 31/05/2022 (60) months

Selection:

Selected using Pre-defined Query : ; Refined using Accidents within selected Polygons -HC - RPU Statistics Request ("A334 SHEDFIELD"); Refined using Accidents within selected Polygons -HC - RPU Statistics Request ("A334 SHEDFIELD")

Notes:

Selected Polygon:A334 SHEDFIELD

Accidents between dates 01/06/2017 and 31/05/2022 (60) months

Selection:

Selected using Pre-defined Query : ; Refined using Accidents within selected Polygons -HC - RPU Statistics Request ("A334 SHEDFIELD"); Refined using Accidents within selected Polygons -HC - RPU Statistics Request ("A334 SHEDFIELD")

Notes:

44170230075 16/06/2017 Time 2130 Vehicles 4 Casualties 2 Slight
 E:456315 N:113172 First Road: B 2177 Road Type Single carriageway
 Speed limit: 50 Junction Detail: Not within 20m of junction
 Crossing: Control None Facilities: None within 50m Road surface Dry
 Darkness: street lighting unknown Fine without high winds
 Special Conditions at Site None Carriageway Hazards: None
 Place accident reported: At scene DfT Special Projects:

Causation

	Factor:	Participant:	Confidence:
1st:	Failed to look properly	Vehicle 1	Very Likely
2nd:	Failed to judge other persons path or speed	Vehicle 1	Very Likely
3rd:			
4th:			
5th:			
6th:			

VEH 1 (CAR) TRAV S ALONG B2177 WINCHESTER ROAD OVERTAKES VEH 2 (CAR) TRAV IN SAME DIRECTION, HITS VEH 3 (CAR) TRAV IN OPPOSITE DIRECTION, REBOUNDS INTO VEH 2, REBOUNDS AGAIN INTO ON COMING TRAFFIC HITS OFFSIDE KERB AND HITS VEH 4 (CAR) BEHIND VEH 3
 Occurred on B2177 WINCHESTER ROAD 51 METRES SOUTH OF DAISY COTTAGE, SHEDFIELD, HAMPSHIRE

Vehicle Reference 1 Car Overtaking nearside
 Vehicle movement from N to S No tow / articulation Leaving the main road
 On main carriageway No skidding, jack-knifing or overturning
 Location at impact Not at, or within 20M of Jct First impact Front Hit vehicle:
 Hit object in road Kerb Off road: None
 Did not leave carr Age of Driver 21 Male
 Not hit and run Breath test Negative
 Left hand drive: No

Casualty Reference: 1 Vehicle: 1 Age: 21 Male Driver/rider Severity: Slight
 Not a pupil
 Seatbelt Not Applicable Cycle helmet: Not a cyclist

Vehicle Reference 2 Car Going ahead other
 Vehicle movement from N to S No tow / articulation Leaving the main road
 On main carriageway No skidding, jack-knifing or overturning
 Location at impact Not at, or within 20M of Jct First impact Offside Hit vehicle:
 Hit object in road None Off road: None
 Did not leave carr Age of Driver 46 Female
 Not hit and run Breath test Negative
 Left hand drive: No

Accidents between dates 01/06/2017 and 31/05/2022 (60) months

Selection: Notes:

Selected using Pre-defined Query : ; Refined using Accidents within selected Polygons -HC - RPU Statistics Request ("A334 SHEDFIELD"); Refined using Accidents within selected Polygons -HC - RPU Statistics Request ("A334 SHEDFIELD")

Vehicle Reference 3 Car Going ahead other
Vehicle movement from S to N No tow / articulation Leaving the main road
On main carriageway No skidding, jack-knifing or overturning
Location at impact Not at, or within 20M of Jct First impact Front Hit vehicle:
Hit object in road None Off road: None
Did not leave carr Age of Driver 52 Male
Not hit and run Breath test Negative
Left hand drive: No

Vehicle Reference 4 Car Going ahead other
Vehicle movement from S to N No tow / articulation Leaving the main road
On main carriageway No skidding, jack-knifing or overturning
Location at impact Not at, or within 20M of Jct First impact Front Hit vehicle:
Hit object in road None Off road: None
Nearside Age of Driver 40 Female
Not hit and run Breath test Negative
Left hand drive: No

Casualty Reference: 2 Vehicle: 4 Age: 40 Female Driver/rider Severity: Slight
Not a pupil
Seatbelt Not Applicable Cycle helmet: Not a cyclist

Accidents between dates 01/06/2017 and 31/05/2022 (60) months

Selection:

Selected using Pre-defined Query : ; Refined using Accidents within selected Polygons -HC - RPU Statistics Request ("A334 SHEDFIELD"); Refined using Accidents within selected Polygons -HC - RPU Statistics Request ("A334 SHEDFIELD")

Notes:

44170299011 03/08/2017 Time 1700 Vehicles 2 Casualties 1 Slight
 E:455762 N: 113076 First Road: U Road Type Single carriageway
 Speed limit: 30 Junction Detail: T & Stag Jct Give way or controlled A 334
 Crossing: Control None Facilities: None within 50m Road surface Dry
 Daylight Fine without high winds
 Special Conditions at Site None Carriageway Hazards: None
 Place accident reported: Elsewhere DfT Special Projects:

Causation

	Factor:	Participant:	Confidence:
1st:	Failed to look properly	Vehicle 2	Possible
2nd:	Careless/Reckless/In a hurry	Vehicle 2	Possible
3rd:			
4th:			
5th:			
6th:			

VEH 2 (VAN) TRAVELLING SW ALONG CHURCH ROAD TRYING TO OVERTAKE VEH 1 (CAR) WAITING TO TURN INTO A334 BOTLEY ROAD AND COLLIDES.

Occurred on A334 BOTLEY ROAD AT JUNCTION WITH CHURCH ROAD, SHEDFIELD, HAMPSHIRE

Vehicle Reference 1 Car Going ahead but held up
 Vehicle movement from NE to NW No tow / articulation Leaving the main road
 On main carriageway No skidding, jack-knifing or overturning
 Location at impact Mid Junction - on roundabout or r First impact Offside Hit vehicle:
 Hit object in road None Off road: None
 Did not leave carr Age of Driver 73 Female
 Not hit and run Breath test Driver not contacted
 Left hand drive: No

Casualty Reference: 1 Vehicle: 1 Age: 73 Female Driver/rider Severity: Slight
 Not a pupil
 Seatbelt Not Applicable Cycle helmet: Not a cyclist

Vehicle Reference 2 Van or Goods 3.5 tonnes mgw and under Overtaking stat vehicle O/S
 Vehicle movement from NE to NW No tow / articulation Leaving the main road
 On main carriageway No skidding, jack-knifing or overturning
 Location at impact Mid Junction - on roundabout or r First impact Front Hit vehicle:
 Hit object in road None Off road: None
 Did not leave carr Age of Driver Not traced
 Hit and run Breath test Driver not contacted
 Left hand drive: No

Accidents between dates 01/06/2017 and 31/05/2022 (60) months

Selection:

Selected using Pre-defined Query : ; Refined using Accidents within selected Polygons -HC - RPU Statistics Request ("A334 SHEDFIELD"); Refined using Accidents within selected Polygons -HC - RPU Statistics Request ("A334 SHEDFIELD")

Notes:

44170313618 14/08/2017 Time 1147 Vehicles 2 Casualties 1 Serious
 E:456390 N: 112609 First Road: A 334 Road Type Single carriageway
 Speed limit: 40 Junction Detail: Pri Drive Give way or controlled Unclassified
 Crossing: Control None Facilities: None within 50m Road surface Dry
 Daylight Fine without high winds
 Special Conditions at Site None Carriageway Hazards: None
 Place accident reported: At scene DfT Special Projects:

Causation

	Factor:	Participant:	Confidence:
1st:	Failed to look properly	Vehicle 1	Possible
2nd:	Failed to judge other persons path or speed	Vehicle 1	Possible
3rd:			
4th:			
5th:			
6th:			

VEH 2 (CAR) TRAVELLING NW ALONG A334 WINCHESTER ROAD STOPS DUE TO ANOTHER VEH TURNING RIGHT INTO THE OAKS. FOLLOWING VEH 1 (CAR) FAILED TO STOP IN TIME AND COLLIDED WITH REAR OF VEH 2

Occurred on A334 WINCHESTER ROAD AT JUNCTION WITH THE OAKS, WICKHAM, HAMPSHIRE

Vehicle Reference 1 Car Going ahead other
 Vehicle movement from SE to NW No tow / articulation Leaving the main road
 On main carriageway No skidding, jack-knifing or overturning
 Location at impact Jct Approach First impact Front Hit vehicle:
 Hit object in road None Off road: None
 Did not leave carr Age of Driver 74 Female
 Not hit and run Breath test Not applicable
 Left hand drive: No

Casualty Reference: 1 Vehicle: 1 Age: 74 Female Driver/rider Severity: Serious
 Not a pupil
 Seatbelt Not Applicable Cycle helmet: Not a cyclist

Vehicle Reference 2 Car Going ahead other
 Vehicle movement from SE to NW No tow / articulation Leaving the main road
 On main carriageway No skidding, jack-knifing or overturning
 Location at impact Jct Approach First impact Back Hit vehicle:
 Hit object in road None Off road: None
 Did not leave carr Age of Driver 27 Female
 Not hit and run Breath test Negative
 Left hand drive: No

Accidents between dates 01/06/2017 and 31/05/2022 (60) months

Selection:

Selected using Pre-defined Query : ; Refined using Accidents within selected Polygons -HC - RPU Statistics Request ("A334 SHEDFIELD"); Refined using Accidents within selected Polygons -HC - RPU Statistics Request ("A334 SHEDFIELD")

Notes:

44180034649 26/01/2018 Time 1952 Vehicles 2 Casualties 2 Slight
 E:456318 N:112932 First Road: U Road Type Single carriageway
 Speed limit: 30 Junction Detail: T & Stag Jct Give way or controlled B 2177
 Crossing: Control None Facilities: None within 50m Road surface Dry
 Darkness: no street lighting Fine without high winds
 Special Conditions at Site None Carriageway Hazards: None
 Place accident reported: At scene DfT Special Projects:

Causation

	Factor:	Participant:	Confidence:
1st:	Failed to look properly	Vehicle 2	Very Likely
2nd:	Failed to judge other persons path or speed	Vehicle 2	Very Likely
3rd:	Following too close	Vehicle 2	
4th:			
5th:			
6th:			

VEH1 (CAR) TRAVELLING SW ON HIGH STREET SLOWS AND STOPS FOR JUNCTION WITH B2177 WINCHESTER ROAD AND IS HIT FROM BEHIND BY VEH2 (CAR) THAT FAILED TO SLOW IN TIME. BOTH DRIVERS SUSTAIN MINOR INJURIES.

Occurred on HIGH STREET AT JUNCTION WITH B2177 WINCHESTER ROAD, SHIRRELL HEATH, HAMPSHIRE.

Vehicle Reference 1 Car Stopping
 Vehicle movement from NE to SW No tow / articulation Leaving the main road
 On main carriageway No skidding, jack-knifing or overturning
 Location at impact Jct Approach First impact Back Hit vehicle:
 Hit object in road None Off road: None
 Did not leave carr Age of Driver 25 Female
 Not hit and run Breath test Negative
 Left hand drive: No

Casualty Reference: 1 Vehicle: 1 Age: 25 Female Driver/rider Severity: Slight
 Not a pupil
 Seatbelt Not Applicable Cycle helmet: Not a cyclist

Vehicle Reference 2 Car Stopping
 Vehicle movement from NE to SW No tow / articulation Leaving the main road
 On main carriageway No skidding, jack-knifing or overturning
 Location at impact Jct Approach First impact Front Hit vehicle:
 Hit object in road None Off road: None
 Did not leave carr Age of Driver 21 Male
 Not hit and run Breath test Negative
 Left hand drive: No

Casualty Reference: 2 Vehicle: 2 Age: 21 Male Driver/rider Severity: Slight
 Not a pupil
 Seatbelt Not Applicable Cycle helmet: Not a cyclist

Accidents between dates 01/06/2017 and 31/05/2022 (60) months

Selection:

Selected using Pre-defined Query : ; Refined using Accidents within selected Polygons -HC - RPU Statistics Request ("A334 SHEDFIELD"); Refined using Accidents within selected Polygons -HC - RPU Statistics Request ("A334 SHEDFIELD")

Notes:

44180212234 07/06/2018 Time 1528 Vehicles 2 Casualties 2 Slight
 E:455297 N:113444 First Road: A 334 Road Type Single carriageway
 Speed limit: 40 Junction Detail: T & Stag Jct Give way or controlled Unclassified
 Crossing: Control None Facilities: None within 50m Road surface Dry
 Daylight Fine without high winds
 Special Conditions at Site None Carriageway Hazards: None
 Place accident reported: At scene DfT Special Projects:

Causation

	Factor:	Participant:	Confidence:
1st:	Failed to look properly	Vehicle 1	Very Likely
2nd:	Failed to judge other persons path or speed	Vehicle 1	Very Likely
3rd:			
4th:			
5th:			
6th:			

VEH2 (CAR) TRAVELLING NW ALONG A334 BOTLEY ROAD SLOWS AND INDICATES TO TURN RIGHT INTO SANDY LANE. VEH1 (CAR) TRAVELLING NW ALONG A334 BOTLEY ROAD FAILS TO SLOW IN TIME AND COLLIDES WITH THE REAR OF VEH2.

Occurred on A334 BOTLEY ROAD AT JUNCTION WITH SANDY LANE, CURDRIDGE, HAMPSHIRE.

Vehicle Reference 1 Car Going ahead other
 Vehicle movement from SE to NW No tow / articulation Leaving the main road
 On main carriageway No skidding, jack-knifing or overturning
 Location at impact Jct Approach First impact Front Hit vehicle:
 Hit object in road None Off road: None
 Did not leave carr Age of Driver 32 Female
 Not hit and run Breath test Negative
 Left hand drive: No

Casualty Reference: 1 Vehicle: 1 Age: 32 Female Driver/rider Severity: Slight
 Not a pupil
 Seatbelt Not Applicable Cycle helmet: Not a cyclist

Vehicle Reference 2 Car Waiting to turn right
 Vehicle movement from E to N No tow / articulation Leaving the main road
 On main carriageway No skidding, jack-knifing or overturning
 Location at impact Jct Approach First impact Back Hit vehicle:
 Hit object in road None Off road: None
 Did not leave carr Age of Driver 47 Female
 Not hit and run Breath test Negative
 Left hand drive: No

Casualty Reference: 2 Vehicle: 2 Age: 47 Female Driver/rider Severity: Slight
 Not a pupil
 Seatbelt Not Applicable Cycle helmet: Not a cyclist

Accidents between dates 01/06/2017 and 31/05/2022 (60) months

Selection:

Selected using Pre-defined Query : ; Refined using Accidents within selected Polygons -HC - RPU Statistics Request ("A334 SHEDFIELD"); Refined using Accidents within selected Polygons -HC - RPU Statistics Request ("A334 SHEDFIELD")

Notes:

44180266811 15/07/2018 Time 1835 Vehicles 2 Casualties 1 Slight
 E:455754 N: 113072 First Road: A 334 Road Type Single carriageway
 Speed limit: 40 Junction Detail: T & Stag Jct Give way or controlled Unclassified
 Crossing: Control None Facilities: None within 50m Road surface Dry
 Daylight Fine without high winds
 Special Conditions at Site None Carriageway Hazards: None
 Place accident reported: At scene DfT Special Projects:

Causation

	Factor:	Participant:	Confidence:
1st:	Road layout (eg bend, hill crest)	Vehicle 2	Very Likely
2nd:	Failed to look properly	Vehicle 2	Very Likely
3rd:			
4th:			
5th:			
6th:			

VEH2 (CAR) TRAVELLING SW ON CHURCH ROAD TURNS RIGHT ONTO A334 BOTLEY ROAD INTO THE PATH OF VEH1 (CAR) TRAVELLING NW ON BOTLEY ROAD. VEH1 COLLIDES WITH VEH2 AND IS FORCED OFF THE ROAD NEARSIDE AND INTO A GARDEN FENCE.

Occurred on A334 BOTLEY ROAD AT JUNCTION WITH CHURCH ROAD, SHEDFIELD, HAMPSHIRE.

Vehicle Reference 1 Car Going ahead right bend
 Vehicle movement from SE to NW No tow / articulation Leaving the main road
 On main carriageway No skidding, jack-knifing or overturning
 Location at impact Mid Junction - on roundabout or r First impact Front Hit vehicle:
 Hit object in road None Off road: Wall or fence
 Nearside Age of Driver 32 Male
 Not hit and run Breath test Negative
 Left hand drive: No

Casualty Reference: 1 Vehicle: 1 Age: 32 Male Driver/rider Severity: Slight
 Not a pupil
 Seatbelt Not Applicable Cycle helmet: Not a cyclist

Vehicle Reference 2 Car Turning right
 Vehicle movement from NE to NW No tow / articulation Leaving the main road
 On main carriageway No skidding, jack-knifing or overturning
 Location at impact Mid Junction - on roundabout or r First impact Nearside Hit vehicle:
 Hit object in road None Off road: None
 Did not leave carr Age of Driver 46 Male
 Not hit and run Breath test Negative
 Left hand drive: No

Accidents between dates 01/06/2017 and 31/05/2022 (60) months

Selection: Notes:

Selected using Pre-defined Query : ; Refined using Accidents within selected Polygons -HC - RPU Statistics Request ("A334 SHEDFIELD"); Refined using Accidents within selected Polygons -HC - RPU Statistics Request ("A334 SHEDFIELD")

44190062613 21/02/2019 Time 0400 Vehicles 1 Casualties 1 Serious
 E:456367 N:112655 First Road: A 334 Road Type Single carriageway
 Speed limit: 40 Junction Detail: Not within 20m of junction
 Crossing: Control None Facilities: None within 50m Road surface Dry
 Darkness: no street lighting Fine without high winds
 Special Conditions at Site None Carriageway Hazards: None
 Place accident reported: At scene DfT Special Projects:

Causation

	Factor:	Participant:	Confidence:
1st:	Loss of control	Vehicle 1	Possible
2nd:			
3rd:			
4th:			
5th:			
6th:			

VEH1 (P/CYCLE) TRAVELLNG SE ALONG A334 WINCHESTER ROAD. FOR UNKNOWN REASONS, RIDER HAS FALLEN FROM BIKE AND WAS FOUND BY MEMBERS OF THE PUBLIC.

Occurred on A334 WINCHESTER ROAD, OUTISDE THE OAKS, SHEDFIELD, HAMPSHIRE.

Vehicle Reference 1 Pedal Cycle Going ahead other
 Vehicle movement from NW to SE No tow / articulation Leaving the main road
 On main carriageway No skidding, jack-knifing or overturning
 Location at impact Not at, or within 20M of Jct First impact Did not impact Hit vehicle:
 Hit object in road None Off road: None
 Did not leave carr Age of Driver 58 Male
 Not hit and run Breath test Not applicable
 Left hand drive: No

Casualty Reference: 1 Vehicle: 1 Age: 58 Male Driver/rider Severity: Serious
 Not a pupil
 Seatbelt Not Applicable Cycle helmet: No

Accidents between dates 01/06/2017 and 31/05/2022 (60) months

Selection:

Selected using Pre-defined Query : ; Refined using Accidents within selected Polygons -HC - RPU Statistics Request ("A334 SHEDFIELD"); Refined using Accidents within selected Polygons -HC - RPU Statistics Request ("A334 SHEDFIELD")

Notes:

44190114832 03/04/2019 Time 0725 Vehicles 2 Casualties 1 Slight
 E:456388 N:112609 First Road: A 334 Road Type Single carriageway
 Speed limit: 60 Junction Detail: Not within 20m of junction
 Crossing: Control None Facilities: None within 50m Road surface Wet/Damp
 Daylight Fine without high winds
 Special Conditions at Site None Carriageway Hazards: None
 Place accident reported: At scene DfT Special Projects:

Causation

	Factor:	Participant:	Confidence:
1st:	Failed to judge other persons path or speed	Vehicle 1	Possible
2nd:	Failed to look properly	Vehicle 1	Possible
3rd:			
4th:			
5th:			
6th:			

VEH1 (CAR) TRAVELLING NW ALONG A334 WINCHESTER ROAD FAILED TO REACT TO VEH2 (CAR) STOPPING AHEAD, AND COLLIDED WITH THE REAR.

Occurred on A334 WINCHESTER ROAD, OUTSIDE THE OAKS, SHEDFIELD, HAMPSHIRE.

Vehicle Reference 1 Car Going ahead other
 Vehicle movement from SE to NW No tow / articulation Leaving the main road
 On main carriageway Skidded
 Location at impact Not at, or within 20M of Jct First impact Front Hit vehicle:
 Hit object in road None Off road: None
 Did not leave carr Age of Driver 29 Female
 Not hit and run Breath test Negative
 Left hand drive: No

Vehicle Reference 2 Car Going ahead but held up
 Vehicle movement from SE to NW No tow / articulation Leaving the main road
 On main carriageway No skidding, jack-knifing or overturning
 Location at impact Not at, or within 20M of Jct First impact Back Hit vehicle:
 Hit object in road None Off road: None
 Did not leave carr Age of Driver 52 Female
 Not hit and run Breath test Negative
 Left hand drive: No

Casualty Reference: 1 Vehicle: 2 Age: 52 Female Driver/rider Severity: Slight
 Not a pupil
 Seatbelt Not Applicable Cycle helmet: Not a cyclist

Accidents between dates 01/06/2017 and 31/05/2022 (60) months

Selection:

Selected using Pre-defined Query : ; Refined using Accidents within selected Polygons -HC - RPU Statistics Request ("A334 SHEDFIELD"); Refined using Accidents within selected Polygons -HC - RPU Statistics Request ("A334 SHEDFIELD")

Notes:

44190162709 11/05/2019 Time 2255 Vehicles 1 Casualties 1 Slight
 E:456313 N:112753 First Road: A 334 Road Type Single carriageway
 Speed limit: 40 Junction Detail: T & Stag Jct Give way or controlled B 2177
 Crossing: Control None Facilities: None within 50m Road surface Dry
 Darkness: no street lighting Fine without high winds
 Special Conditions at Site None Carriageway Hazards: None
 Place accident reported: At scene DfT Special Projects:

Causation

	Factor:	Participant:	Confidence:
1st:	Impaired by alcohol	Vehicle 1	Possible
2nd:			
3rd:			
4th:			
5th:			
6th:			

VEH1 (CAR) TRAVELLING SE ALONG A334 COLLIDED WITH THE CENTRAL ISLAND BOLLARD AND FILLED ONTO ITS ROOF.

Occurred on A334 AT JUNCTION WITH B2177 WINCHESTER ROAD, SHEDFIELD, HAMPSHIRE.

Vehicle Reference 1 Car Going ahead other
 Vehicle movement from NW to SE No tow / articulation Leaving the main road
 On main carriageway No skidding, jack-knifing or overturning
 Location at impact Jct Approach First impact Front Hit vehicle:
 Hit object in road Kerb Off road: None
 Did not leave carr Age of Driver 34 Male
 Not hit and run Breath test Failed to provide
 Left hand drive: No

Casualty Reference: 1 Vehicle: 1 Age: 46 Female Passenger Severity: Slight
 Not a pupil
 Seatbelt Not Applicable Cycle helmet: Not a cyclist
 Front seat

Accidents between dates 01/06/2017 and 31/05/2022 (60) months

Selection:

Selected using Pre-defined Query : ; Refined using Accidents within selected Polygons -HC - RPU Statistics Request ("A334 SHEDFIELD"); Refined using Accidents within selected Polygons -HC - RPU Statistics Request ("A334 SHEDFIELD")

Notes:

44190423911 25/11/2019 Time 1435 Vehicles 2 Casualties 1 Slight
 E:456315 N:112753 First Road: A 334 Road Type Single carriageway
 Speed limit: 40 Junction Detail: T & Stag Jct Give way or controlled A 334
 Crossing: Control None Facilities: None within 50m Road surface Dry
 Daylight Fine without high winds
 Special Conditions at Site None Carriageway Hazards: None
 Place accident reported: Elsewhere DfT Special Projects:

Causation

Factor:	Participant:	Confidence:
1st:		
2nd:		
3rd:		
4th:		
5th:		
6th:		

VEH2 (CAR) TRAVELLING SE ALONG A334 FAILED TO SLOW IN TIME ON APPROACH TO JUNCTION AND COLLIDED WITH THE REAR OF VEH1 (CAR) TRAVELLING SE ALONG A334 IN FRONT, WAITING TO TURN RIGHT ONTO A334 WINCHESTER ROAD.

Occurred on A334 AT JUNCTION WITH A334 WINCHESTER ROAD, SHEDFIELD, HAMPSHIRE.

Vehicle Reference 1 Car Waiting to turn right
 Vehicle movement from NW to SE No tow / articulation Leaving the main road
 On main carriageway No skidding, jack-knifing or overturning
 Location at impact Jct Approach First impact Back Hit vehicle:
 Hit object in road None Off road: None
 Did not leave carr Age of Driver 34 Female
 Not hit and run Breath test Driver not contacted
 Left hand drive: No

Casualty Reference: 1 Vehicle: 1 Age: 34 Female Driver/rider Severity: Slight
 Not a pupil
 Seatbelt Not Applicable Cycle helmet: Not a cyclist

Vehicle Reference 2 Car Stopping
 Vehicle movement from NW to SE No tow / articulation Leaving the main road
 On main carriageway No skidding, jack-knifing or overturning
 Location at impact Jct Approach First impact Front Hit vehicle:
 Hit object in road None Off road: None
 Did not leave carr Age of Driver 46 Male
 Not hit and run Breath test Driver not contacted
 Left hand drive: No

Accidents between dates 01/06/2017 and 31/05/2022 (60) months

Selection:

Selected using Pre-defined Query : ; Refined using Accidents within selected Polygons -HC - RPU Statistics Request ("A334 SHEDFIELD"); Refined using Accidents within selected Polygons -HC - RPU Statistics Request ("A334 SHEDFIELD")

Notes:

44190440922 08/12/2019 Time 0255 Vehicles 1 Casualties 1 Slight
 E:456325 N:112740 First Road: A 334 Road Type Single carriageway
 Speed limit: 40 Junction Detail: T & Stag Jct Give way or controlled A 334
 Crossing: Control None Facilities: None within 50m Road surface Wet/Damp
 Darkness: no street lighting Raining without high winds
 Special Conditions at Site None Carriageway Hazards: None
 Place accident reported: At scene DfT Special Projects:

Causation

Factor:	Participant:	Confidence:
1st: Impaired by alcohol	Vehicle 1	Very Likely
2nd:		
3rd:		
4th:		
5th:		
6th:		

VEH1 (CAR) TRAVELLING N ALONG A334 WINCHESTER ROAD TURNS LEFT TO TRAVEL NW ALONG A334 CURDRIDGE ROAD BUT CLIPS THE NEARSIDE KERB CAUSING THE VEH TO OVERTURN.

Occurred on A334 WINCHESTER ROAD AT JUNCTION WITH A334 CURDRIDGE ROAD, SHEDFIELD, HAMPSHIRE

Vehicle Reference 1 Car Turning left
 Vehicle movement from S to NW No tow / articulation Leaving the main road
 On main carriageway Skidded
 Location at impact Mid Junction - on roundabout or r First impact Nearside Hit vehicle:
 Hit object in road Kerb Off road: None
 Did not leave carr Age of Driver 46 Male
 Not hit and run Breath test Positive
 Left hand drive: No

Casualty Reference: 1 Vehicle: 1 Age: 46 Male Driver/rider Severity: Slight
 Not a pupil
 Seatbelt Not Applicable Cycle helmet: Not a cyclist

Accidents between dates 01/06/2017 and 31/05/2022 (60) months

Selection:

Selected using Pre-defined Query : ; Refined using Accidents within selected Polygons -HC - RPU Statistics Request ("A334 SHEDFIELD"); Refined using Accidents within selected Polygons -HC - RPU Statistics Request ("A334 SHEDFIELD")

Notes:

44200027273 22/01/2020 Time 2055 Vehicles 1 Casualties 1 Slight
 E:456328 N: 112748 First Road: A 334 Road Type Single carriageway
 Speed limit: 40 Junction Detail: T & Stag Jct Give way or controlled A 334
 Crossing: Control None Facilities: None within 50m Road surface Wet/Damp
 Darkness: no street lighting Fine without high winds
 Special Conditions at Site None Carriageway Hazards: None
 Place accident reported: At scene DfT Special Projects:

Causation

	Factor:	Participant:	Confidence:
1st:	Junction overshoot	Vehicle 1	Very Likely
2nd:	Poor turn or manoevre	Vehicle 1	Very Likely
3rd:			
4th:			
5th:			
6th:			

VEH1 (CAR) TRAVELLING SE ALONG A334 SHEDFIELD ROAD TURNS RIGHT TO TRAVEL SE ALONG A334 WINCHESTER ROAD BUT MISJUDGES THE JUNCTION AND LEAVES THE CARRIAGEWAY NEARSIDE AND OVERTURNS INTO A DITCH.

Occurred on A334 WINCHESTER ROAD AT JUNCTION WITH A334 SHEDFIELD ROAD, SHEDFIELD, HAMPSHIRE

Vehicle Reference 1 Car Turning right
 Vehicle movement from NW to SE No tow / articulation Leaving the main road
 On main carriageway Overtaken
 Location at impact Mid Junction - on roundabout or r First impact Nearside Hit vehicle:
 Hit object in road None Off road: Entered ditch
 Nearside Age of Driver 18 Female
 Not hit and run Breath test Negative
 Left hand drive: No

Casualty Reference: 1 Vehicle: 1 Age: 18 Female Driver/rider Severity: Slight
 Not a pupil
 Seatbelt Not Applicable Cycle helmet: Not a cyclist

Accidents between dates 01/06/2017 and 31/05/2022 (60) months

Selection:

Selected using Pre-defined Query : ; Refined using Accidents within selected Polygons -HC - RPU Statistics Request ("A334 SHEDFIELD"); Refined using Accidents within selected Polygons -HC - RPU Statistics Request ("A334 SHEDFIELD")

Notes:

44200060802 17/02/2020 Time 1100 Vehicles 2 Casualties 1 Slight
 E:456323 N:112754 First Road: B 2177 Road Type Single carriageway
 Speed limit: 40 Junction Detail: T & Stag Jct Give way or controlled A 334
 Crossing: Control None Facilities: None within 50m Road surface Wet/Damp
 Daylight Fine without high winds
 Special Conditions at Site None Carriageway Hazards: None
 Place accident reported: At scene DfT Special Projects:

Causation

	Factor:	Participant:	Confidence:
1st:	Driver using mobile phone	Vehicle 1	Possible
2nd:	Failed to judge other persons path or speed	Vehicle 1	Possible
3rd:			
4th:			
5th:			
6th:			

VEH 1 (VAN) TRAVELLING S ALONG B2177 WINCHESTER ROAD FAILED TO BRAKE IN TIME AND COLLIDED WITH REAR OF VEH 2 (CAR) WAITING IN QUEUE OF TRAFFIC IN FRONT.

Occurred on B2177 WINCHESTER ROAD AT JUNCTION WITH A334 WINCHESTER ROAD, SHEDFIELD, HAMPSHIRE

Vehicle Reference 1 Van or Goods 3.5 tonnes mgw and under Going ahead other
 Vehicle movement from N to S No tow / articulation Leaving the main road
 On main carriageway No skidding, jack-knifing or overturning
 Location at impact Mid Junction - on roundabout or r First impact Front Hit vehicle:
 Hit object in road None Off road: None
 Did not leave carr Age of Driver 30 Male
 Not hit and run Breath test Not requested
 Left hand drive: No

Vehicle Reference 2 Car Going ahead but held up
 Vehicle movement from N to S No tow / articulation Leaving the main road
 On main carriageway No skidding, jack-knifing or overturning
 Location at impact Mid Junction - on roundabout or r First impact Back Hit vehicle:
 Hit object in road None Off road: None
 Did not leave carr Age of Driver 36 Female
 Not hit and run Breath test Negative
 Left hand drive: No

Casualty Reference: 1 Vehicle: 2 Age: 36 Female Driver/rider Severity: Slight
 Not a pupil
 Seatbelt Worn but not i Cycle helmet: Not a cyclist

Accidents between dates 01/06/2017 and 31/05/2022 (60) months

Selection:

Selected using Pre-defined Query : ; Refined using Accidents within selected Polygons -HC - RPU Statistics Request ("A334 SHEDFIELD"); Refined using Accidents within selected Polygons -HC - RPU Statistics Request ("A334 SHEDFIELD")

Notes:

44210002630 03/01/2021 Time 1726 Vehicles 3 Casualties 1 Slight
 E:455484 N: 113367 First Road: A 334 Road Type Single carriageway
 Speed limit: 50 Junction Detail: Not within 20m of junction
 Crossing: Control None Facilities: None within 50m Road surface Wet/Damp
 Darkness: no street lighting Fine without high winds
 Special Conditions at Site None Carriageway Hazards: None
 Place accident reported: At scene DfT Special Projects:

Causation

	Factor:	Participant:	Confidence:
1st:	Slippery road (due to weather)	Vehicle 3	Possible
2nd:	Travelling too fast for conditions	Vehicle 3	Possible
3rd:	Failed to judge other persons path or speed	Vehicle 3	Possible
4th:	Animal or object in carriageway	Vehicle 1	Possible
5th:			
6th:			

VEH 1 (CAR) TRAVELLING NW ALONG A334 BOTLEY ROAD COMES TO AN ABRUPT STOP DUE TO AN ANIMAL IN THE CARRIAGEWAY. VEH 2 (CAR) TRAVELLING NW ON A334 BEHIND, ALSO STOPS. VEH 3 (VAN) TRAVELLING NW BEHIND VEH 2 FAILS TO STOP IN TIME AND COLLIDES WITH VEH 2. VEH Occurred on A334 BOTLEY ROAD, OUTSIDE 1 AYLINGS, SHEDFIELD, HAMPSHIRE.

Vehicle Reference 1 Car Going ahead other
 Vehicle movement from SE to NW No tow / articulation Leaving the main road
 On main carriageway No skidding, jack-knifing or overturning
 Location at impact Not at, or within 20M of Jct First impact Did not impact Hit vehicle:
 Hit object in road None Off road: None
 Did not leave carr Age of Driver Not traced
 Not hit and run Breath test Not requested
 Left hand drive: No

Vehicle Reference 2 Car Going ahead other
 Vehicle movement from SE to NW No tow / articulation Leaving the main road
 On main carriageway No skidding, jack-knifing or overturning
 Location at impact Not at, or within 20M of Jct First impact Back Hit vehicle:
 Hit object in road None Off road: None
 Did not leave carr Age of Driver 42 Female
 Not hit and run Breath test Not requested
 Left hand drive: No

Accidents between dates 01/06/2017 and 31/05/2022 (60) months

Selection: Notes:

Selected using Pre-defined Query : ; Refined using Accidents
within selected Polygons -HC - RPU Statistics Request ("A334
SHEDFIELD"); Refined using Accidents within selected
Polygons -HC - RPU Statistics Request ("A334 SHEDFIELD")

Vehicle Reference 3 Van or Goods 3.5 tonnes mgw and under Going ahead other
Vehicle movement from SE to NW No tow / articulation Leaving the main road
On main carriageway No skidding, jack-knifing or overturning
Location at impact Not at, or within 20M of Jct First impact Front Hit vehicle:
Hit object in road None Off road: None
Did not leave carr Age of Driver 27 Male
Not hit and run Breath test Negative
Left hand drive: No

Casualty Reference: 1 Vehicle: 3 Age: 27 Male Driver/rider Severity: Slight
Not a pupil
Seatbelt Not Applicable Cycle helmet: Not a cyclist

Accidents between dates 01/06/2017 and 31/05/2022 (60) months

Selection:

Selected using Pre-defined Query : ; Refined using Accidents within selected Polygons -HC - RPU Statistics Request ("A334 SHEDFIELD"); Refined using Accidents within selected Polygons -HC - RPU Statistics Request ("A334 SHEDFIELD")

Notes:

44210107521 22/03/2021 Time 1504 Vehicles 2 Casualties 2 Slight
 E:456320 N:112751 First Road: B 2177 Road Type Single carriageway
 Speed limit: 40 Junction Detail: T & Stag Jct Give way or controlled A 334
 Crossing: Control None Facilities: None within 50m Road surface Dry
 Daylight Fine without high winds
 Special Conditions at Site None Carriageway Hazards: None
 Place accident reported: At scene DfT Special Projects:

Causation

	Factor:	Participant:	Confidence:
1st:	Disobeyed Give Way or Stop sign or markings	Vehicle 1	Very Likely
2nd:	Failed to judge other persons path or speed	Vehicle 1	Very Likely
3rd:	Failed to look properly	Vehicle 1	Possible
4th:	Exceeding speed limit	Vehicle 2	Possible
5th:			
6th:			

VEH 1 (CAR) TRAVELLING SE ALONG A334 FAILS TO GIVE WAY / SEE VEH 2 (VAN) TRAVELLING NW ALONG B2177 AND COLLIDES AS EMERGES FROM JUNCTION.

Occurred on A334 AT JUNCTION WITH B2177 WINCHESTER ROAD, SHEDFIELD, HAMPSHIRE

Vehicle Reference 1 Car Turning right
 Vehicle movement from NW to SE No tow / articulation Leaving the main road
 On main carriageway Skidded
 Location at impact Mid Junction - on roundabout or r First impact Offside Hit vehicle:
 Hit object in road None Off road: None
 Did not leave carr Age of Driver 56 Female
 Not hit and run Breath test Negative
 Left hand drive: No

Vehicle Reference 2 Van or Goods 3.5 tonnes mgw and under Going ahead other
 Vehicle movement from SE to N Single trailer Leaving the main road
 On main carriageway No skidding, jack-knifing or overturning
 Location at impact Mid Junction - on roundabout or r First impact Front Hit vehicle:
 Hit object in road None Off road: None
 Did not leave carr Age of Driver 52 Male
 Not hit and run Breath test Negative
 Left hand drive: No

Casualty Reference: 1 Vehicle: 2 Age: 52 Male Driver/rider Severity: Slight
 Not a pupil
 Seatbelt Not Applicable Cycle helmet: Not a cyclist

Casualty Reference: 2 Vehicle: 2 Age: 22 Male Passenger Severity: Slight
 Not a pupil
 Seatbelt Not Applicable Cycle helmet: Not a cyclist

Not car passenger

Accidents between dates 01/06/2017 and 31/05/2022 (60) months

Selection:

Selected using Pre-defined Query : ; Refined using Accidents within selected Polygons -HC - RPU Statistics Request ("A334 SHEDFIELD"); Refined using Accidents within selected Polygons -HC - RPU Statistics Request ("A334 SHEDFIELD")

Notes:

44210127424 05/04/2021 Time 1055 Vehicles 2 Casualties 1 Slight
 E:455691 N:113138 First Road: A 334 Road Type Single carriageway
 Speed limit: 60 Junction Detail: Pri Drive Give way or controlled Unclassified
 Crossing: Control None Facilities: None within 50m Road surface Dry
 Daylight Fine without high winds
 Special Conditions at Site None Carriageway Hazards: None
 Place accident reported: At scene DfT Special Projects:

Causation

	Factor:	Participant:	Confidence:
1st:	Defective brakes	Vehicle 1	Possible
2nd:	Failed to look properly	Vehicle 1	Possible
3rd:	Failed to judge other persons path or speed	Vehicle 1	
4th:			
5th:			
6th:			

VEH1 (CAR) TRAVELLING NW ALONG A334 BOTLEY ROAD COLLIDED WITH THE REAR OF VEH2 (CAR) TRAVELLING NW IN FRONT AND SLOWING TO TURN LEFT INTO SHEDFIELD EQUESTRIAN CENTRE. Occurred on A334 BOTLEY ROAD AT JUNCTION WITH SHEDFIELD EQUESTRIAN CENTRE, SHEDFIELD, HAMPSHIRE.

Vehicle Reference 1 Car Going ahead other
 Vehicle movement from SE to NW No tow / articulation Leaving the main road
 On main carriageway No skidding, jack-knifing or overturning
 Location at impact Jct Approach First impact Front Hit vehicle:
 Hit object in road None Off road: None
 Did not leave carr Age of Driver 62 Male
 Not hit and run Breath test Not requested
 Left hand drive: No

Vehicle Reference 2 Car Stopping
 Vehicle movement from SE to SW No tow / articulation Leaving the main road
 On main carriageway No skidding, jack-knifing or overturning
 Location at impact Jct Approach First impact Back Hit vehicle:
 Hit object in road None Off road: Wall or fence
 Nearside Age of Driver 23 Female
 Not hit and run Breath test Not requested
 Left hand drive: No

Casualty Reference: 1 Vehicle: 2 Age: 23 Female Driver/rider Severity: Slight
 Not a pupil
 Seatbelt Not worn Cycle helmet: Not a cyclist

Accidents between dates 01/06/2017 and 31/05/2022 (60) months

Selection:

Selected using Pre-defined Query : ; Refined using Accidents within selected Polygons -HC - RPU Statistics Request ("A334 SHEDFIELD"); Refined using Accidents within selected Polygons -HC - RPU Statistics Request ("A334 SHEDFIELD")

Notes:

44210271848 10/07/2021 Time 1220 Vehicles 3 Casualties 1 Slight
 E:456270 N:112776 First Road: A 334 Road Type Single carriageway
 Speed limit: 40 Junction Detail: Not within 20m of junction
 Crossing: Control None Facilities: None within 50m Road surface Wet/Damp
 Daylight Fine without high winds
 Special Conditions at Site None Carriageway Hazards: None
 Place accident reported: At scene DfT Special Projects:

Causation

	Factor:	Participant:	Confidence:
1st:	Slippery road (due to weather)	Vehicle 1	Possible
2nd:	Poor turn or manoeuvre	Vehicle 1	Possible
3rd:			
4th:			
5th:			
6th:			

VEH 1 (CAR) TRAVELLING SE ALONG A334 HAS FAILED TO NOTICE STATIONARY TRAFFIC AHEAD AND COLLIDED WITH THE REAR OF VEH 2 (CAR) TRAVELLING SE ALONG A334, SHUNTING THEM INTO THE BACK OF VEH 3 (CAR) TRAVELLING SE ALONG A334.

Occurred on A334 BOTLEY ROAD, OUTSIDE THE ENTRANCE TO ANIMED VETERINARY HOSPITAL, SHEDFIELD, HAMPSHIRE.

Vehicle Reference 1 Car Stopping
 Vehicle movement from NW to SE No tow / articulation Leaving the main road
 On main carriageway Skidded
 Location at impact Not at, or within 20M of Jct First impact Front Hit vehicle:
 Hit object in road None Off road: None
 Did not leave carr Age of Driver 31 Female
 Not hit and run Breath test Negative
 Left hand drive: No

Vehicle Reference 2 Car Going ahead but held up
 Vehicle movement from NW to E No tow / articulation Leaving the main road
 On main carriageway No skidding, jack-knifing or overturning
 Location at impact Not at, or within 20M of Jct First impact Back Hit vehicle:
 Hit object in road None Off road: None
 Did not leave carr Age of Driver 23 Female
 Not hit and run Breath test Negative
 Left hand drive: No

Casualty Reference: 1 Vehicle: 2 Age: 23 Female Driver/rider Severity: Slight
 Not a pupil
 Seatbelt Not Applicable Cycle helmet: Not a cyclist

Accidents between dates 01/06/2017 and 31/05/2022 (60) months

Selection: Notes:

Selected using Pre-defined Query : ; Refined using Accidents within selected Polygons -HC - RPU Statistics Request ("A334 SHEDFIELD"); Refined using Accidents within selected Polygons -HC - RPU Statistics Request ("A334 SHEDFIELD")

Vehicle Reference	3	Car	Going ahead but held up
Vehicle movement from	NW to SE	No tow / articulation	Leaving the main road
On main carriageway		No skidding, jack-knifing or overturning	
Location at impact	Not at, or within 20M of Jct	First impact	Back
Hit object in road	None	Off road:	None
Did not leave carr		Age of Driver	37
Not hit and run	Breath test	Negative	Male
		Left hand drive:	No

Accidents between dates 01/06/2017 and 31/05/2022 (60) months

Selection:

Selected using Pre-defined Query : ; Refined using Accidents within selected Polygons -HC - RPU Statistics Request ("A334 SHEDFIELD"); Refined using Accidents within selected Polygons -HC - RPU Statistics Request ("A334 SHEDFIELD")

Notes:

44210307208 02/08/2021 Time 2329 Vehicles 2 Casualties 2 Slight
 E:456323 N:112752 First Road: A 334 Road Type Single carriageway
 Speed limit: 40 Junction Detail: T & Stag Jct Give way or controlled B 2177
 Crossing: Control None Facilities: None within 50m Road surface Dry
 Darkness: no street lighting Fine without high winds
 Special Conditions at Site None Carriageway Hazards: None
 Place accident reported: At scene DfT Special Projects:

Causation

	Factor:	Participant:	Confidence:
1st:	Junction overshoot	Vehicle 001	Very Likely
2nd:	Careless/Reckless/In a hurry	Vehicle 001	Very Likely
3rd:			
4th:			
5th:			
6th:			

VEH 1 (CAR) TRAVELLING NW ON BOTLEY ROAD A334 APPROACHING JUNCTION WITH WINCHESTER ROAD B2177 FAILS TO GIVE WAY AND COLLIDES WITH VEH 2 (VAN) TRAVELLING S ON WINCHESTER ROAD

Occurred on BOTLEY ROAD A334 JUNCTION WITH WINCHESTER ROAD B2177 SHEDFIELD

Vehicle Reference 1 Car Turning right
 Vehicle movement from NW to SE No tow / articulation Leaving the main road
 On main carriageway No skidding, jack-knifing or overturning
 Location at impact Mid Junction - on roundabout or r First impact Front Hit vehicle:
 Hit object in road None Off road: None
 Did not leave carr Age of Driver 42 Male
 Not hit and run Breath test Negative
 Left hand drive: No

Casualty Reference: 2 Vehicle: 1 Age: 42 Male Driver/rider Severity: Slight
 Not a pupil
 Seatbelt Worn but not i Cycle helmet: Not a cyclist

Vehicle Reference 2 Van or Goods 3.5 tonnes mgw and under Going ahead other
 Vehicle movement from N to S No tow / articulation Leaving the main road
 On main carriageway No skidding, jack-knifing or overturning
 Location at impact Mid Junction - on roundabout or r First impact Offside Hit vehicle:
 Hit object in road None Off road: Road sign / ATS
 Nearside Age of Driver 35 Male
 Not hit and run Breath test Not requested
 Left hand drive: No

Casualty Reference: 1 Vehicle: 2 Age: 35 Male Driver/rider Severity: Slight
 Not a pupil
 Seatbelt Worn but not i Cycle helmet: Not a cyclist

Accidents between dates 01/06/2017 and 31/05/2022 (60) months

Selection:

Selected using Pre-defined Query : ; Refined using Accidents within selected Polygons -HC - RPU Statistics Request ("A334 SHEDFIELD"); Refined using Accidents within selected Polygons -HC - RPU Statistics Request ("A334 SHEDFIELD")

Notes:

44210371490 15/09/2021 Time 2058 Vehicles 2 Casualties 1 Serious
 E:456325 N:112747 First Road: B 2177 Road Type Single carriageway
 Speed limit: 40 Junction Detail: T & Stag Jct Give way or controlled A 334
 Crossing: Control None Facilities: None within 50m Road surface Wet/Damp
 Darkness: no street lighting Fine without high winds
 Special Conditions at Site None Carriageway Hazards: None
 Place accident reported: At scene DfT Special Projects:

Causation

	Factor:	Participant:	Confidence:
1st:	Impaired by alcohol	Vehicle 001	Possible
2nd:	Impaired by drugs (illicit or medicinal)	Vehicle 001	Possible
3rd:			
4th:			
5th:			
6th:			

VEH 1 (CAR) TRAVELLING NW TO SE ON BOTLEY ROAD FAILS TO GIVE WAY AND COLLIDES WITH VEH 2 (CAR) TRAVELLING S TO N ON WINCHESTER ROAD
 Occurred on JUNCTION OF BOTLEY ROAD AND WINCHESTER ROAD SHEDFIELD

Vehicle Reference 1 Car Going ahead other
 Vehicle movement from NW to SE No tow / articulation Leaving the main road
 On main carriageway No skidding, jack-knifing or overturning
 Location at impact Jct Approach First impact Front Hit vehicle:
 Hit object in road None Off road: None
 Nearside Age of Driver 28 Male
 Not hit and run Breath test Positive
 Left hand drive: No

Vehicle Reference 2 Car Going ahead other
 Vehicle movement from S to N No tow / articulation Leaving the main road
 On main carriageway No skidding, jack-knifing or overturning
 Location at impact Jct Approach First impact Front Hit vehicle:
 Hit object in road None Off road: None
 Did not leave carr Age of Driver 60 Male
 Not hit and run Breath test Negative
 Left hand drive: No

Casualty Reference: 1 Vehicle: 2 Age: 86 Female Passenger Severity: Serious
 Not a pupil
 Seatbelt Not Applicable Cycle helmet: Not a cyclist
 Front seat

Accidents between dates 01/06/2017 and 31/05/2022 (60) months

Selection:

Selected using Pre-defined Query : ; Refined using Accidents within selected Polygons -HC - RPU Statistics Request ("A334 SHEDFIELD"); Refined using Accidents within selected Polygons -HC - RPU Statistics Request ("A334 SHEDFIELD")

Notes:

44210381440 21/09/2021 Time 1510 Vehicles 2 Casualties 1 Slight
 E:456409 N:112566 First Road: A 334 Road Type Single carriageway
 Speed limit: 30 Junction Detail: Pri Drive Give way or controlled Unclassified
 Crossing: Control None Facilities: None within 50m Road surface Dry
 Daylight Fine without high winds
 Special Conditions at Site None Carriageway Hazards: None
 Place accident reported: Elsewhere DfT Special Projects:

Causation

	Factor:	Participant:	Confidence:
1st:	Failed to look properly	Vehicle 2	Very Likely
2nd:			
3rd:			
4th:			
5th:			
6th:			

VEH 1 (CAR) TRAVELLING N ALONG A334 WINCHESTER ROAD WHEN VEH 2 (CAR) TURNED RIGHT OUT OF MCCARTHY'S FARM SHOP TO HEAD N AND COLLIDED WITH VEH 1.

Occurred on A334 WINCHESTER ROAD OUTSIDE MCCARTHY'S FARM SHOP, WINCHESTER

Vehicle Reference 1 Car Going ahead other
 Vehicle movement from S to N No tow / articulation Leaving the main road
 On main carriageway No skidding, jack-knifing or overturning
 Location at impact Jct Approach First impact Offside Hit vehicle:
 Hit object in road None Off road: None
 Did not leave carr Age of Driver 63 Male
 Not hit and run Breath test Driver not contacted
 Left hand drive: No

Casualty Reference: 1 Vehicle: 1 Age: 63 Male Driver/rider Severity: Slight
 Not a pupil
 Seatbelt Not Applicable Cycle helmet: Not a cyclist

Vehicle Reference 2 Car Going ahead other
 Vehicle movement from E to N No tow / articulation Leaving the main road
 On main carriageway No skidding, jack-knifing or overturning
 Location at impact Entering main road First impact Front Hit vehicle:
 Hit object in road None Off road: None
 Did not leave carr Age of Driver 23 Female
 Not hit and run Breath test Driver not contacted
 Left hand drive: No

Accidents between dates 01/06/2017 and 31/05/2022 (60) months

Selection:

Selected using Pre-defined Query : ; Refined using Accidents within selected Polygons -HC - RPU Statistics Request ("A334 SHEDFIELD"); Refined using Accidents within selected Polygons -HC - RPU Statistics Request ("A334 SHEDFIELD")

Notes:

44210487718 05/12/2021 Time 1240 Vehicles 3 Casualties 1 Slight
 E:456391 N: 112609 First Road: A 334 Road Type Single carriageway
 Speed limit: 40 Junction Detail: Pri Drive Give way or controlled Unclassified
 Crossing: Control None Facilities: None within 50m Road surface Wet/Damp
 Daylight Fine without high winds
 Special Conditions at Site None Carriageway Hazards: None
 Place accident reported: At scene DfT Special Projects:

Causation

	Factor:	Participant:	Confidence:
1st:	Vehicle in course of crime	Vehicle 1	Very Likely
2nd:	Aggressive driving	Vehicle 1	Very Likely
3rd:			
4th:			
5th:			
6th:			

VEH1 (CAR) TRAVELLING N ALONG A334 WINCHESTER ROAD, TRYING TO EVADE POLICE, GOES TO OVERTAKE VEH2 (CAR) TRAVELLING N IN FRONT, AT THE SAME TIME AS VEH2 TURNS RIGHT INTO MCCARTHYS FRUIT AND VEG. VEH1 HAS THEN COLLIDED WITH VEH3 (CAR) TRAV S ALONG THE A334
 Occurred on A334 WINCHESTER ROAD AT JUNCTION WITH MCCARTHYS FRUIT AND VEGETABLES, WICKHAM, HAMPSHIRE.

Vehicle Reference 1 Car Overtaking moving vehicle O/S
 Vehicle movement from S to N No tow / articulation Leaving the main road
 On main carriageway No skidding, jack-knifing or overturning
 Location at impact Mid Junction - on roundabout or r First impact Front Hit vehicle:
 Hit object in road None Off road: None
 Did not leave carr Age of Driver 21 Male
 Not hit and run Breath test Negative
 Left hand drive: No

Casualty Reference: 1 Vehicle: 1 Age: 21 Male Driver/rider Severity: Slight
 Not a pupil
 Seatbelt Not Applicable Cycle helmet: Not a cyclist

Vehicle Reference 2 Car Turning right
 Vehicle movement from S to E No tow / articulation Leaving the main road
 On main carriageway No skidding, jack-knifing or overturning
 Location at impact Mid Junction - on roundabout or r First impact Offside Hit vehicle:
 Hit object in road None Off road: None
 Did not leave carr Age of Driver 53 Female
 Not hit and run Breath test Negative
 Left hand drive: No

Accidents between dates 01/06/2017 and 31/05/2022 (60) months

Selection:

Selected using Pre-defined Query : ; Refined using Accidents within selected Polygons -HC - RPU Statistics Request ("A334 SHEDFIELD"); Refined using Accidents within selected Polygons -HC - RPU Statistics Request ("A334 SHEDFIELD")

Notes:

Vehicle Reference 3 Car Going ahead other
 Vehicle movement from N to S No tow / articulation Leaving the main road
 On main carriageway No skidding, jack-knifing or overturning
 Location at impact Mid Junction - on roundabout or r First impact Front Hit vehicle:
 Hit object in road None Off road: None
 Did not leave carr Age of Driver 40 Female
 Not hit and run Breath test Negative
 Left hand drive: No

44220069127 18/02/2022 Time 1812 Vehicles 1 Casualties 1 Slight
 E:454987 N: 113514 First Road: A 334 Road Type Single carriageway
 Speed limit: 50 Junction Detail: Not within 20m of junction
 Crossing: Control None Facilities: None within 50m Road surface Wet/Damp
 Darkness: no street lighting Fine with high winds
 Special Conditions at Site None Carriageway Hazards: None
 Place accident reported: At scene DfT Special Projects:

Causation

Factor:	Participant:	Confidence:
1st: Animal or object in carriageway	Vehicle 001	Very Likely
2nd: Road layout (eg bend, hill etc.)	Vehicle 001	Very Likely
3rd: Vegetation	Vehicle 001	Very Likely
4th: Not displaying lights at night or in poor visibility	Vehicle 001	Very Likely
5th:		
6th:		

VEH 1 (CAR) TRAVELLING W ALONG BOTLEY ROAD A334 ROUNDS A BEND AND COLLIDES WITH FALLEN TREE DUE TO RECENT STORM

Occurred on BOTLEY ROAD A334, APPROX 320 METERS W FROM SANDY LANE, CURDRIGE, HAMPSHIRE

Vehicle Reference 1 Car Going ahead left bend
 Vehicle movement from E to W No tow / articulation Leaving the main road
 On main carriageway No skidding, jack-knifing or overturning
 Location at impact Not at, or within 20M of Jct First impact Front Hit vehicle:
 Hit object in road None Off road: None
 Did not leave carr Age of Driver 71 Male
 Not hit and run Breath test Not requested
 Left hand drive: No

Casualty Reference: 1 Vehicle: 1 Age: 71 Male Driver/rider Severity: Slight
 Not a pupil
 Seatbelt Not Applicable Cycle helmet: Not a cyclist

Accidents between dates 01/06/2017 and 31/05/2022 (60) months

Selection:

Selected using Pre-defined Query : ; Refined using Accidents within selected Polygons -HC - RPU Statistics Request ("A334 SHEDFIELD"); Refined using Accidents within selected Polygons -HC - RPU Statistics Request ("A334 SHEDFIELD")

Notes:

44220082907 01/03/2022 Time 0045 Vehicles 1 Casualties 2 Serious
 E:447786 N:116784 First Road: U Road Type Single carriageway
 Speed limit: 40 Junction Detail: Not within 20m of junction
 Crossing: Control None Facilities: None within 50m Road surface Wet/Damp
 Darkness: no street lighting Raining without high winds
 Special Conditions at Site None Carriageway Hazards: None
 Place accident reported: At scene DfT Special Projects:

Causation

	Factor:	Participant:	Confidence:
1st:	Deposit on road (eg oil, mud, chippings)	Vehicle 001	Possible
2nd:	Slippery road (due to weather)	Vehicle 001	Possible
3rd:			
4th:			
5th:			
6th:			

VEH 1 (CAR) TRAVELLING NE ALONG ALLINGTON LANE LOSES CONTROL ON WET ROAD SURFACE, LEAVES CARRIAGEWAY AND COLLIDES WITH A TREE

Occurred on 45 METRES NE OF RAILWAY BRIDGE, ALLINGTON LANE, WEST END

Vehicle Reference 1 Car Going ahead left bend
 Vehicle movement from SW to NE No tow / articulation Leaving the main road
 On main carriageway No skidding, jack-knifing or overturning
 Location at impact Not at, or within 20M of Jct First impact Front Hit vehicle:
 Hit object in road None Off road: Tree
 Nearside Age of Driver 19 Male
 Not hit and run Breath test Negative
 Left hand drive: No

Casualty Reference: 1 Vehicle: 1 Age: 19 Male Driver/rider Severity: Slight
 Not a pupil
 Seatbelt Not Applicable Cycle helmet: Not a cyclist

Casualty Reference: 2 Vehicle: 1 Age: 18 Female Passenger Severity: Serious
 Not a pupil
 Seatbelt Not Applicable Cycle helmet: Not a cyclist

Front seat

Accidents between dates 01/06/2017 and 31/05/2022 (60) months

Selection:

Selected using Pre-defined Query : ; Refined using Accidents within selected Polygons -HC - RPU Statistics Request ("A334 SHEDFIELD"); Refined using Accidents within selected Polygons -HC - RPU Statistics Request ("A334 SHEDFIELD")

Notes:

44220087746 03/03/2022 Time 2110 Vehicles 2 Casualties 1 Slight
 E:456327 N:112748 First Road: B 2177 Road Type Single carriageway
 Speed limit: 40 Junction Detail: T & Stag Jct Give way or controlled A 334
 Crossing: Control None Facilities: None within 50m Road surface Dry
 Darkness: no street lighting Fine without high winds
 Special Conditions at Site Road works Carriageway Hazards: None
 Place accident reported: Elsewhere DfT Special Projects:

Causation

Factor:	Participant:	Confidence:
1st:		
2nd:		
3rd:		
4th:		
5th:		
6th:		

VEH 1 (CAR) TRAVELLING SE ALONG THE A334 TURNED RIGHT ONTO A334 WINCHESTER ROAD AND HAD TO STOP DUE TO A ROAD CLOSURE. VEH2 (VAN) TRAVELLING SE ALONG THE A334 ALSO TURNED RIGHT ONTO THE A334 WINCHESTER ROAD AND COLLIDED WITH THE REAR OF VEH1.

Occurred on JUNCTION OF B2177/A334 ROADWORKS OUTSIDE ASHLEY MANOR REST HOME, SHEDFIELD

Vehicle Reference 1 Car Reversing
 Vehicle movement from NW to SE No tow / articulation Leaving the main road
 On main carriageway No skidding, jack-knifing or overturning
 Location at impact Cleared junction or waiting/park First impact Back Hit vehicle:
 Hit object in road None Off road: None
 Did not leave carr Age of Driver 53 Male
 Not hit and run Breath test Driver not contacted
 Left hand drive: No

Casualty Reference: 1 Vehicle: 1 Age: 53 Male Driver/rider Severity: Slight
 Not a pupil
 Seatbelt Not Applicable Cycle helmet: Not a cyclist

Vehicle Reference 2 Van or Goods 3.5 tonnes mgw and under Going ahead other
 Vehicle movement from NW to SE No tow / articulation Leaving the main road
 On main carriageway No skidding, jack-knifing or overturning
 Location at impact Cleared junction or waiting/park First impact Front Hit vehicle:
 Hit object in road Road Works Off road: None
 Did not leave carr Age of Driver Male
 Hit and run Breath test Driver not contacted
 Left hand drive: No

Accidents between dates 01/06/2017 and 31/05/2022 (60) months

Selection:

Selected using Pre-defined Query : ; Refined using Accidents within selected Polygons -HC - RPU Statistics Request ("A334 SHEDFIELD"); Refined using Accidents within selected Polygons -HC - RPU Statistics Request ("A334 SHEDFIELD")

Notes:

44220096040 10/03/2022 Time 0512 Vehicles 1 Casualties 1 Serious
 E:456320 N:112748 First Road: A 334 Road Type Single carriageway
 Speed limit: 40 Junction Detail: T & Stag Jct Give way or controlled B 2177
 Crossing: Control None Facilities: None within 50m Road surface Wet/Damp
 Darkness: no street lighting Fine without high winds
 Special Conditions at Site Road works Carriageway Hazards: None
 Place accident reported: At scene DfT Special Projects:

Causation

	Factor:	Participant:	Confidence:
1st:	Fatigue	Vehicle 001	Possible
2nd:	Illness or disability, mental or physical	Vehicle 001	Possible
3rd:			
4th:			
5th:			
6th:			

VEH 1 (VAN) TRAVELLING NW ALONG A334 LOSES CONTROL AND COLLIDES WITH CENTRAL REFUGE/BOLLARD THEN COLLIDES WITH TREE

Occurred on JUNCTION OF A334/B2177 OPPOSITE ASHLEY MANOR, SHEDFIELD

Vehicle Reference 1 Car Turning left
 Vehicle movement from SE to NW No tow / articulation Leaving the main road
 On main carriageway No skidding, jack-knifing or overturning
 Location at impact Mid Junction - on roundabout or r First impact Front Hit vehicle:
 Hit object in road Bollard / Refuge Off road: Tree
 Straight ahead at Jun Age of Driver 59 Male
 Not hit and run Breath test Not requested
 Left hand drive: No

Casualty Reference: 1 Vehicle: 1 Age: 59 Male Driver/rider Severity: Serious
 Not a pupil
 Seatbelt Not Applicable Cycle helmet: Not a cyclist

Accidents between dates 01/06/2017 and 31/05/2022 (60) months

Selection:

Selected using Pre-defined Query : ; Refined using Accidents within selected Polygons -HC - RPU Statistics Request ("A334 SHEDFIELD"); Refined using Accidents within selected Polygons -HC - RPU Statistics Request ("A334 SHEDFIELD")

Notes:

44220124518 29/03/2022 Time 2220 Vehicles 2 Casualties 1 Slight
 E:456324 N:112752 First Road: A 334 Road Type Single carriageway
 Speed limit: 40 Junction Detail: T & Stag Jct Give way or controlled B 2177
 Crossing: Control None Facilities: None within 50m Road surface Dry
 Darkness: no street lighting Fine without high winds
 Special Conditions at Site None Carriageway Hazards: None
 Place accident reported: At scene DfT Special Projects:

Causation

	Factor:	Participant:	Confidence:
1st:	Junction overshoot	Vehicle 1	Very Likely
2nd:	Impaired by alcohol	Vehicle 1	Very Likely
3rd:			
4th:			
5th:			
6th:			

VEH1 (CAR) TRAVELLING SE ALONG A334 FAILED TO GIVE WAY AT JUNCTION AND COLLIDED WITH VEH2 (VAN) TRAVELLING S ALONG B2177.

Occurred on A334 AT JUNCTION WITH B2177, SHEDFIELD, HAMPSHIRE.

Vehicle Reference 1 Car Going ahead other
 Vehicle movement from NW to SE No tow / articulation Leaving the main road
 On main carriageway No skidding, jack-knifing or overturning
 Location at impact Mid Junction - on roundabout or r First impact Front Hit vehicle:
 Hit object in road None Off road: None
 Did not leave carr Age of Driver 36 Female
 Not hit and run Breath test Negative
 Left hand drive: No

Casualty Reference: 1 Vehicle: 1 Age: 36 Female Driver/rider Severity: Slight
 Not a pupil
 Seatbelt Not Applicable Cycle helmet: Not a cyclist

Vehicle Reference 2 Van or Goods 3.5 tonnes mgw and under Going ahead other
 Vehicle movement from N to S No tow / articulation Leaving the main road
 On main carriageway No skidding, jack-knifing or overturning
 Location at impact Mid Junction - on roundabout or r First impact Offside Hit vehicle:
 Hit object in road None Off road: None
 Did not leave carr Age of Driver 40 Male
 Not hit and run Breath test Negative
 Left hand drive: No

Accidents between dates **01/06/2017** and **31/05/2022** (60) months

Selection:

Selected using Pre-defined Query : ; Refined using Accidents within selected Polygons -HC - RPU Statistics Request ("A334 SHEDFIELD"); Refined using Accidents within selected Polygons -HC - RPU Statistics Request ("A334 SHEDFIELD")

Notes:

Accidents involving:

	Fatal	Serious	Slight	Total
Motor vehicles only (excluding 2-wheels)	0	4	21	25
2-wheeled motor vehicles	0	0	0	0
Pedal cycles	0	1	0	1
Horses & other	0	0	0	0
Total	0	5	21	26

Casualties:

	Fatal	Serious	Slight	Total
Vehicle driver	0	2	25	27
Passenger	0	2	2	4
Motorcycle rider	0	0	0	0
Cyclist	0	1	0	1
Pedestrian	0	0	0	0
Other	0	0	0	0
Total	0	5	27	32

Appendix 2

Access and Visibility

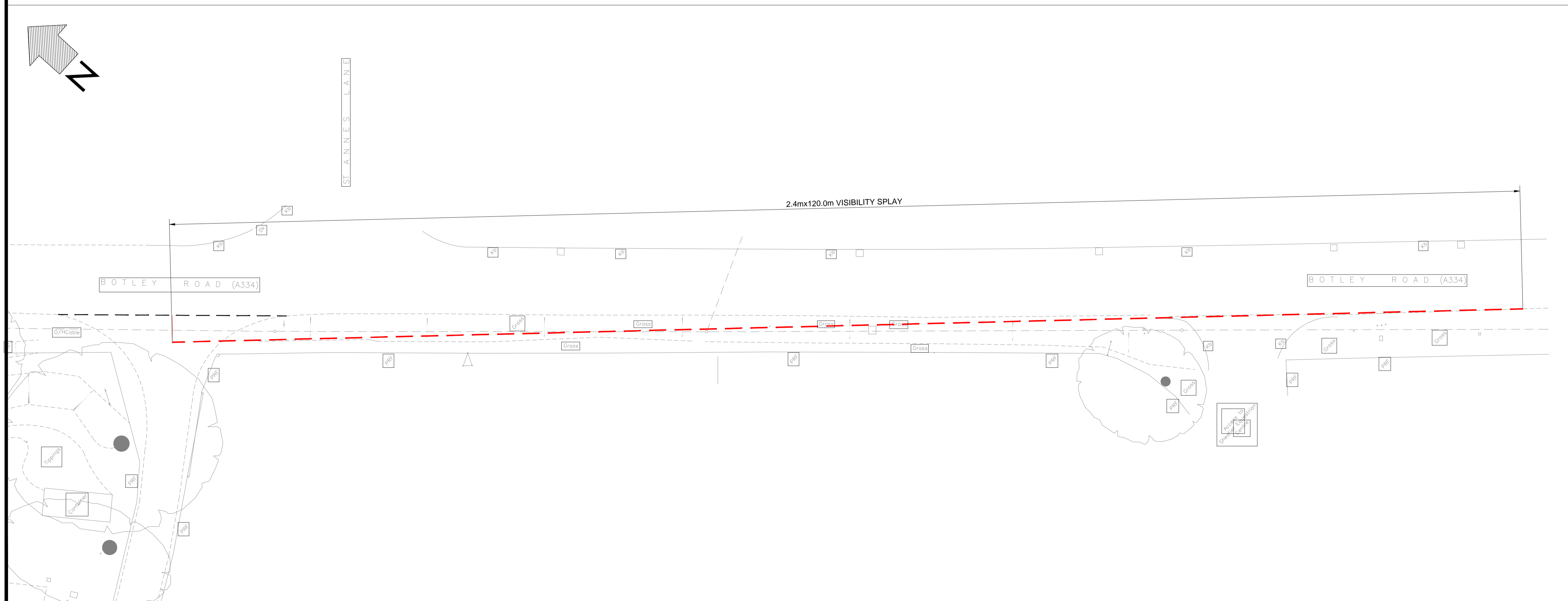
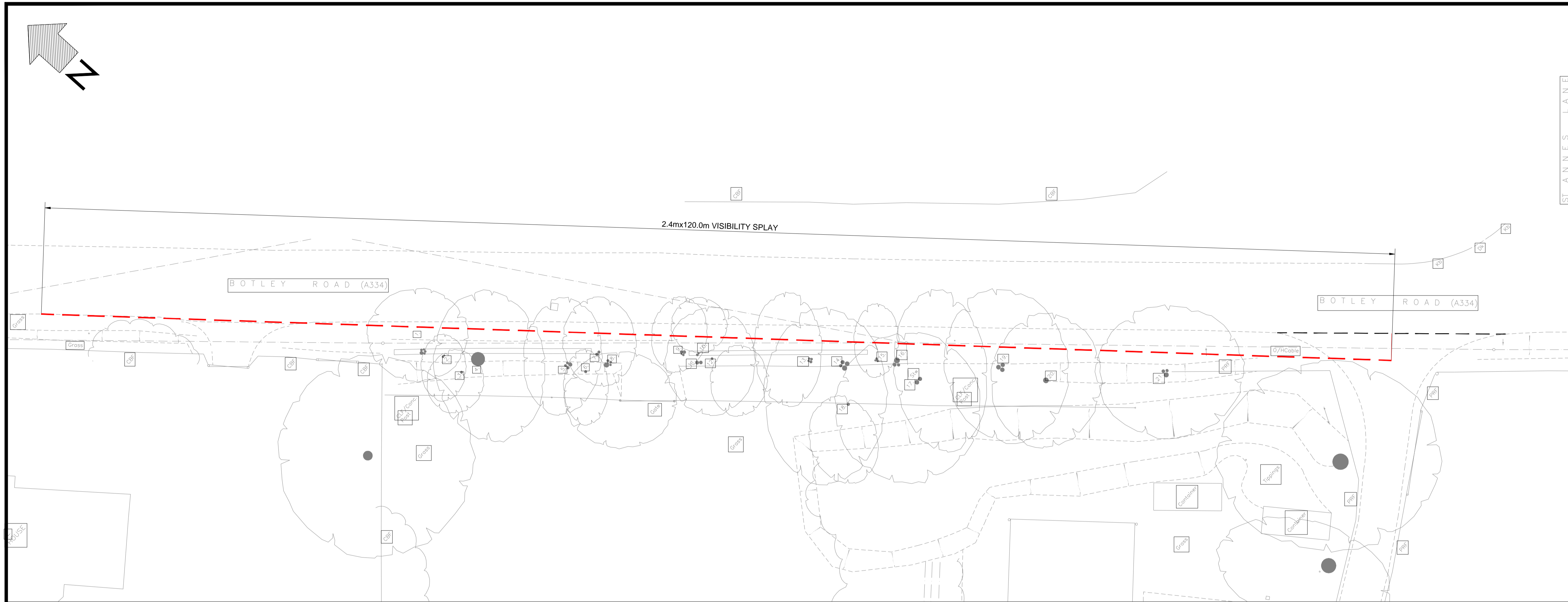

Client



Project

SHELFIELD EQUESTRIAN CENTRE

Drawing Title

ACCESS AND VISIBILITY

Drawing Status

FOR INFORMATION

Date	Scale	Size
JAN 2023	1:200	A1

Drawing No.	Rev
NJC-001	-

Appendix 3

Visibility Cross Section

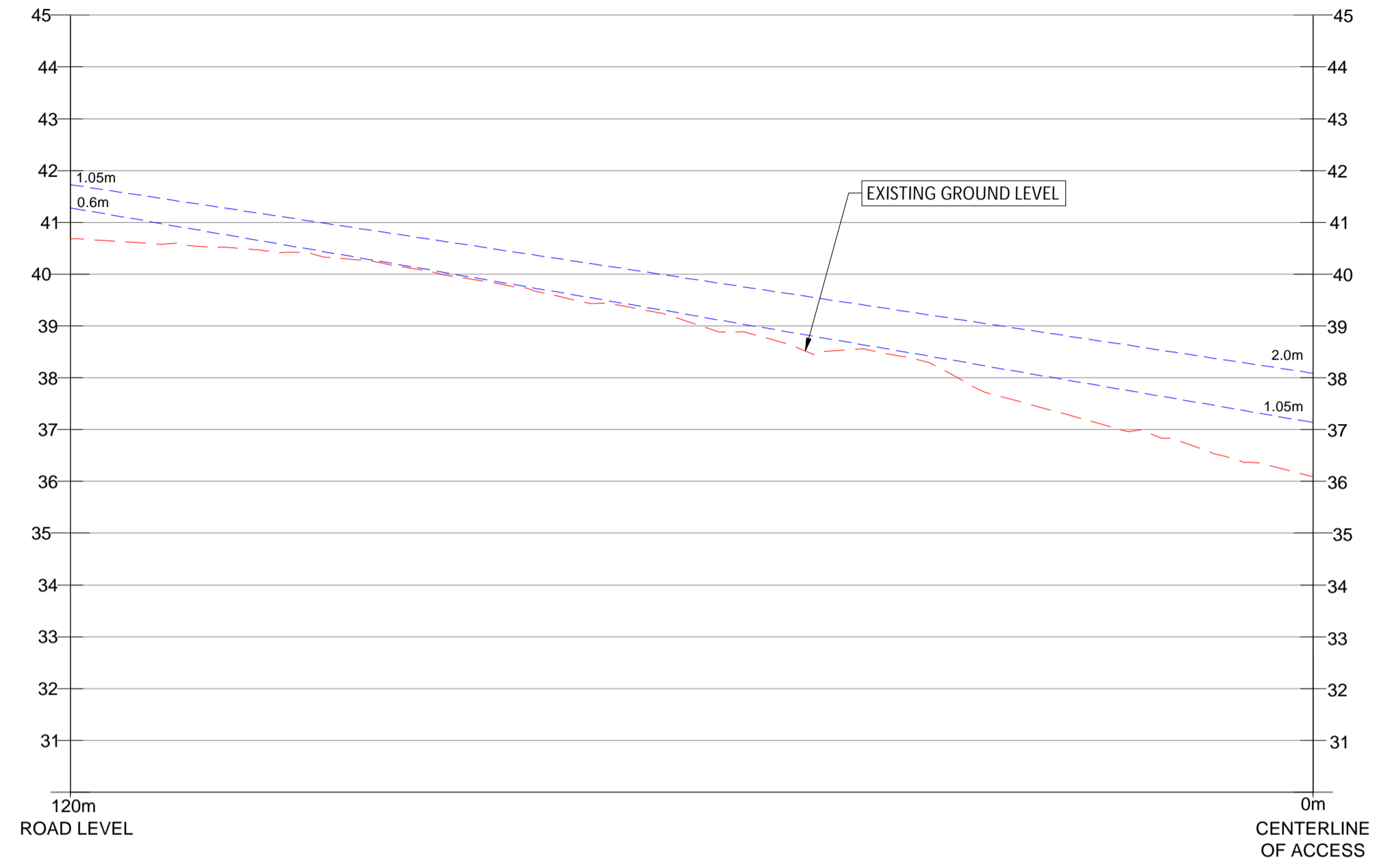

VERTICAL VISIBILITY - NORTH
SCALE: HOR:1:500; VER: 1:100

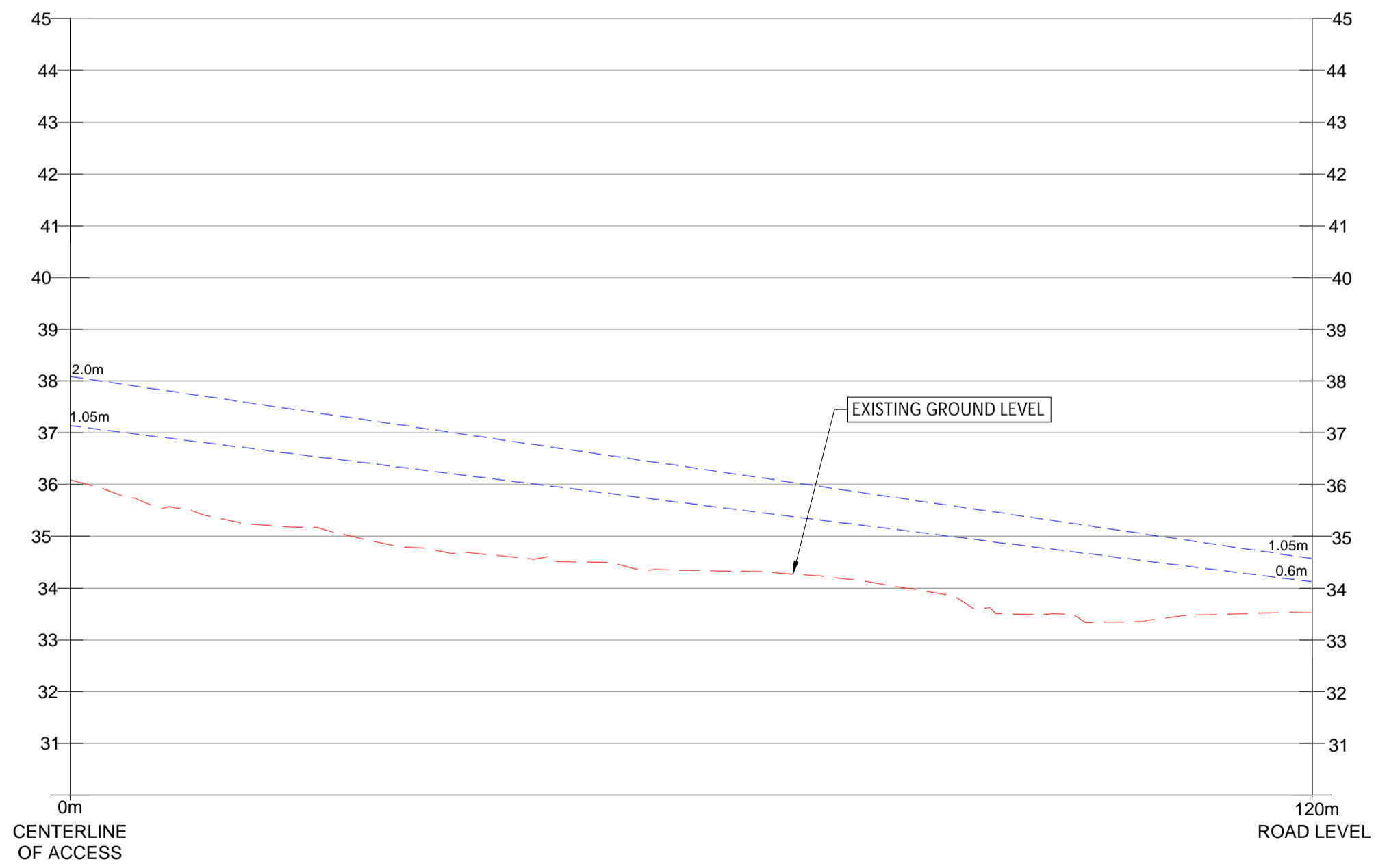

VERTICAL VISIBILITY - SOUTH
SCALE: HOR:1:500; VER: 1:100

Client



Project

SHEDFIELD EQUESTRIAN CENTRE

Drawing Title

ACCESS AND VISIBILITY CROSS SECTION

Drawing Status

FOR INFORMATION

Date	Scale	Size
JAN 2023	1:500	A1
Drawing No.	Rev	
NJC-002	-	

Appendix 4

Traffic Survey Data

Shedfield ATC 01, A334

Produced by Streetwise Services Ltd.



Channel 1 - Northbound

Vehicle Flow

Week 1

Hr Ending	06/02/2022 Sunday	07/02/2022 Monday	08/02/2022 Tuesday	09/02/2022 Wednesday	10/02/2022 Thursday	11/02/2022 Friday	12/02/2022 Saturday	5 Day Ave	7 Day Ave
1	39	12	11	14	13	15	17	13	17
2	25	8	9	9	9	7	17	8	12
3	6	3	9	4	6	5	6	5	6
4	9	4	9	9	5	6	7	7	7
5	7	13	9	8	9	7	4	9	8
6	9	39	39	40	40	37	10	39	31
7	20	105	121	139	135	124	40	125	98
8	49	283	339	321	310	305	95	312	243
9	98	304	349	327	353	326	175	332	276
10	148	293	273	270	303	280	209	284	254
11	264	263	242	250	258	285	312	260	268
12	276	250	264	227	249	303	329	259	271
13	285	280	330	254	273	316	324	291	295
14	262	278	293	284	263	299	344	283	289
15	260	270	294	269	285	332	285	290	285
16	255	299	279	332	299	336	293	309	299
17	217	377	394	396	358	371	273	379	341
18	150	328	340	308	408	332	236	343	300
19	114	177	240	217	234	287	154	231	203
20	94	125	151	145	161	159	123	148	137
21	67	97	81	82	108	107	77	95	88
22	42	44	68	68	74	63	41	63	57
23	31	33	61	51	50	54	57	50	48
24	14	22	20	23	30	45	53	28	30
7-19	2378	3402	3637	3455	3593	3772	3029	3572	3324
6-22	2601	3773	4058	3889	4071	4225	3310	4003	3704
6-24	2646	3828	4139	3963	4151	4324	3420	4081	3782
0-24	2741	3907	4225	4047	4233	4401	3481	4163	3862

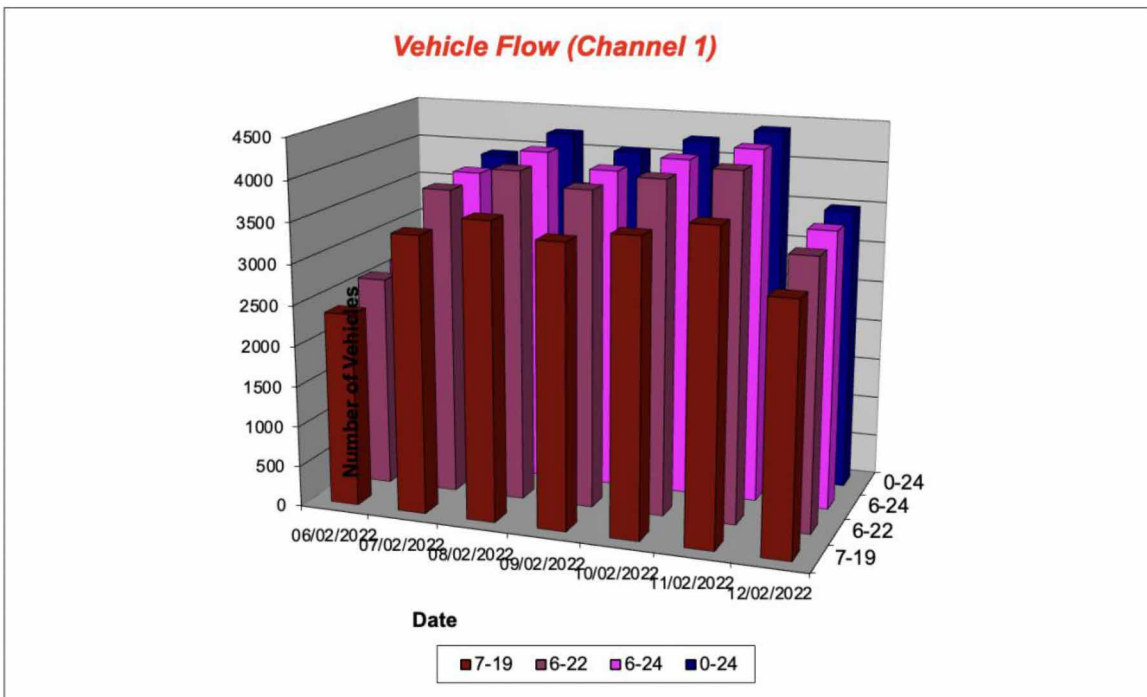

Channel 2 - Southbound

Vehicle Flow

Week 1

Hr Ending	06/02/2022	07/02/2022	08/02/2022	09/02/2022	10/02/2022	11/02/2022	12/02/2022	5 Day Ave	7 Day Ave
	Sunday	Monday	Tuesday	Wednesday	Thursday	Friday	Saturday		
1	29	4	7	8	10	9	17	8	12
2	12	2	3	6	7	3	10	4	6
3	4	5	8	7	7	10	6	7	7
4	6	6	10	12	7	9	6	9	8
5	4	18	11	15	14	11	4	14	11
6	6	42	31	47	33	40	18	39	31
7	24	148	189	172	174	154	54	167	131
8	38	417	422	392	397	366	107	399	306
9	93	376	351	385	371	345	178	366	300
10	167	254	280	278	287	282	225	276	253
11	258	234	266	250	252	299	284	260	263
12	257	249	285	274	289	260	327	271	277
13	287	261	280	271	269	338	326	284	290
14	234	261	290	265	280	326	314	284	281
15	289	277	280	256	281	350	366	289	300
16	255	319	300	306	272	352	287	310	299
17	222	363	372	347	379	382	307	369	339
18	148	339	395	384	364	344	203	365	311
19	103	191	189	231	241	280	145	226	197
20	95	125	121	138	154	124	117	132	125
21	73	81	88	77	110	93	69	90	84
22	39	67	86	71	75	67	67	73	67
23	25	38	60	59	51	71	59	56	52
24	12	18	25	19	26	50	48	28	28
7-19	2351	3541	3710	3639	3682	3924	3069	3699	3417
6-22	2582	3962	4194	4097	4195	4362	3376	4162	3824
6-24	2619	4018	4279	4175	4272	4483	3483	4245	3904
0-24	2680	4095	4349	4270	4350	4565	3544	4326	3979

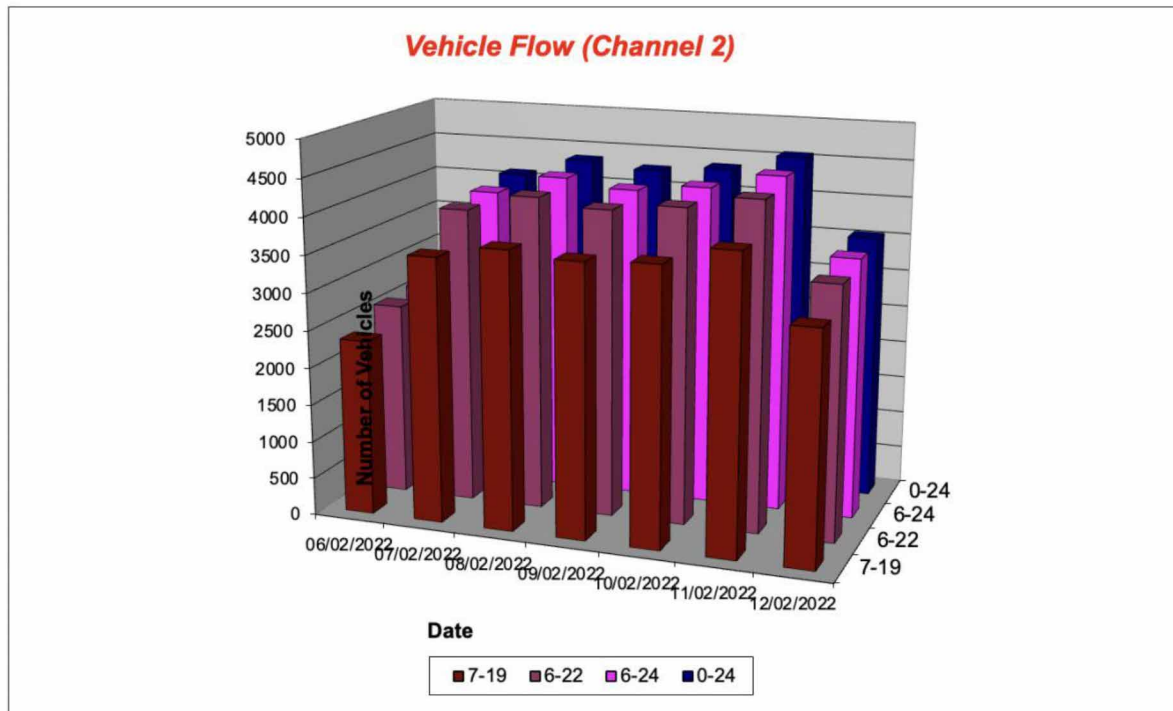

Appendix 5

Parking Layout

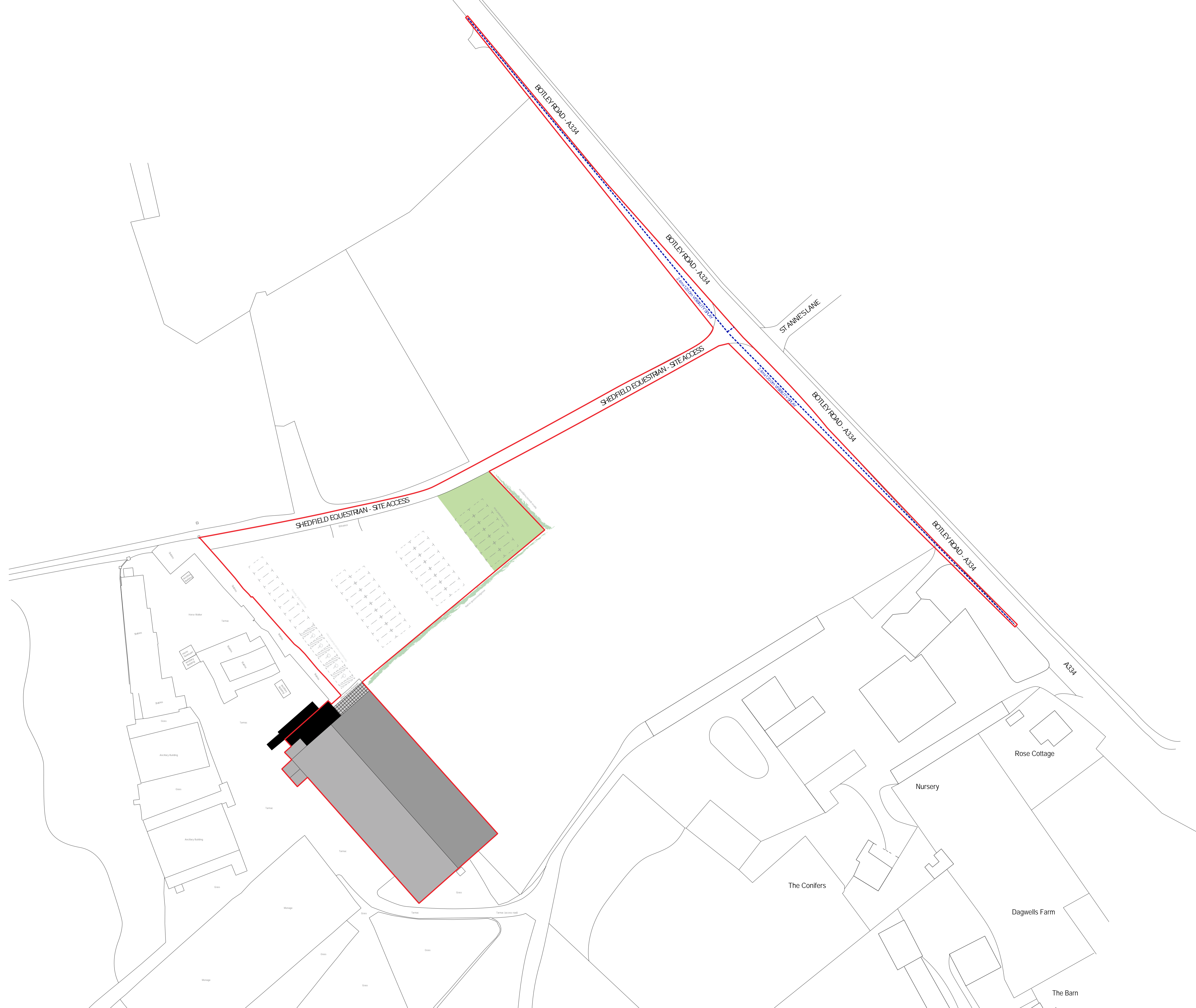

SITE PLAN v2

SHEDFIELD NURSERY & EQUESTRIAN
 Botley Road, Shedfield
 Southampton, Hampshire,
 SO32 2HN

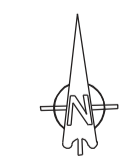

A1 : SCALE 1:500

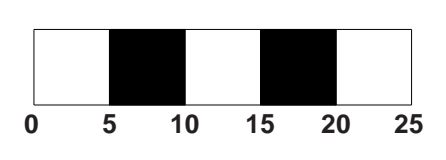

Appendix 6

Swept Path Tracking

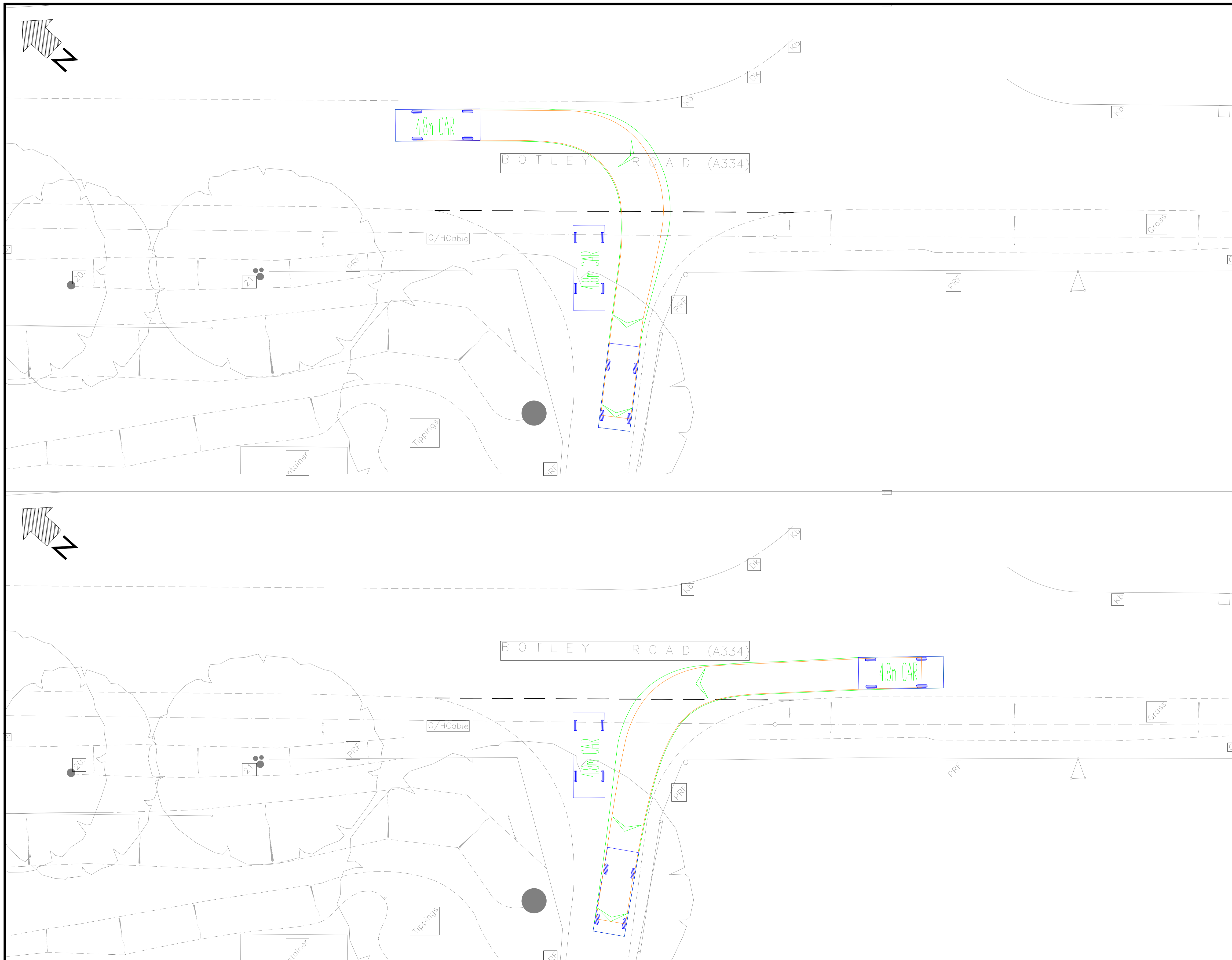

VEHICLE DETAILS:

Green line shows body
Orange line shows axle/wheels

4.8m CAR
 Overall Length 4800mm
 Overall Width 1793mm
 Overall Body Height 1502mm
 Min Body Ground Clearance 287mm
 Track Width 1700mm
 Lock-to-lock time 4.00s
 Curb to Curb Turning Radius 6200mm

Design speed 16kph for all Forward movements
 Design speed 10kph for all Reverse movements

Client



Project

SHELFIELD EQUESTRIAN CENTRE

Drawing Title

SWEPT PATH TRACKING

Drawing Status

FOR INFORMATION

Date	Scale	Size
JAN 2023	1:100	A1

Drawing No.	Rev
NJC-003	-