

FITTING GUIDE - EXTRACTION FLUE COVERS



1

Feed the bottom section over the frame it is to be fixed to.



2

Line up vertically and horizontally using a spirit level.



3

Once the cover is level and in position it should look as shown above.



4

Drill a fixing hole through one of the mortar lines, then countersink to accept the fixing screw head being used to secure to frame.



5

Once holes have been drilled you should be left with countersunk holes as shown above.



6

Screw the GRP panels to the frame being careful to ensure the screws aren't over tightened.



Once the bottom section of the cover has been installed, Offer next section up to the top of the first one, sliding it over the overlap.



Repeat steps 4 & 5.

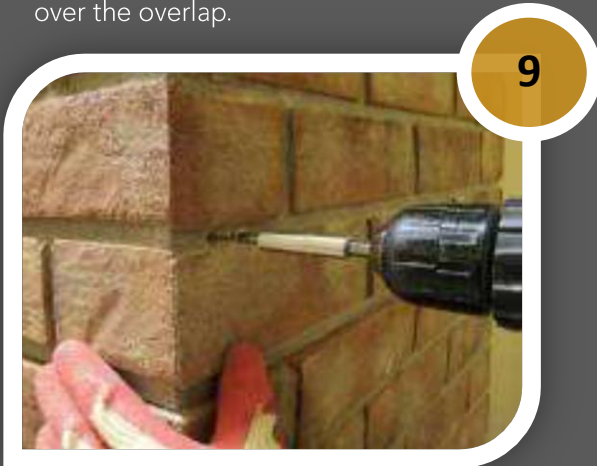

Repeat step 6 for all remaining panels.



Mix the provided mortar compound following the enclosed instructions.



Ensure that when mixing the mortar compound you create an even colour with no streaks and an even consistency.

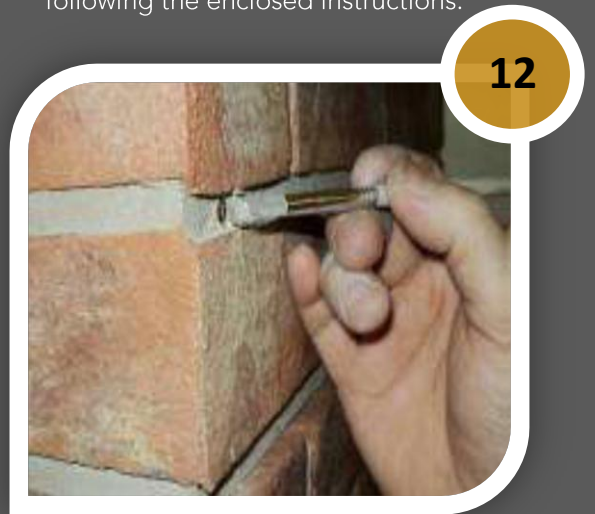

Finally, carefully place the mortar compound over all screw holes to ensure no part of the screw is visible.