

NO DIMENSIONS TO BE SCALED FROM THIS DRAWING

CDM - RESIDUAL HAZARDS The following are considered to be significant risks relevant to this drawing, which could not be fully mitigated or removed through design:

CDM - RESIDUAL HAZARDS	
1	None Identified
2	
3	
0	Further possible control measures have been identified within the Design Risk Assessments which may help to mitigate these and other identified risks further during the construction / maintenance process.

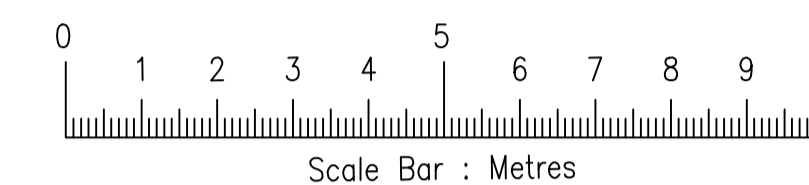
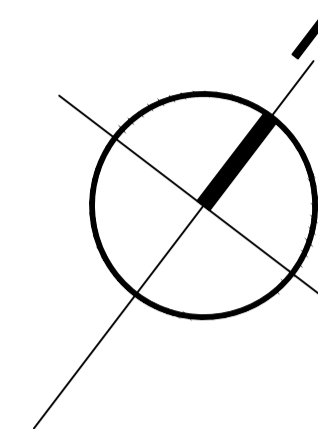

Note: Site plan to be read in conjunction with landscape proposals and associated reports.

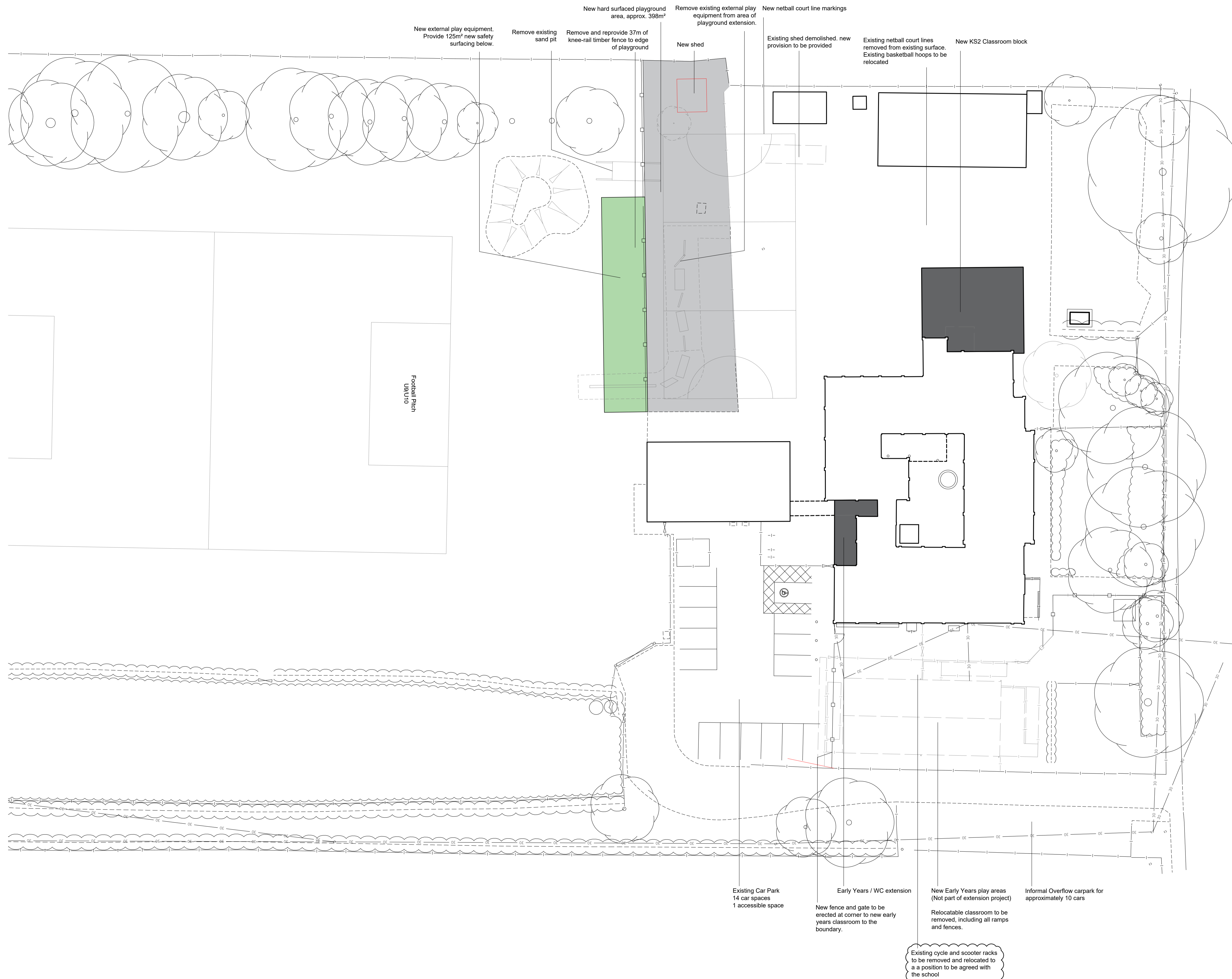

Revision	Date	Drn	Chk
P03	19.08.23	GWY	DPT
P03	16.04.23	GWY	DPT
P02	25.05.23	GWY	DPT
P01	13.04.23	GWY	DPT

Client:
**Jeakins Weir for
Cambridgeshire County Council**

Project:
**Proposed Extension of
Townley Primary School, Christchurch**

Drawing Title:
SITE PLAN - PROPOSED

Suitability Status:
S4 - Suitable for Stage Approval

Job No. **221278** Scale **1:200** Size **@ A1** Rev **P04**

Drawing Number:
110630-PEV-XX-XX-DR-A-9200

Project Code - Originator - Zone - Level - Type - Role - Number



T 0345 045 0050 www.pick-everard.co.uk

This drawing is issued for the sole and exclusive use of the intended recipient and is subject to copyright in favour of Pick Everard. Pick Everard does not accept any responsibility or liability whatsoever for its use by a person other than the intended recipient.