

TYPICAL CROSS SECTIONS THROUGH ACCESS

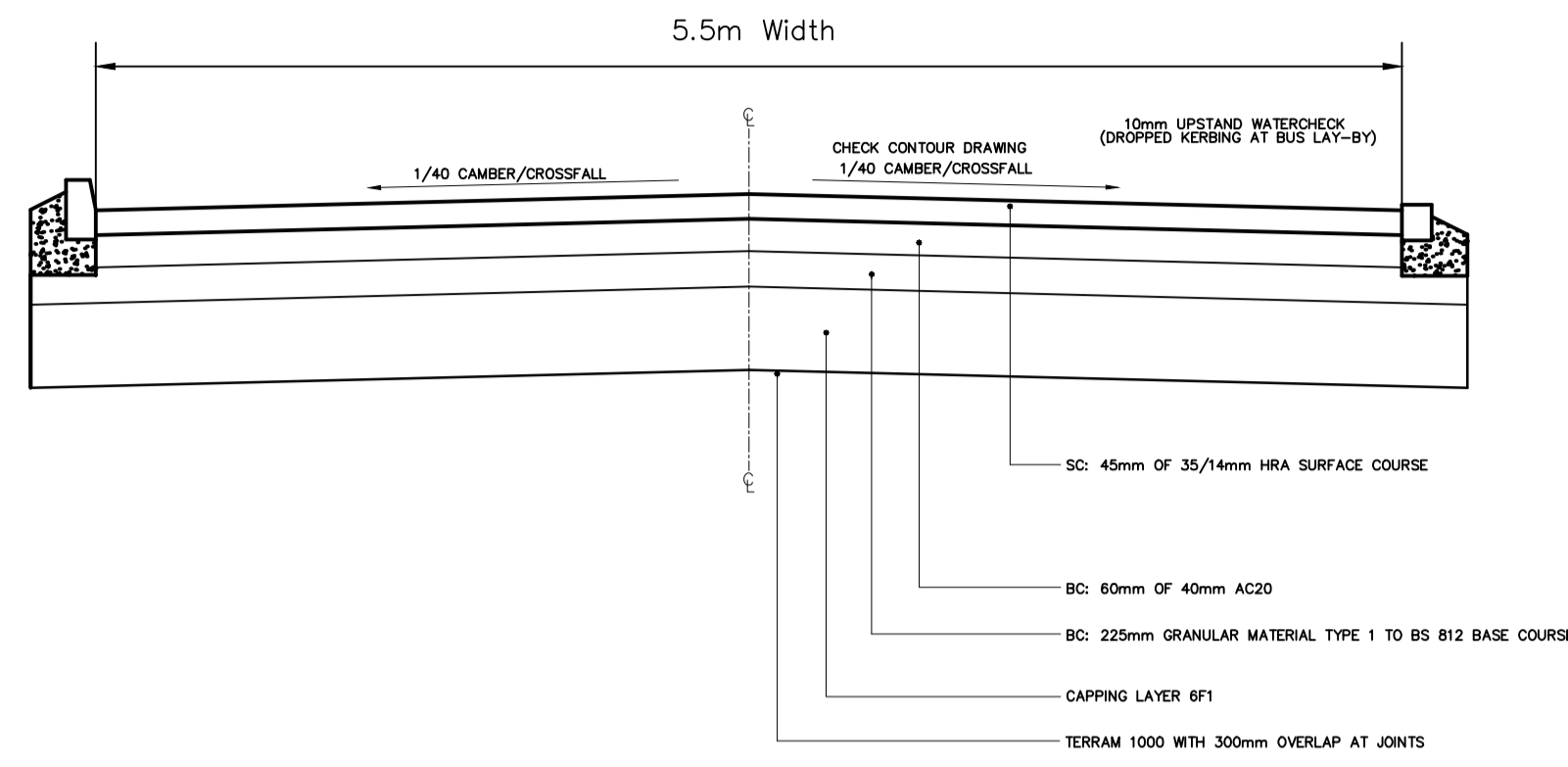

FOOTWAY REINSTATEMENT WORK & DEDICATED FOOT ACCESS

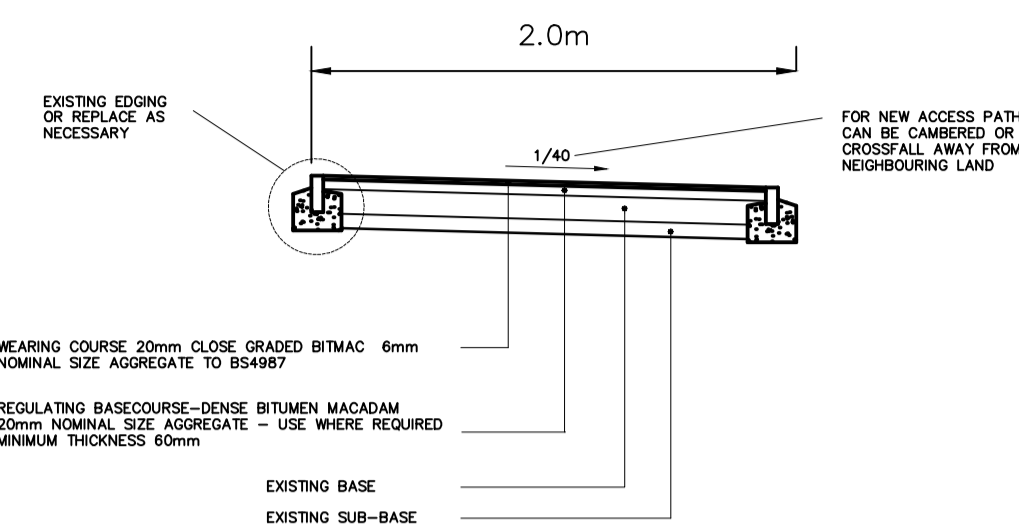

Value at time of construction	Sub-Base Only	Sub-Base & Capping
<2%	-	150 + 600
2.5%	350	150 + 400
3.0%	300	150 + 350
4.0%	270	150 + 300
5.0%	250	150 + 250

IF SUB-GRADE IS TESTED AS FROST SENSITIVE BY MINIMUM CONSTRUCTION OF PAVEMENT TO BE 450mm SUB-BASE and/or CAPPING TO BE DETERMINED BY SITE TESTING AT FORMATION LEVEL AND AGREED WITH BUCKS CC

NOTE:
 BINDER COURSE: DENSE BITUMEN MACADAM, TO CL6.5 BS4987-1.
 ROADBASE: DENSE BITUMEN MACADAM, 32mm NOMINAL SIZE TO CL5.2 BS4987-1.
 SUB-BASE: FULLY COMPACTED TYPE 1 GRANULAR SUB-BASE TO MANUAL OF CONTRACT DOCUMENTS FOR HIGHWAY WORKS (MCHW) VOLUME 1 CLAUSE 803 OR ON SITE STOCKPILED CRUSHED CONCRETE WITH 50mm SAND BUNTING.
 CAPPING LAYER: MCHW (SERIES 600) MATERIAL 60mm COMPLYING TO BS EN 12382 OR ON SITE STOCKPILED CRUSHED CONCRETE WITH 50mm SAND BUNTING.
 SOFT LANDSCAPING: TO ARCHITECTS DETAILS.

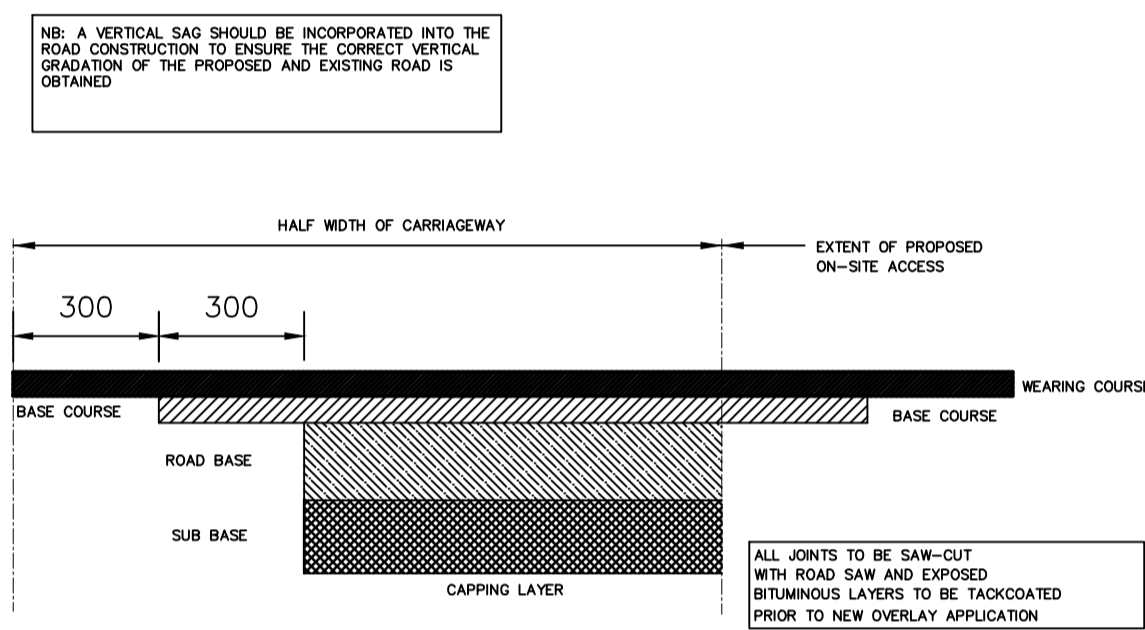
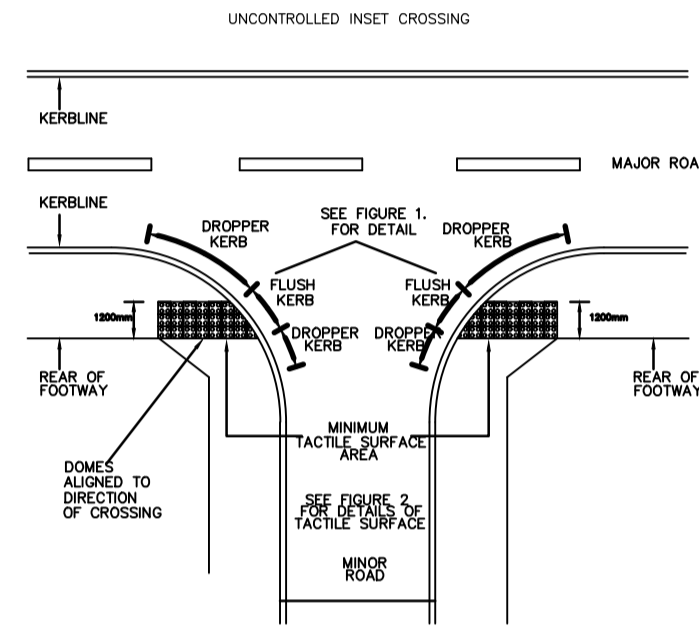

INTERFACE DETAIL BETWEEN NEW ACCESS & EXISTING PUBLIC HIGHWAY

125 x 150 DROP KERB DETAIL

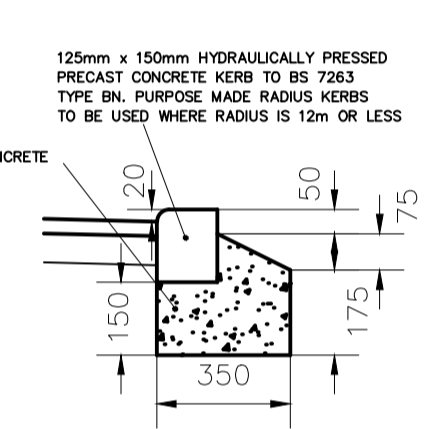

FOOTWAY/SHARED SURFACE EDGING

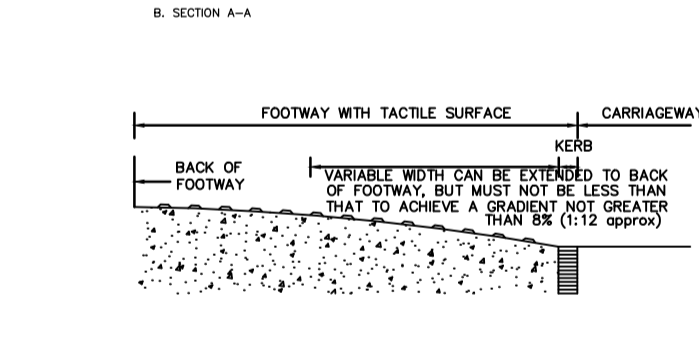
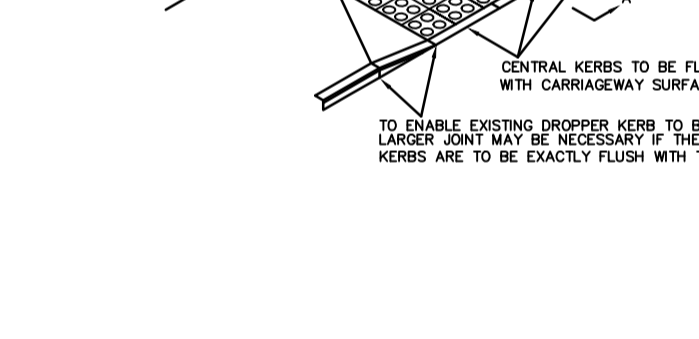
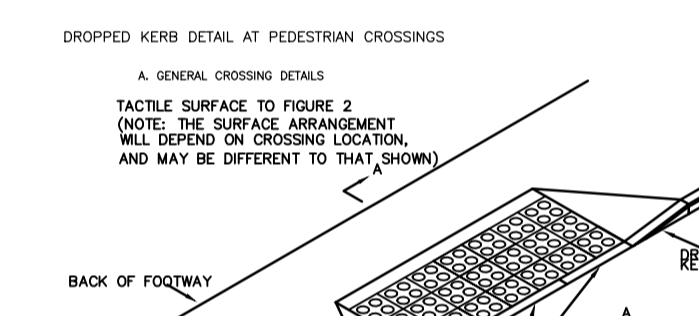
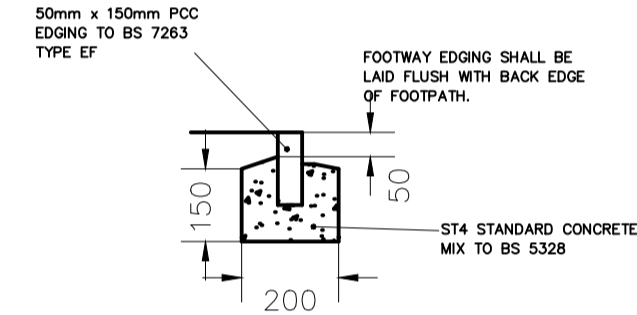

FOUNDATION DETAIL TO ROAD SIGN

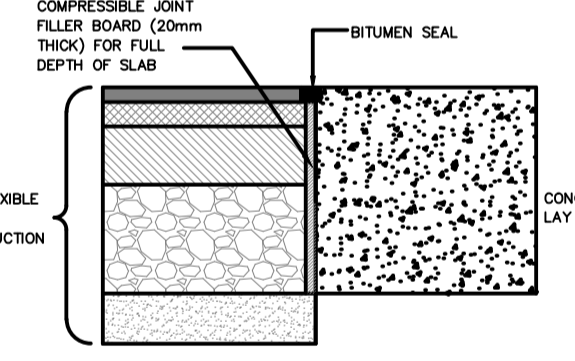
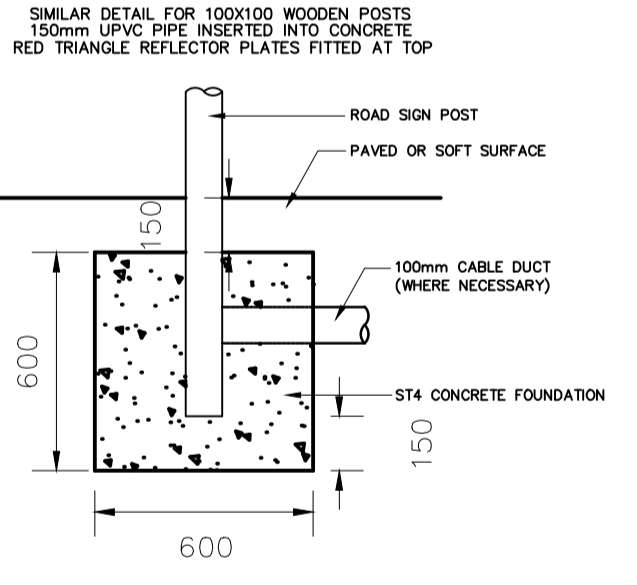

TRANSITION FROM RIGID TO FLEXIBLE ROAD CONSTRUCTION

GRANNITE SETT KERB DETAIL

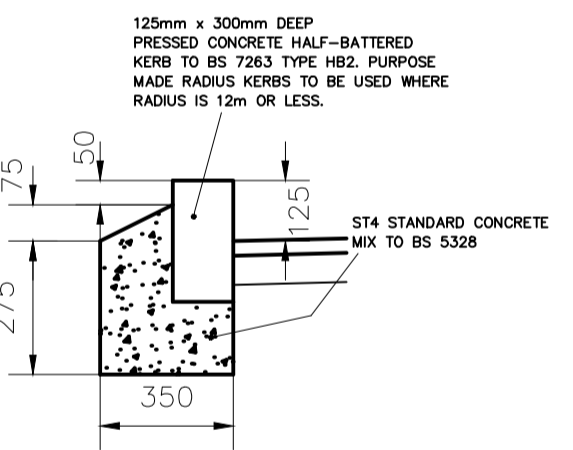

HALF BATTERED KERB DETAIL (PRIVATE ACCESS ONLY)

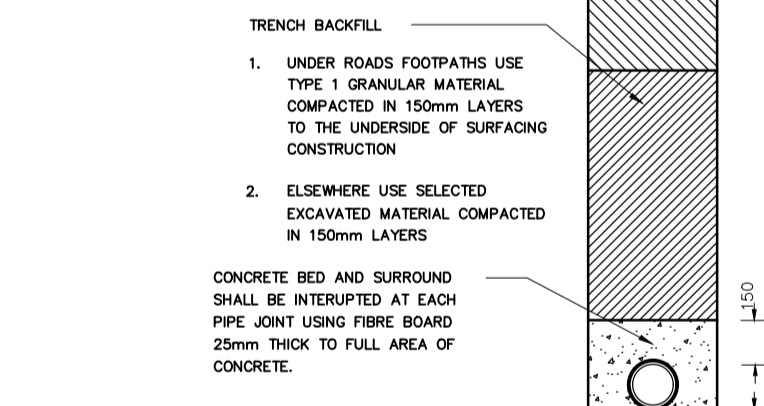
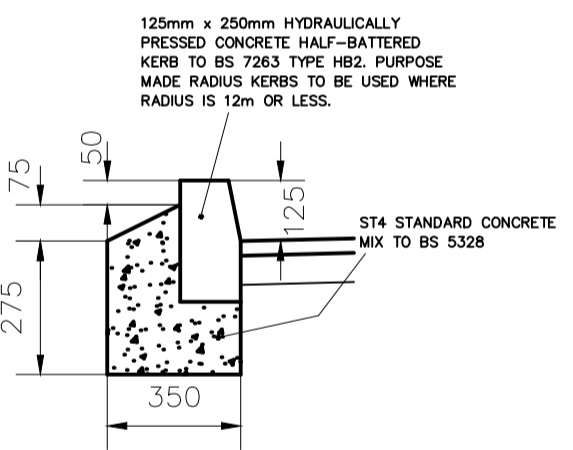

CONCRETE BED AND SURROUND CLASS Z

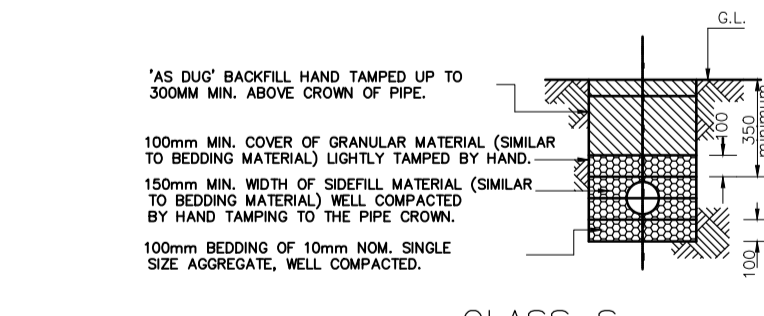

CLASS S PIPES BEDDED AND SURROUNDED IN GRANULAR MATERIAL

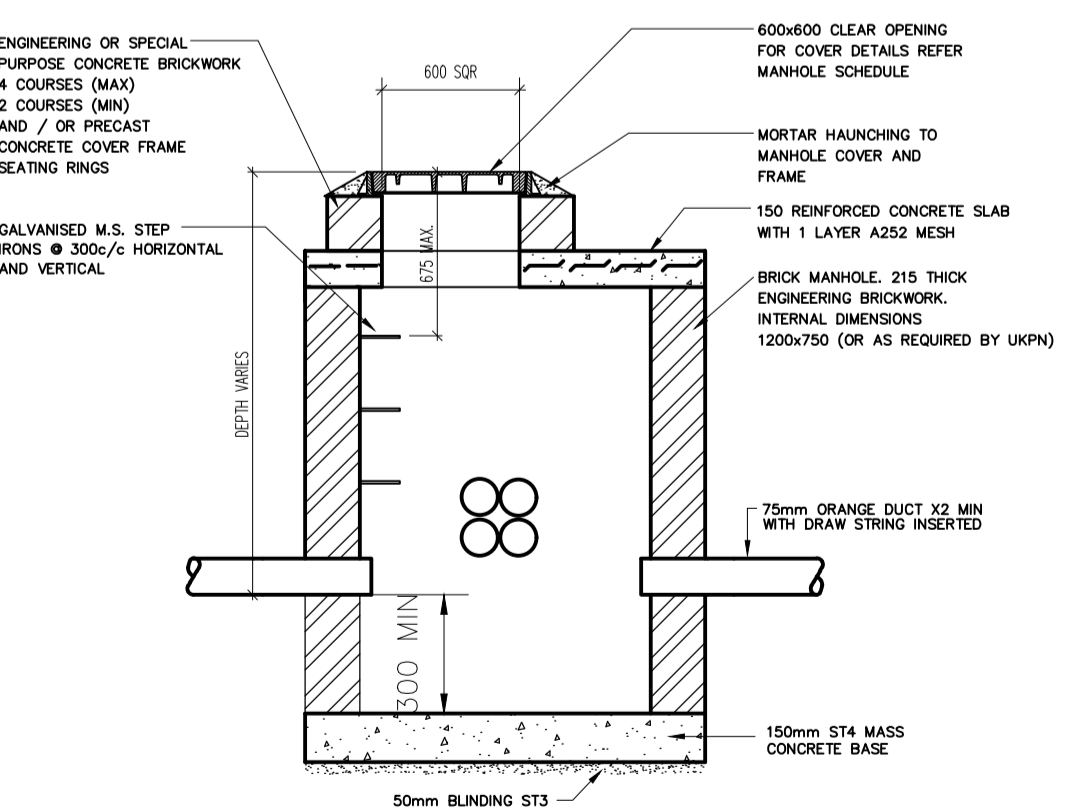
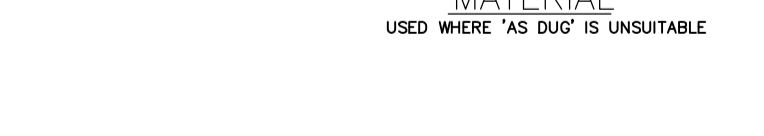

TYPICAL DRAWPIT DETAIL

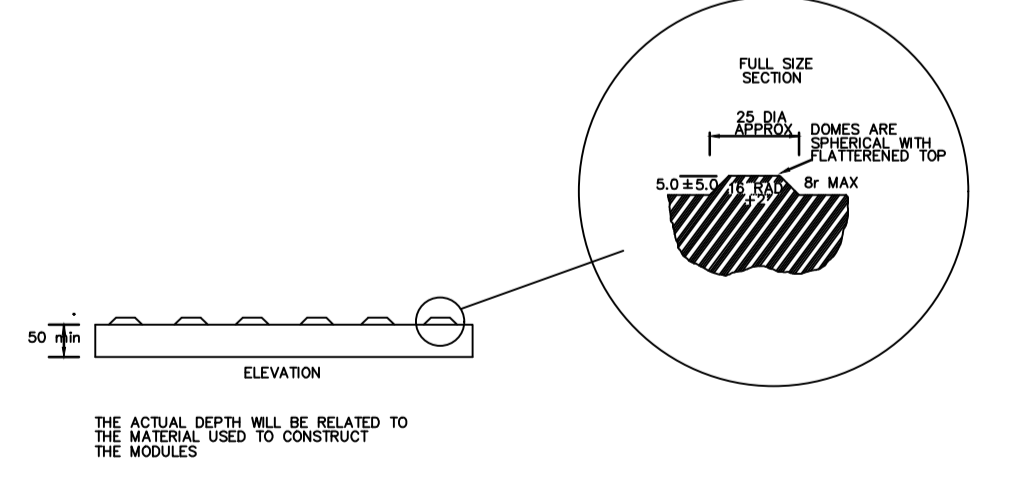
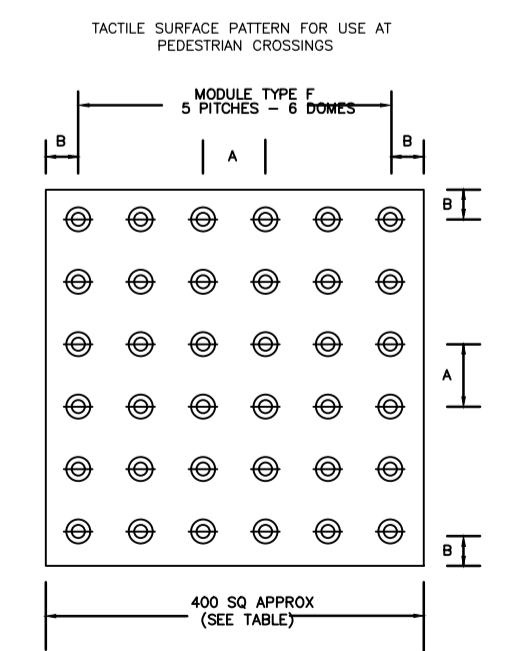

MODULE TYPE	SIZE	PITCH DIMENSION
E	450 x 450	64 x 33
F	400 x 400	64 x 33

- NOTES:
 1) COLOUR - RED FOR CONTROLLED CROSSINGS, BUFF OR CONTRASTING COLOUR, OTHER THAN RED, FOR UNCONTROLLED CROSSINGS
 2) ALL DIMENSIONS IN MILLIMETERS
 3) MATERIALS - THE TACTILE SURFACE MAY BE CONSTRUCTED FROM ANY MATERIAL SUITABLE FOR PAVING FOOTWAY SURFACES
 4) PAVING TO BE Laid ON 30mm SHARP SAND OR LEAN MIX CONCRETE ON 200mm TYPE 1

- All private drainage works to be constructed in accordance with the typical details and the latest building regulations.
- Before commencing any sewer or drainage works, the developer's ground worker must satisfy themselves of actual levels and conditions of existing sewers.
- Drainage under roads to be either-
 A) vitrified clayware to bsen295
 B) concrete to bs5911, class m
- Buried concrete to be class ds-2 conditions in accordance with br digest 363, unreinforced concrete to be sulphate resisting portland cement, as directed by the structural engineers, minimum cement content of 380kg/m³ & maximum free water/cement ratio of 0.45, where 40mm nominal aggregate is used in unreinforced concrete it may be decreased by 30kg/m³, see also note 7.
- All abandoned, buried obstructions encountered during the construction of the highway & drainage works are to be broken out to bed level of drains and sewers and to the formation of car parks and drives etc., and to the sufficient depth to allow for laying of company's main services.
- In situ concrete to benchings of foul manholes to be class 4 conditions, i.e. min cement to 360kg/m³ sulphate resisting portland cement and max. free water ratio of 0.45 and 20mm aggregate, precast concrete used in construction of foul sewers to be sulphate resisting to class 4.
- Depth and location of existing services to be traced prior to any excavation.
- All private drainage to be laid to levels shown using flexibly jointed pipes either upvc to bs 4460 and bs5481 or vitrified clayware to bsen 295.
- Generally pipes to have granular bed & surround in accordance with manufacturers recommendations, ensuring adequate protection with respect to depth and location.

Rev	Description	By	Date	Chkd
T04	COMMENTS DATED 21.08.22 FROM HIGHWAYS INCLUDED	JMB	19.07.22	
T03	ADDITIONAL DETAILS ADDED, Gully REMOVED	JMB	26.10.21	
T02	DRAWN PITS AND TRENCH POSTS DETAILS ADDED	JMB	20.12.21	
T01	ISSUED FOR TENDER	JMB	09.12.21	

Hull Raiser Ltd
 Dagmar House
 Mill Hill Road
 Cowes
 Isle of Wight
 PO31 7EJ
 E-mail: Technical@Hullraiser.co.uk
 Phone: (+44) 797 092 5335

WENDOVER CRICKET CLUB

WENDOVER CRICKET CLUB BUCKINGHAMSHIRE CRICKET CLUB ENTRANCE

CONSTRUCTION DETAILS

Status
TENDER

Drawing No.
211011-003

Revision
T04

Scale	Size	Drawn	Date	Chkd	Passed
VARIABLES	A1	JMB	21.10.21	AL	