

Notes :

This drawing has been prepared in accordance with BS 5837:2012.

This drawing is intended to be printed and used in colour only, and for no purpose other than the consideration of trees in accordance with BS 5837.

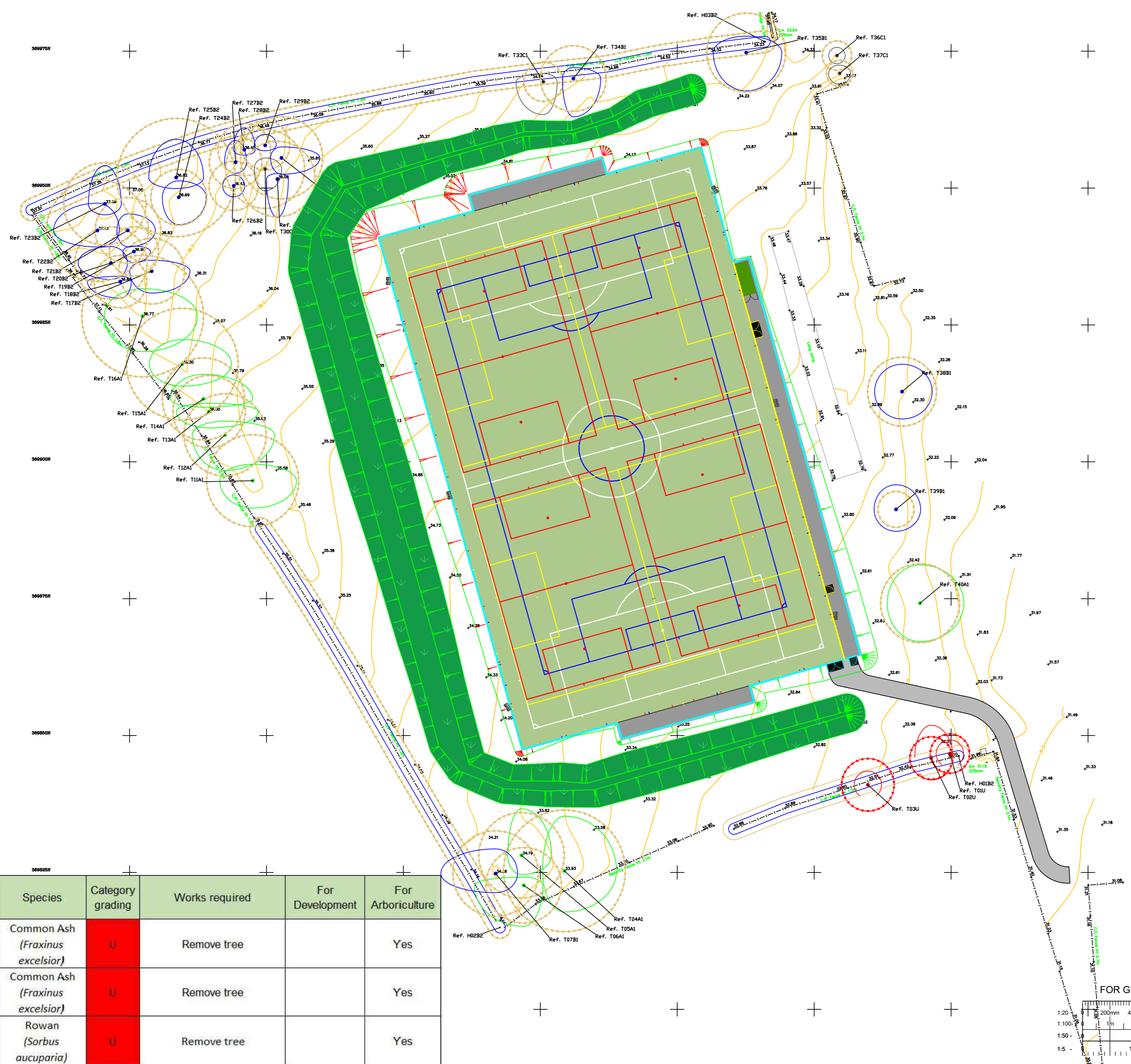

BS5837:2012 Cascade chart for tree quality assessment

Category & Definition	Criteria (Including subcategories where appropriate)	Identification on plan
Tree: unsuitable for retention	Category U	Red on plan RGB 127,0,0
Trees to be considered for retention		
Category A	1. Many important qualities 2. Many landscape qualities 3. Many cultural values, including conservation	Light Green RGB 0,255,0
Category B	1. Many important qualities 2. Many landscape qualities 3. Many cultural values, including conservation	Blue RGB 0,0,255
Category C	1. Many important qualities 2. Many landscape qualities 3. Many cultural values, including conservation	Grey RGB 0,0,0

- KEY**
- Root Protection Area (RPA)
 - Tree Stem
 - T1 Tree No.
 - Tree to be removed
 - Tree to be pruned

Tree reference number	Species	Category grading	Works required	For Development	For Arboriculture
T01	Common Ash (<i>Fraxinus excelsior</i>)	U	Remove tree		Yes
T02	Common Ash (<i>Fraxinus excelsior</i>)	U	Remove tree		Yes
T03	Rowan (<i>Sorbus aucuparia</i>)	U	Remove tree		Yes

Rev	Details	Date	Checked By
Drawing Number		AEL-18793-TWP	
Apex Environmental Ltd 3 Lawrence Way, Lichfield, WS13 6RD TEL: 0121 249 1235 e-mail: info@ael-treeconsultants.co.uk web: www.ael-treeconsultants.co.uk			
Client		Surfacing Standards Ltd	
Project Queen Elizabeth Grammer School, Horncastle			
Title Tree Work Plan			
Scale	Date	Drawn By	Checked By
1:500	23/07/2023	RJH	
Revision		Drawing Number	
A			
THIS DRAWING IS CONFIDENTIAL AND MUST NOT BE REPRODUCED WITHOUT THE CONSENT OF APEX ENVIRONMENTAL LTD			

