

This scheme is subject to Town Planning and all other necessary consents, conditions and approvals. It is intended as a guide only and is not to be used for construction. All dimensions are to be checked on site, do not scale. This drawing is to be read in conjunction with all relevant consultants' and/or specialists' drawings/documents and any discrepancies or variations are to be resolved by the client and the design team. All queries, comments and any structural elements are to be referred to the structural engineering consultant for resolution. All feasibility studies are subject to full site survey. The workmanship of all trades shall conform to the relevant standards of the Institution of Mechanical Engineers (BSEN) and the relevant standards of British Standard (BS) 5900/1589 parts 1-15 inclusive.

All design and construction is to be in accordance with the Construction, Design and Management Regulations 2015.

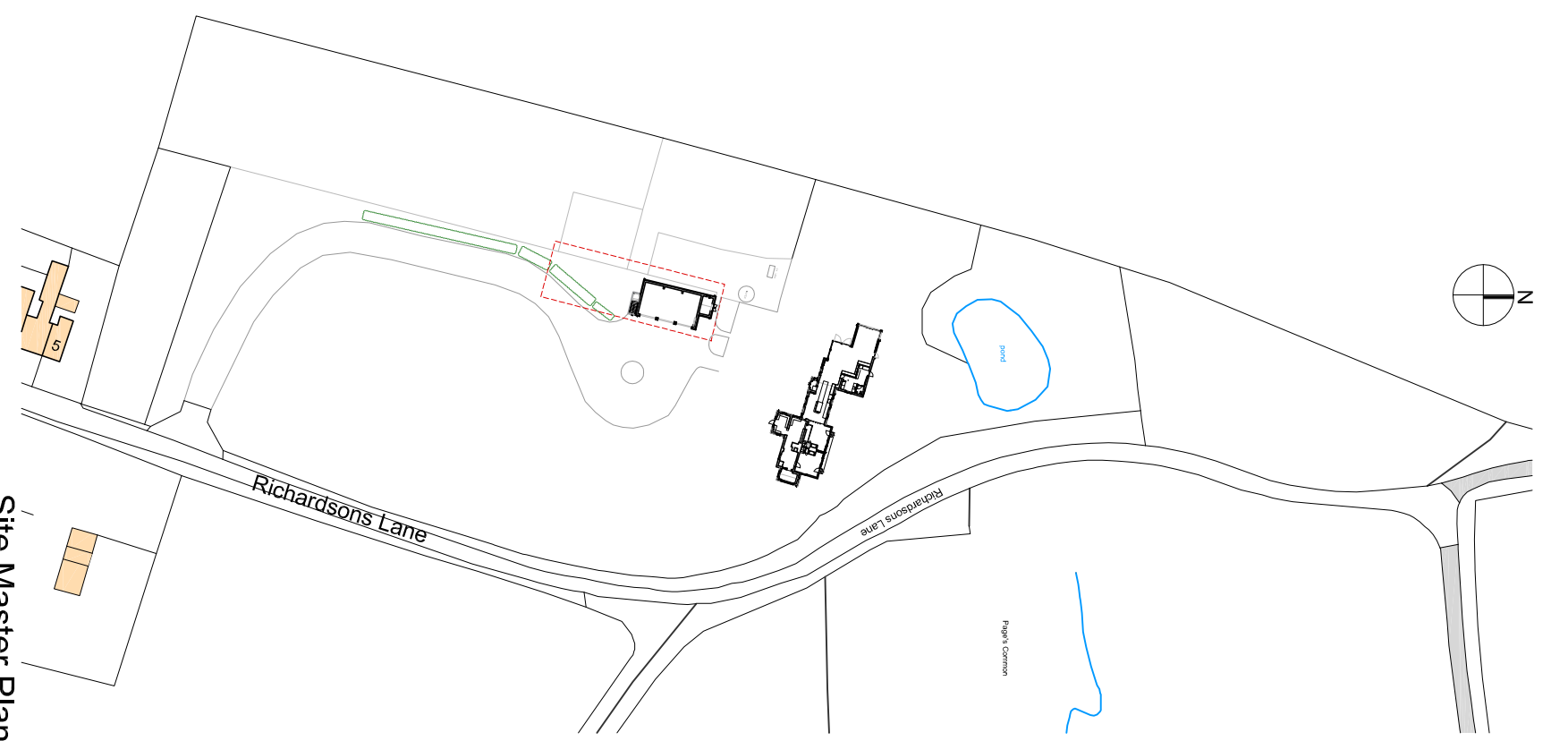
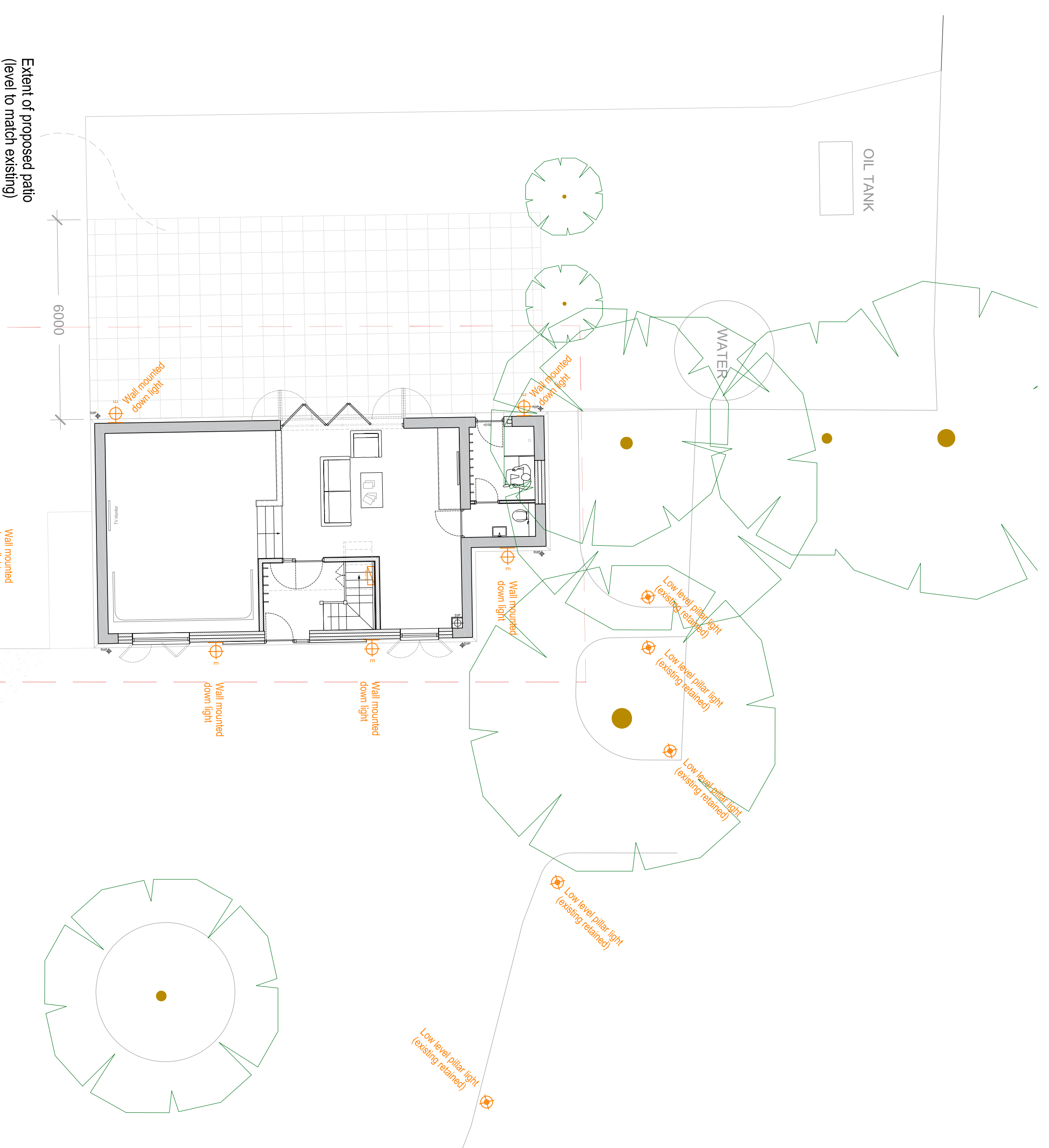
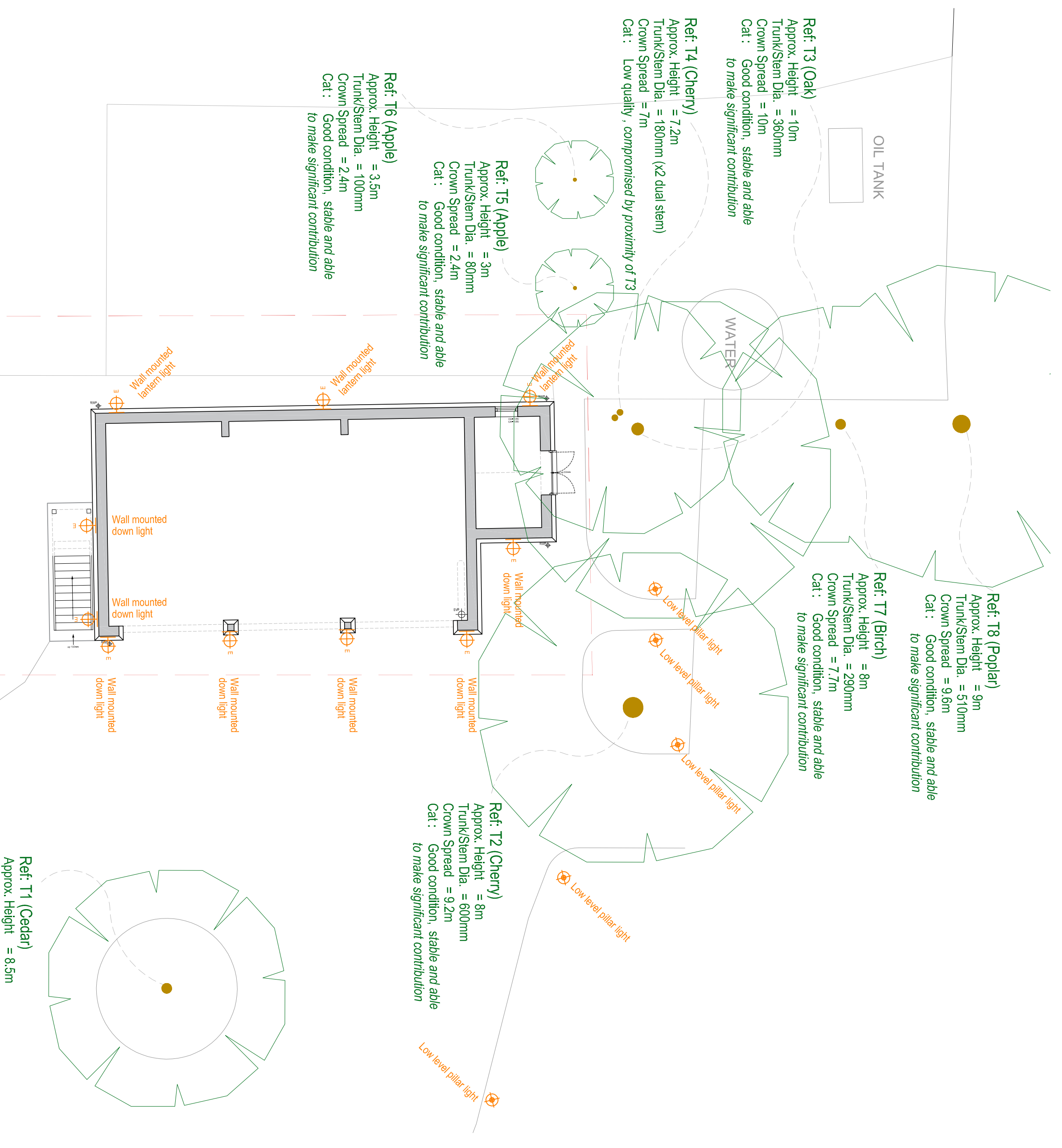

Existing tarmac driveway extended to front of new cart lodge (levels to match existing) extent as indicated by hatching

**NOTES:**  
 All existing trees to be retained, no topping or lopping of the existing trees on site is proposed as part of the works. All ground levels to remain as existing and no excavations are proposed within the crown spread of the trees on site.  
 All lighting fittings positioned as indicated on the plans. All fittings will not exceed 2700K and will illuminate downwards only. Wall lights to be mounted at 1.8m from ground level.

## PLANNING

Revisions	project	address	drawing	dwg no.	date	scale
	Proposed Extension & Alterations to Cart Lodge	Longwood House, Richardsons Lane, Chelmondiston. IP9 1HP	Landscape Scheme Strategy Plan as Existing and Proposed	LH-1222-PL-4000	AUG 23	1:200 @ A3 1:100 @ A1

**Sones Stannard**  
 Interior & Architectural Design

T: 01254 388073  
 E: mail@sonesstannard.com  
 W: www.sonesstannard.com  
 Forge Cottage, Sicklestone, Bury St Edmunds IP20 0BU

Landscape plan as Existing

Landscape plan as Proposed