

SITE LOCATION

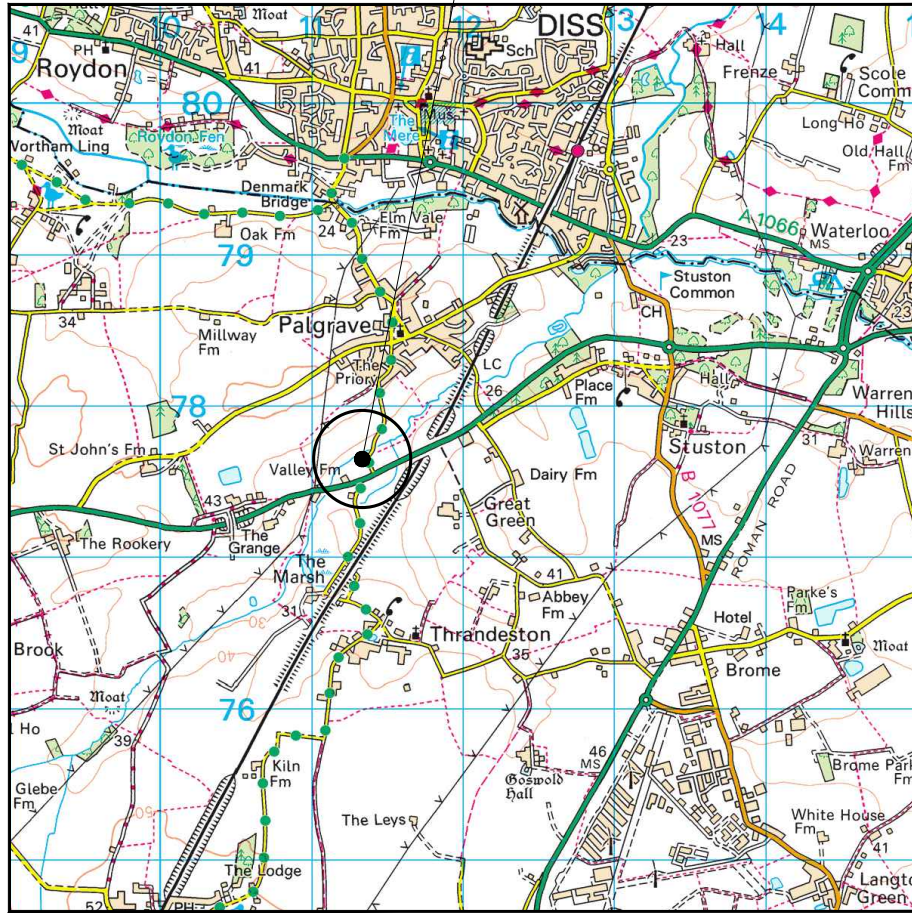

SITE LOCATION
(SCALE 1:50000)

ORDNANCE SURVEY EXTRACT. BASED UPON THE LANDRANGER MAP SERIES WITH THE PERMISSION OF THE CONTROLLER OF HER MAJESTY'S STATIONERY OFFICE. CROWN COPYRIGHT. LICENCE No. 0100023487

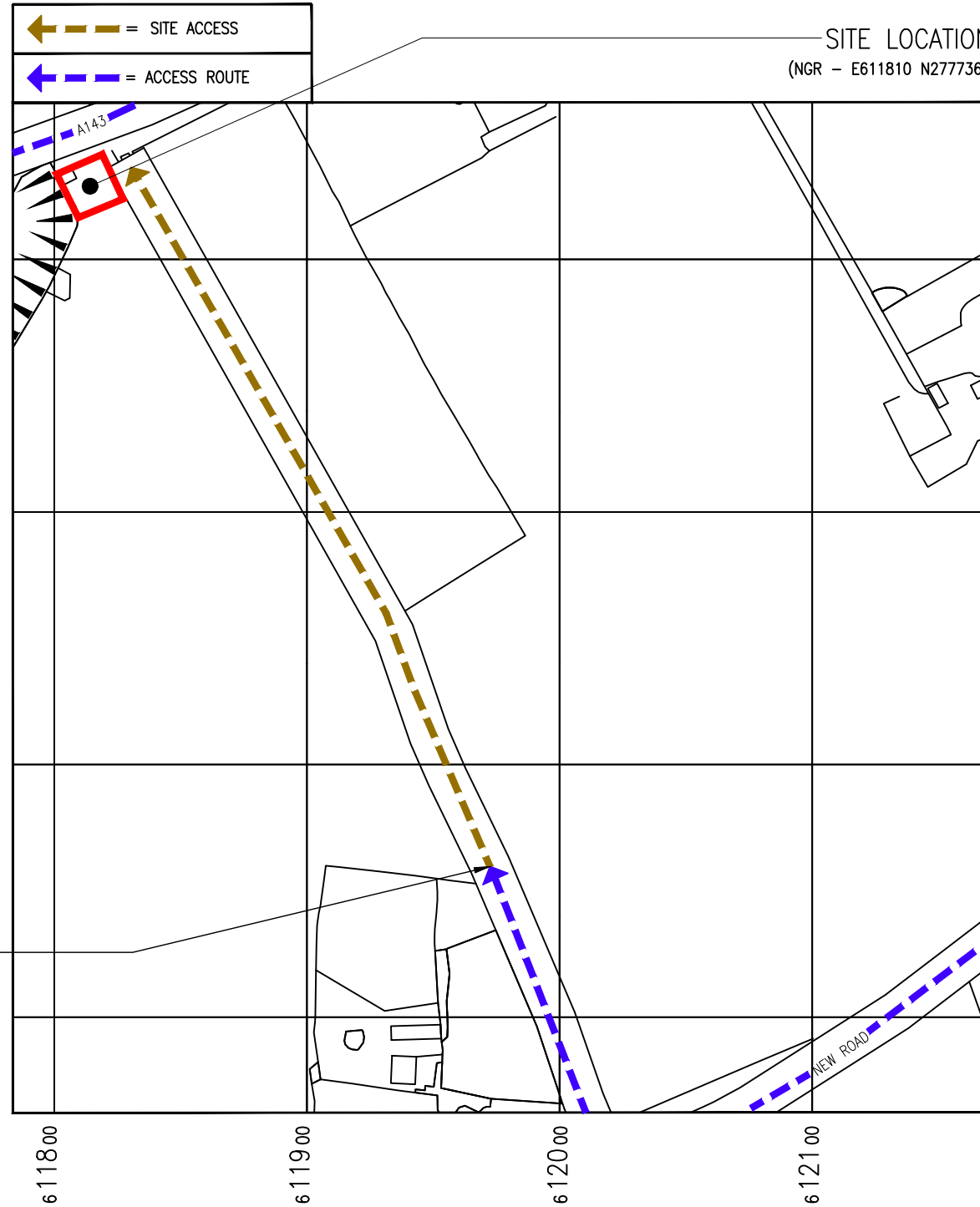
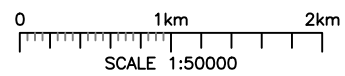

SITE LOCATION
(NGR - E611810 N277736)

DETAILED SITE LOCATION
(SCALE 1:2500)

BASED UPON ORDNANCE SURVEY MAP EXTRACT WITH THE PERMISSION OF THE CONTROLLER OF HER MAJESTY'S STATIONERY OFFICE. CROWN COPYRIGHT. LICENCE No. 100047474

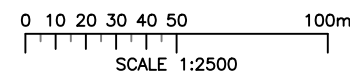

NOTES:

OUTLINE OF DEMISE AREA, 382m²

A	INITIAL ISSUE	FR	INS	19.06.23
REV.	MODIFICATION	BY	CHK.	DATE

ICON TOWER
INNOVATIVE INFRASTRUCTURE SOLUTIONS

ICON TOWER REF No:
GBR-SFK0001

OPERATOR 1 REFERENCE No.:
N/A

OPERATOR 2 REFERENCE No.:
N/A

SITE NAME AND ADDRESS:
POND FARM
GREAT GREEN
DISS
IP21 4BQ

DRAWING TITLE:
SITE LOCATION MAPS

PURPOSE OF ISSUE:
PLANNING

DRAWING NUMBER:
100

SURVEYED BY: INS GROUP	ORIGINAL SIZE: A3	ISSUE: A
DRAWN: FR	DATE: 19.06.23	CHECKED: INS
	DATE: 19.06.23	

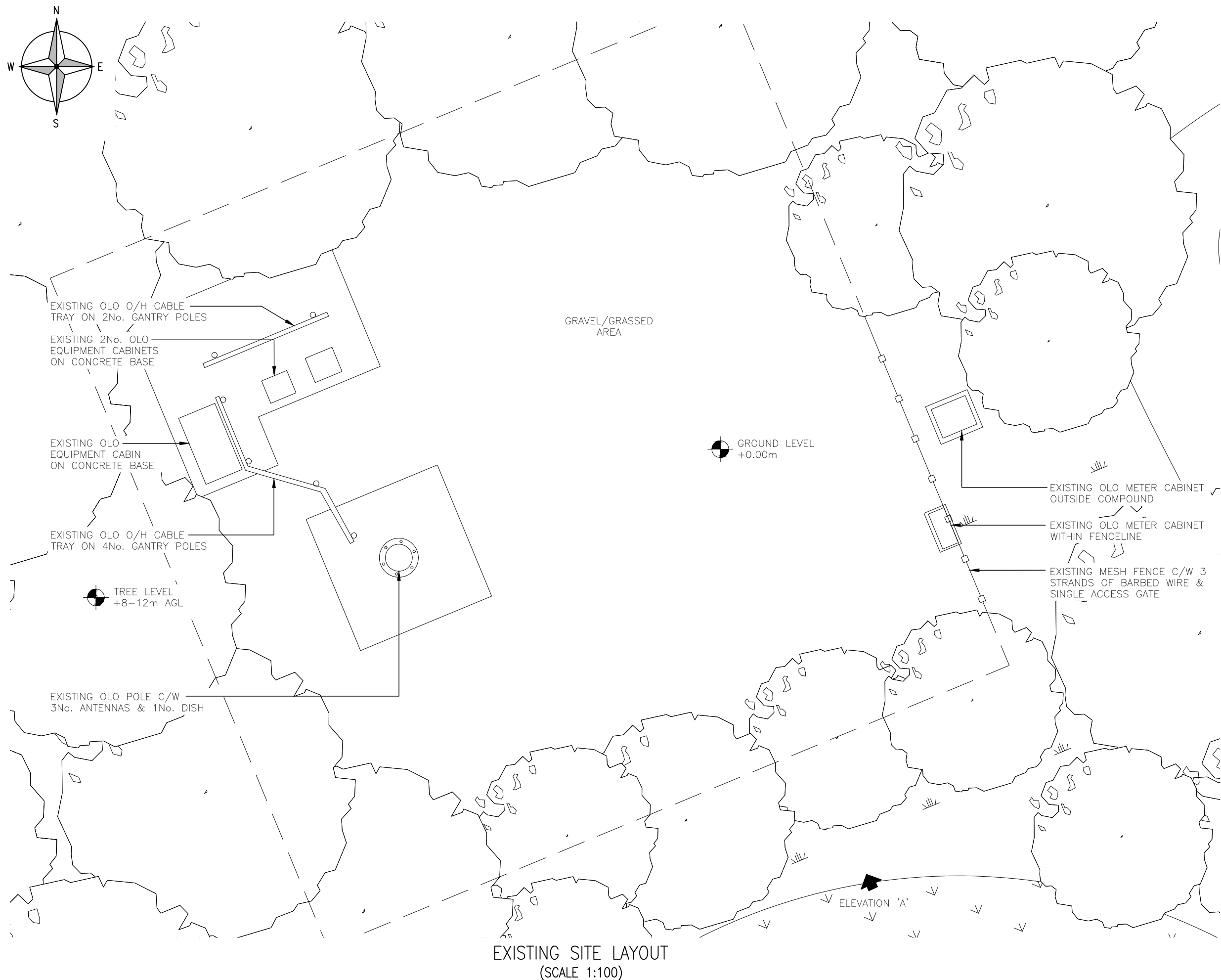

EXISTING SITE LAYOUT
(SCALE 1:100)

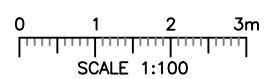

NOTES:

A	INITIAL ISSUE	FR	INS	19.06.23
REV.	MODIFICATION	BY	CHK.	DATE



ICON TOWER REF No:
GBR-SFK0001

OPERATOR 1 REFERENCE No.:
N/A

OPERATOR 2 REFERENCE No.:
N/A

SITE NAME AND ADDRESS:
POND FARM
GREAT GREEN
DISS
IP21 4BQ

DRAWING TITLE:
EXISTING SITE LAYOUT

PURPOSE OF ISSUE:
PLANNING

DRAWING NUMBER:
200

SURVEYED BY: INS GROUP		ORIGINAL SIZE: A3		ISSUE: A
DRAWN: FR	DATE: 19.06.23	CHECKED: INS	DATE: 19.06.23	

1:1

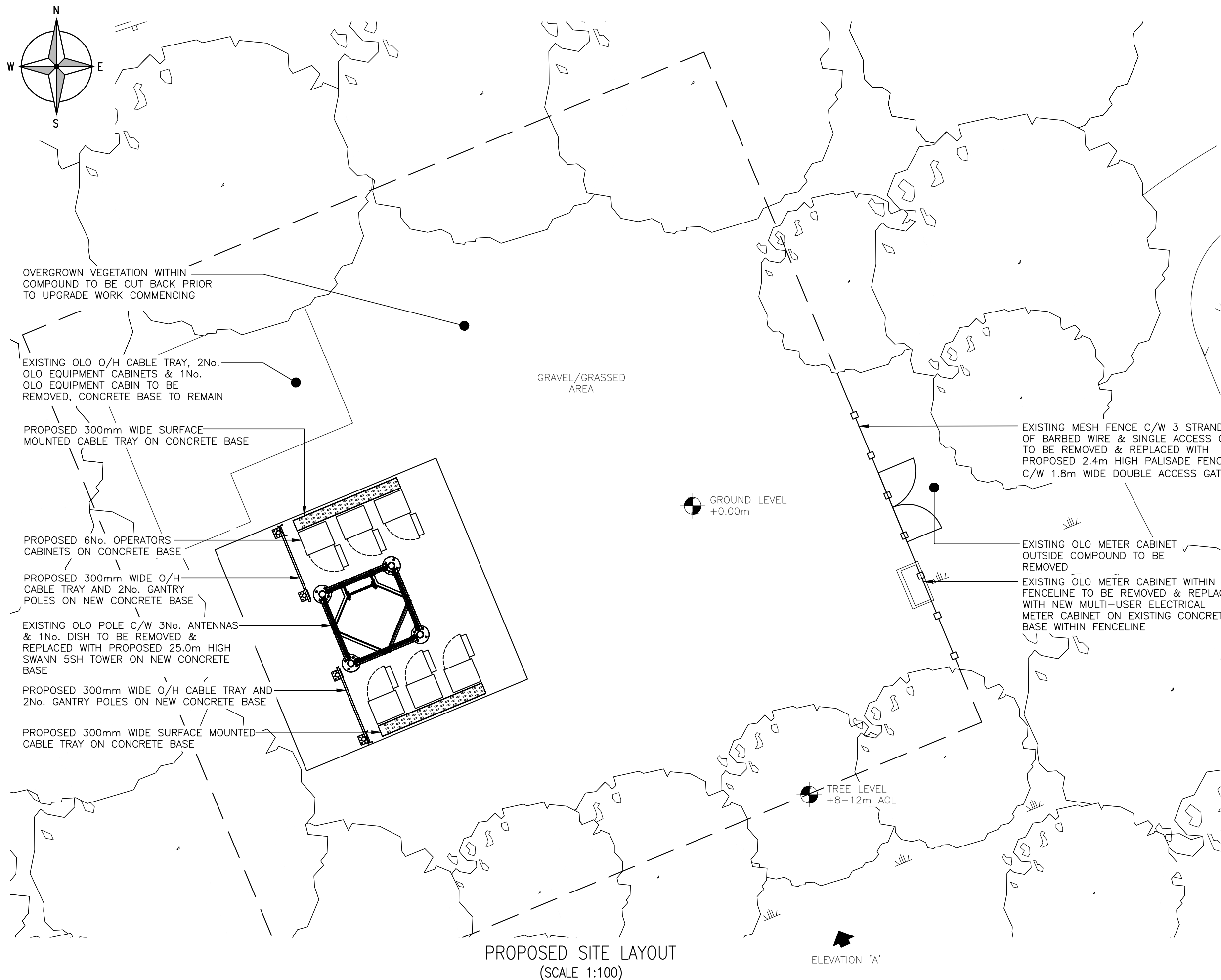

NOTES:

A	INITIAL ISSUE	FR	INS	19.06.23
REV.	MODIFICATION	BY	CHK.	DATE

A	INITIAL ISSUE	FR	INS	19.06.23
REV.	MODIFICATION	BY	CHK.	DATE



ICON TOWER REF No:
GBR-SFK0001

OPERATOR 1 REFERENCE No.:
N/A

OPERATOR 2 REFERENCE No.:
N/A

SITE NAME AND ADDRESS:
POND FARM
GREAT GREEN
DISS
IP21 4BQ

DRAWING TITLE:
PROPOSED SITE LAYOUT

PURPOSE OF ISSUE:
PLANNING

DRAWING NUMBER:
201

SURVEYED BY: INS GROUP	ORIGINAL SIZE: A3	ISSUE: A
DRAWN: FR	DATE: 19.06.23	CHECKED: INS
	DATE: 19.06.23	

1:1

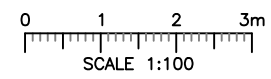



EXISTING NORTH-WEST ELEVATION
(SCALE 1:125)

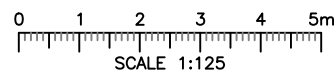

NOTES:

A	INITIAL ISSUE	JL	NDS	29.03.23
REV.	MODIFICATION	BY	CHK.	DATE



ICON TOWER REF No:
GBR-SFK0001

OPERATOR 1 REFERENCE No.:
N/A

OPERATOR 2 REFERENCE No.:
N/A

SITE NAME AND ADDRESS:
POND FARM
GREAT GREEN
DISS
IP21 4BQ

DRAWING TITLE:
EXISTING SITE ELEVATION

PURPOSE OF ISSUE:
PLANNING

DRAWING NUMBER:
300

SURVEYED BY: INS GROUP	ORIGINAL SIZE: A3	ISSUE: A
---------------------------	----------------------	-------------

DRAWN: FR	DATE: 19.06.23	CHECKED: INS	DATE: 19.06.23
--------------	-------------------	-----------------	-------------------

1:1

NOTES:

A	INITIAL ISSUE	JL	NDS	29.03.23
REV.	MODIFICATION	BY	CHK.	DATE

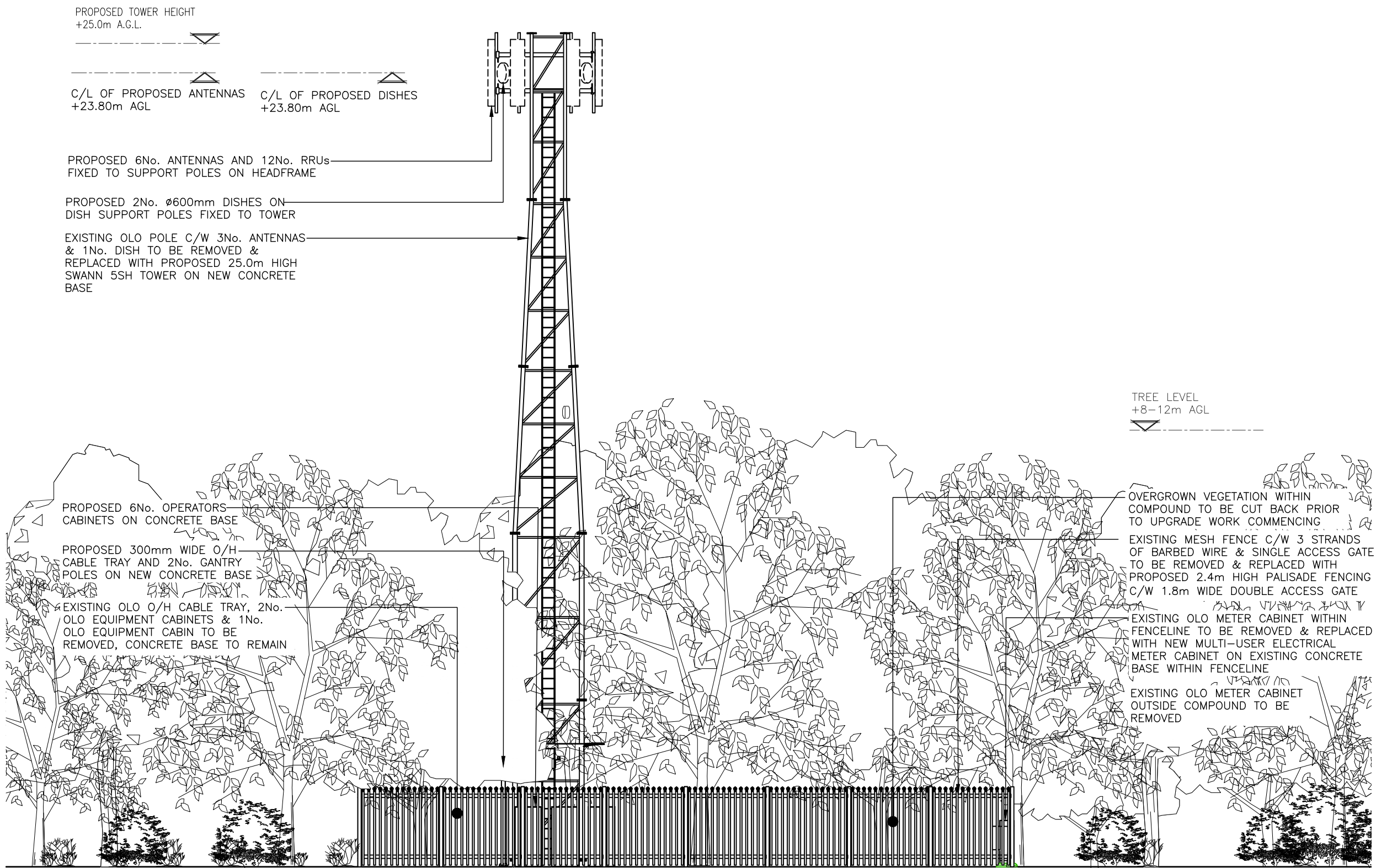

PROPOSED NORTH-WEST ELEVATION
(SCALE 1:125)

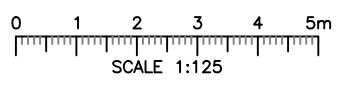

ICON TOWER REF No:
GBR-SFK0001

OPERATOR 1 REFERENCE No.:
N/A

OPERATOR 2 REFERENCE No.:
N/A

SITE NAME AND ADDRESS:
POND FARM
GREAT GREEN
DISS
IP21 4BQ

DRAWING TITLE:
PROPOSED SITE ELEVATION

PURPOSE OF ISSUE:
PLANNING

DRAWING NUMBER:
301

SURVEYED BY: INS GROUP	ORIGINAL SIZE: A3	ISSUE: A
DRAWN: FR	DATE: 19.06.23	CHECKED: INS
	DATE: 19.06.23	

1:1