

NOTES:
 THIS DRAWING IS COPYRIGHT OF VESP ARCHITECTS LTD.
 DO NOT SCALE FROM THIS DRAWING FOR CONSTRUCTION PURPOSES.
 USE DIMENSIONS SHOWN OR CONTACT THE ARCHITECT FOR
 CONFIRMATION. ALL DIMENSIONS TO BE CHECKED ON SITE. ALL
 OMISSIONS AND DISCREPANCIES TO BE REPORTED TO THE
 ARCHITECTS IMMEDIATELY

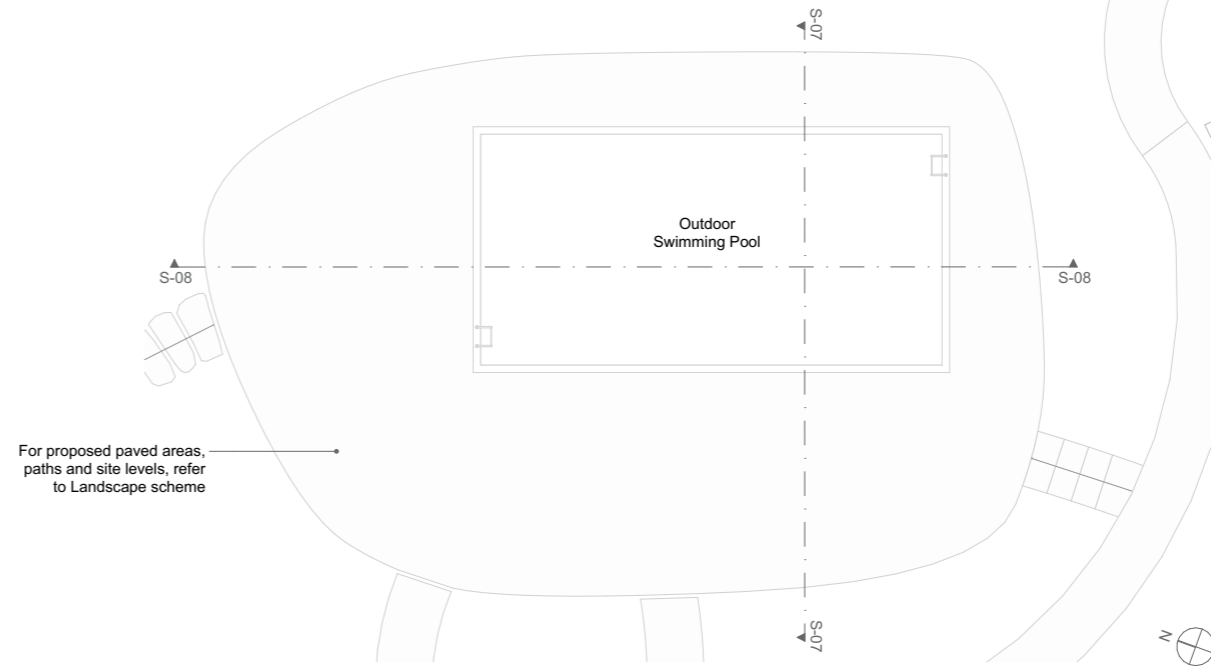

Swimming Pool - Proposed Plan
 1:200

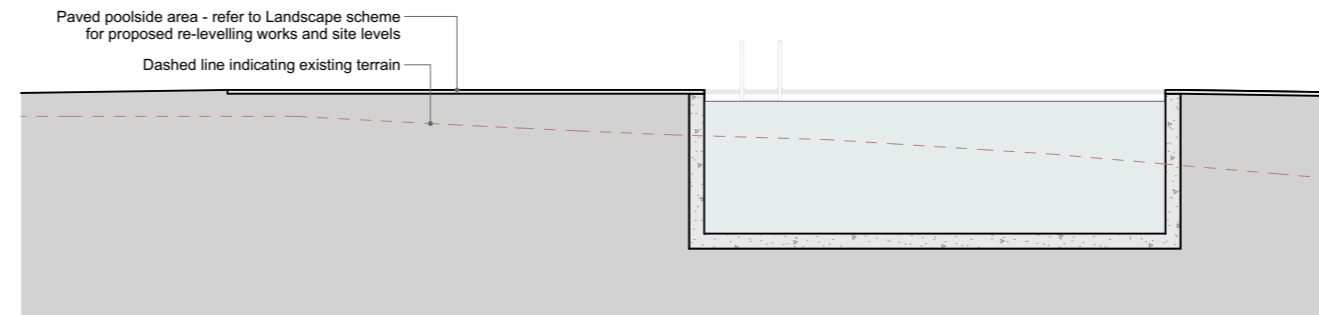
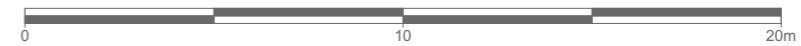

1
 S-07

Swimming Pool - Proposed Short Section
 1:100

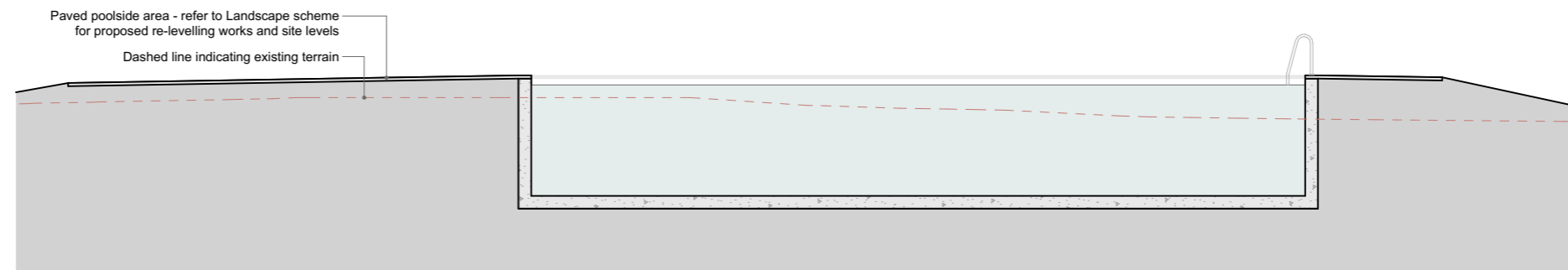

2
 S-08

Swimming Pool - Proposed Long Section
 1:100



Notes:
 - All existing and proposed landscaping, including trees, paths/surfaces, and site levels/contours, are illustrated indicatively where shown - refer to the Landscape Designer's drawings for all details.
 - Refer to the existing landscape drawing, the Tree Survey and Tree Constraints Plan for information on existing trees.
 - Refer to the Drainage Consultant's information for existing and proposed drainage strategy.

Revision Notes	Date	Rev
As per LPA request	17.08.23	A

Drawing Status

Project
Tremaine Green
 Tremaine Green, Pelynt, Looe,
 PL13 2LT

Drawing
Swimming Pool Sections - Proposed

Scale / A3 1:100, 1:200	Project No. 2232
----------------------------	---------------------

Drawing No. PL.23	Rev. A
----------------------	-----------

VESP
 ARCHITECTS

5 Station Yard
 Ashburton
 TQ13 7EF

01364 653 503
 hello@vesp.uk
 vesp.uk