

NOTES:
 THIS DRAWING IS COPYRIGHT OF VESP ARCHITECTS LTD.
 DO NOT SCALE FROM THIS DRAWING FOR CONSTRUCTION PURPOSES.
 USE DIMENSIONS SHOWN OR CONTACT THE ARCHITECT FOR
 CONFIRMATION. ALL DIMENSIONS TO BE CHECKED ON SITE. ALL
 OMISSIONS AND DISCREPANCIES TO BE REPORTED TO THE
 ARCHITECTS IMMEDIATELY.

- Key**
- Site Boundary (circa 9,900 sqm)
 - Ownership Boundary
 - - - Public Right of Way

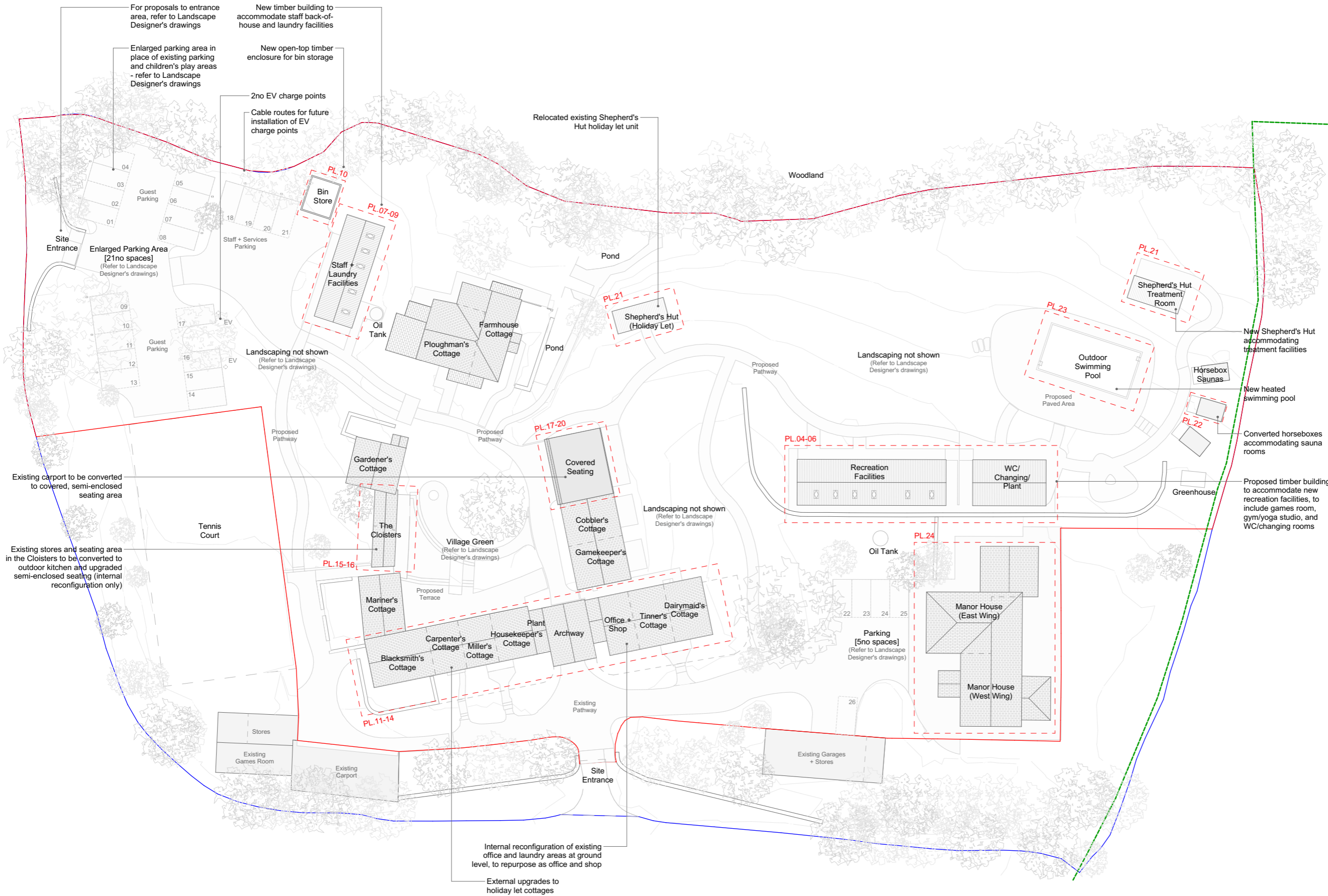

Notes:

- All existing and proposed landscaping, including trees, paths/surfaces, and site levels/contours, are illustrated indicatively where shown - refer to the Landscape Designer's drawings for all details.
- Refer to the existing landscape drawing, the Tree Survey and Tree Constraints Plan for information on existing trees.
- Refer to the Drainage Consultant's information for existing and proposed drainage strategy.

Revision Notes	Date	Rev
Draft issue	30.05.23	A
Planning issue	06.06.23	B
Amended to LPA comments	17.08.23	C

Drawing Status
FOR PLANNING

Project
Tremaine Green
 Tremaine Green, Pelynt, Looe,
 PL13 2LT

Drawing
Site Plan - Proposed

Scale / A3 1:500	Project No. 2232
---------------------	---------------------

Drawing No. PL.03	Rev. C
----------------------	-----------

VESP
 ARCHITECTS

5 Station Yard
 Ashburton
 TQ13 7EF

01364 653 503
 hello@vesp.uk
 vesp.uk

